

The Contemporary Artist's House

Living Among Art



CONCEPT
The Contemporary Artist's House combines artistic production, exhibition, and everyday living within a single residential environment. Inspired by the idea of bringing the atmosphere of an art gallery into the comfort of a home, the design creates a seamless relationship between art and daily life.
 A minimalist design language, enriched with neutral tones and bold color accents, provides a timeless backdrop for artworks. Sculptural forms and fluid, single-line furniture establish a refined spatial identity that reflects contemporary living.

SPATIAL ORGANIZATION
 The exhibition core, located at the **center** of the residence, serves as both the primary organizational element and the main display area for artworks.
 Circulation is arranged around this central volume, creating a continuous spatial flow that encourages interaction with art throughout the home. Neutral surfaces highlight the artworks, while the surrounding living spaces maintain a warm and inviting atmosphere.

DESIGN DECISIONS
 Material selection, lighting, and spatial organization form the foundation of the design. Light natural materials and clean surfaces emphasize the artworks, while warm wood textures enhance comfort within the living spaces.
 The layout is organized according to orientation, placing social areas along the daylight-facing façade and private spaces toward the rear. A restrained ceiling design and continuous linear elements reinforce spatial unity, directing attention toward the artworks and the overall user experience.

"A HOME
 CURATED
 AS A
 LIVING GALLERY."

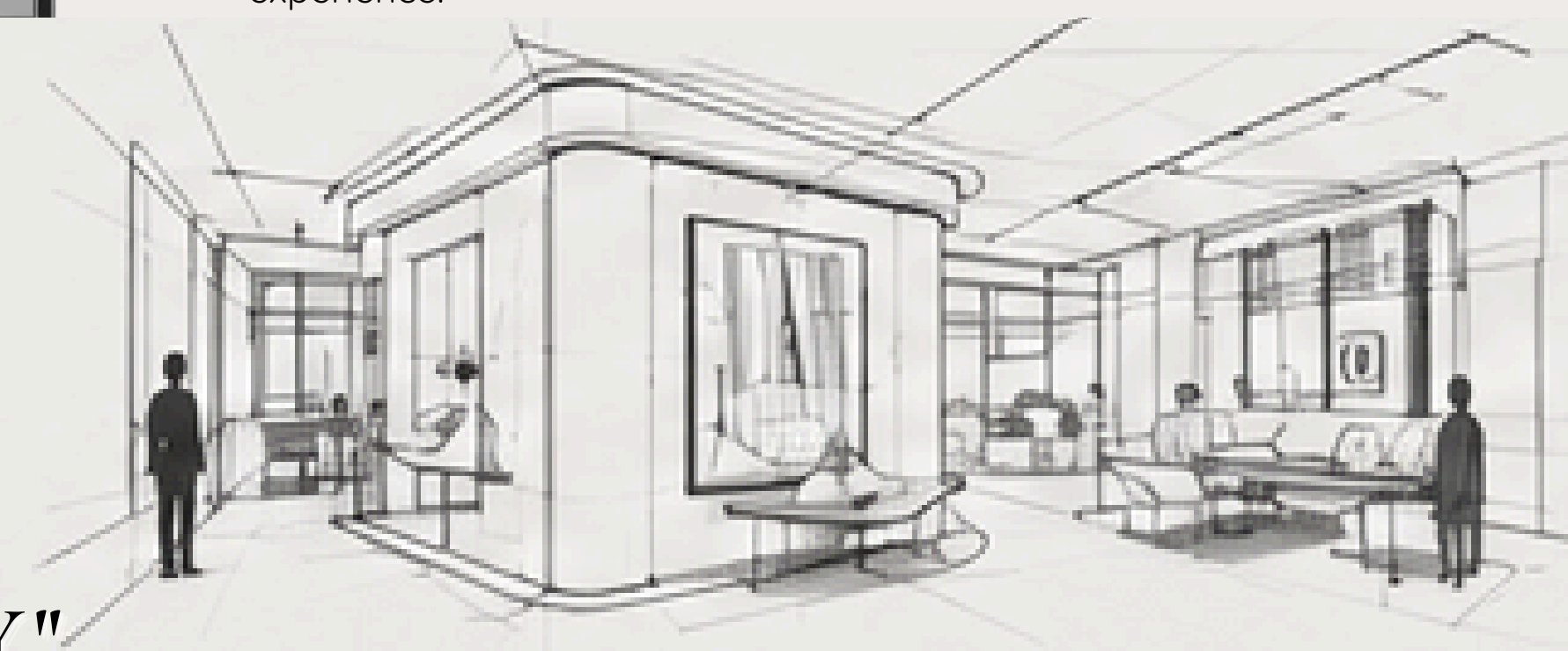

Living Area

Kitchen



Master Bedroom

En-Suite Bathroom

Laundry Room

Bathroom

Hobby Room

