

THE MARITIME THRESHOLD

AN ARCHAEOLOGICAL PLATFORM OF LIGHT AND MEMORY

SITE:



LOCATED IN A COASTAL ARCHAEOLOGICAL (RUINS OF TYRE) CONTEXT IN TYRE, THE PROJECT RESPONDS TO THE SEA, THE RUINS, AND THE CULTURAL MEMORY OF THE SITE.

OVERALL MASS:

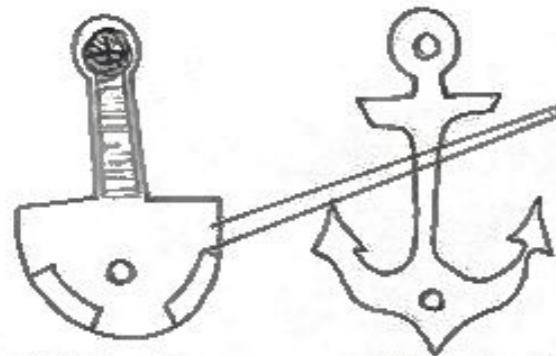

THE OVERALL MASS IS INSPIRED BY THE IMAGE OF ANCHOR SYMBOLISING STABILITY AND MARITIME IDENTITY. THE CIRCULAR GEOMETRY ENHANCES THE IDEA OF GATHERING AND FOCUSING ATTENTION TOWARD THE ARCHAEOLOGICAL VOID.

THE PROJECT IS NOT A BUILDING, BUT A SEQUENCE OF SPATIAL EXPERIENCES CONNECTING MOVEMENT, OBSERVATION, AND ARCHAEOLOGICAL MEMORY.

MATERIAL: THE PROJECT IS FINISHED IN LIMESTONE.

STYLE: ROMAN-INSPIRED ARCHITECTURE STYLE.

BOTH TO ESTABLISH A VISUAL DIALOGUE WITH THE ARCHAEOLOGICAL CONTEXT OF TYRE.

AN EXTENDED COURTYARD AND GATHERING SPACE ALLOW THE PROJECT TO FUNCTION AS A PUBLIC CULTURAL PLATFORM, CAPABLE OF HOSTING EVENTS AND COLLECTIVE ACTIVITIES.

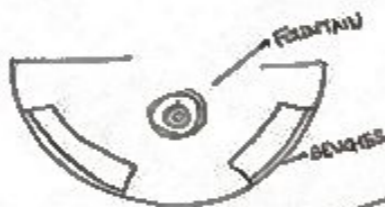

STAIRS: A PROCESSIONAL STAIR LEADS THE VISITOR GRADUALLY UPWARD NARROWING THE PERCEPTION AND INTENSIFYING ANTICIPATION. THE ASCENT CULMINATES IN A VIEWING PLATFORMS THAT FRAMES THE SEA AND THE ARCHAEOLOGICAL LANDSCAPE.

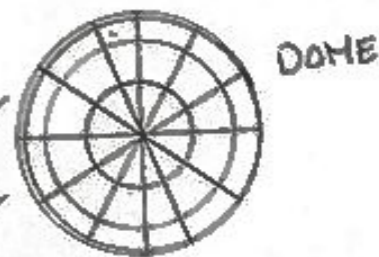

A PERFORATED DOME FILTERS NATURAL LIGHT TOWARD THE ARCHAEOLOGICAL VOID, CREATING A DYNAMIC PATTERN OF SHADOWS THAT CHANGES THROUGHOUT THE DAY. THE LIGHT STRATEGY EMPHASIZES THE ACT OF REVELATION RATHER THAN SIMPLE ILLUMINATION.

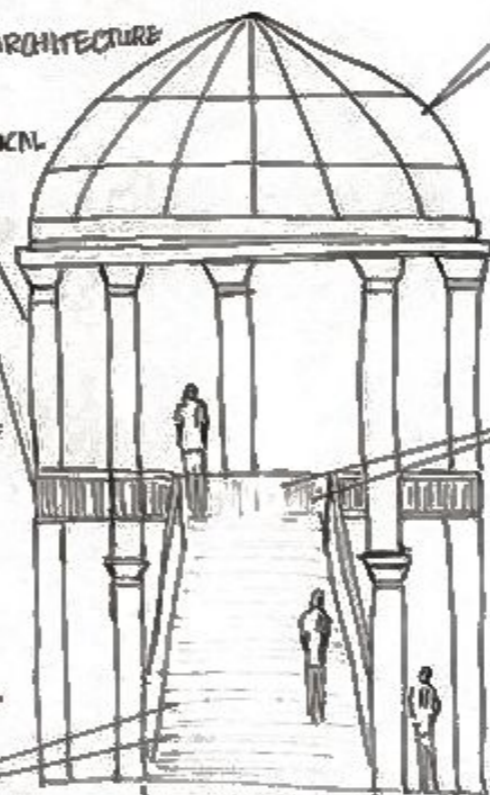

VOID: AT THE HEART OF THE PROJECT, A CIRCULAR VOID REVEALS THE ARCHAEOLOGICAL MOSAIC FROM ABOVE AND BELOW, ALLOWING MULTIPLE PERSPECTIVE OF SITE. IT ACTS AS AN ARCHITECTURAL MAGNIFIER.

THE

AN

SITE :



LOCATED IN A COASTAL ARCHAEOLOGICAL (RUNS OF TYRE) CONTEXT IN TYRE, THE PROJECT RESPONDS TO THE SEA, THE RUINS, AND THE CULTURAL MEMORY OF THE SITE.

OVERALL MASS:

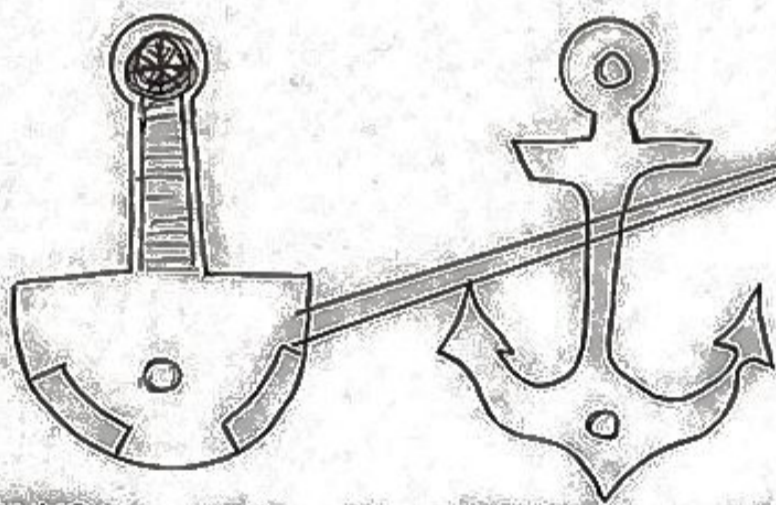

THE OVERALL MASS IS INSPIRED BY THE IMAGE

OF ANCHOR SYMBOLISING STABILITY AND MARITIME IDENTITY.
THE CIRCULAR GEOMETRY ENHANCES THE IDEA OF GATHERING AND FOCUSING ATTENTION TOWARD THE ARCHAEOLOGICAL VOID.

AN ARCHAEOLOGICAL PLATFORM OF LIGHT AND MEMORY

THE PROJECT IS NOT A BUILDING, BUT A SEQUENCE OF SPATIAL EXPERIENCES CONNECTING MOVEMENT, OBSERVATION, AND ARCHAEOLOGICAL MEMORY.

MATERIAL: THE PROJECT IS FINISHED IN LIMESTONE.

STYLE: ROMAN-INSPIRED ARCHITECTURE STYLE.

BOTH TO ESTABLISH A VISUAL DIALOGUE WITH THE ARCHAEOLOGICAL CONTEXT OF TYRE.

AN EXTENDED COURTYARD AND GATHERING SPACE ALLOW THE PROJECT TO FUNCTION AS A PUBLIC CULTURAL PLATFORM, CAPABLE OF HOSTING EVENTS AND COLLECTIVE ACTIVITIES.

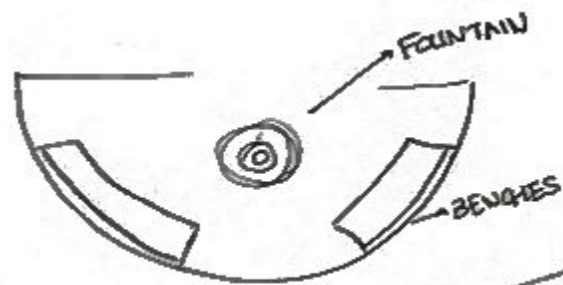

STAIRS: A PROCESSIONAL STAIR LEADS THE VISITOR GRADUALLY UPWARD NARROWING THE PERCEPTION AND INTENSIFYING ANTICIPATION. THE ASCENT CULMINATES IN A VIEWING PLATFORMS THAT FRAMES THE SEA AND THE ARCHAEOLOGICAL LANDSCAPE.

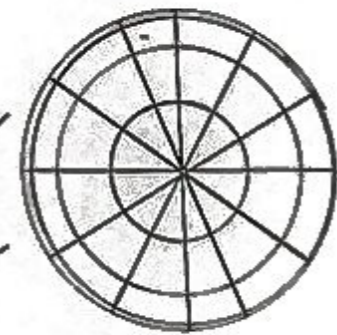

DOMES

A PERFORATED DOME FILTERS NATURAL LIGHT TOWARD THE ARCHAEOLOGICAL VOID, CREATING A DYNAMIC PATTERN OF SHADOWS THAT CHANGES THROUGHOUT THE DAY.

THE LIGHT STRATEGY EMPHASIZES THE ACT OF REVELATION RATHER THAN SIMPLE ILLUMINATION.

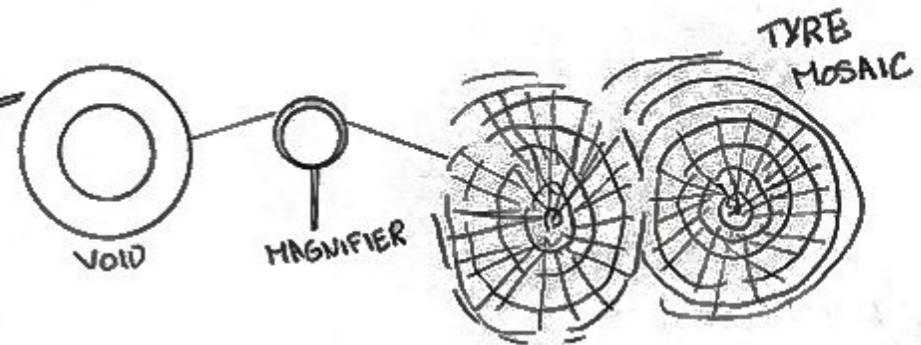

VOID: AT THE HEART OF THE PROJECT, A CIRCULAR VOID REVEALS THE ARCHAEOLOGICAL MOSAIC FROM ABOVE AND BELOW, ALLOWING MULTIPLE PERSPECTIVE OF SITE. IT ACTS AS AN ARCHITECTURAL MAGNIFIER

INSOFTYRE)
S TO THE
/ OF THE SITE.

THE IMAGE

ARITIME IDENTITY.
OF GATHERING AND
SICAL VOID.

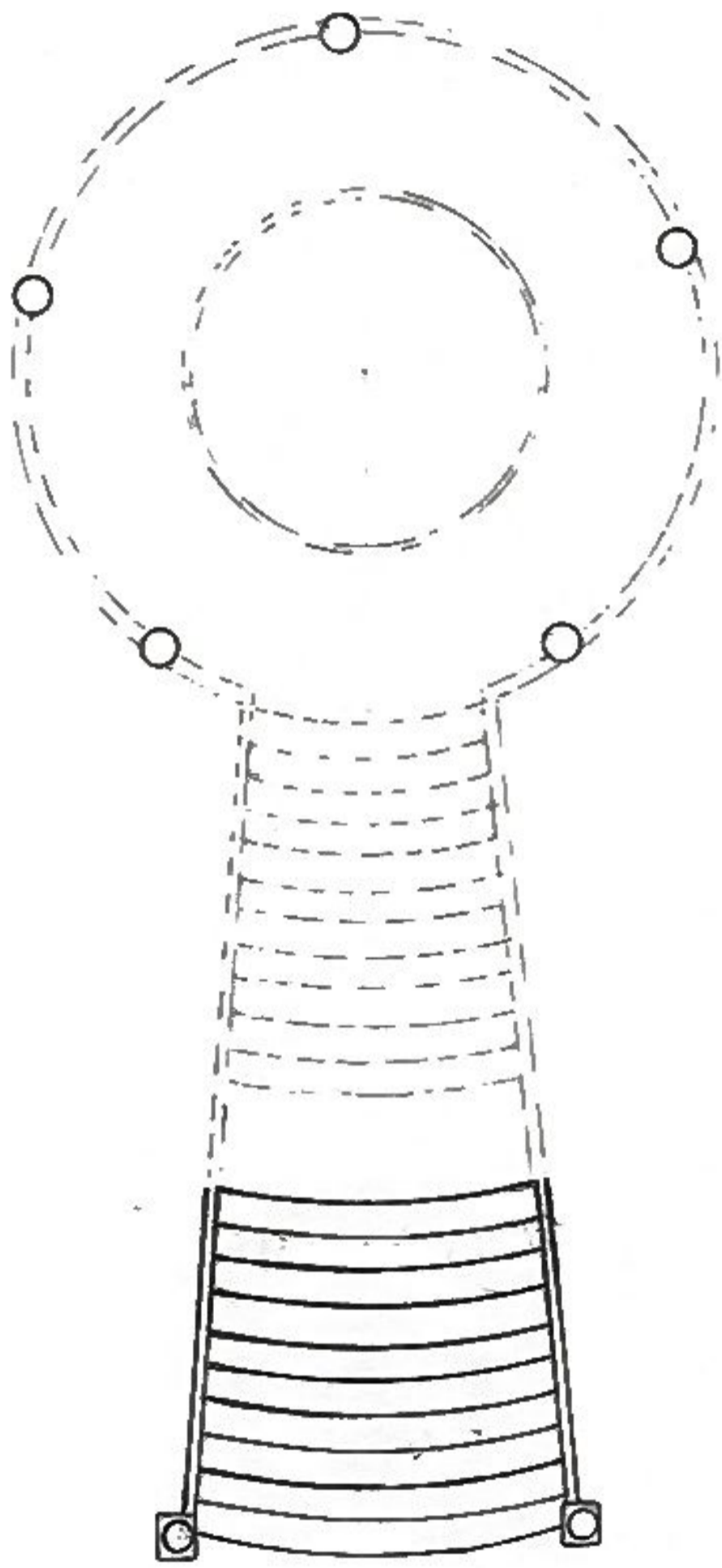

GROUND FLOOR PLAN
Ech 1/50

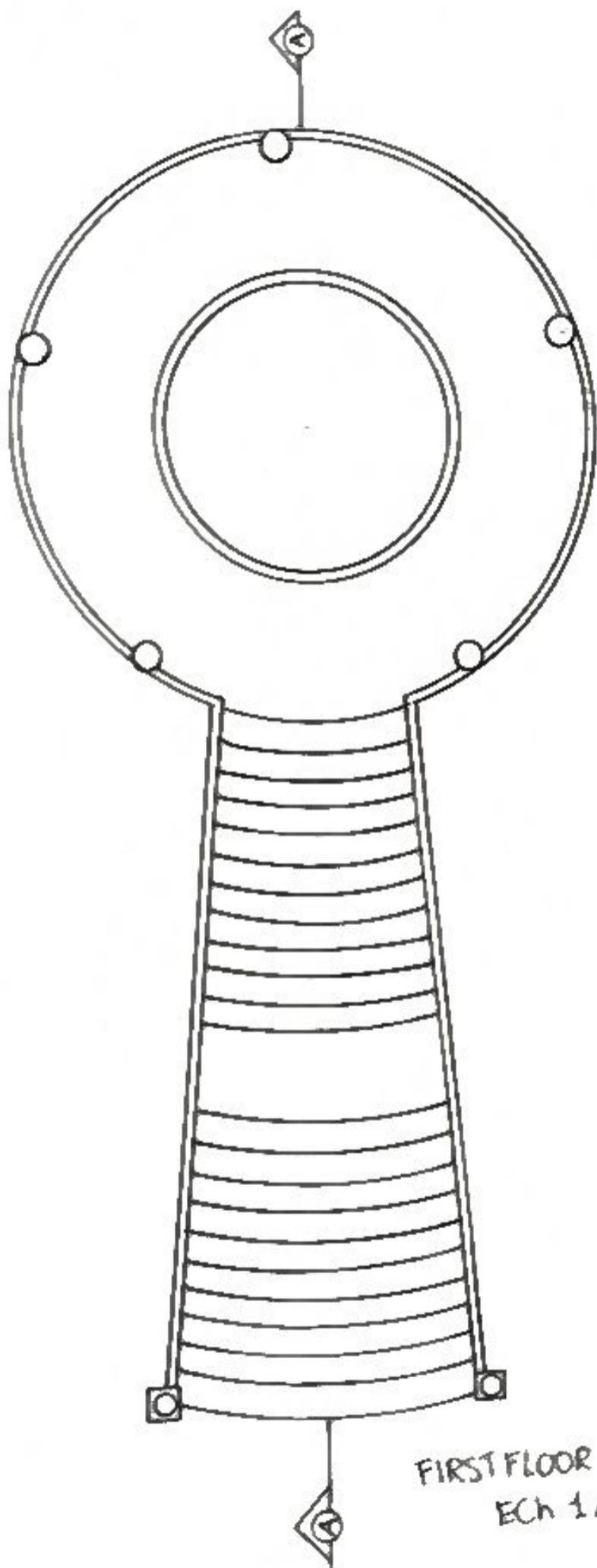

FIRST FLOOR PLAN
ECH 1/50

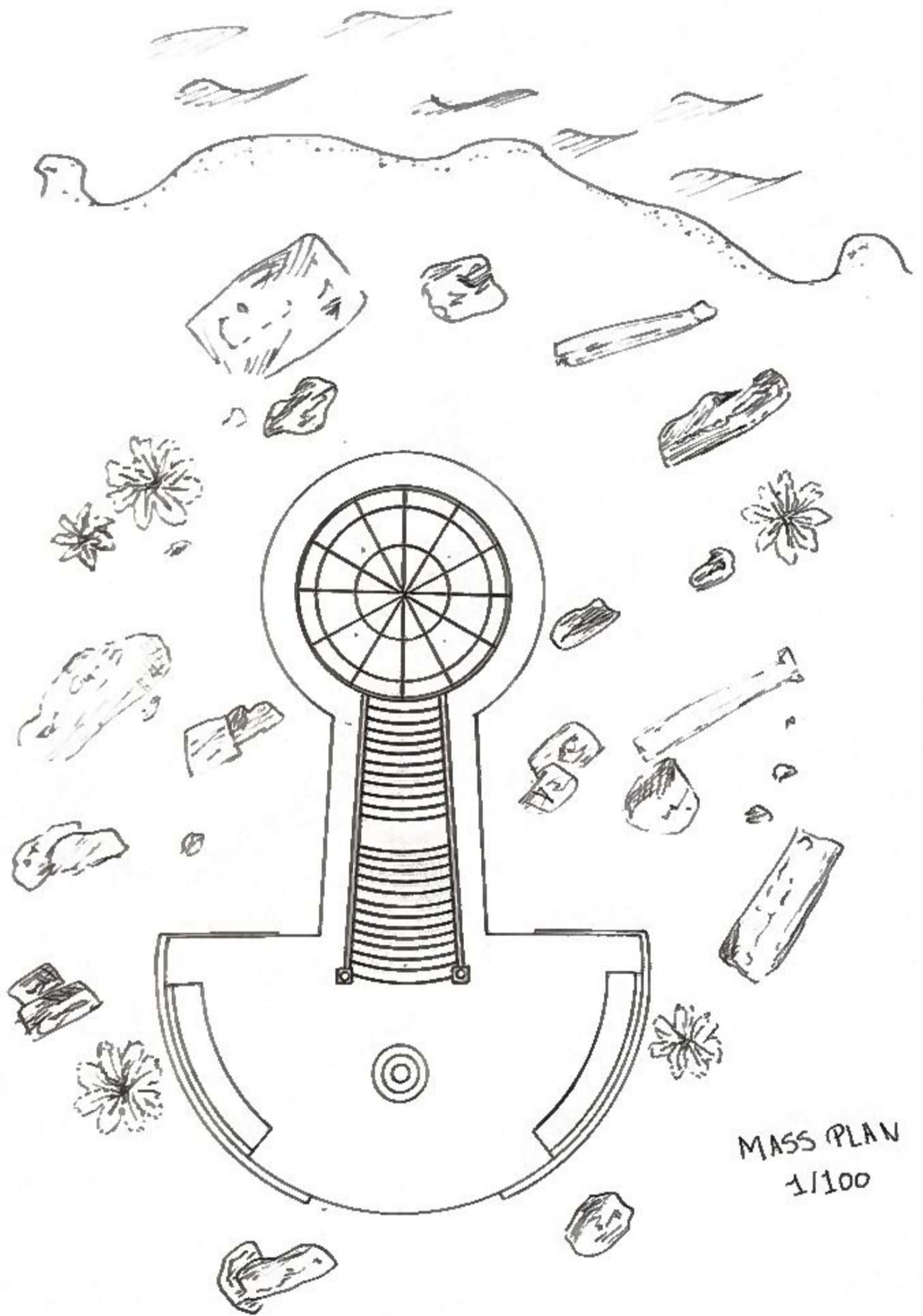

MASS PLAN
1/100

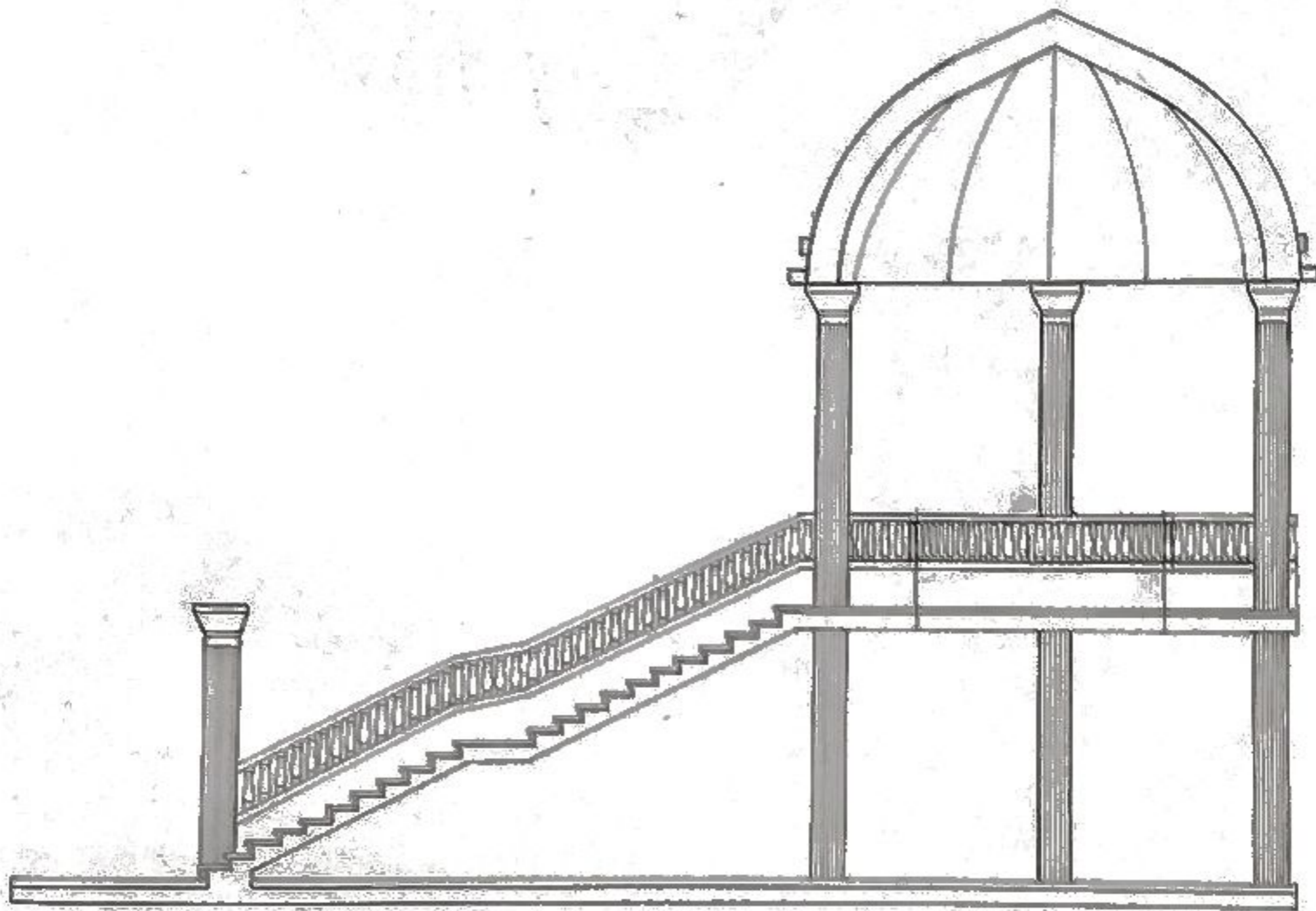

SECTION A
SC: 1/50

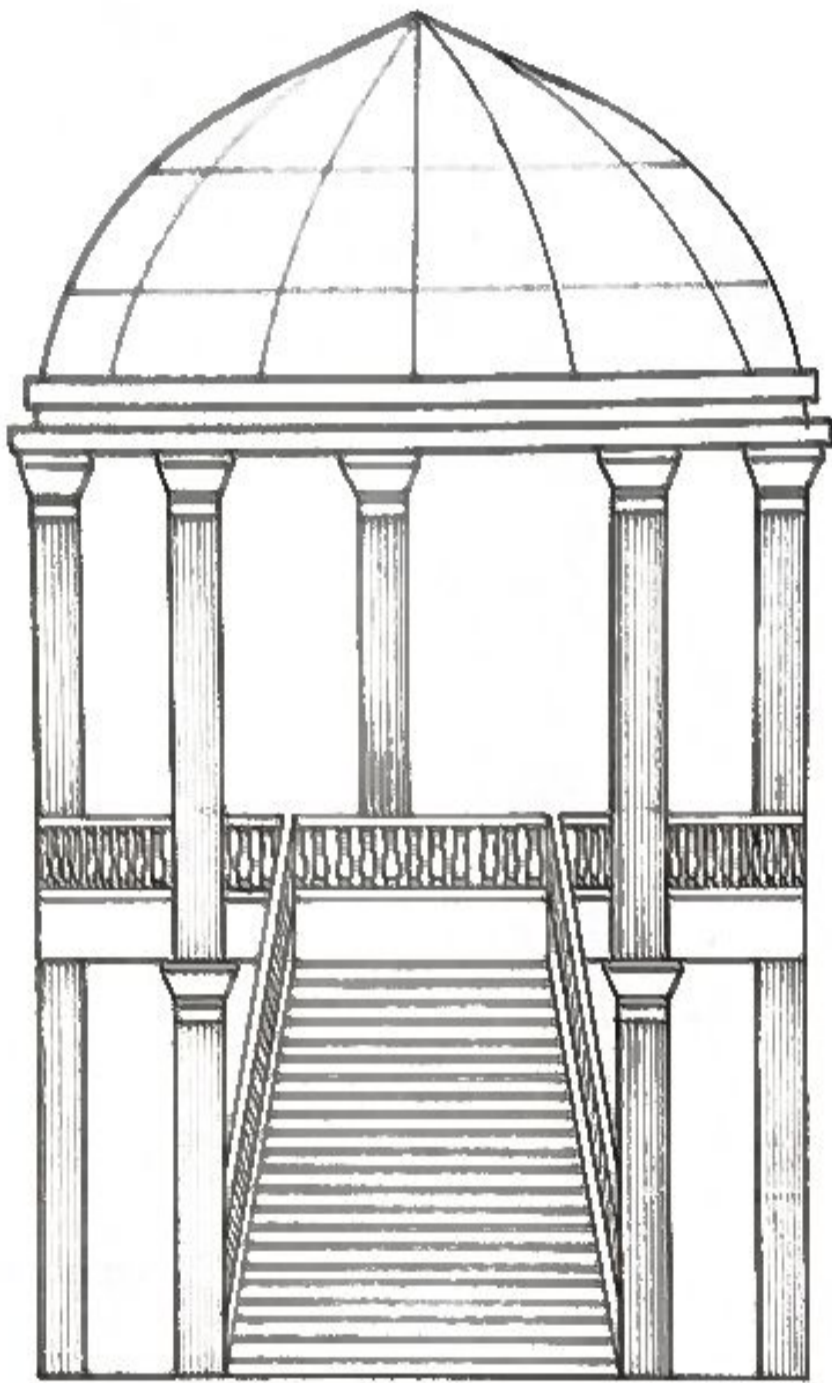

ELEVATION
1/50