



**shell homage**

**Meticulously crafted out of 100% waste materials**

Our materials are relatively lightweight compared to marble or natural stones, and they possess non-repetitive, one-of-a-kind patterns and structures.

Shell Homage creates biodegradable materials out of egg and walnut shells, which are bonded with organic and biodegradable substances. This enables us to create a versatile mixture that can be utilized through various production techniques. Similar to stone or ceramic, our materials can be drilled, sanded, laser cut, or cast using CNC methods.

We employ natural dyeing techniques, using colors extracted from food ingredients, herbs, and natural stones, all of which are completely biodegradable. Each surface and object we create is meticulously handcrafted, resulting in a unique combination of textures, colors, and patterns. When no longer in use, our products are 100% compostable. The composite material we develop can be pressed, extruded, 3D printed, thermoformed, hand laid, or formed through injection molding.

**Galala-Ain-Sokhna city**

**Site analysis**

Our materials are relatively lightweight compared to marble or natural stones, and they possess non-repetitive, one-of-a-kind patterns and structures.

Shell Homage offers a meaningful and delightful experience to users, with a powerful message behind it. We fabricate biodegradable composite materials without the use of toxic chemicals, expanding possibilities for applications in product and industrial design, 3D printing, interior design, consumable goods, fashion, and jewelry design.

Shell Homage offers a meaningful and delightful experience to users, with a powerful message behind it. We fabricate biodegradable composite materials without the use of toxic chemicals, expanding possibilities for applications in product and industrial design, 3D printing, interior design, consumable goods, fashion, and jewelry design.

**matrix**

- entrance
- waiting area
- main displays
- custom made zone
- cashier
- focal point
- administrative entrance
- reception
- security room
- storage

**zoning**

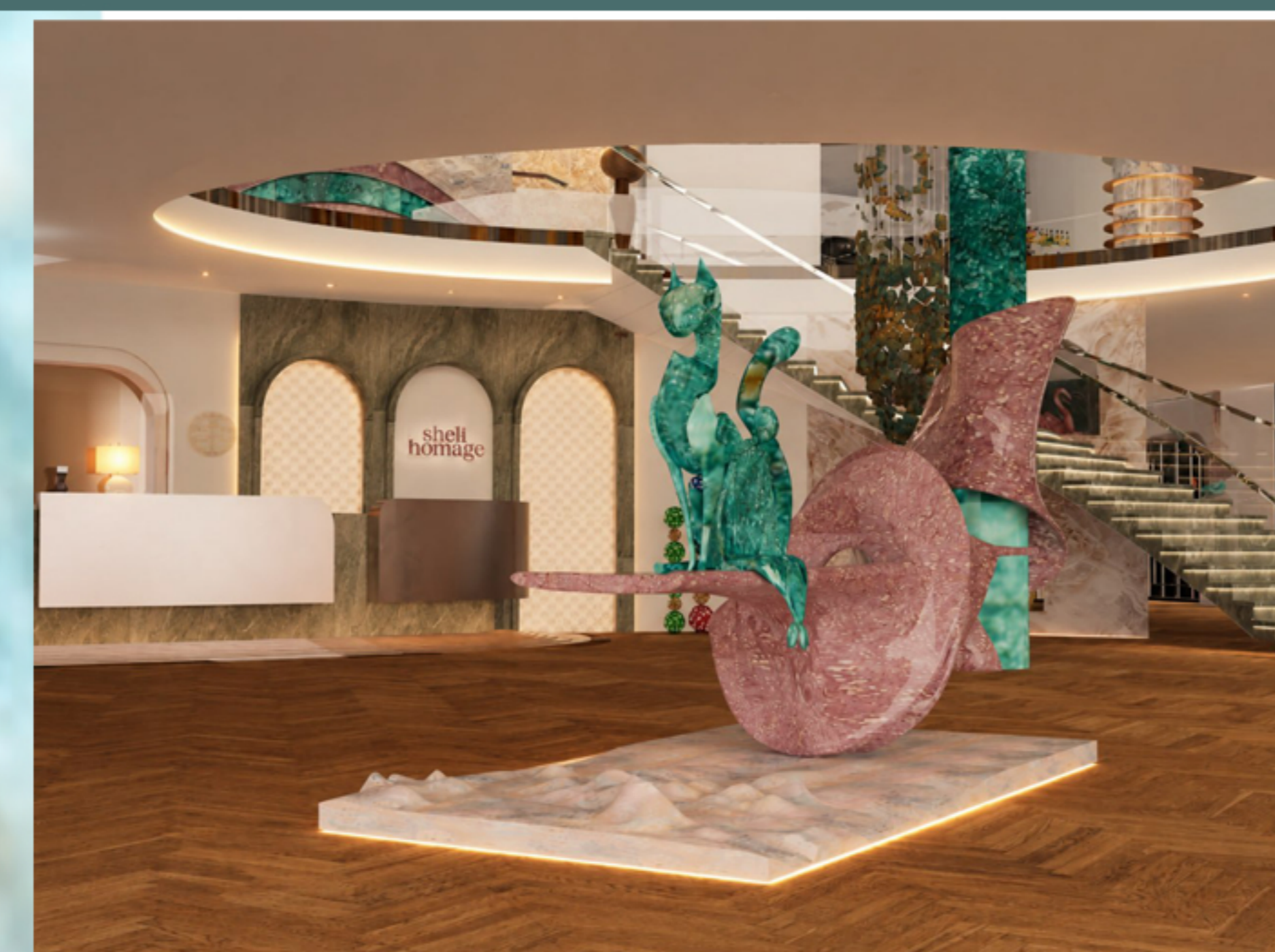

PERSPECTIVE SHOT (1)



PERSPECTIVE SHOT (2)

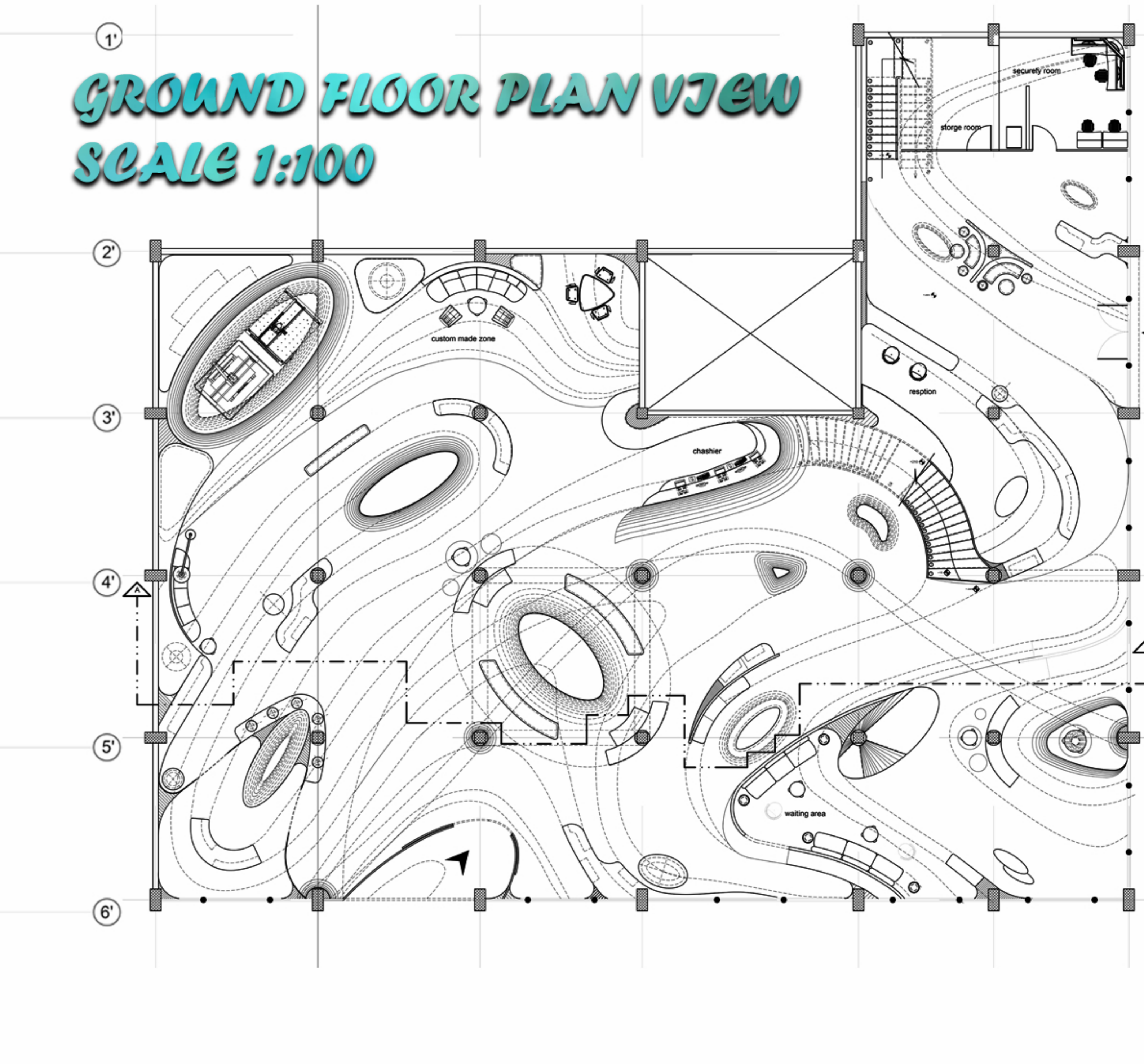
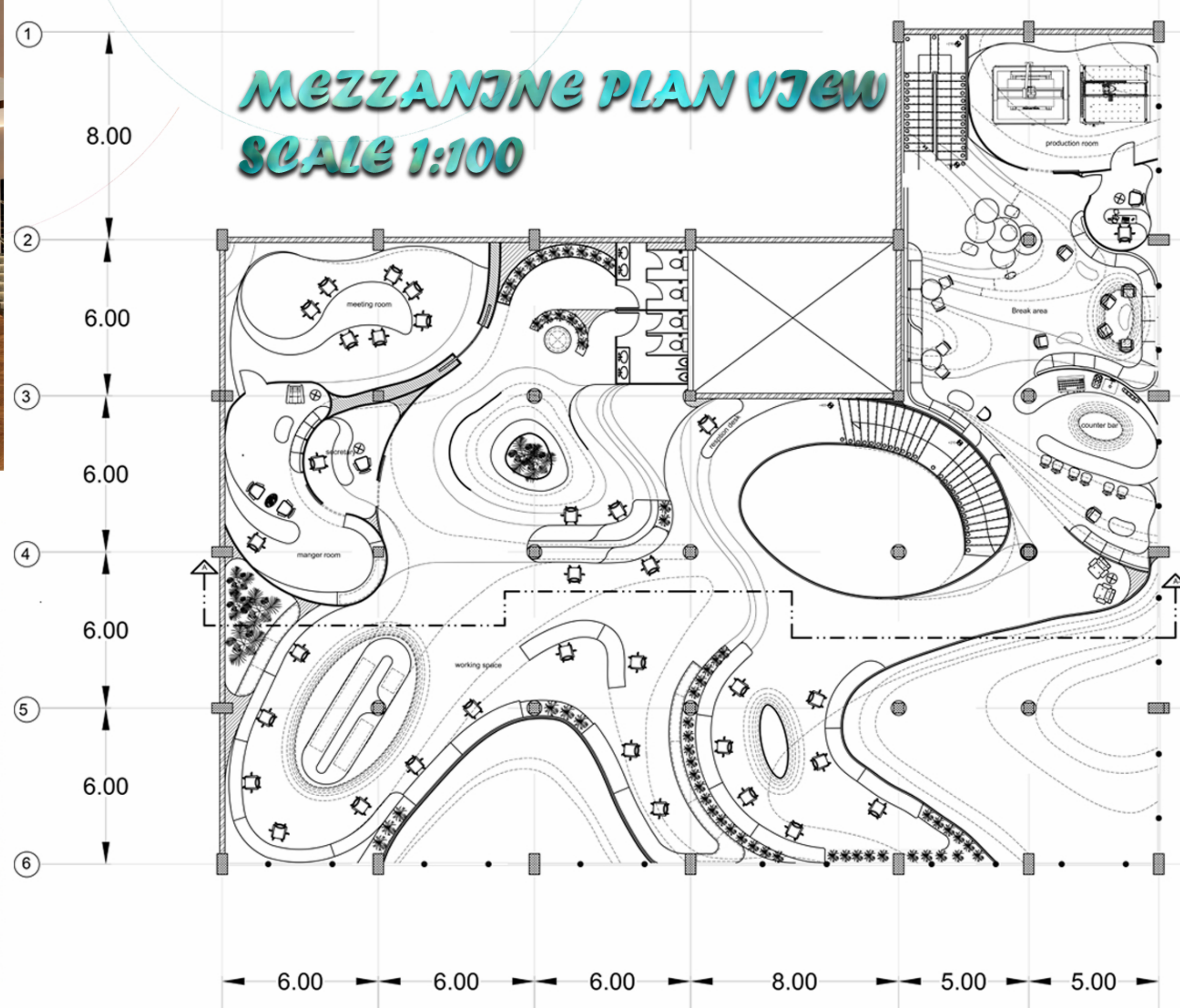

PERSPECTIVE SHOT (3)



PERSPECTIVE SHOT (4)



PERSPECTIVE SHOT (5)



PERSPECTIVE SHOT (6)



PERSPECTIVE SHOT (7)



SECTION (A-A) SCALE 1:25