

# OCEAN AND MARINE RESEARCH CENTER

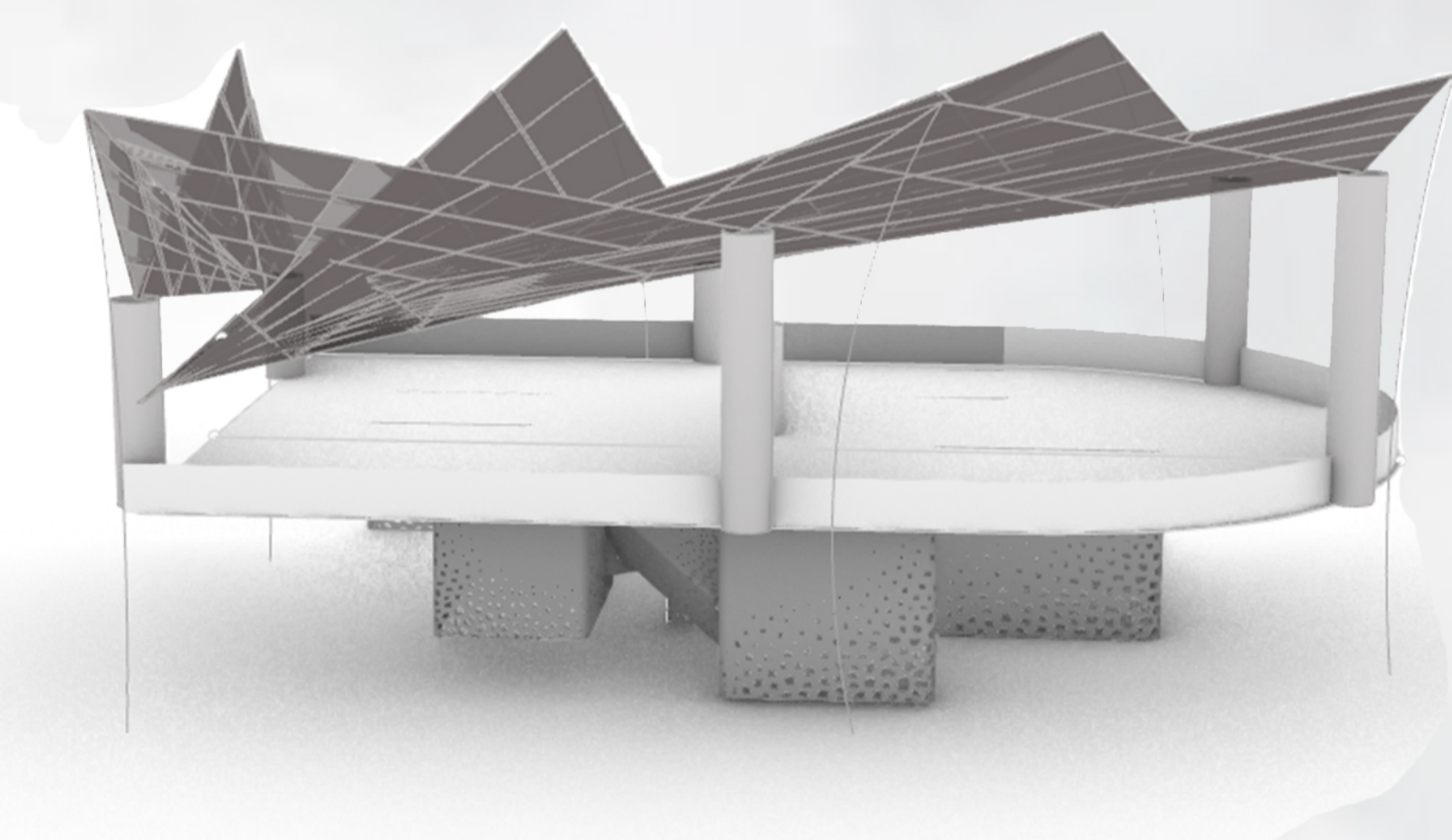

## TECHNICAL DETAIL

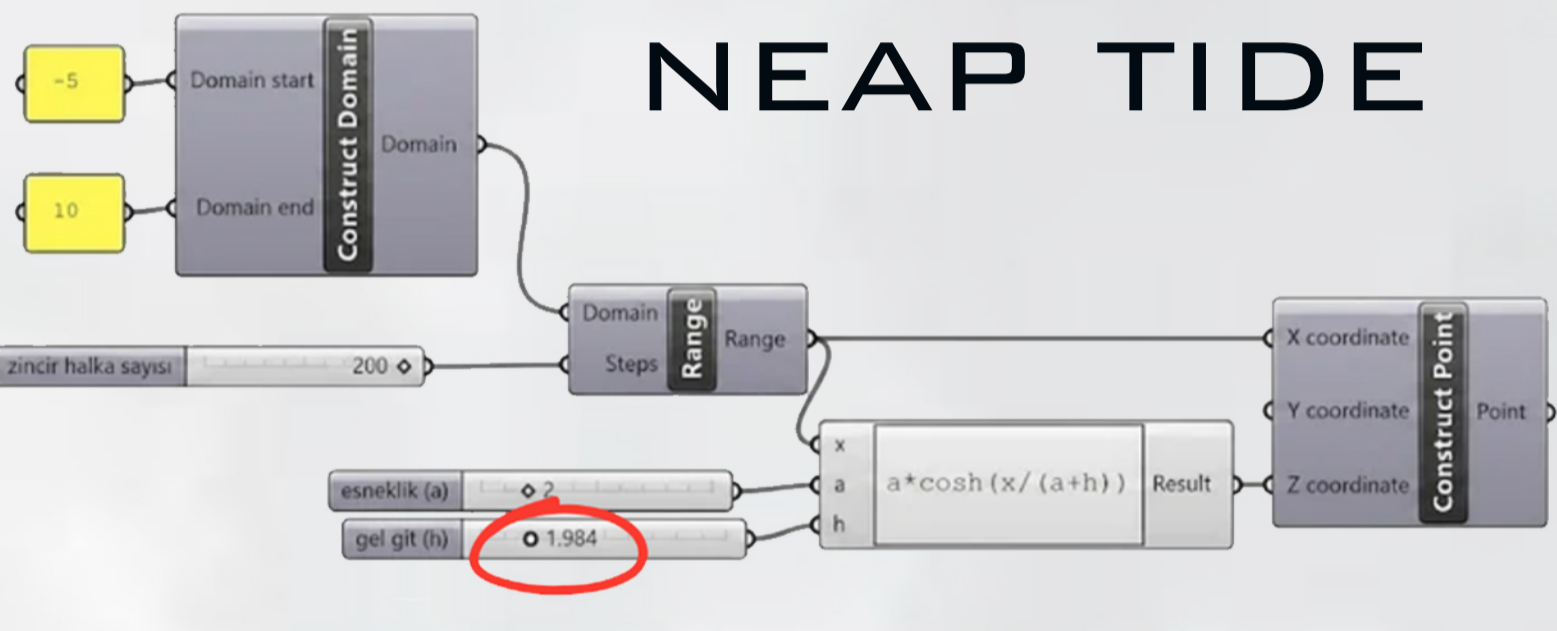
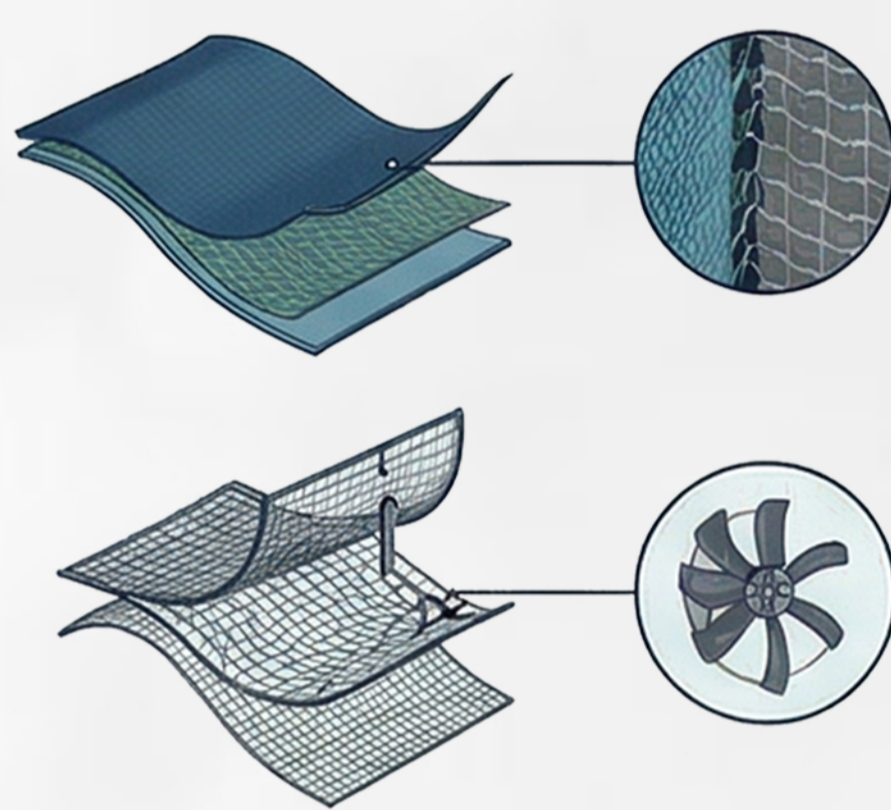

THE PIEZOELECTRIC SENSORS LOCATED AT THE JOINTS OF THE PARAMETRIC ROOF AND THE MINI-TURBINES ON THE CATENARY CURVE CHAINS CAN GENERATE ELECTRICITY FROM THE CONTINUOUS MOVEMENT CAUSED BY TIDES, SUFFICIENTLY MEETING THE ENERGY NEEDS OF THE STRUCTURE.

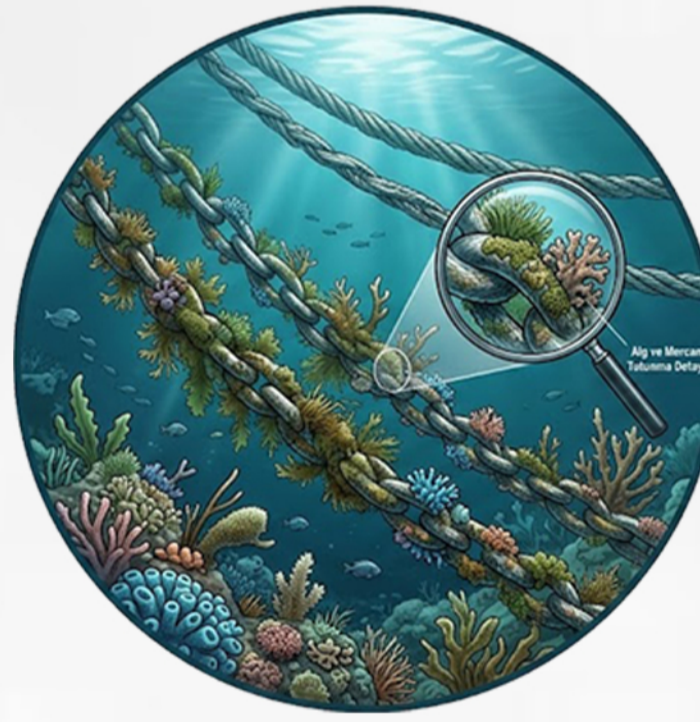
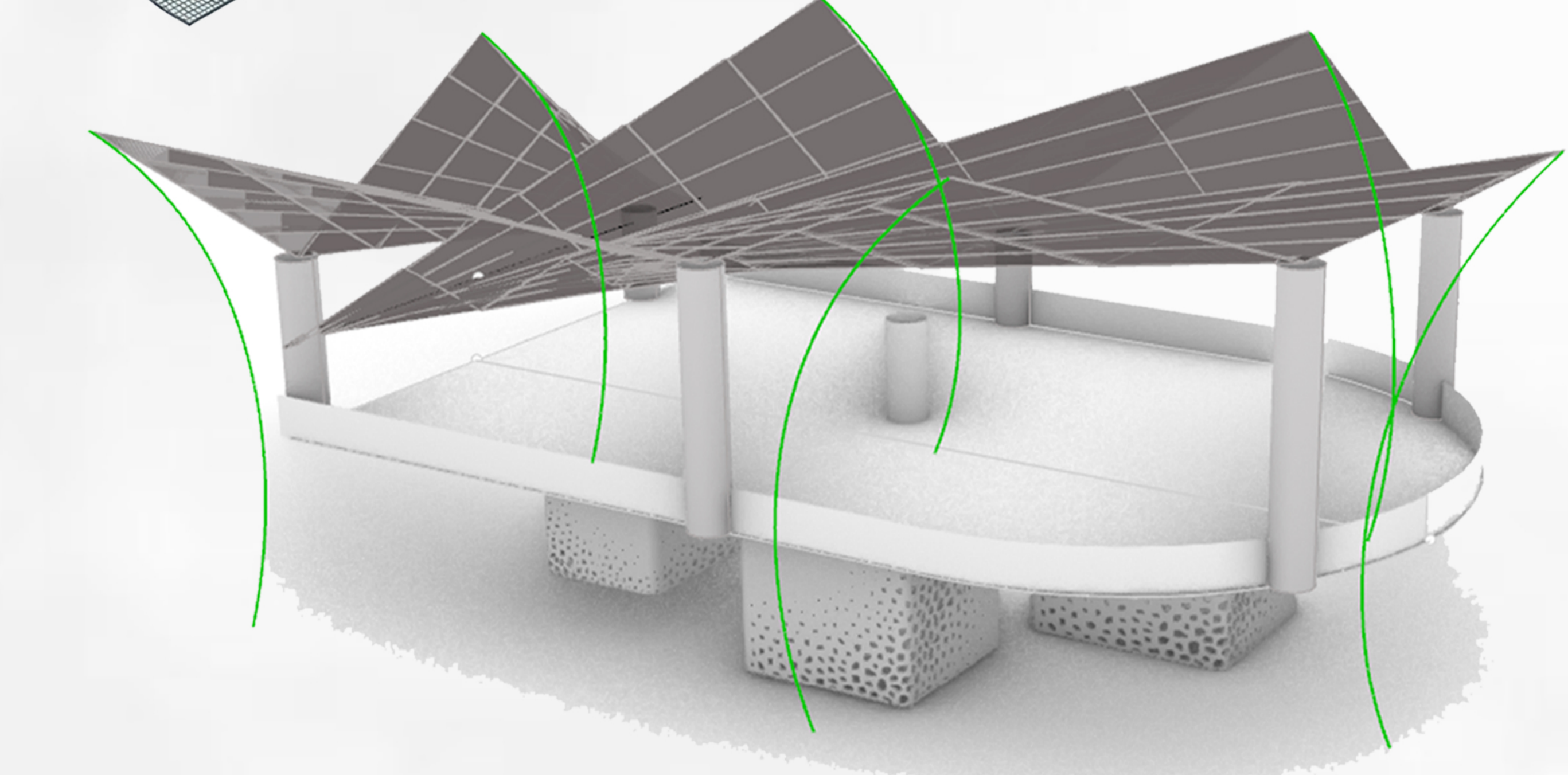
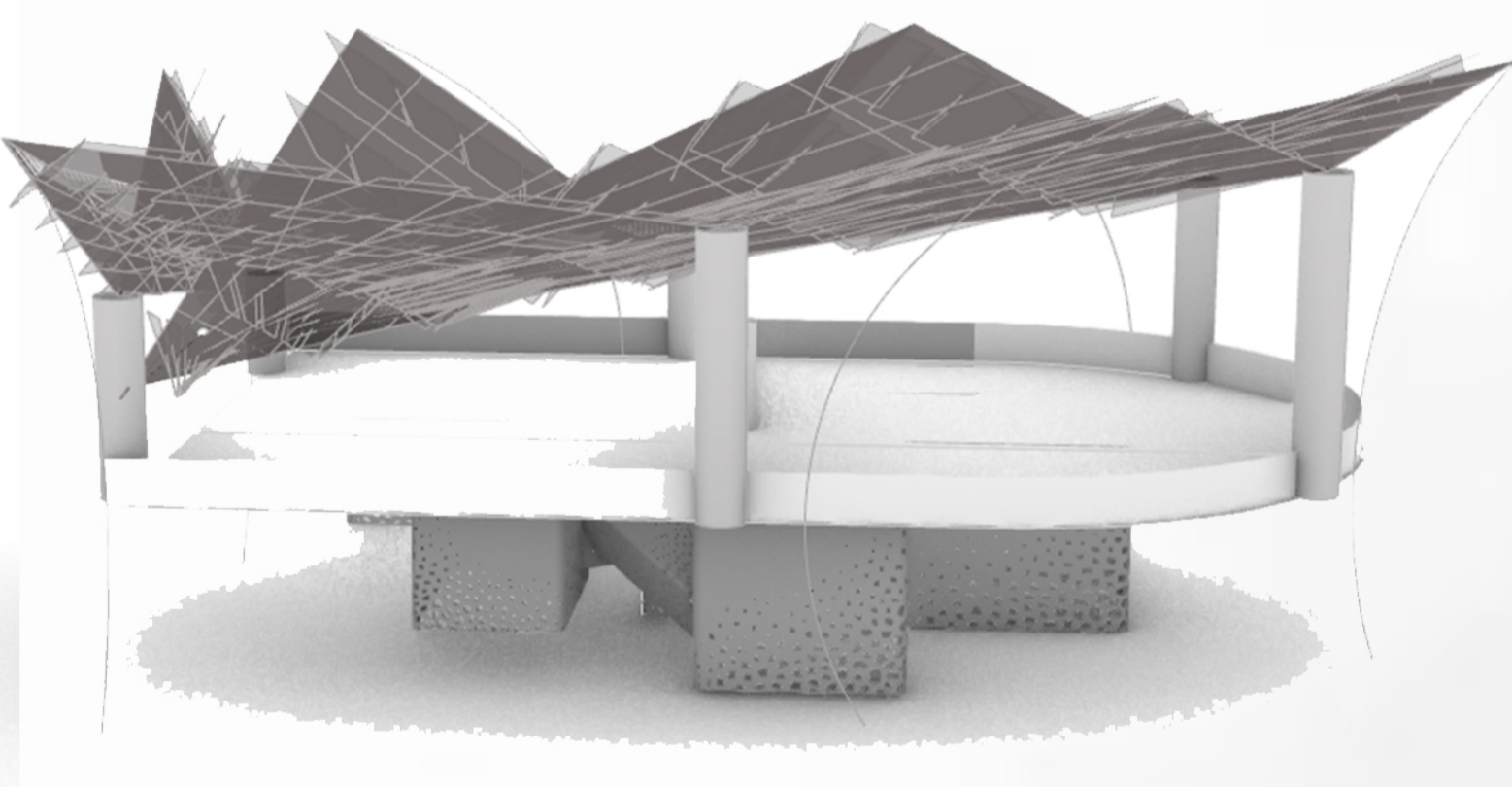
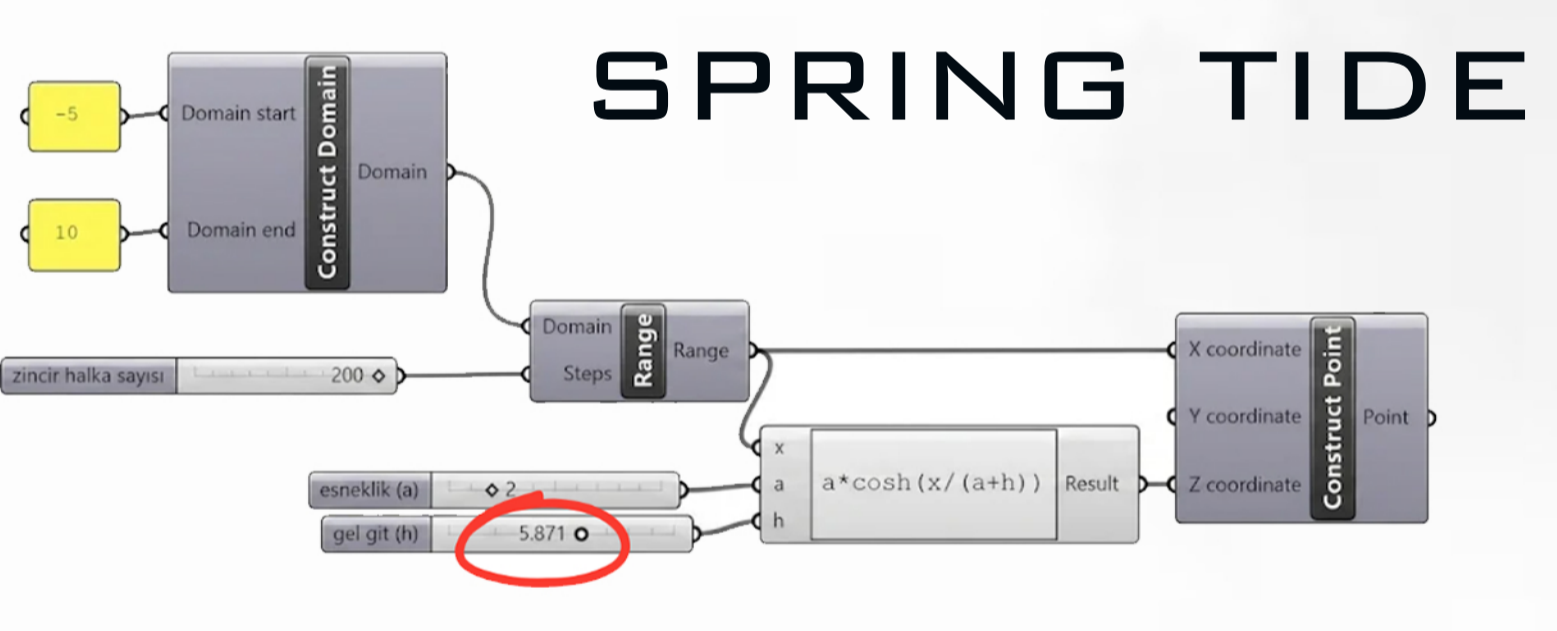

FURTHERMORE, THE CATENARY CURVE CHAINS OF THE STRUCTURE ARE MANUFACTURED FROM BIOPLASTICS AND SMART COMPOSITES, WHICH ARE SALTWATER-RESISTANT AND ANTI-CLOGGING SMART MATERIALS. CONSEQUENTLY, THE SURFACE TEXTURE OF THE CHAIN PROVIDES AN ATTACHMENT SURFACE FOR ALGAE AND CORALS, SERVING AS A HABITAT TO RESTORE THE MARINE ECOSYSTEM THAT HAS VANISHED OVER TIME

