

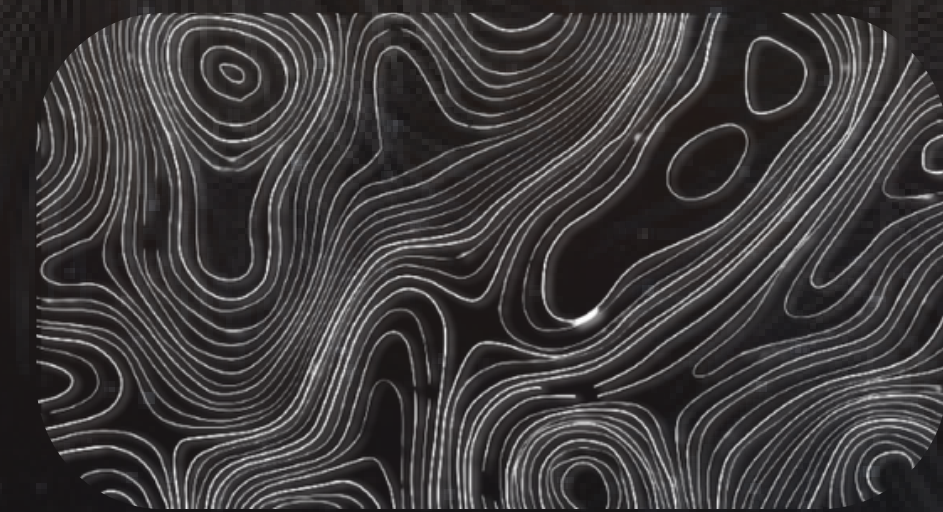

In Amazigh, it means desert. It is a strange and uncommon language, but it is linked to the Sahrawi identity.

CONCEPT

The concept blends the mystique of desert caves with the serenity of Faiyoum's natural landscape. The indoor area features a cave-inspired design – earthy textures, warm lighting, and natural stone finishes – evoking the feeling of a hidden desert retreat. The outdoor area transitions into an open desert oasis, with a man-made waterfall, a small lake with birds, and low Bedouin-style seating surrounded by lush greenery. The overall ambiance takes guests on a journey from the stillness of the cave to the openness and life of the desert – a balance between tranquility and nature's vitality.



MATRIX

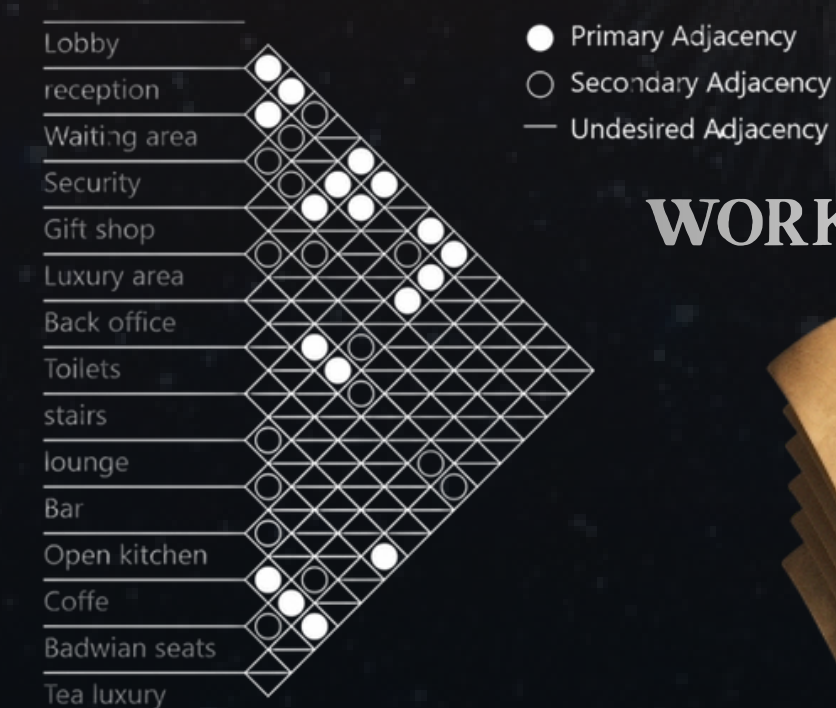

STRUCTURE ANALYSIS

HOTEL AREA
708 SQUARE METER WITH THE OUTDOOR AREA



WORKING DETAILS



SKY LIGHT



FRIST FLOOR ZONING

WALLS INSTRUCTION

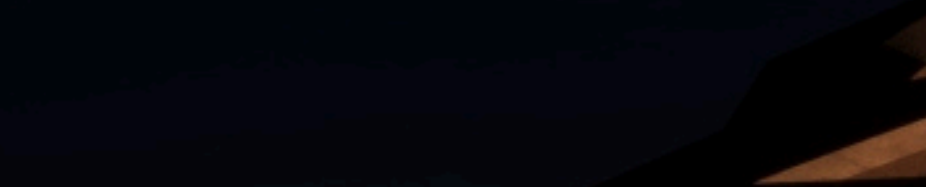

AMAZEIH LETTERS

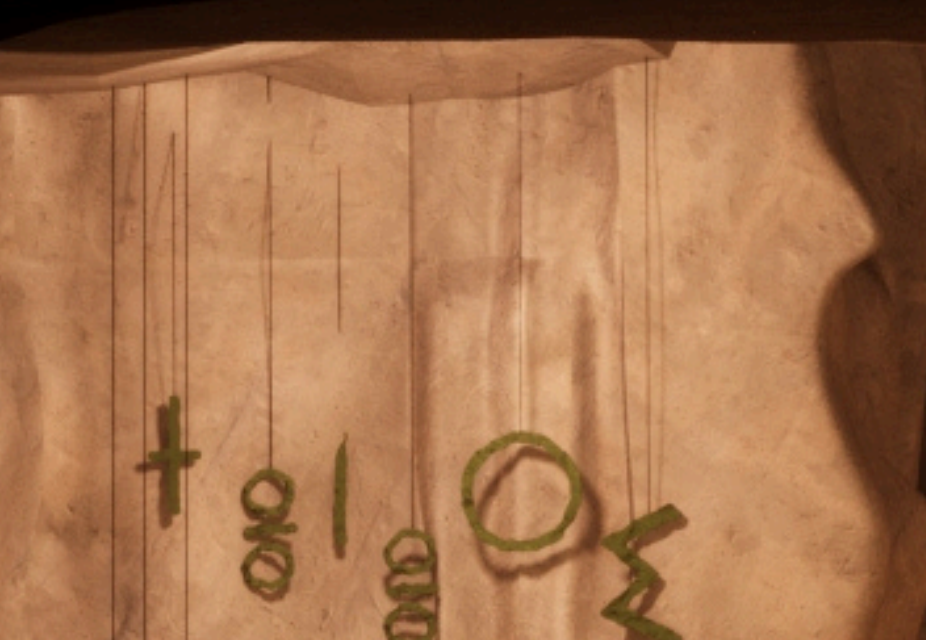

PHARAONIC HOLOGRAM



STARS HOLOGRAM

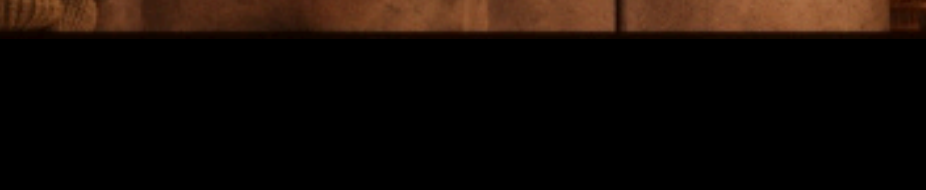

MATERIALS



COLOR SCHEME

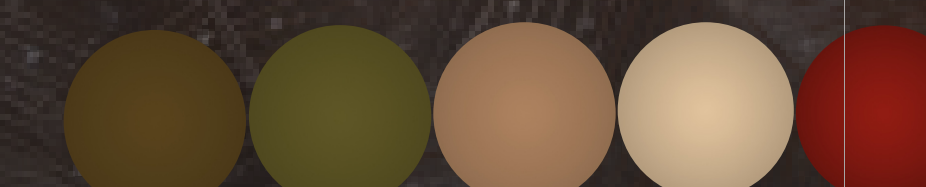

SITE ANALYSIS

Nestled in the heart of Faiyoum along Wadi El Raajan Road, Tache By The Lake is surrounded by a tranquil lake and golden sand mountains. The hotel offers breathtaking panoramic views that blend the serenity of the water with the timeless beauty of the desert, and is located approximately 150 km (around 2.5 hours by car) from Cairo International Airport.

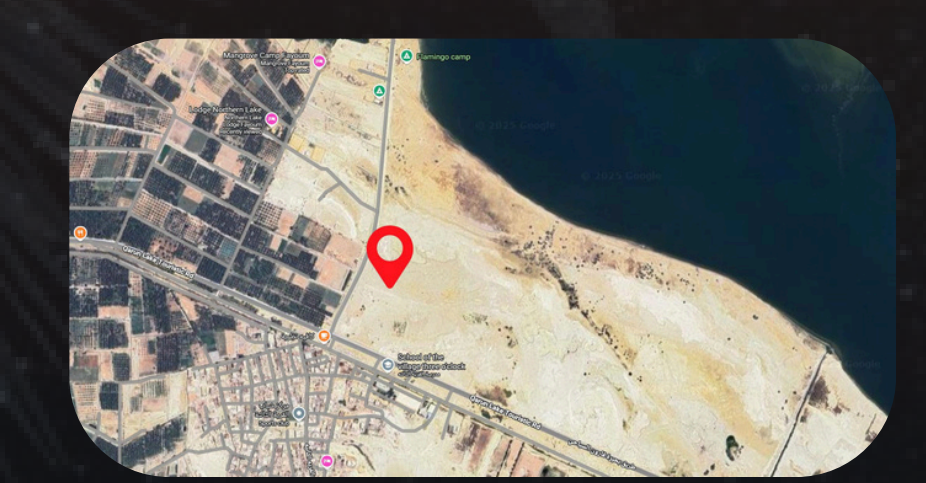

PHARAONIC HOLOGRAM

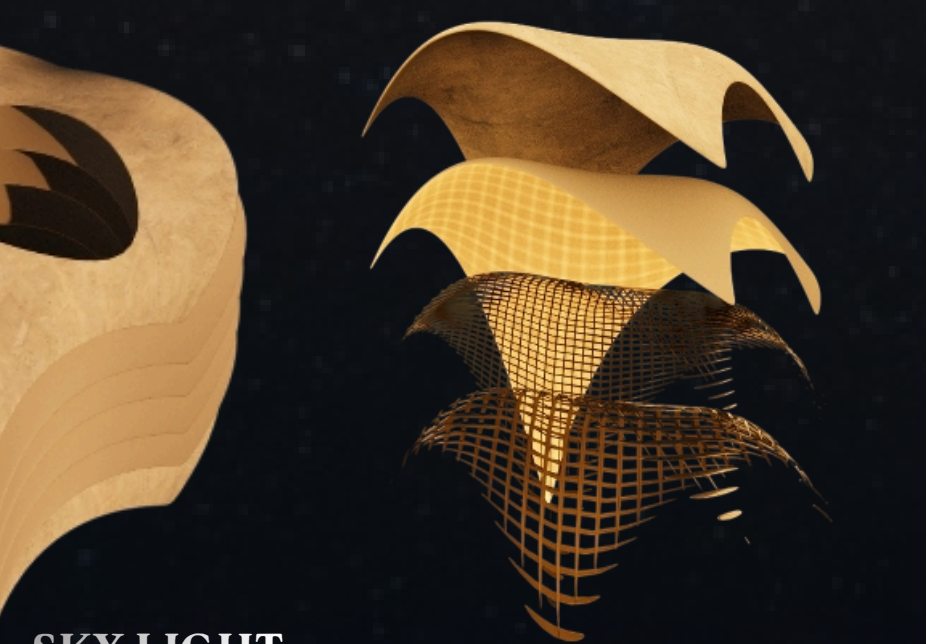

AMAZEIH LETTERS



PHARAONIC HOLOGRAM



STARS HOLOGRAM

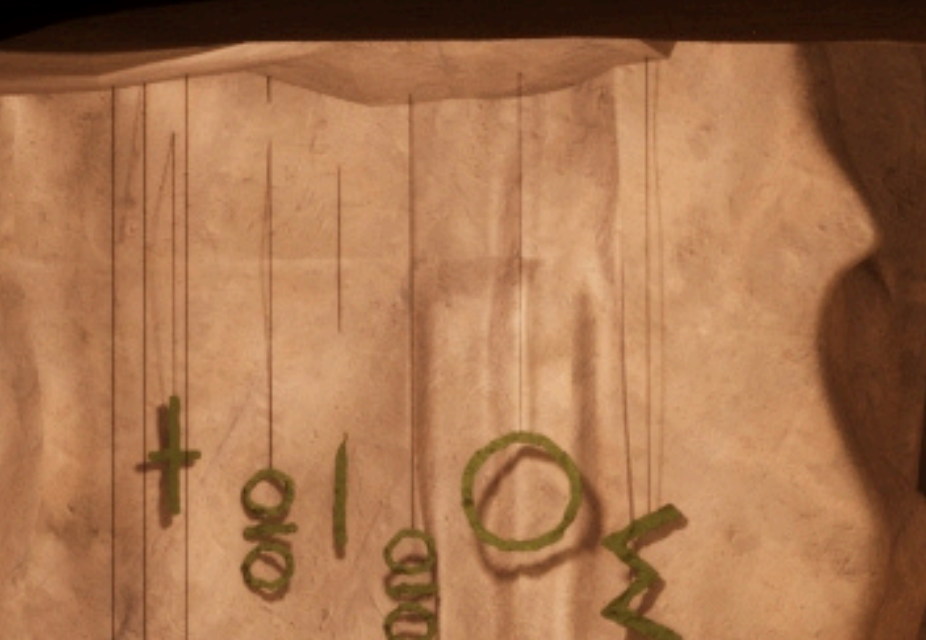

AMAZEIH LETTERS



PHARAONIC HOLOGRAM

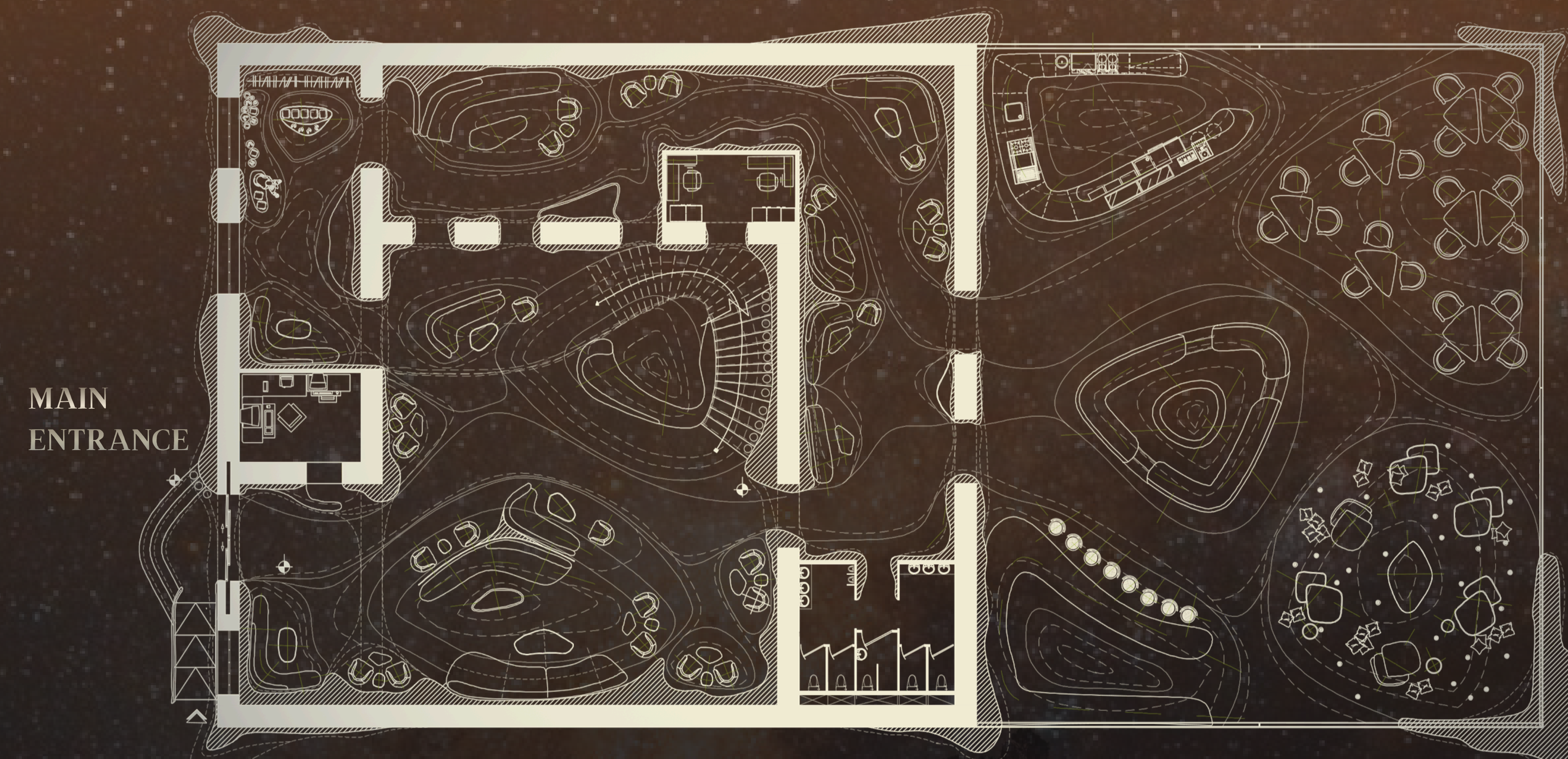
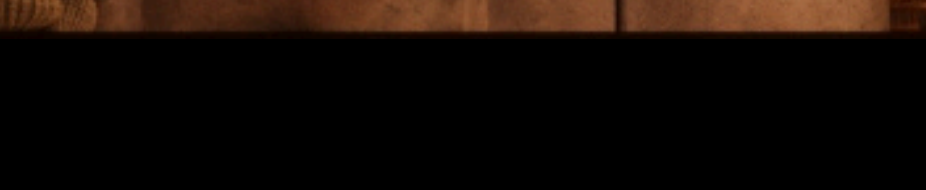

GRAND FLOOR SCALE 1:100



FIRST FLOOR SCALE 1:100



3D SHOTS



SECTION (A-A) SCALE 1:50