

Belgrade Marina Quarter

The site is located in Belgrade, in a former industrial zone by the river, with an existing marina. Today, the area is strongly shaped by road and railway infrastructure, which creates both physical and visual barriers. At the same time, however, it has significant development potential thanks to its waterfront position, existing greenery and good accessibility.

The urban proposal focuses on transforming the brownfield into a mixed-use urban district with a predominantly residential character, complemented by civic amenities, services, cultural, sports and work-related functions. The spatial structure of the area is based on an orthogonal grid of urban blocks, which gradually becomes more open towards the river, transforming into a pavilion-like development that responds to the natural surroundings.

The key public space is a waterfront square connected to the river and the marina, complemented by a park and a network of public spaces and pedestrian routes. The mobility concept prioritizes walking and cycling, while the former railway line is transformed into a linear recreational axis. The area is further connected through a system of pedestrian bridges.

The proposal allows for phased development and creates the conditions for long-term sustainable growth, as well as for the integration of the area into the wider urban environment.

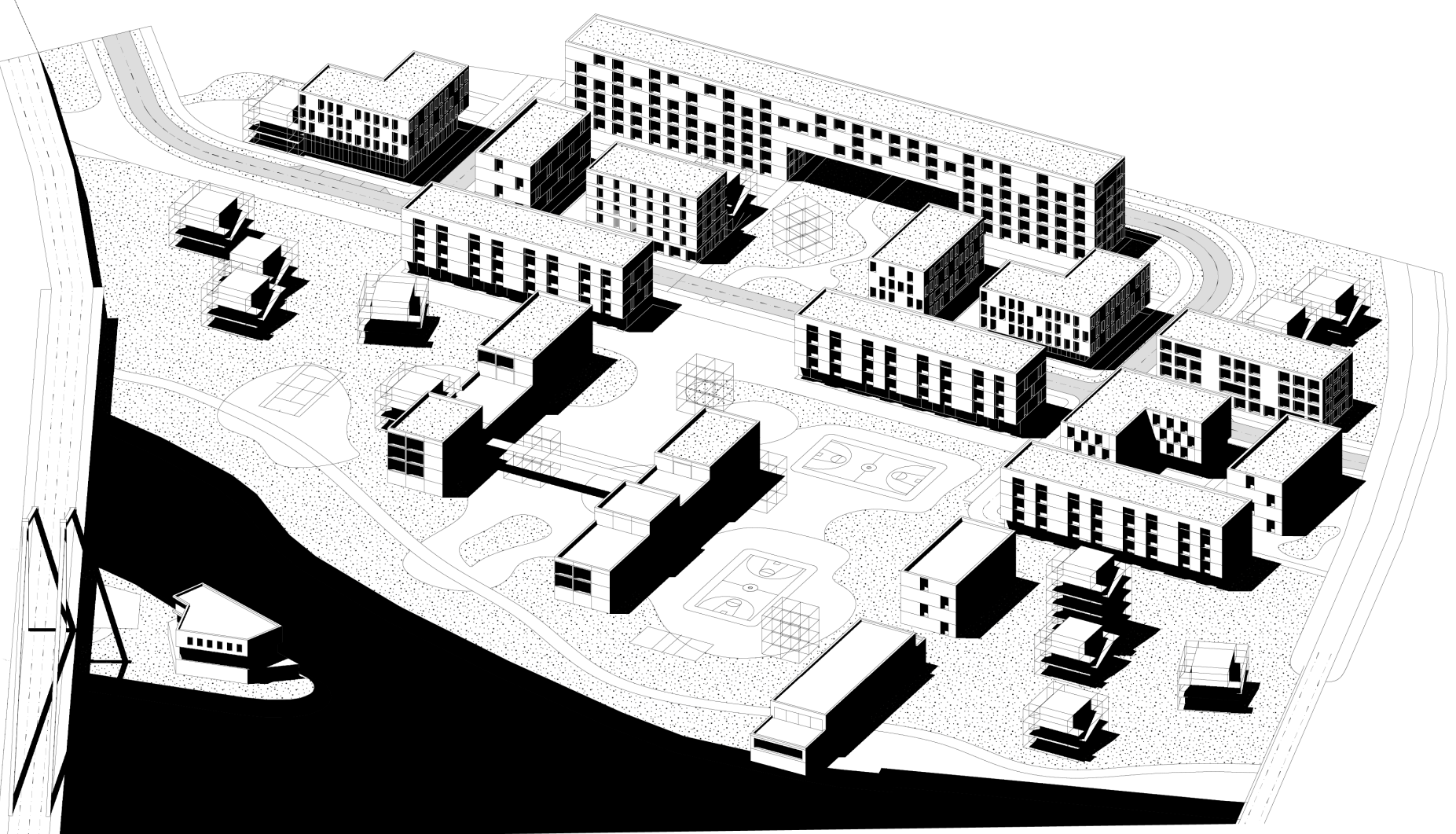
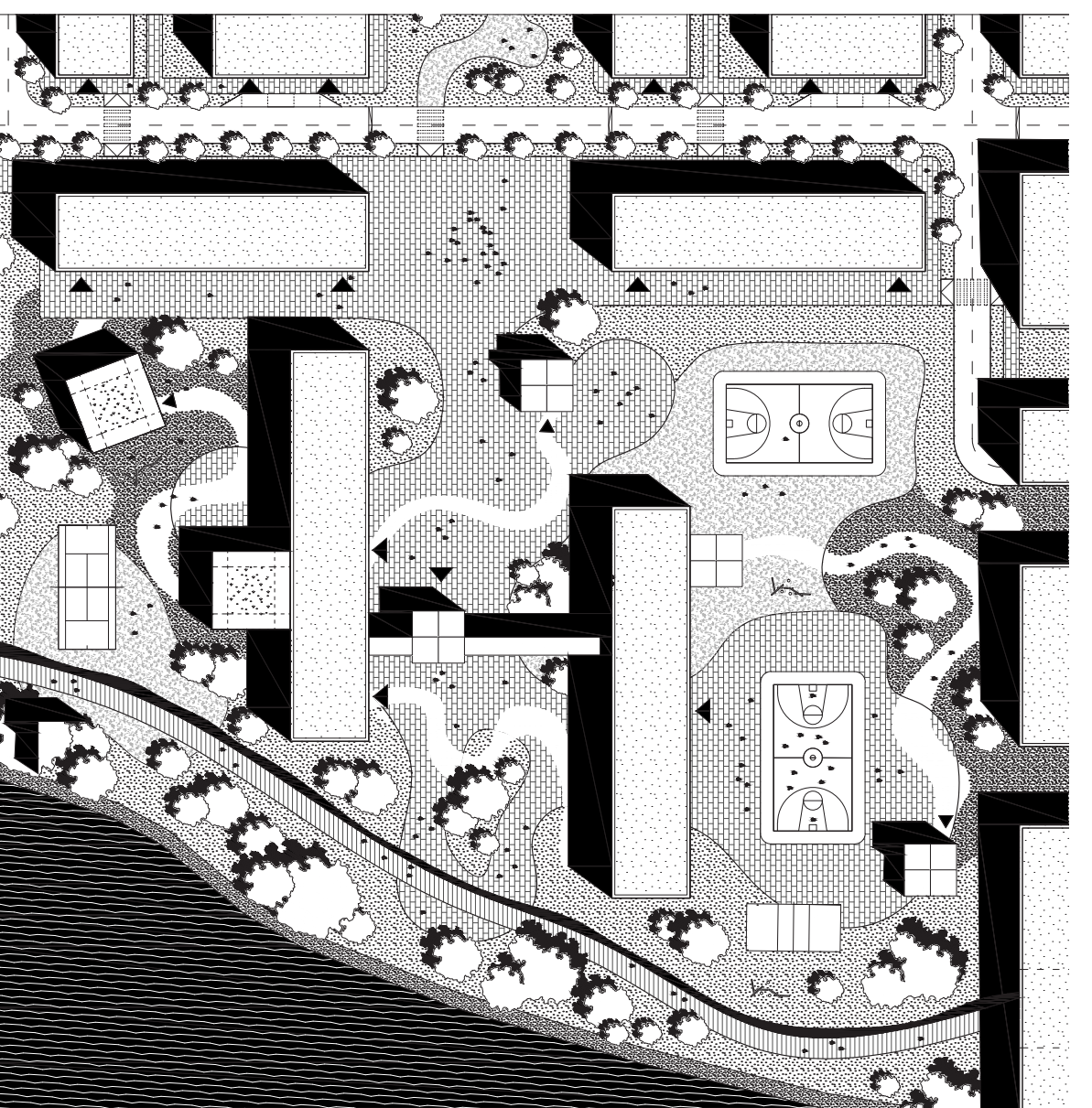

Existing Condition
/diverse built structure, uncoordinated greenery, unused areas/

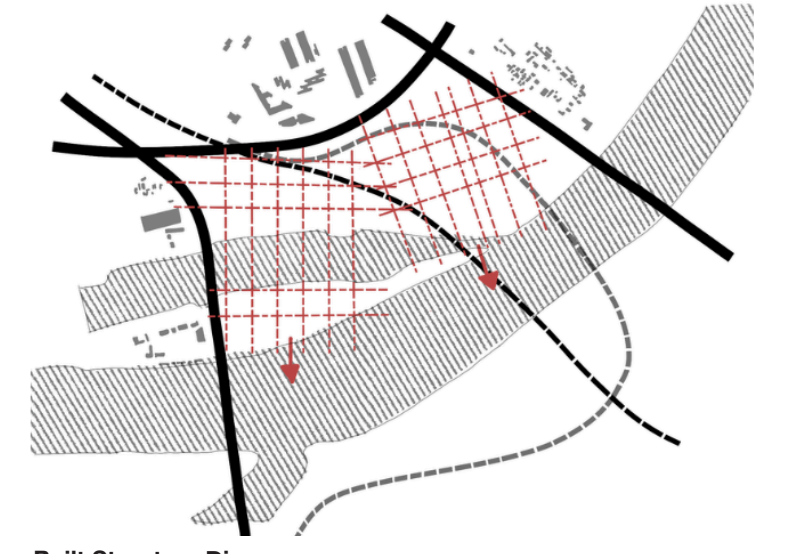

Built Structure Diagram
/based on the existing surrounding urban structure + orientation towards the water/

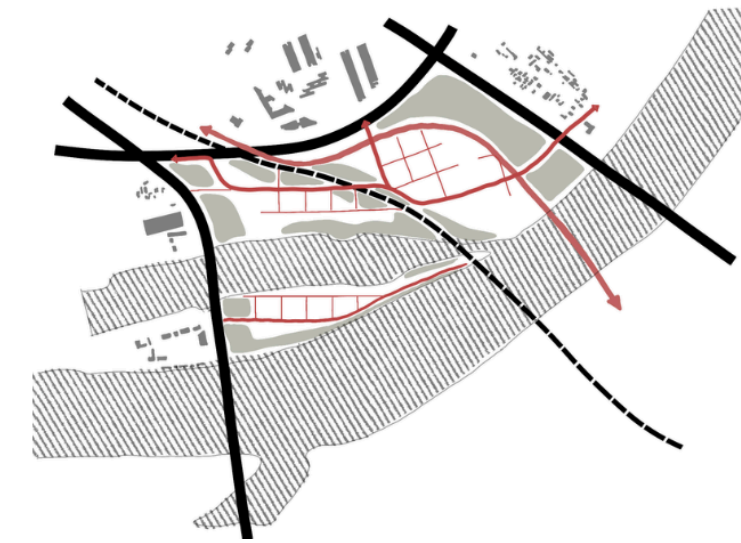

Transport and Greenery Diagram
/using greenery as a barrier between high-speed roads and housing, unifying road access within the site/

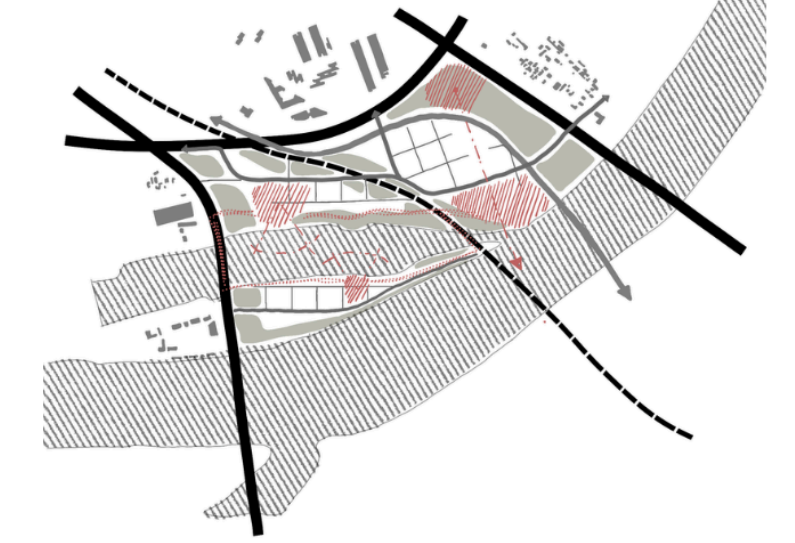

Diagram of Central Points
/connecting the area through pedestrian routes along the waterfront and bridges linked below the existing bridges/

