



جامعة بيروت العربية
BEIRUT ARAB UNIVERSITY
Faculty of Architecture
Design & Built Environment

NAME: JANA BARAKE
ID: 202104071

The abandoned aquarium tower that was once envisioned as Lebanon's first window into the marine world remains a silent manara, suspended between interrupted ambition and unrealized communication.

Revitalizing the Batroun Aquarium



WHERE SILENCE BECOMES SIGNAL

Batroun Map



Site Location

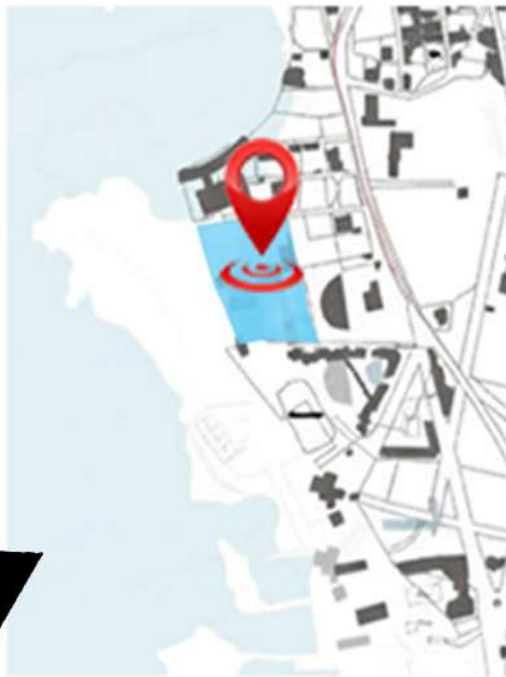

LONG STANDING TOWER



VIEW FROM TOP



VIEW FROM STRUCTURE



PANORAMIC VIEW



VIEW FROM GROUND

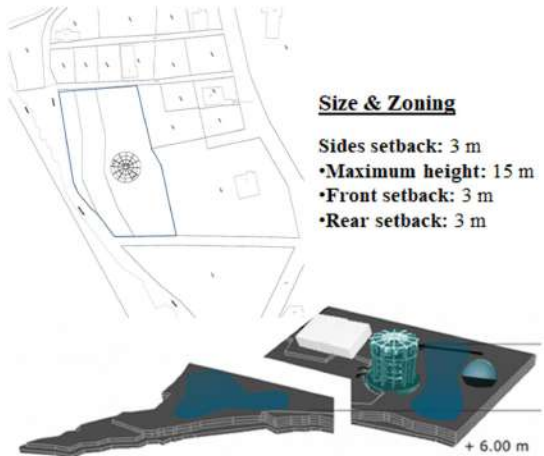

Size & Zoning

- Sides setback: 3 m
- Maximum height: 15 m
- Front setback: 3 m
- Rear setback: 3 m

Land Area: 7,350 m²

Zoning: 50/200

- Maximum buildable area per floor 3,675 m².
- (200)-Maximum total area 14.700 m².



VIEW FROM TOP



VIEW FROM STRUCTURE



- Architectural Uniqueness
- Cultural Importance
- High Visibility
- In front of seaside
- Extreme Deterioration
- Outdated Design for Current Use
- Coastal Humidity
- Abandoned Structure
- The main tourist destination
- Creation of the Marine Center
- Support from the Public and Media Attention
- Planned for demolition
- Economic and Political Crisis
- Degradation of the Environment

Aquarium	Research	Entertainment	Educational	Administration	Services
Lobby	Food Preparation	Touch Pool	Classrooms	Reception	WC
Underwater Tank	Life Support Systems (water)	Turtle Pond	Training Rooms	Offices	Cleaning Room
Main Aquarium Tanks	Quarantine (sick animals)	Planetarium	Cafeteria	Meeting Rooms	Nurse
Aquatic Garden	Achieves	Activity zone	Resting Area	Co working Spaces	Security
VR projector Zone	Laboratories	Workshops	Projection Rooms	Copy and mail room	Mechanical Room
Cafeteria	Co working Spaces			Co working Rooms	Changing Rooms
	Lecture Halls				Staff rooms

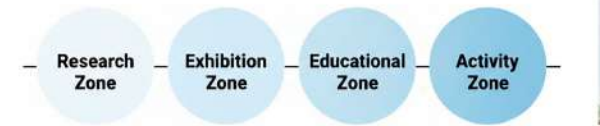

From silence to signal

The project investigates how architecture can transform hidden forms of communication meaning sound, vibration, rhythm, and distance into spatial experiences. The tower serves as the central anchor, with surrounding spaces arranged to reflect varying intensity, where proximity, height, and density correspond to how communication diminishes or changes over distance.

Keywords: Continuity, Tangible Translation, Radial Organization, Primary and Secondary Massing, Spatial Hierarchy, Contextual Anchoring.

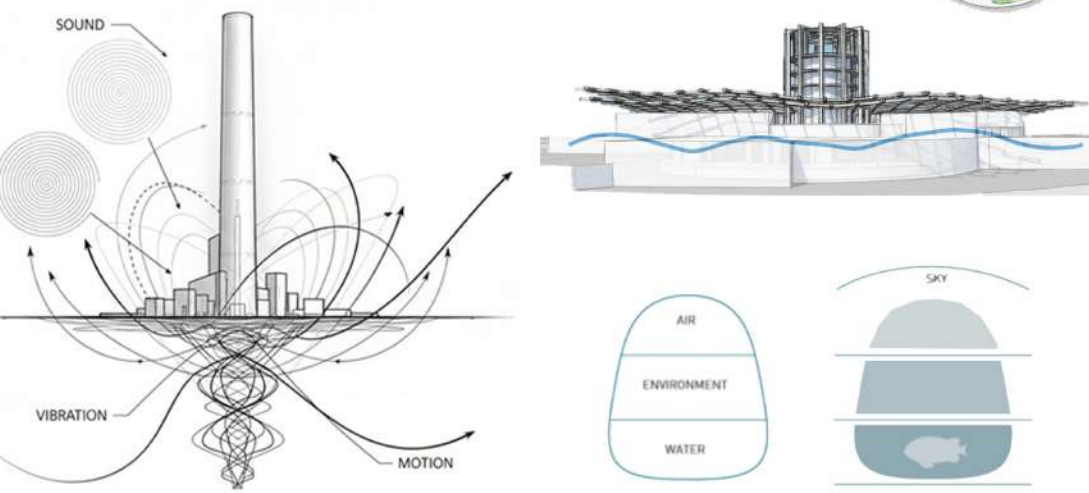

LAYOUT



CONCEPT GENERATION

The concealed ground. The extensions are not meant to compete, instead, they dissolve into the continuous architectural skin which is a mesh that unifies into one subtle ground condition, rather than reading as separate volumes, they become a field beneath the tower.

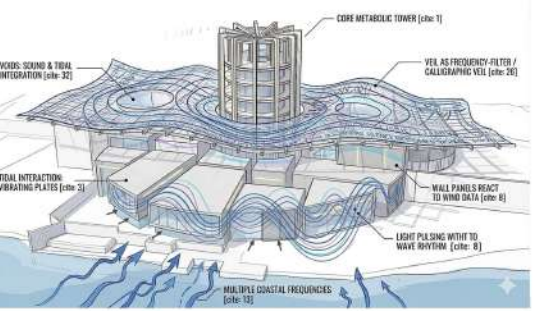

1. EXISTING SITUATION

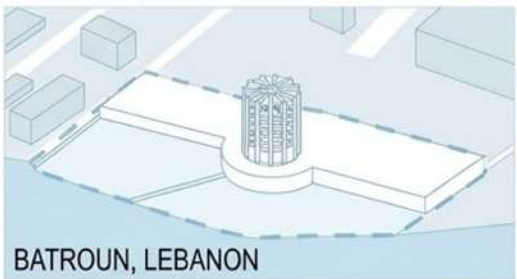

2. MASSING ADDITION

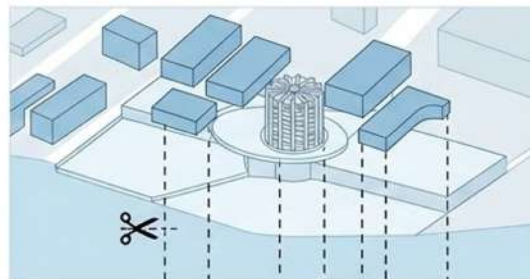

3. CONCEPT LAYERING

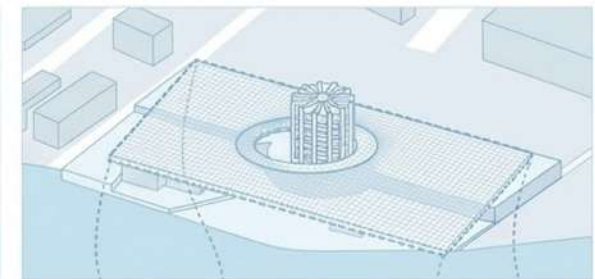

4. SITE CONNECTIVITY

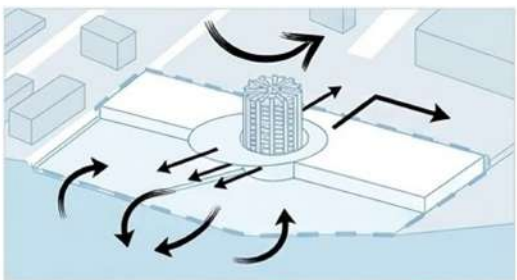

5. FOOTPRINT EXTENSION

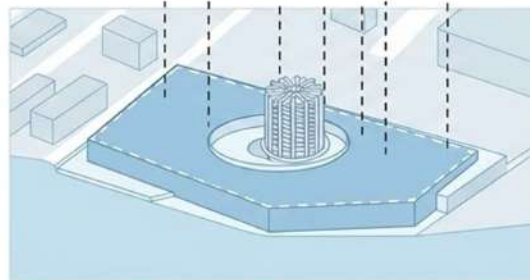

6. ARTICULATED CANOPY



GROUND FLOOR PLAN

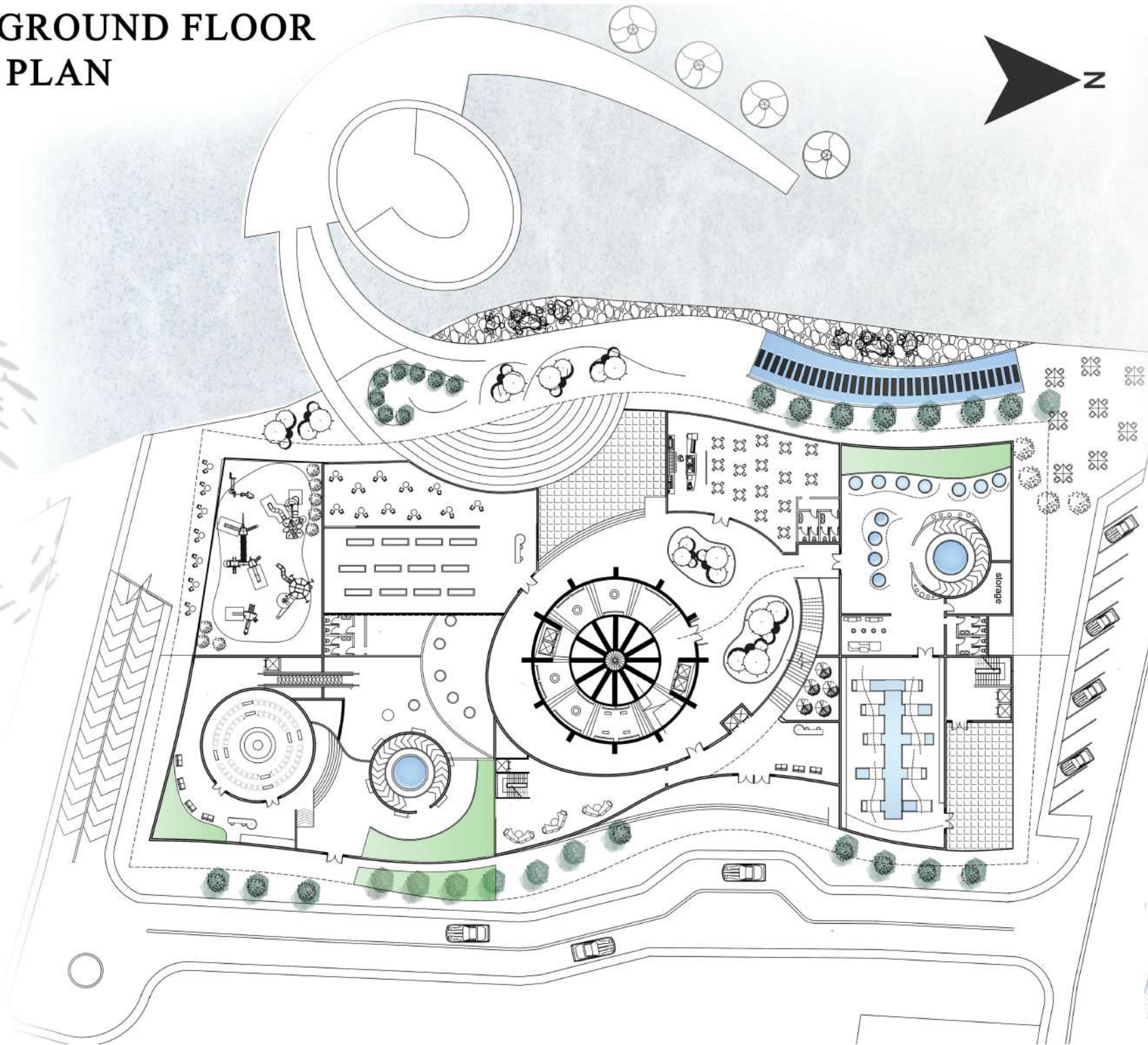

ZONING

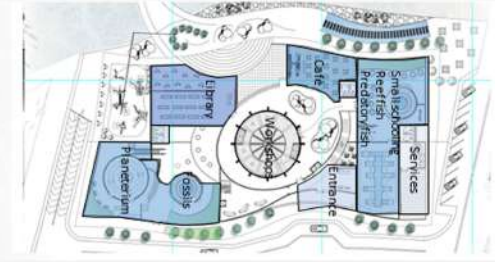

CIRCULATION

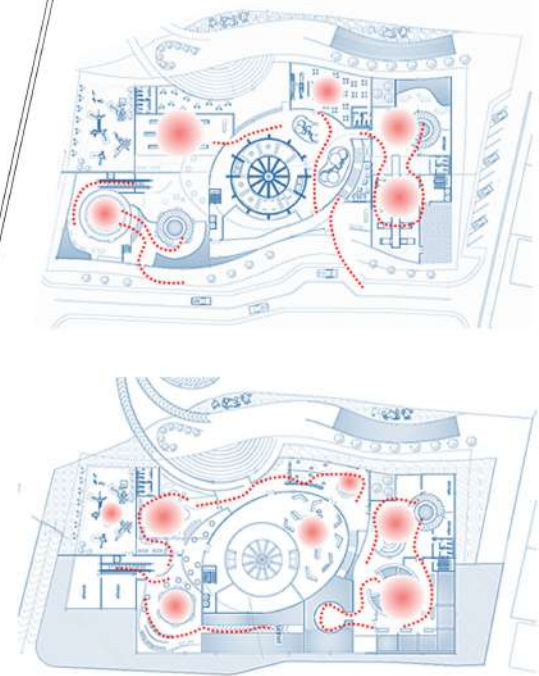

BASEMENT 1 PLAN (-4)

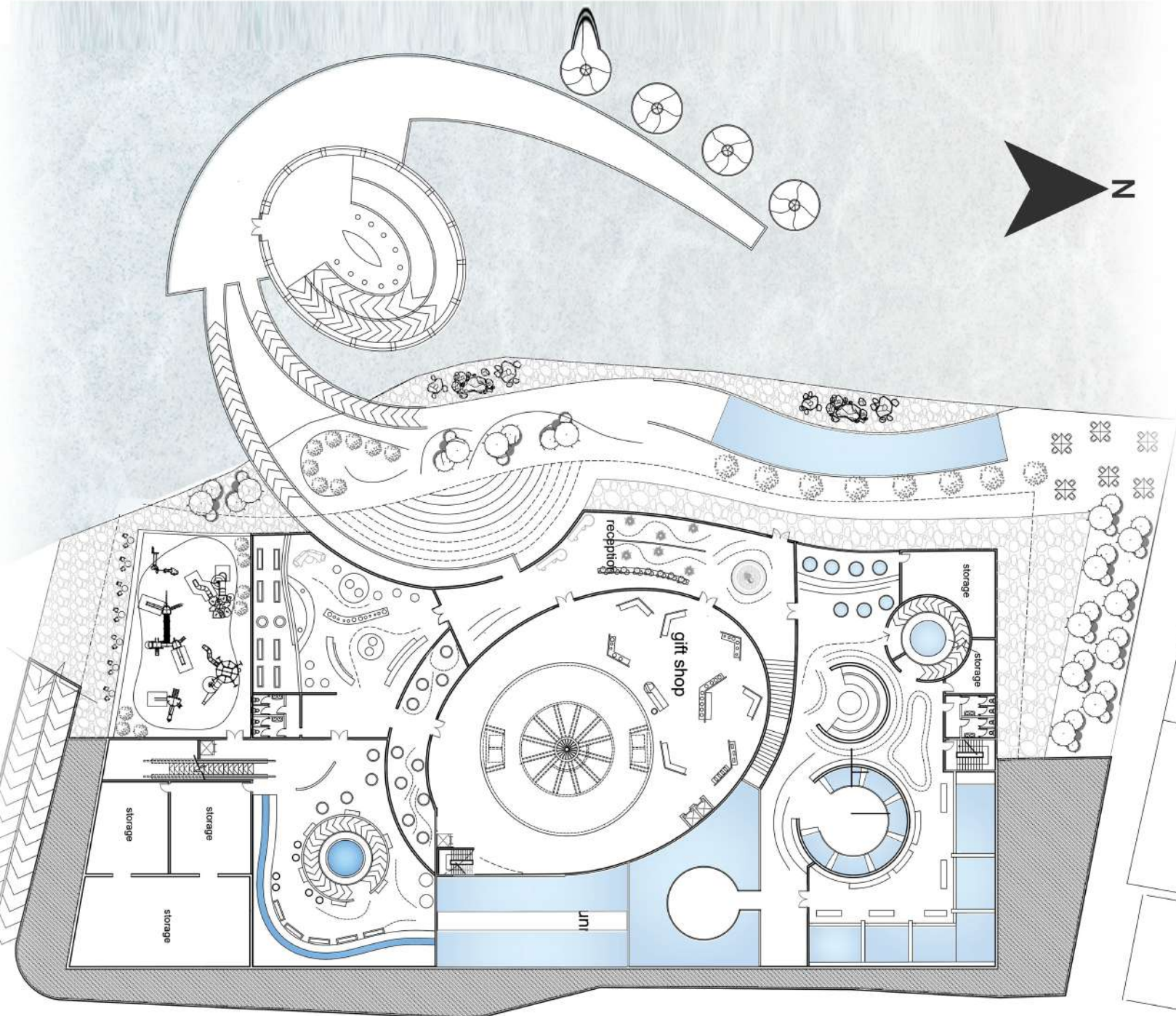

ZONING

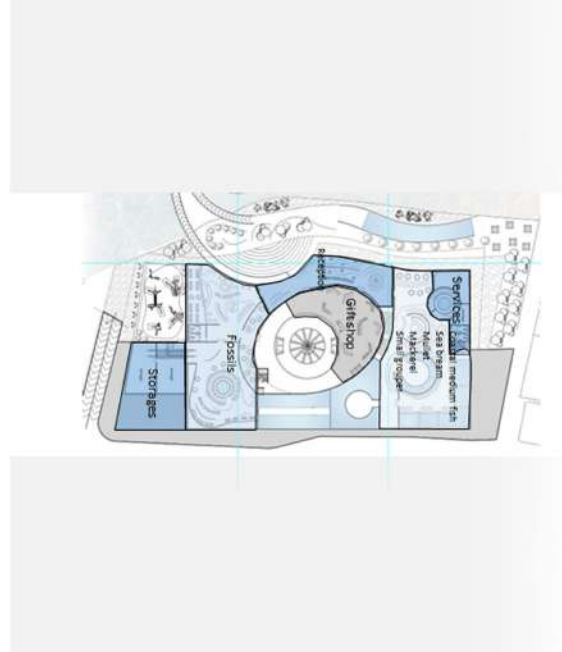

FIRE STAIRS/ RAMPS

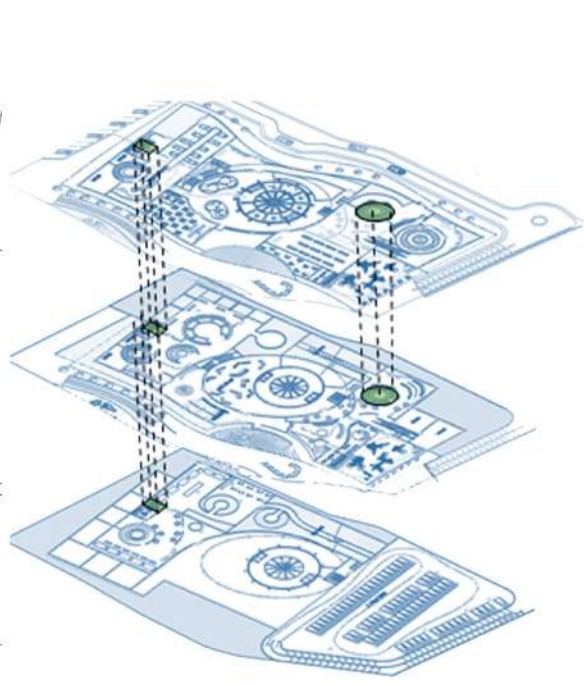

BASEMENT 2 PLAN (-8)

ZONING

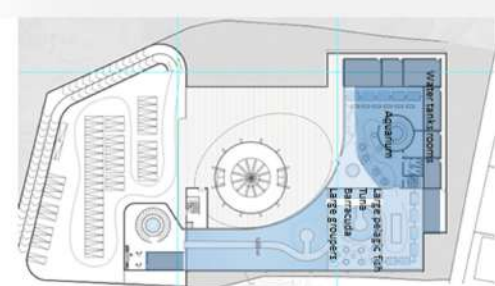
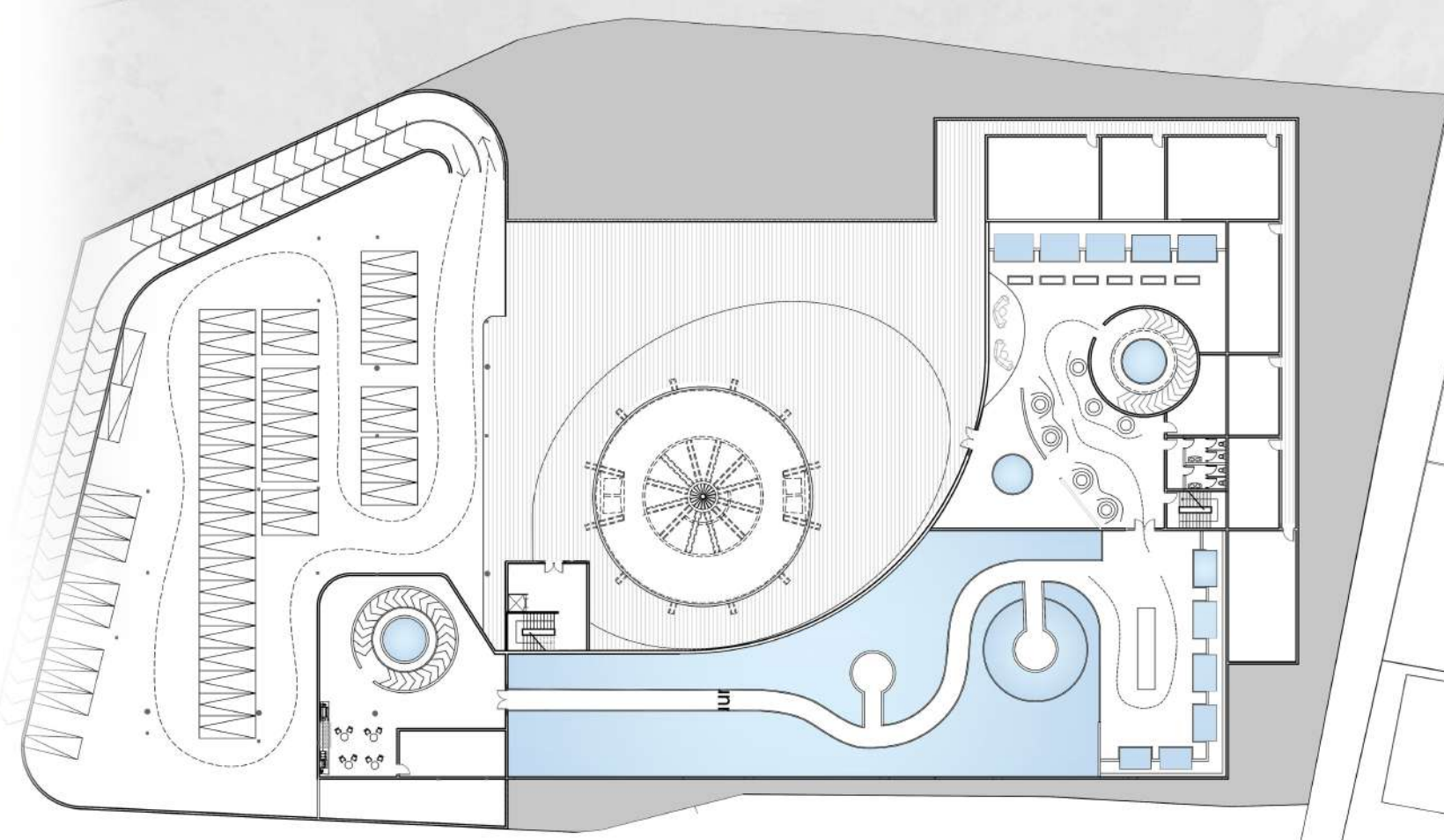

CIRCULATION

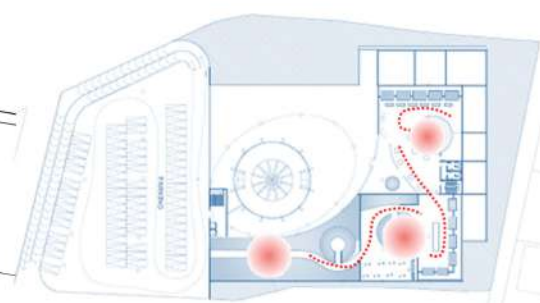
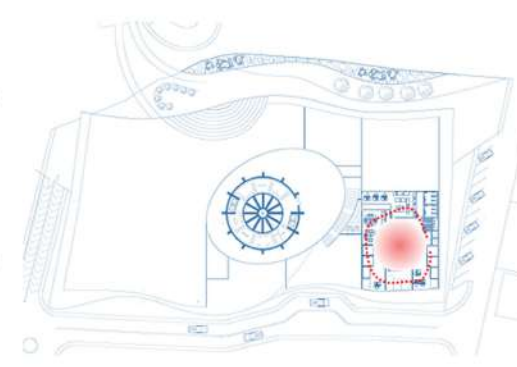

FIRST FLOOR PLAN +4

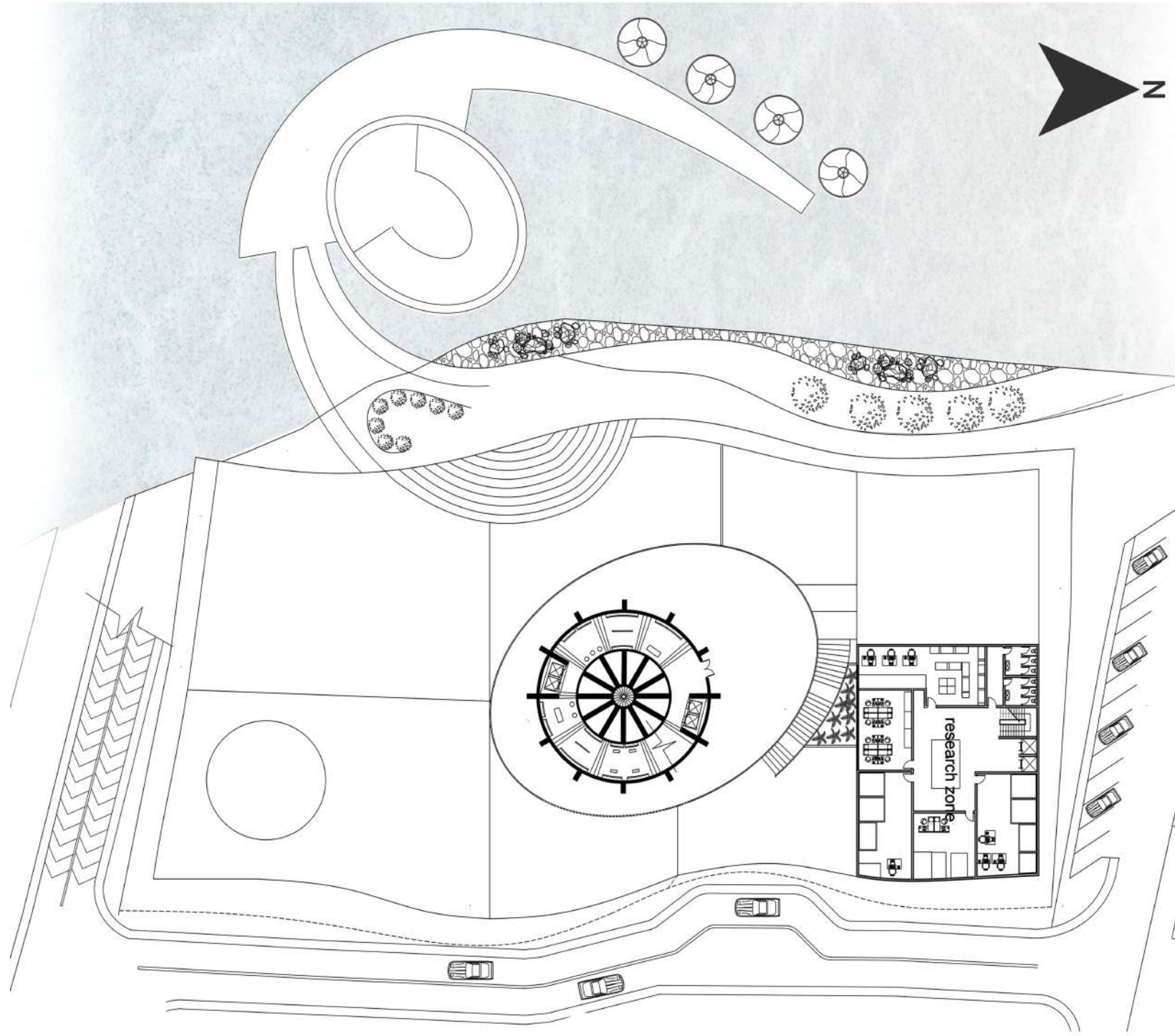

ZONING

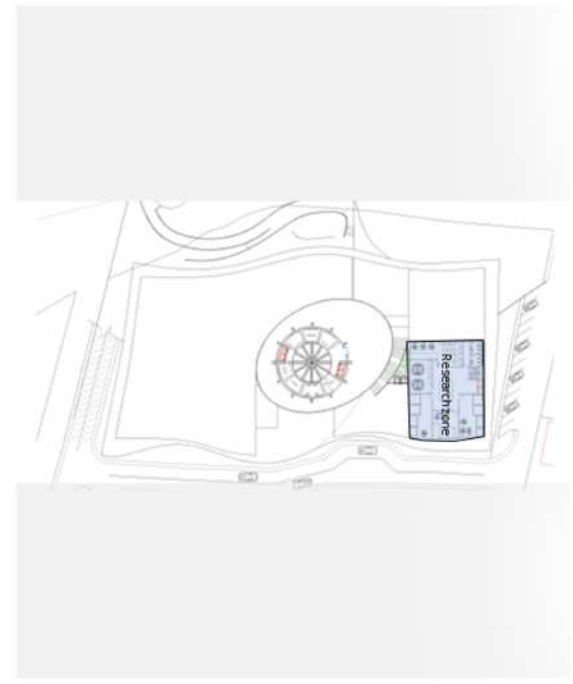

FIRE EXITS

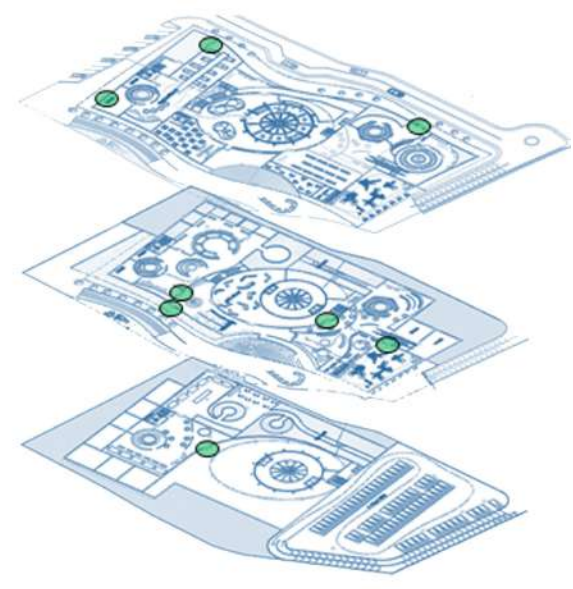

EAST SECTION



EAST ELEVATION



WEST SECTION



WEST ELEVATION



PERSPECTIVES





