

ZONE ZERO

Proposed Penal Colony in Corregidor Islands, Philippines

In the Philippines, dehumanization begins when a Person Deprived of Liberty (PDL) steps inside its one of the severely overcrowded prisons in the world. Here, imprisonment is not the only punishment, but the line between justice and suffering begins to blur. With a rate of 149 per 100,000 people, the Philippines ranked among the highest incarceration rates in Asia and the world. Hence, prisons are packed with people more than its intended capacity, reaching a congestion rate of 322 percent.



Can the walls of punishment rise to a point of reset?



SITE CONTEXT

Metro Manila is home to the largest and most overcrowded correctional facilities in the Philippines. Two of the longest-standing institutions, the Manila City Jail and the Quezon City Jail, continue to operate far beyond their intended capacities. Meanwhile, newly built penal facilities in the region face the same fate. Rapid population growth and severe land scarcity in the metro only worsen these challenges, leaving little support for upgrading and expanding existing prisons.

METRO MANILA PENAL INSTITUTIONS

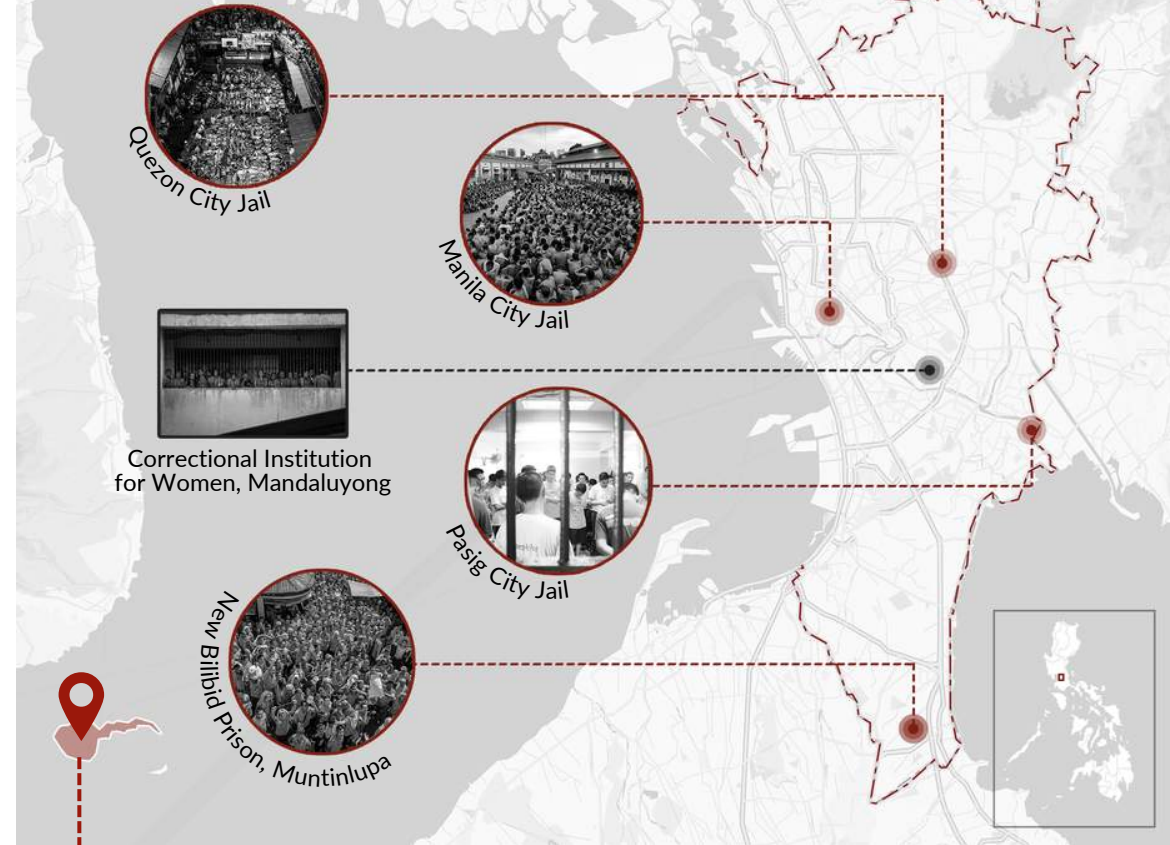

THE SITE: CORREGIDOR ISLAND

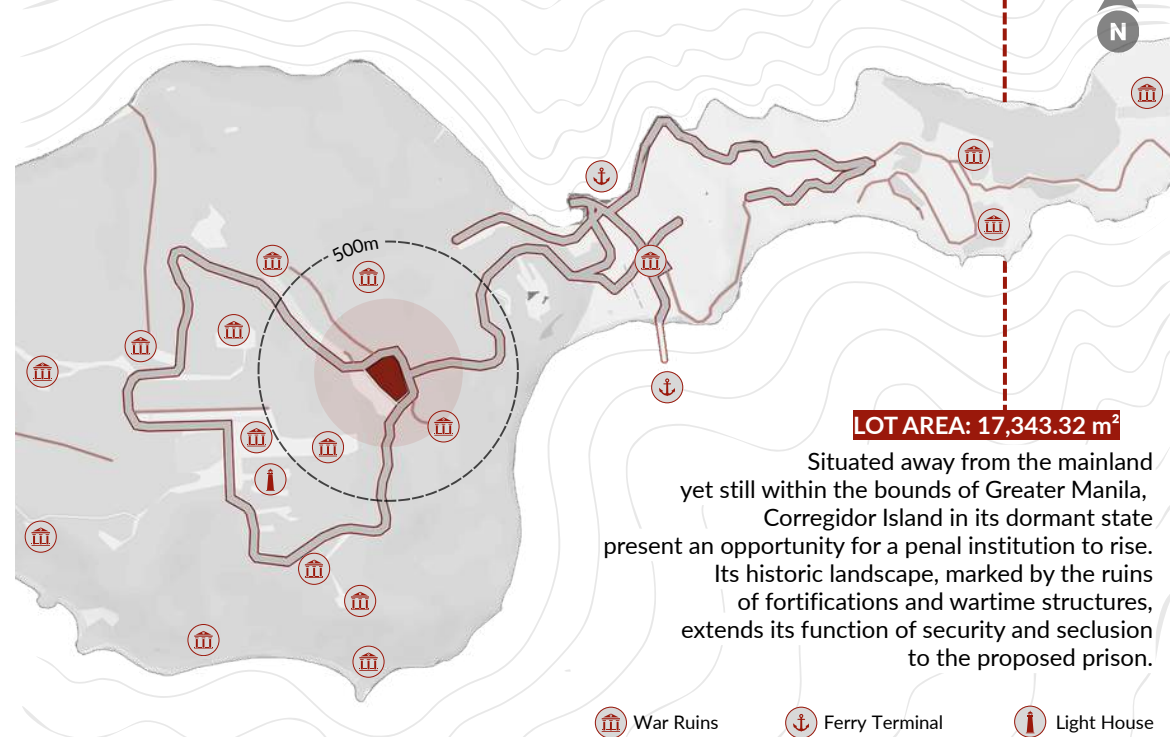

SITE ANALYSIS

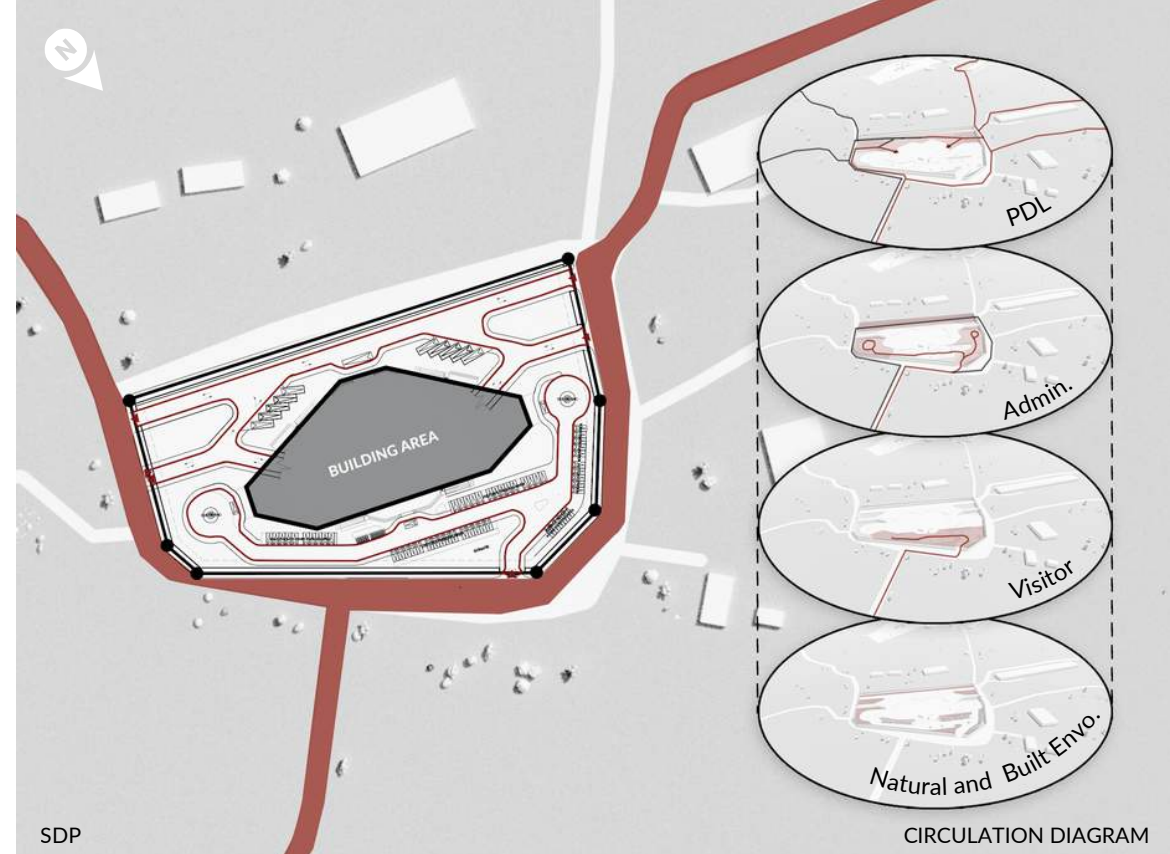

URBAN CHALLENGES

This failure of humanity stems not only to the social and judicial aspects, but its very own architecture. The design of Philippine prisons still followed the traditional and horizontal model of Panopticon - a circular prison system that prioritizes surveillance over assistance, fear above care, and order beyond opportunity. In this architecture of fear, the human soul is reduced to a silhouette under constant watch, never free to unfold, never safe to be unseen. It is not just the body that is confined, but the possibility of redemption, stripped away under the cold gaze of surveillance. This environment is not conducive to rehabilitation. Instead, it contributes to a sustained recidivism rate near 50 percent and a continuous cycle of re-offending. This punitive influence undermines the true purpose of incarceration, failing not only the offenders but the society it claims to protect.

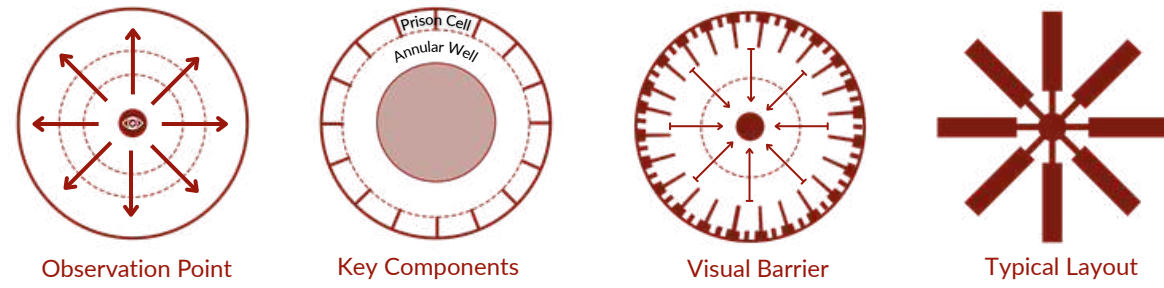

ANTI-PANOPTICON PRISON SYSTEM

Envisioned as a 51-story structure that separates both men and women correctional facilities, Zone Zero is injected into the vertical prison as a decentralized, and multi-directional framework, featuring interconnected, hexagonal units that host various functions: recreation, livelihood, learning, and wellness zone. Instead of a central watch tower, the hexagonal core and transparent communal spaces promote spatial efficiency that reduce the feelings of fear and isolation, encouraging a better relationship between guards and inmates.

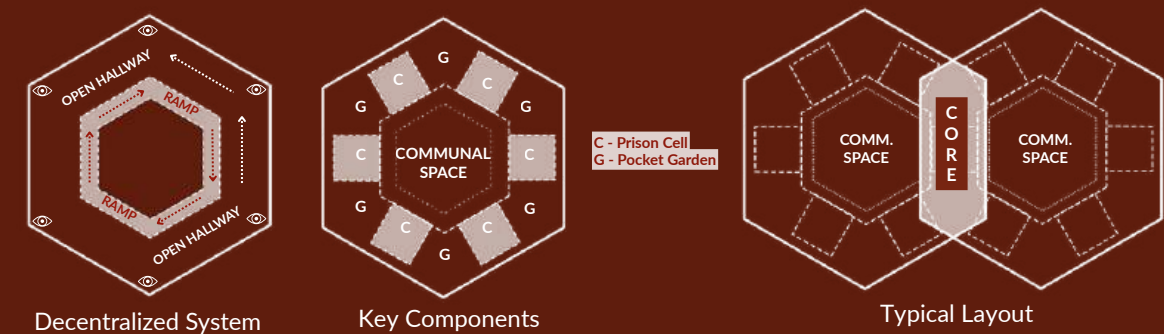

Rejecting the horizontal sprawl and isolation of conventional prisons, building upwards while uplifting the human spirits within offers a solution to decongest overcrowded jail facilities and reduce recidivism.

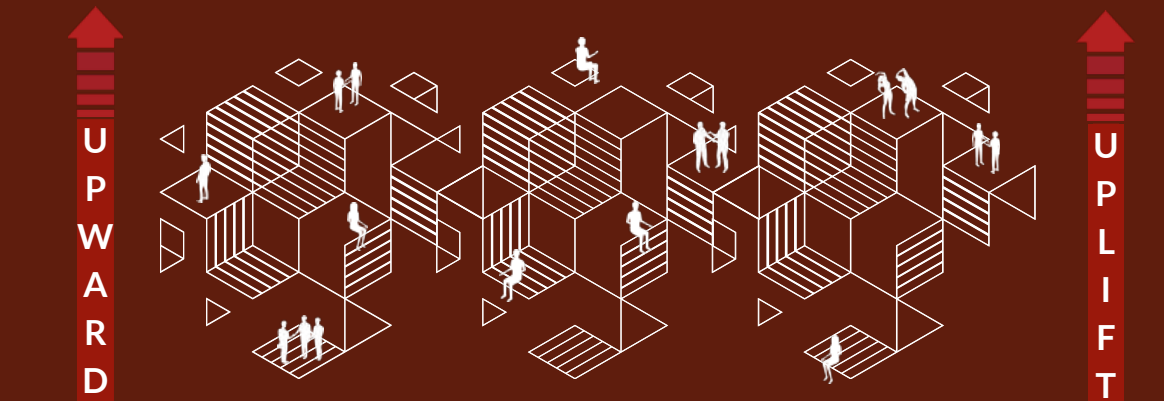

Zone Zero becomes the point of rebirth where everyone is no longer seen as a failed member of society but a living framework for renewal, restoration, and reintegration.

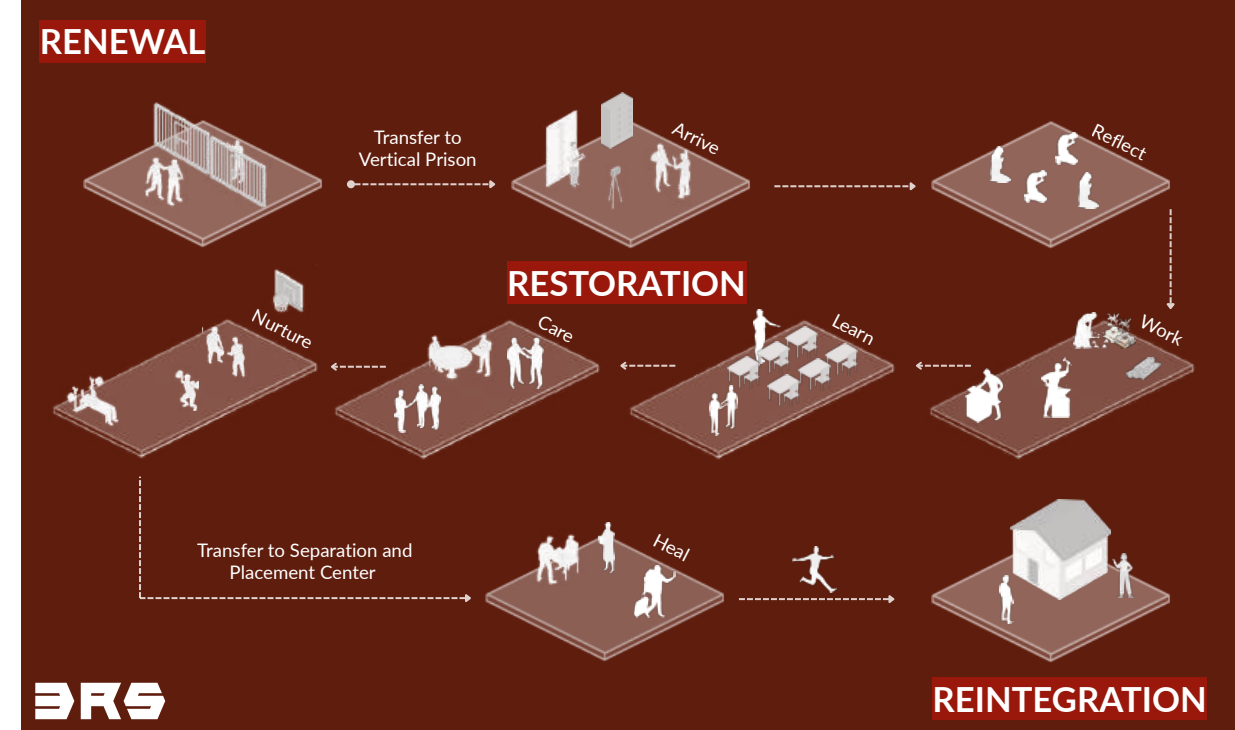

FORM EVOLUTION

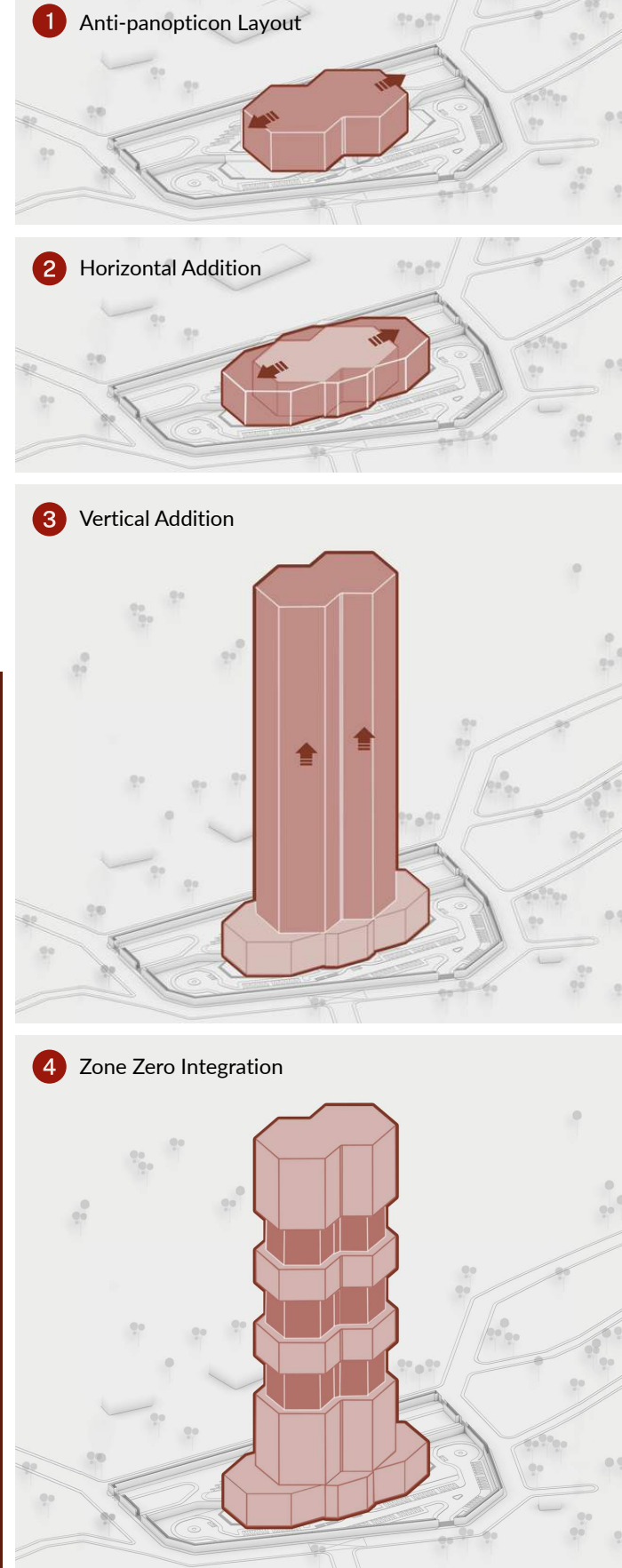

ZONING DIAGRAM

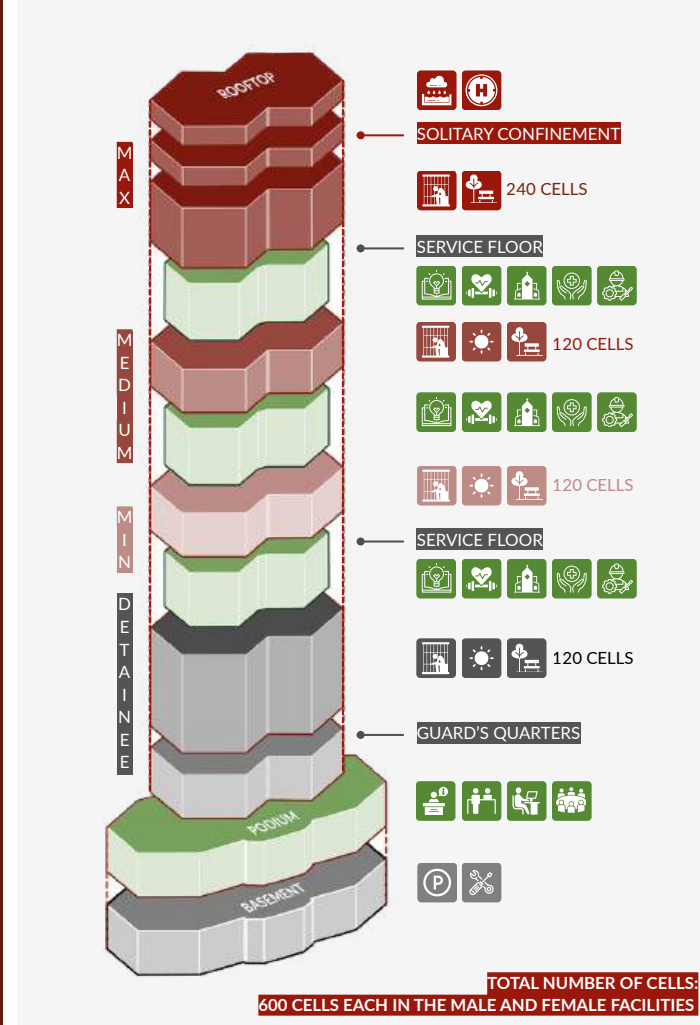

TYP. TOWER FLOOR PLAN

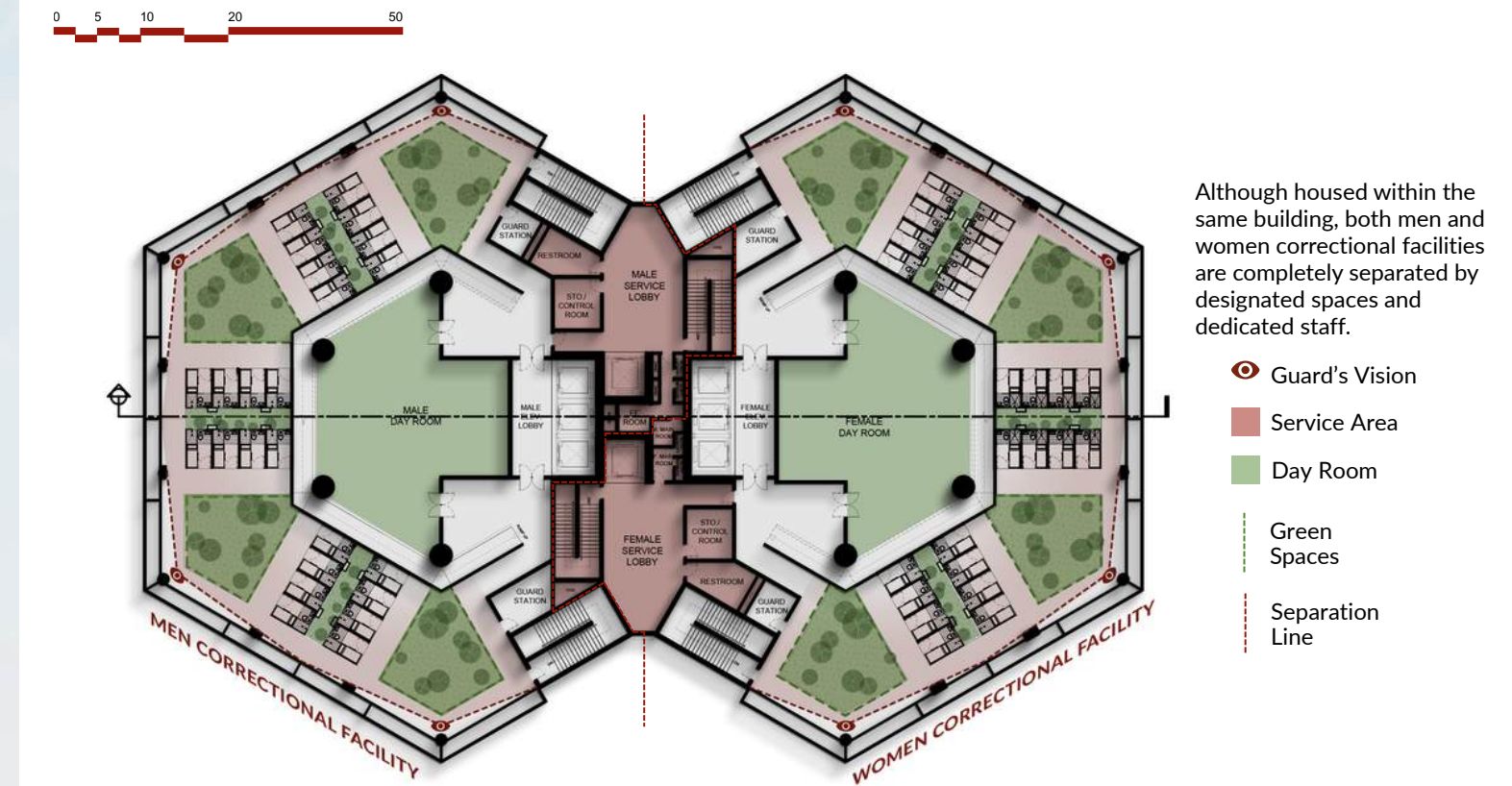

Inside every cell makes a living space for each inmate that embodies a humane design - one that is far from the harsh arrangement of a prison cell. A dignified living environment is ensured by incorporating multi-functional furniture and adaptable partitions that address basic needs.

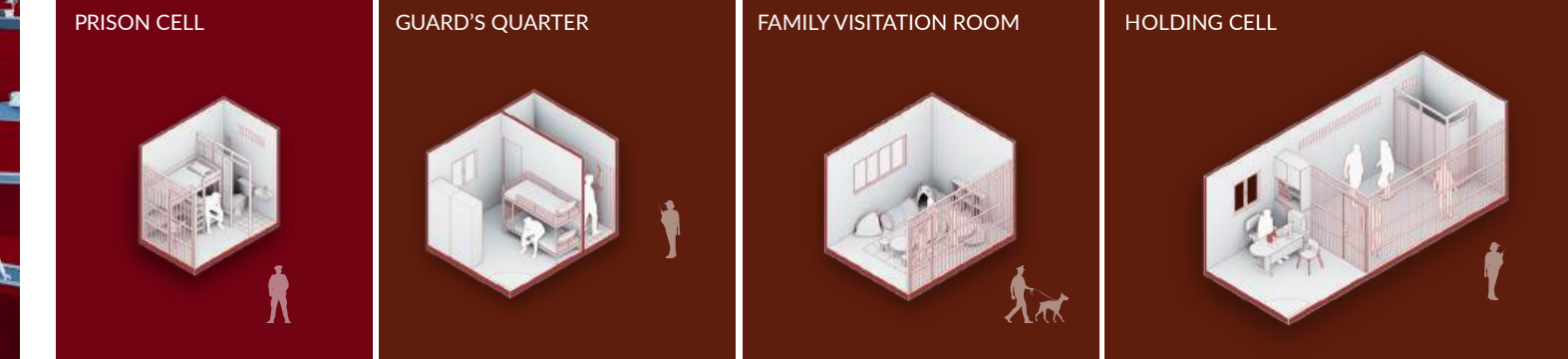

STRUCTURAL DIAGRAM

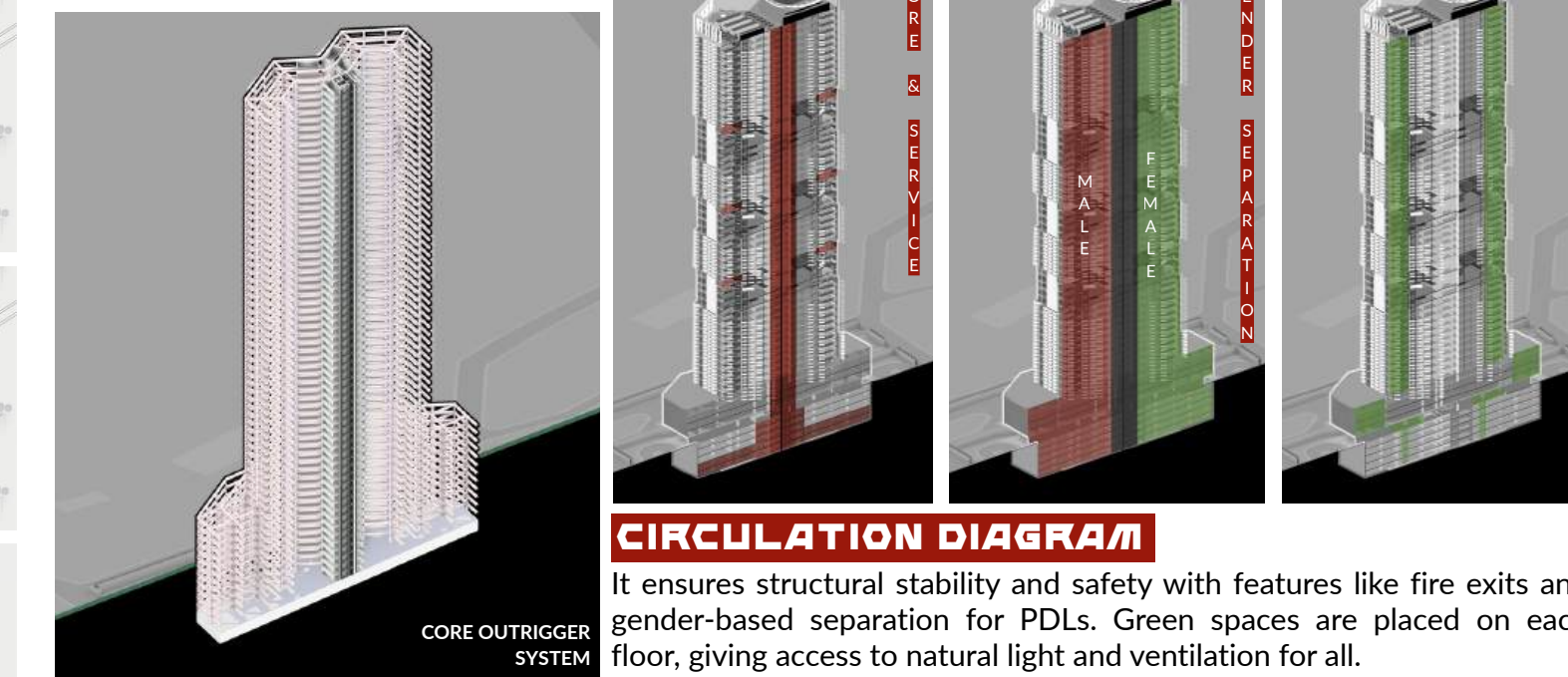

Zone Zero reimagines prison design by integrating transparent public zones and community-based monitoring within its structure, fostering trust, accountability, and a sense of shared responsibility.

RECREATION ZONE



LIVELIHOOD ZONE



LEARNING ZONE



WELLNESS ZONE



SECURITY RISK ZONE

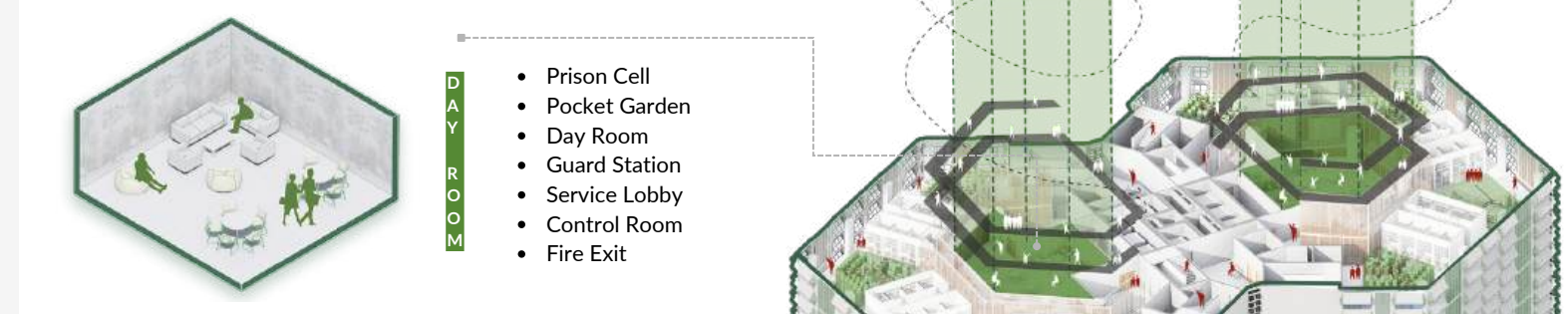

This vertical sanctuary rises as the very foundation of rehabilitation, redemption, and restorative justice in the Philippine prison.

BUILDING ENVELOPE AND TECHNOLOGY

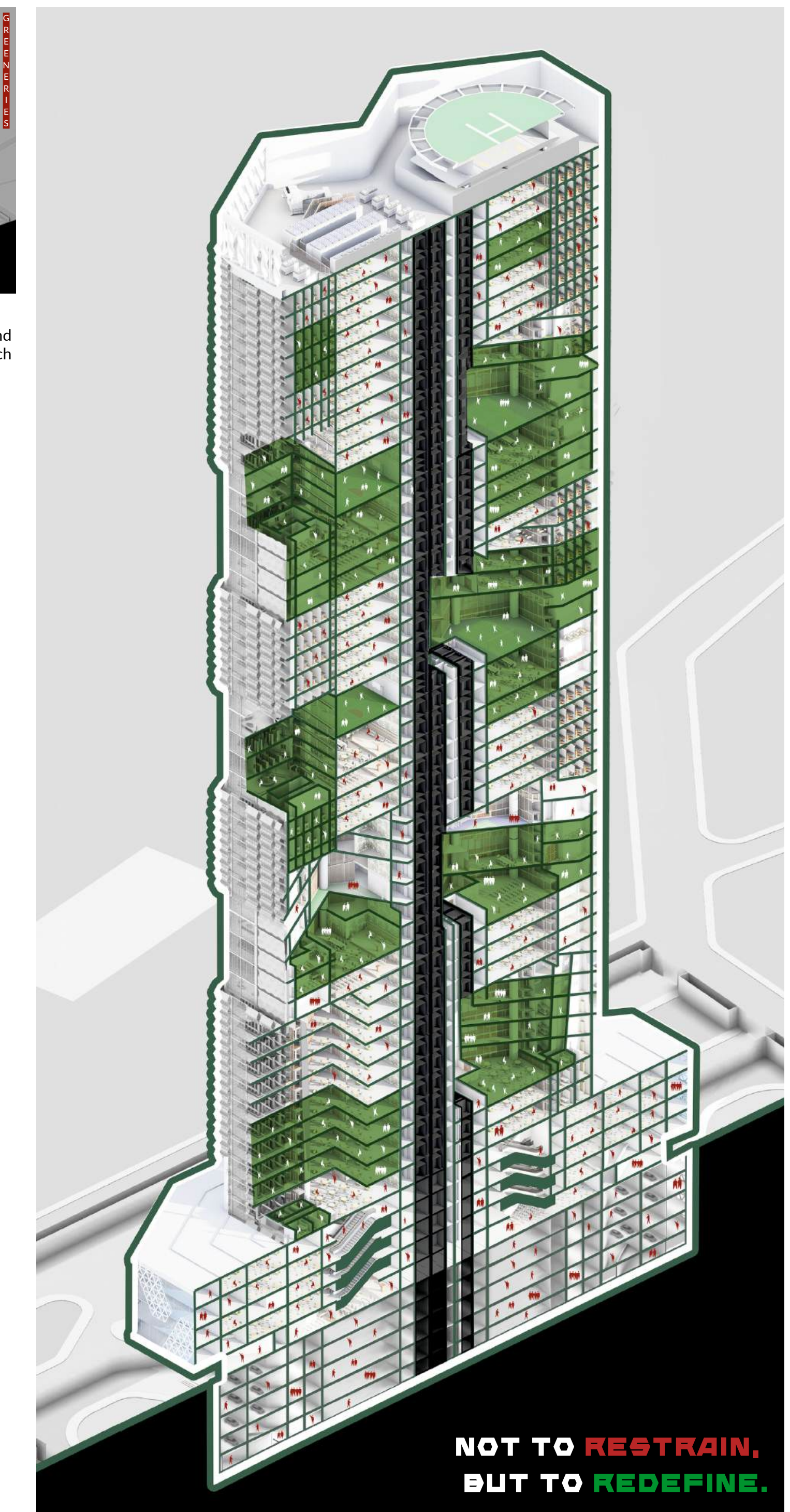
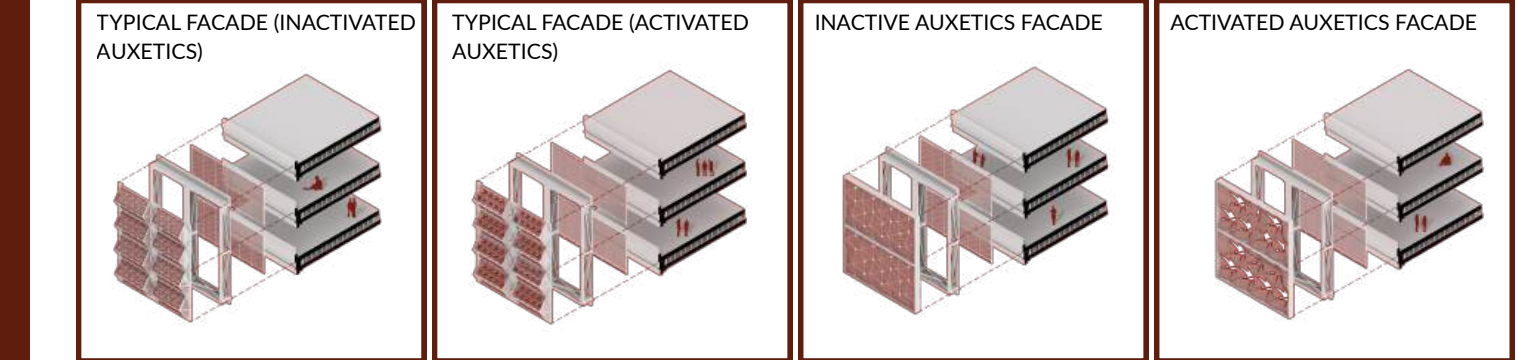
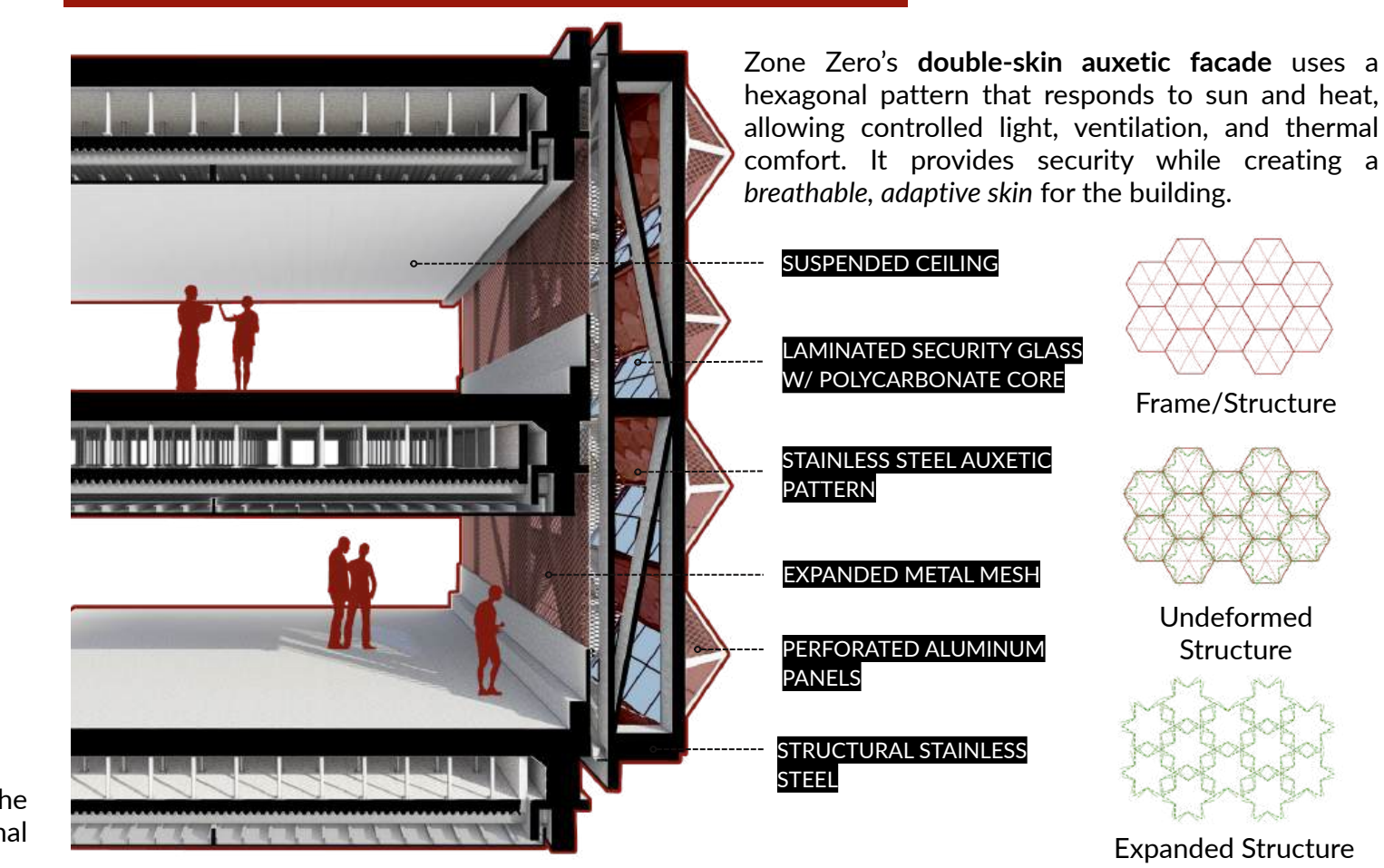

NOT TO RESTRAIN, BUT TO REDEFINE.