

Small-scale intervention for individuals or families that is easy to construct using locally-sourced materials

Semi-transparent sail fabric mesh canopy prevents water evaporation creating a comfortable environment for marine life.

The structure is directly connected and accessible to the local farmer and fishermen community.

Floating fishery units allow for fish breeding and growing crops simultaneously reversing land reclamation and fish farms.

# The Net Margin

"TAKE LESS, MAKE MORE.."

Historically, Lake Manzala has been a vital biodiversity habitat for aquatic life. Home to over 150,000 fishermen, Lake Manzala has been the primary source of livelihood for the local community. In recent years, Lake Manzala has faced major environmental challenges caused by anthropogenic influences.

**PROBLEM**

Lake Manzala has lost 63% of its natural wetland since 1972, due to land reclamation, illegal fish farms, and landfilling. As a result, Lake Manzala is facing habitat degradation, loss of marine life, and decline in local handcrafts and artisanal heritage.

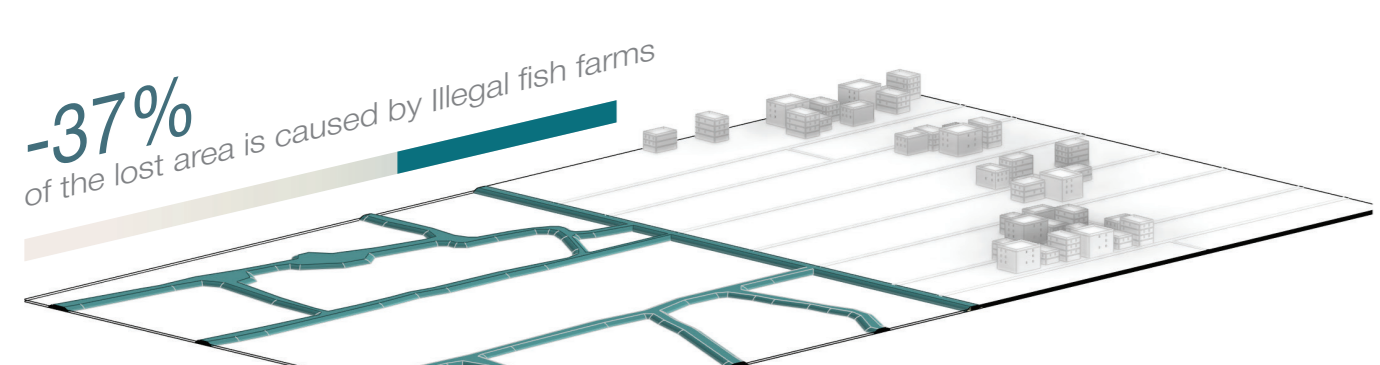
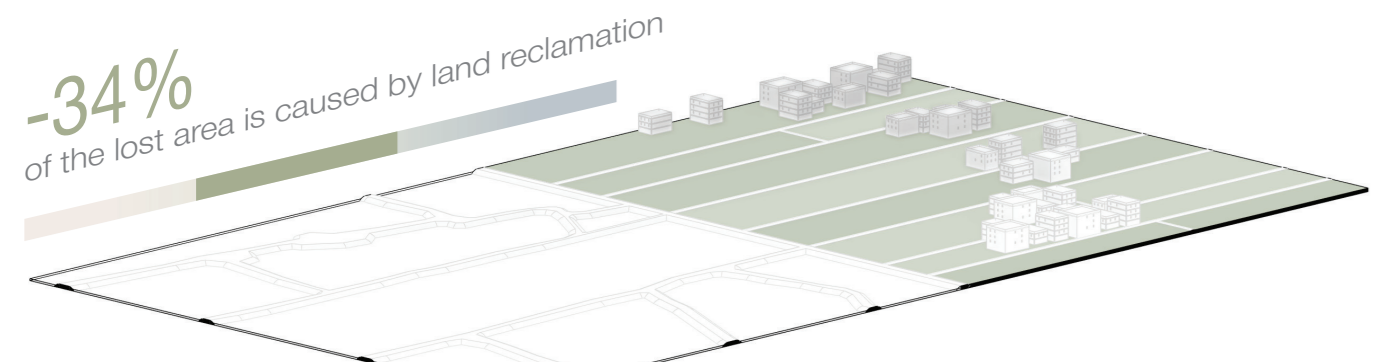
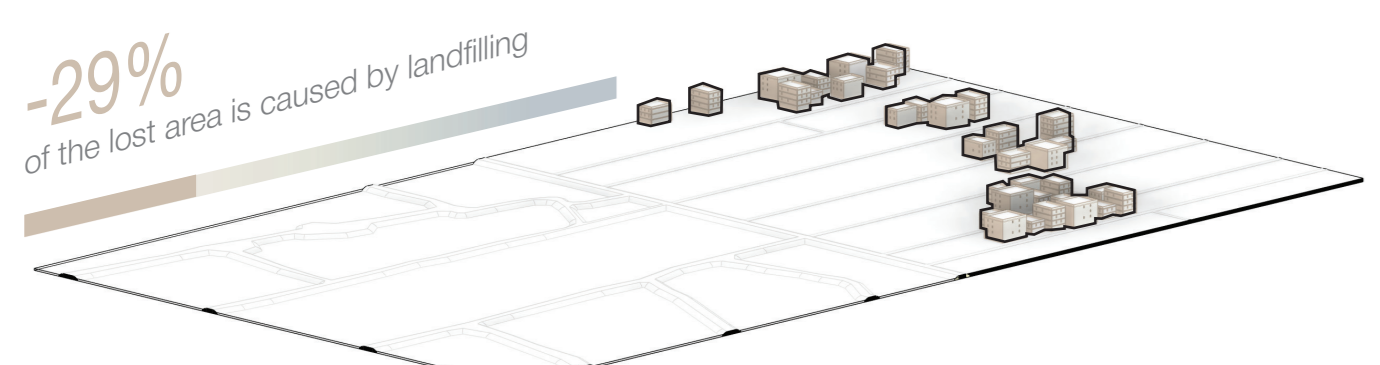
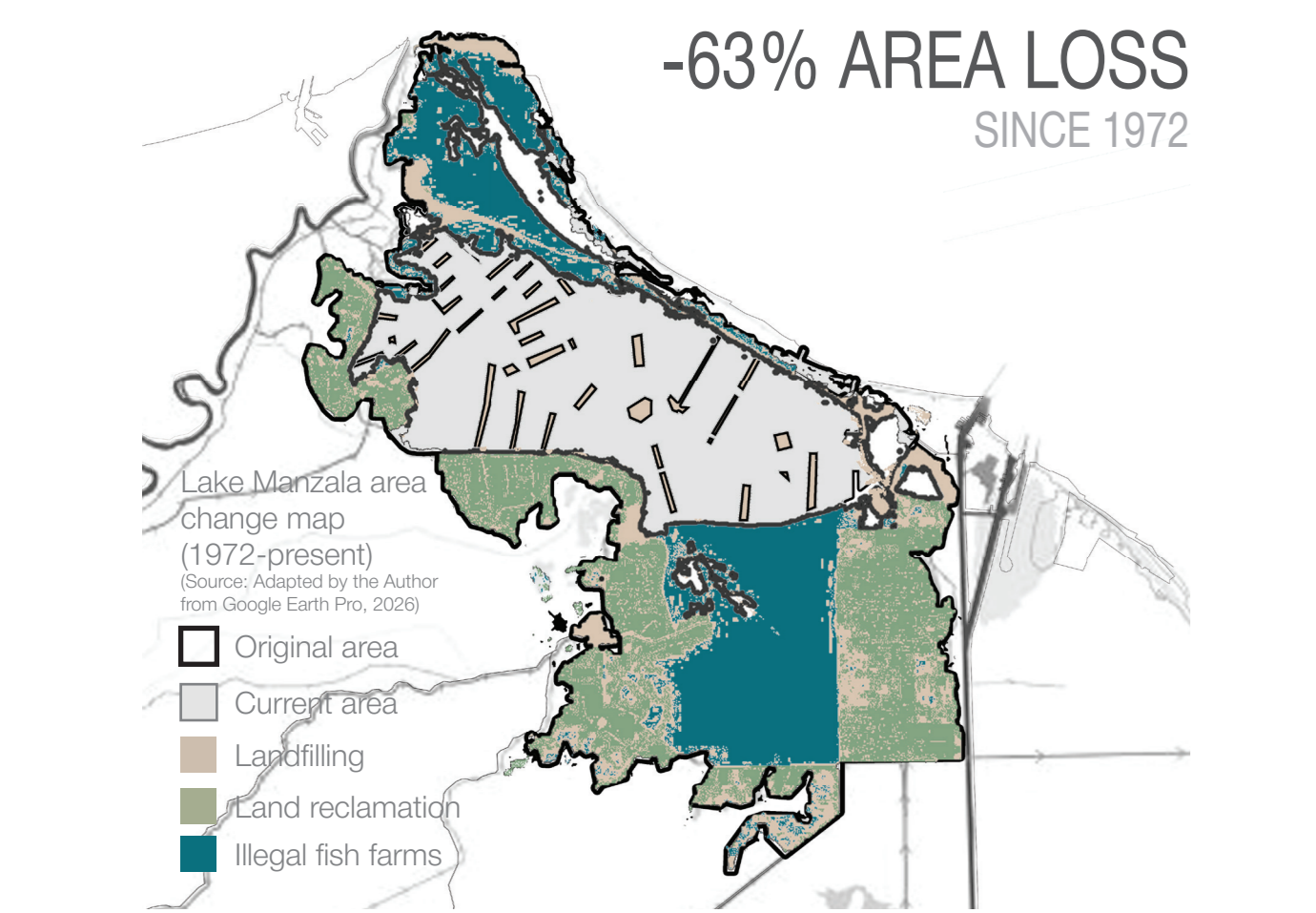

**SOLUTION**

The loss of natural wetlands in Lake Manzala caused by the expansion is solved by creating floating aquageoponic modules. These modules allow for planting crops and breeding fish in the same area simultaneously. They are all covered by a large canopy that keeps the water from evaporating.

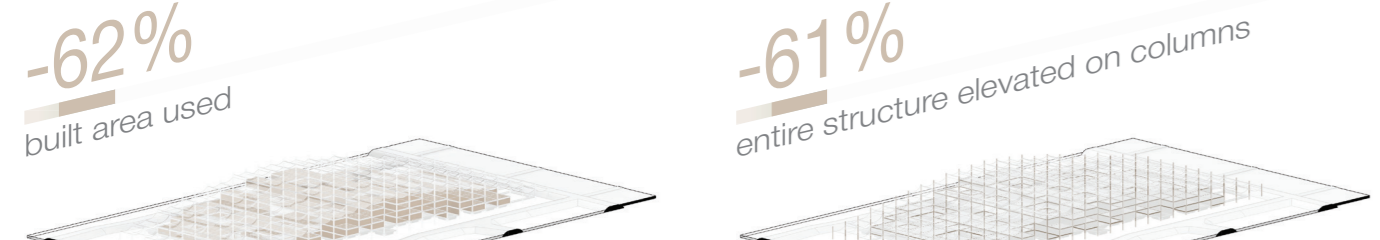

Closed spaces for stock/gear storage as well as administrative spaces.



Closed spaces for stock/gear storage as well as administrative spaces.



Closed spaces for stock/gear storage as well as administrative spaces.



Closed spaces for stock/gear storage as well as administrative spaces.

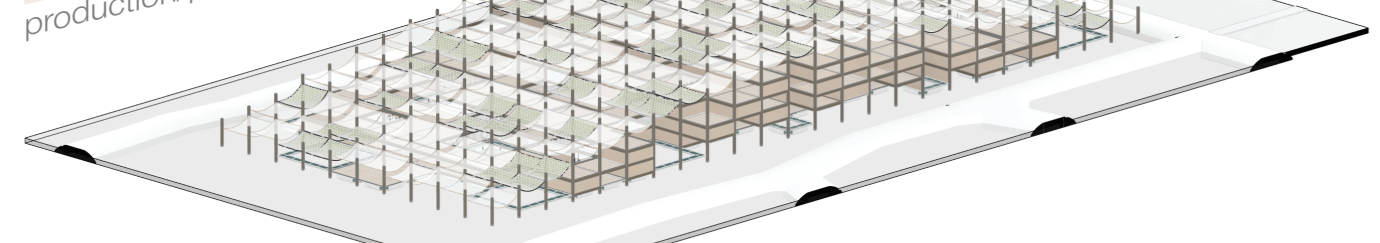

UP TO 7X production/profit than both agriculture and aquaculture lands combined.

**GROUND LEVEL PLAN**

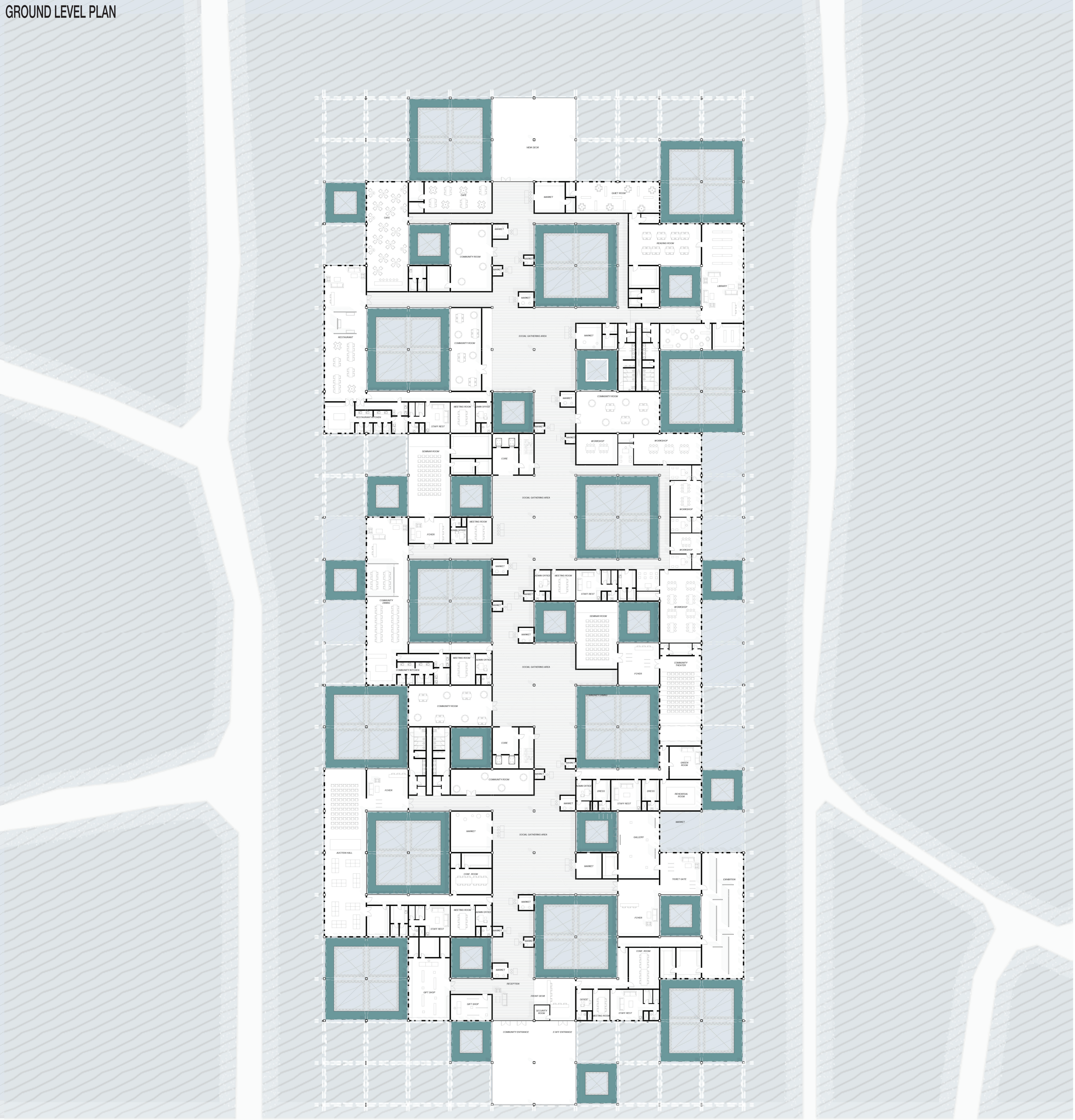

**LAYOUT**



Closed spaces for stock/gear storage as well as administrative spaces. Closed spaces for stock/gear storage as well as administrative spaces.

## RESTAURANT MODULE

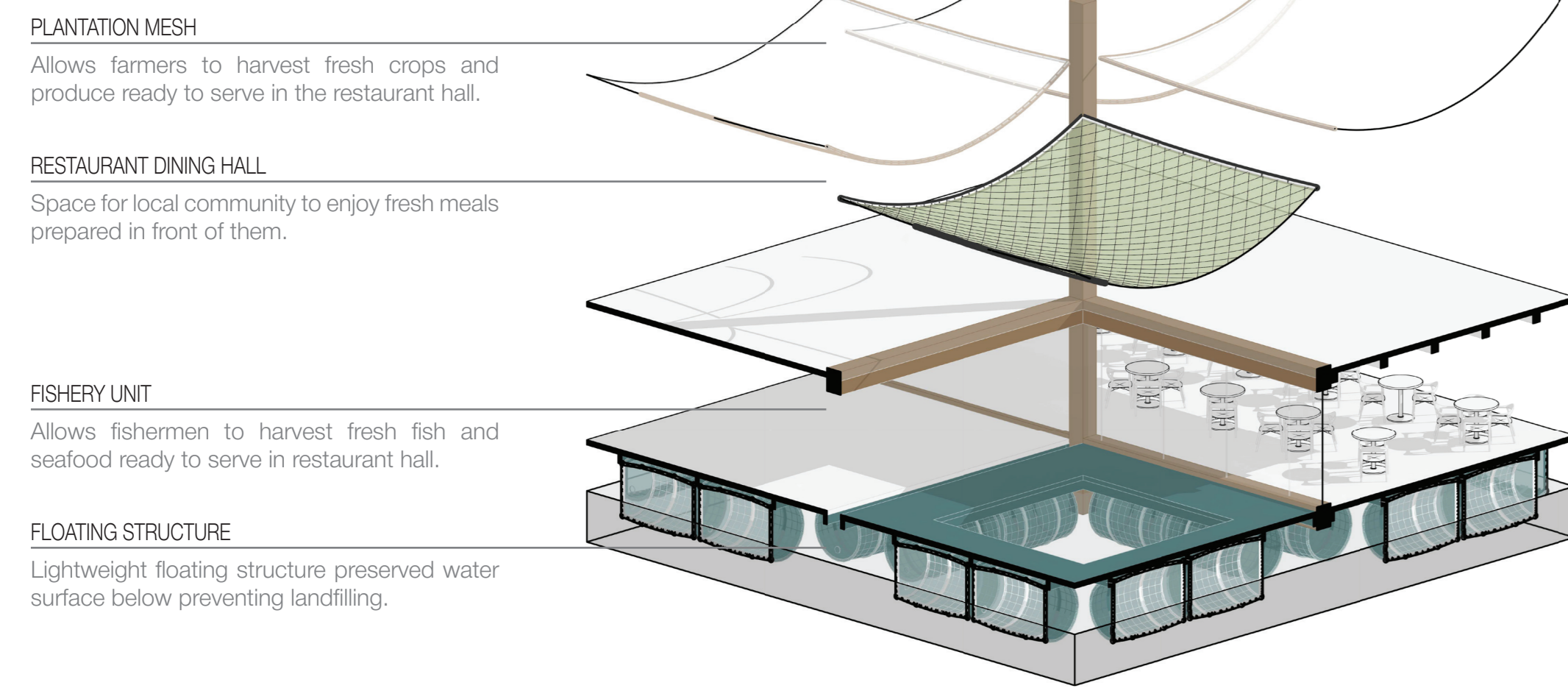

**PLANTATION MESH**

Allows farmers to harvest fresh crops and produce ready to serve in the restaurant hall.

**RESTAURANT DINING HALL**

Space for local community to enjoy fresh meals prepared in front of them.

**FISHERY UNIT**

Allows fishermen to harvest fresh fish and seafood ready to serve in restaurant hall.

**FLOATING STRUCTURE**

Lightweight floating structure preserved water surface below preventing landfiling.

## WORKSHOP MODULE

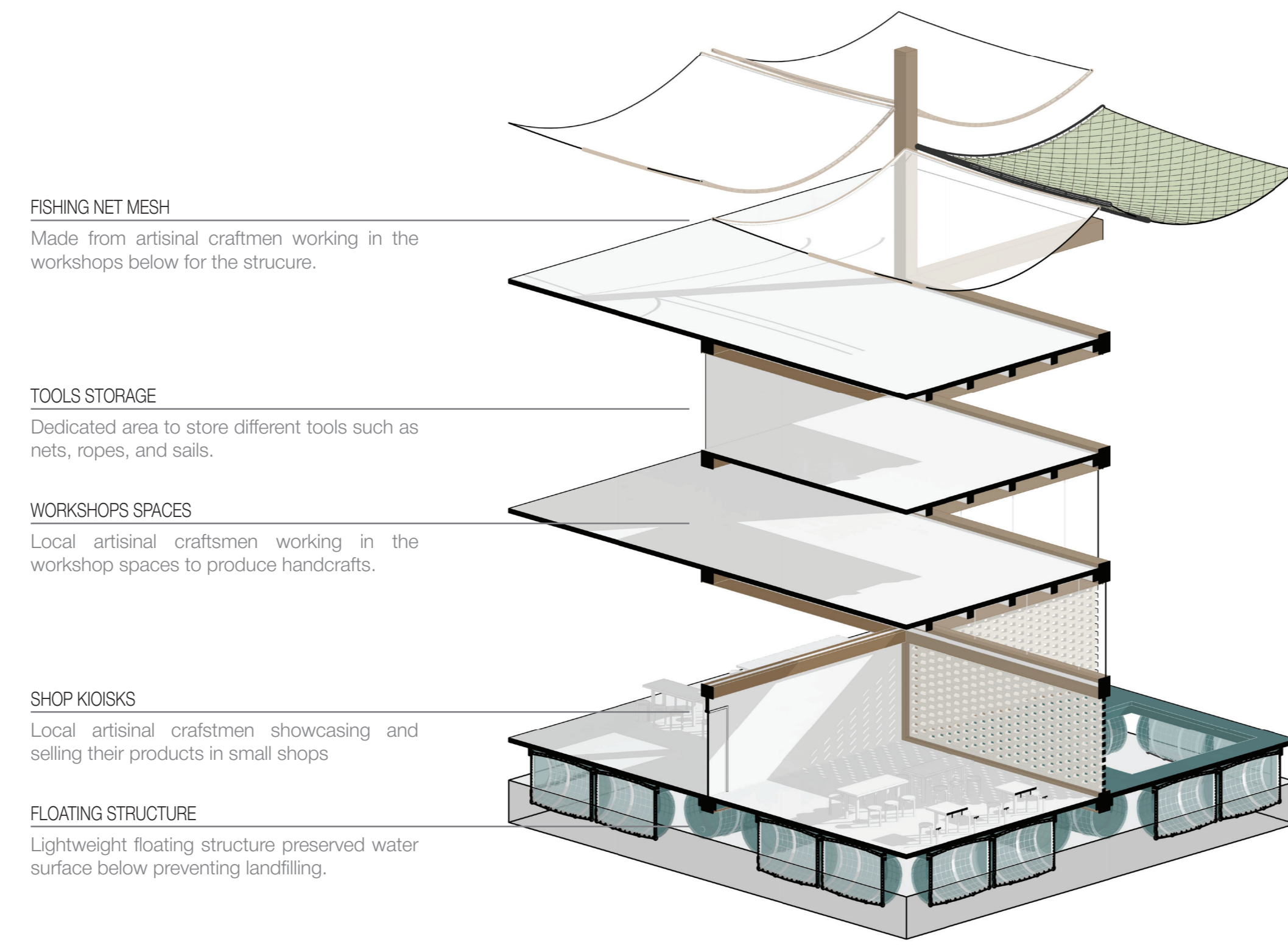

**FISHING NET MESH**

Made from artisanal craftsmen working in the workshops below for the structure.

**TOOLS STORAGE**

Dedicated area to store different tools such as nets, ropes, and sails.

**WORKSHOPS SPACES**

Local artisanal craftsmen working in the workshop spaces to produce handcrafts.

**SHOP KIOSKS**

Local artisanal craftsmen showcasing and selling their products in small shops

**FLOATING STRUCTURE**

Lightweight floating structure preserved water surface below preventing landfiling.

## MARKET MODULE

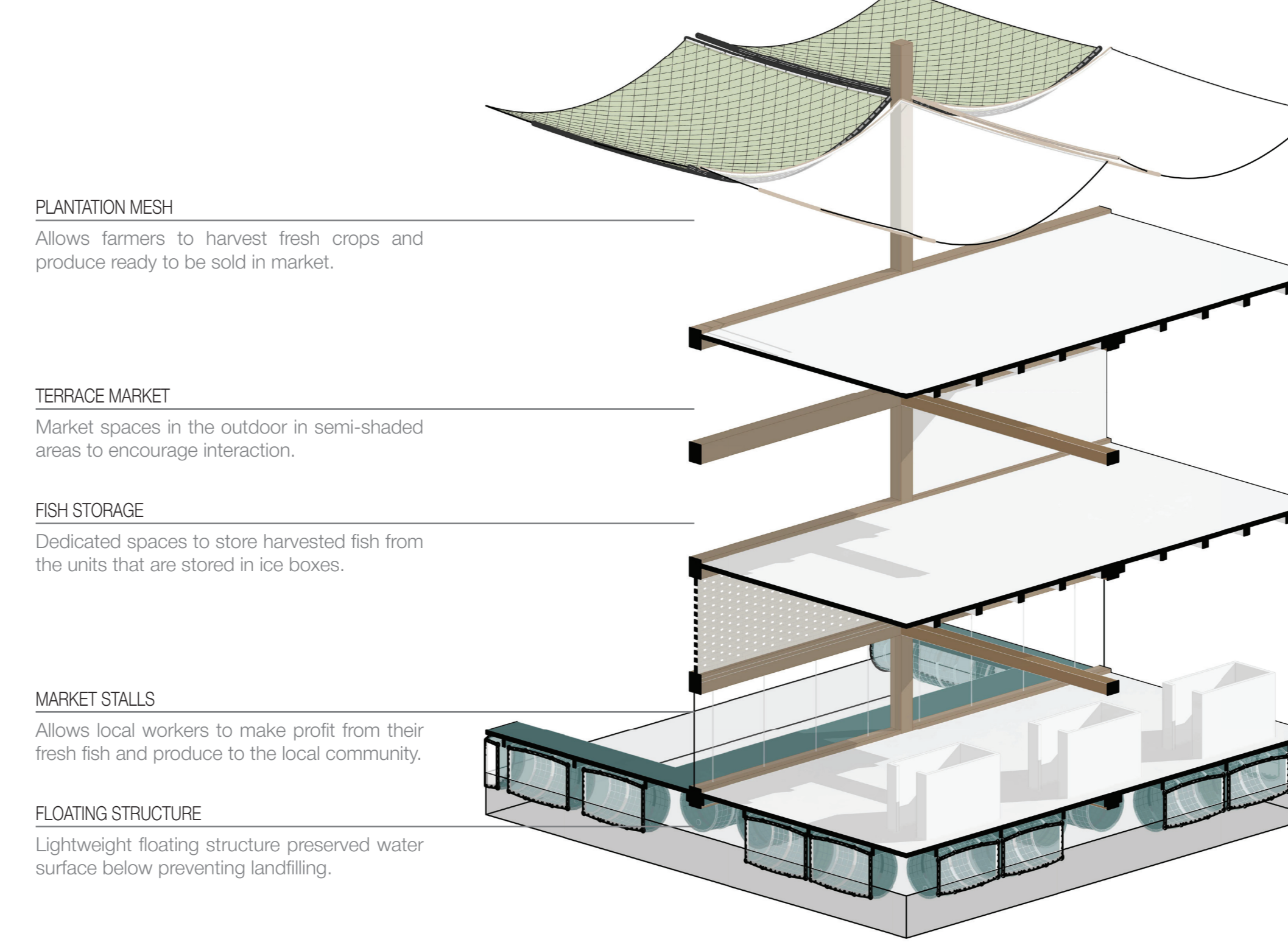

**PLANTATION MESH**

Allows farmers to harvest fresh crops and produce ready to be sold in market.

**TERFACE MARKET**

Market spaces in the outdoor in semi-shaded areas to encourage interaction.

**FISH STORAGE**

Dedicated spaces to store harvested fish from the units that are stored in ice boxes.

**MARKET STALLS**

Allows local workers to make profit from their fresh fish and produce to the local community.

**FLOATING STRUCTURE**

Lightweight floating structure preserved water surface below preventing landfiling.

## AUCTION MODULE

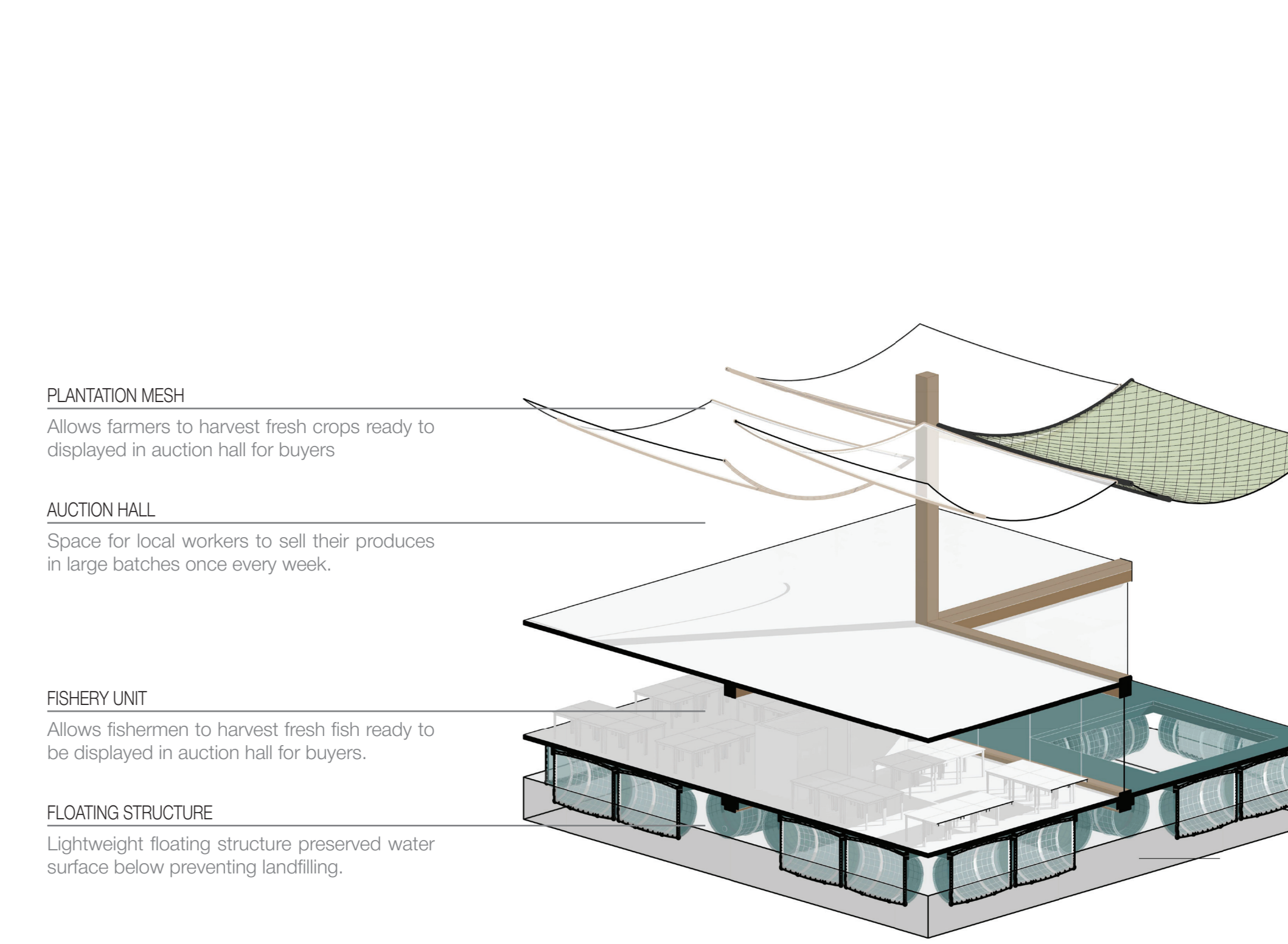

**PLANTATION MESH**

Allows farmers to harvest fresh crops ready to be displayed in auction hall for buyers

**AUCTION HALL**

Space for local workers to sell their produces in large batches once every week.

**FISHERY UNIT**

Allows fishermen to harvest fresh fish ready to be displayed in auction hall for buyers.

**FLOATING STRUCTURE**

Lightweight floating structure preserved water surface below preventing landfiling.

## 3D SECTION

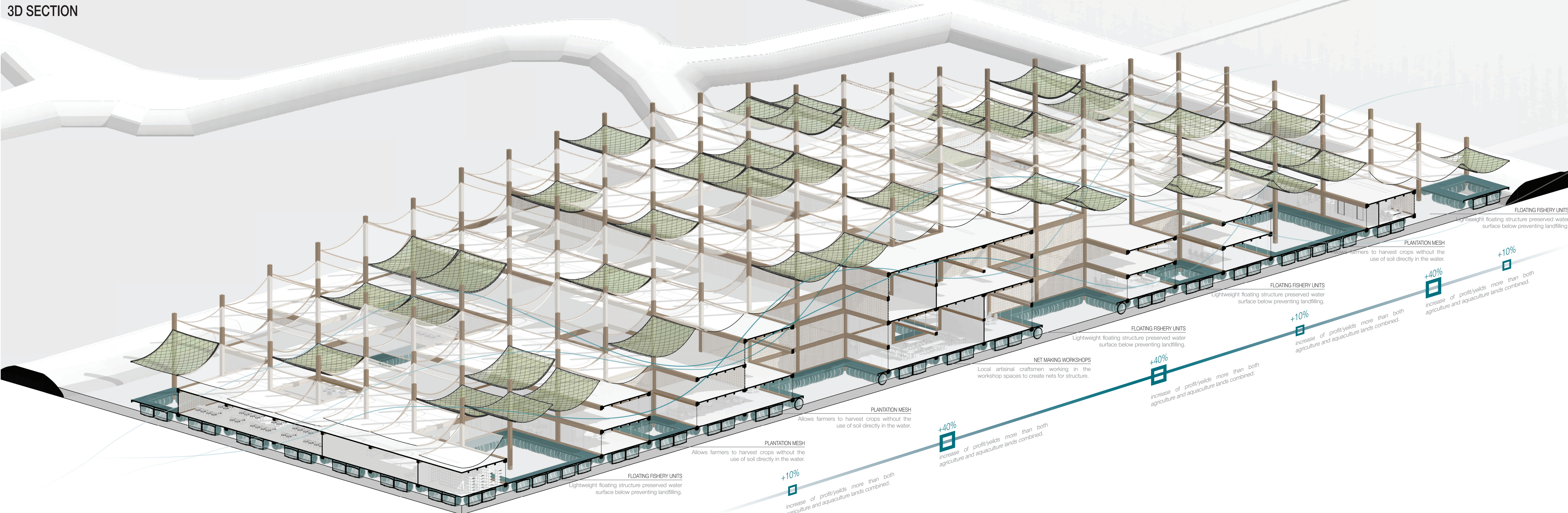

**FLOATING FISHERY UNITS**

Lightweight floating structure preserved water surface below preventing landfiling.

**PLANTATION MESH**

Allows farmers to harvest crops without the use of soil directly in the water.

+10%

Increase of profit/yields more than both agriculture and aquaculture lands combined.

+40%

Increase of profit/yields more than both agriculture and aquaculture lands combined.

+10%

Increase of profit/yields more than both agriculture and aquaculture lands combined.

+40%

Increase of profit/yields more than both agriculture and aquaculture lands combined.

+40%

Increase of profit/yields more than both agriculture and aquaculture lands combined.

+10%

Increase of profit/yields more than both agriculture and aquaculture lands combined.

+10%

Increase of profit/yields more than both agriculture and aquaculture lands combined.

**FLOATING FISHERY UNITS**

Lightweight floating structure preserved water surface below preventing landfiling.

**PLANTATION MESH**

Allows farmers to harvest crops without the use of soil directly in the water.

+10%

Increase of profit/yields more than both agriculture and aquaculture lands combined.

+40%

Increase of profit/yields more than both agriculture and aquaculture lands combined.

+10%

Increase of profit/yields more than both agriculture and aquaculture lands combined.

+40%

Increase of profit/yields more than both agriculture and aquaculture lands combined.

+40%

Increase of profit/yields more than both agriculture and aquaculture lands combined.

+10%

Increase of profit/yields more than both agriculture and aquaculture lands combined.

+10%

Increase of profit/yields more than both agriculture and aquaculture lands combined.

## PERSPECTIVE ELEVATION

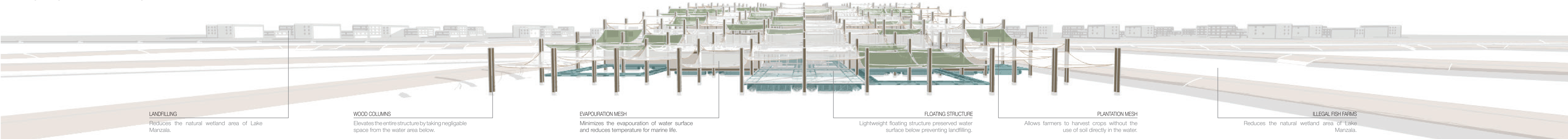

**LANDFILLING**

Reduces the natural wetland area of Lake Manzala.

**WOOD COLUMNS**

Elevates the entire structure by taking negligible space from the water area below.

**EVAPORATION MESH**

Minimizes the evaporation of water surface and reduces temperature for marine life.

**FLOATING STRUCTURE**

Lightweight floating structure preserved water surface below preventing landfiling.

**PLANTATION MESH**

Allows farmers to harvest crops without the use of soil directly in the water.

**ILLEGAL FISH FARMS**

Reduces the natural wetland area of Lake Manzala.

## FIRST LEVEL PLAN

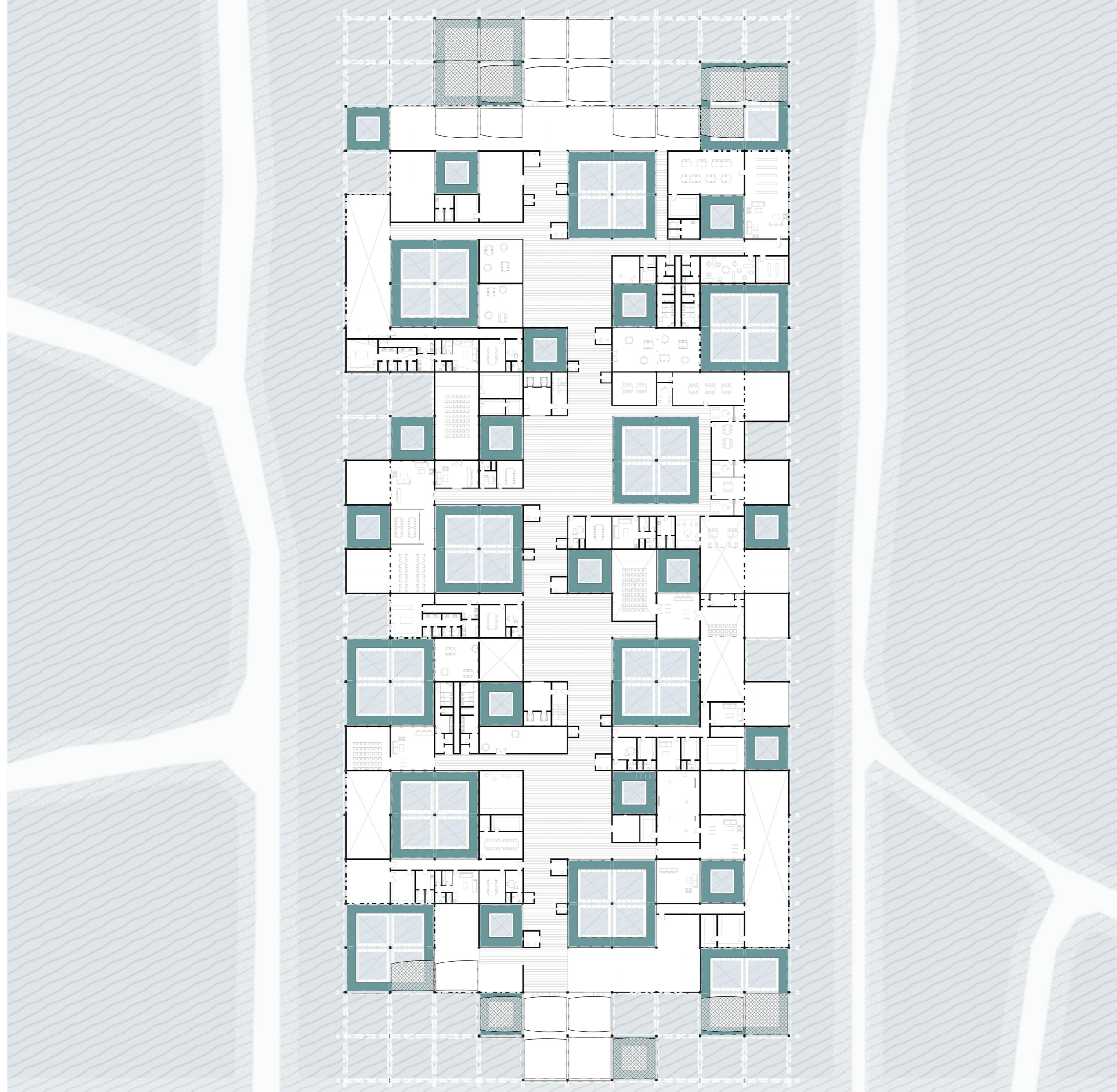

## SECOND LEVEL PLAN

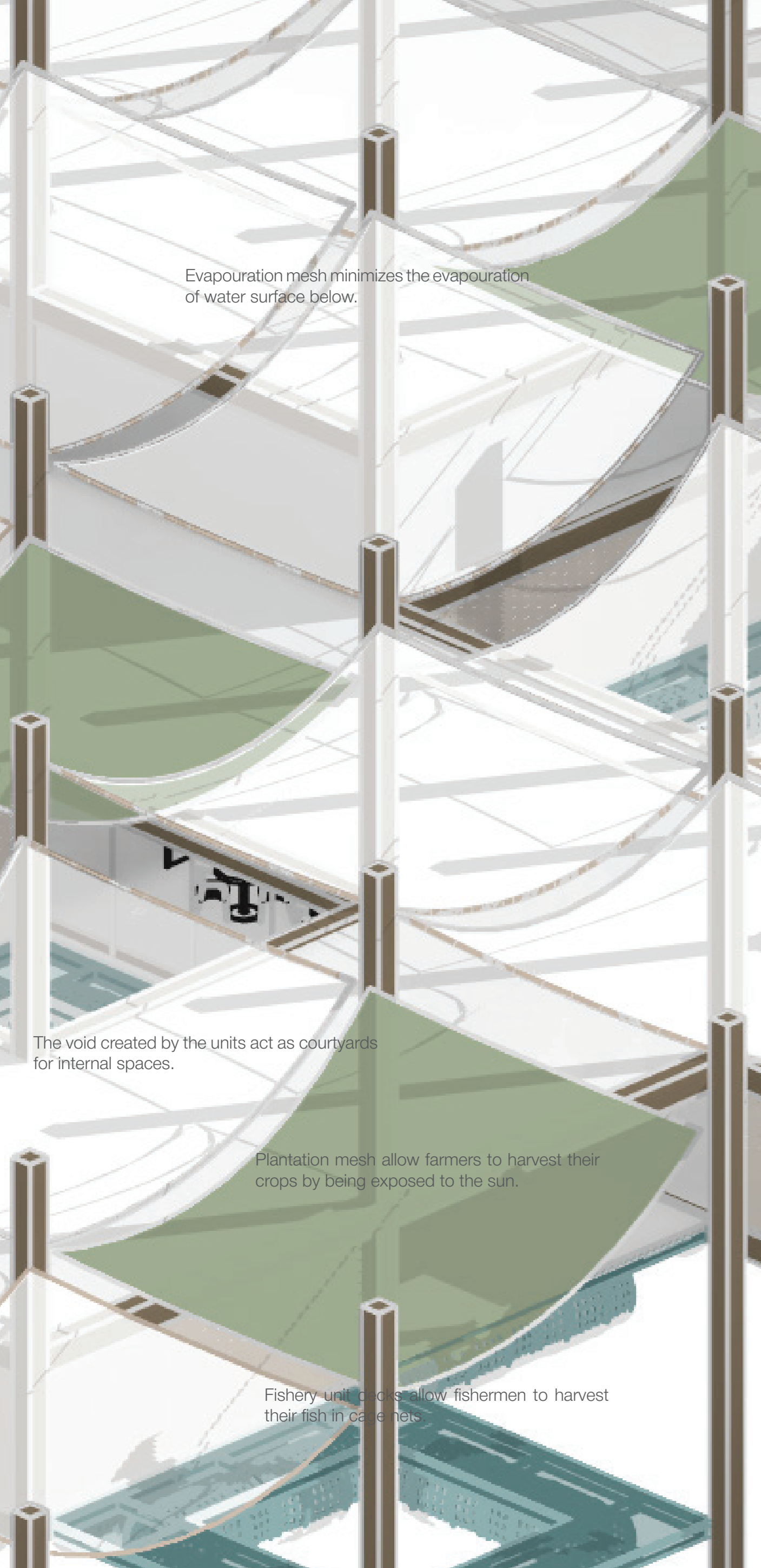
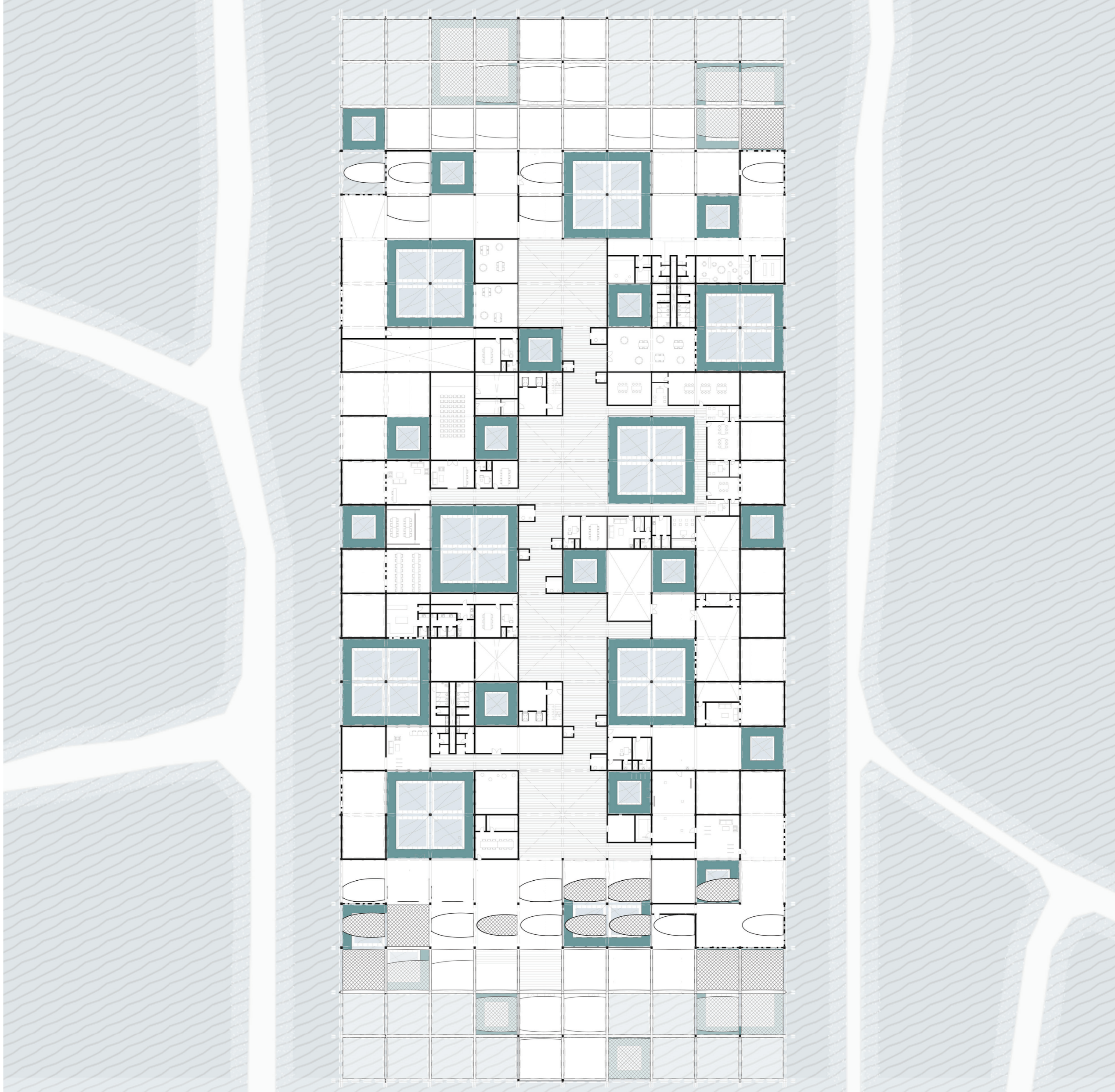

## MODULES FABRICATION

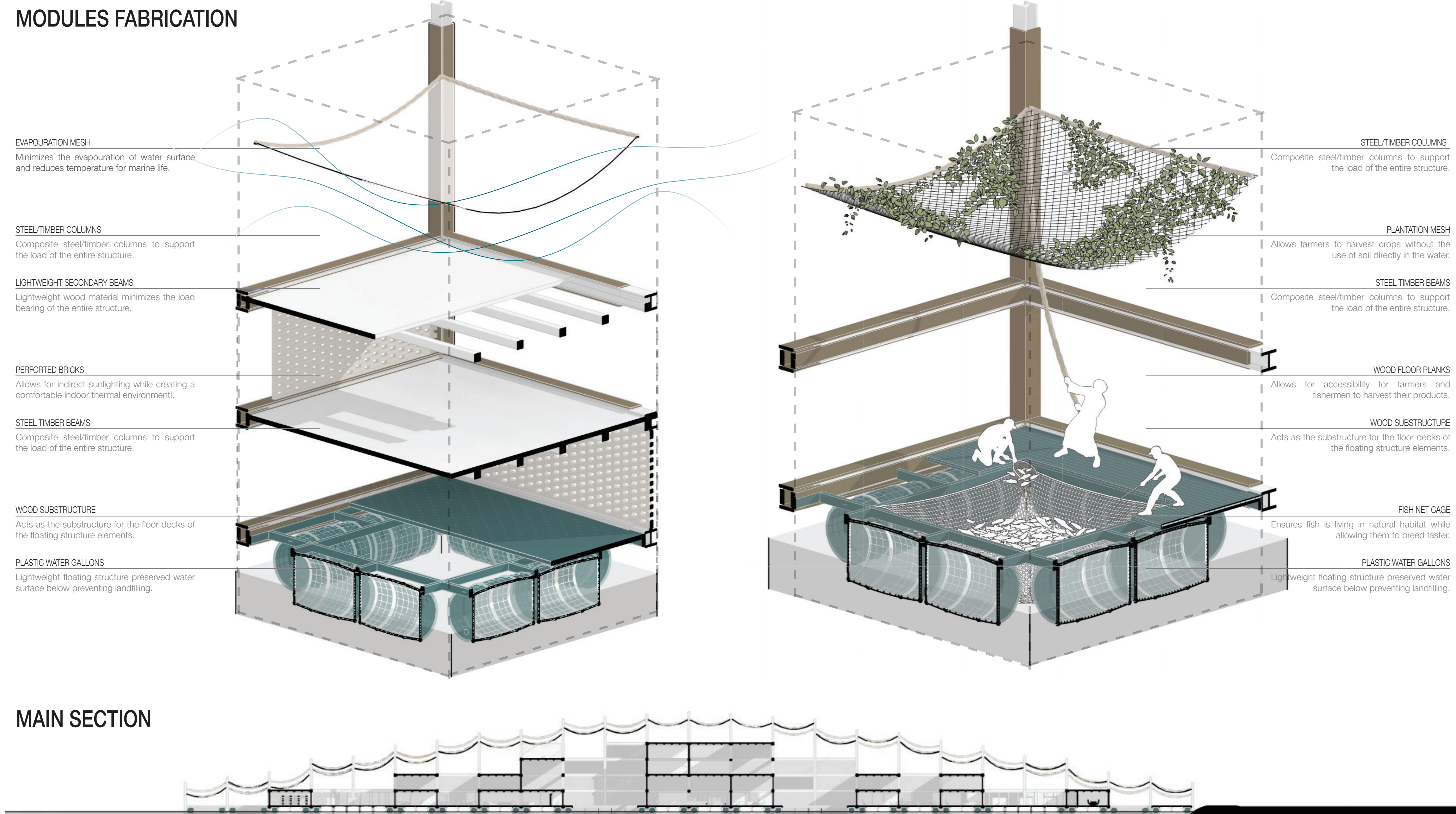

## MAIN SECTION

