

CENTER

Enrique Getzemaní García Campos
Luis Enrique Quezada Torres

The built elements of Centers are two buildings:
Vertical with 10 levels, and horizontal with 6 levels.
Both of them are divided into a public, semi-
public and private sections.

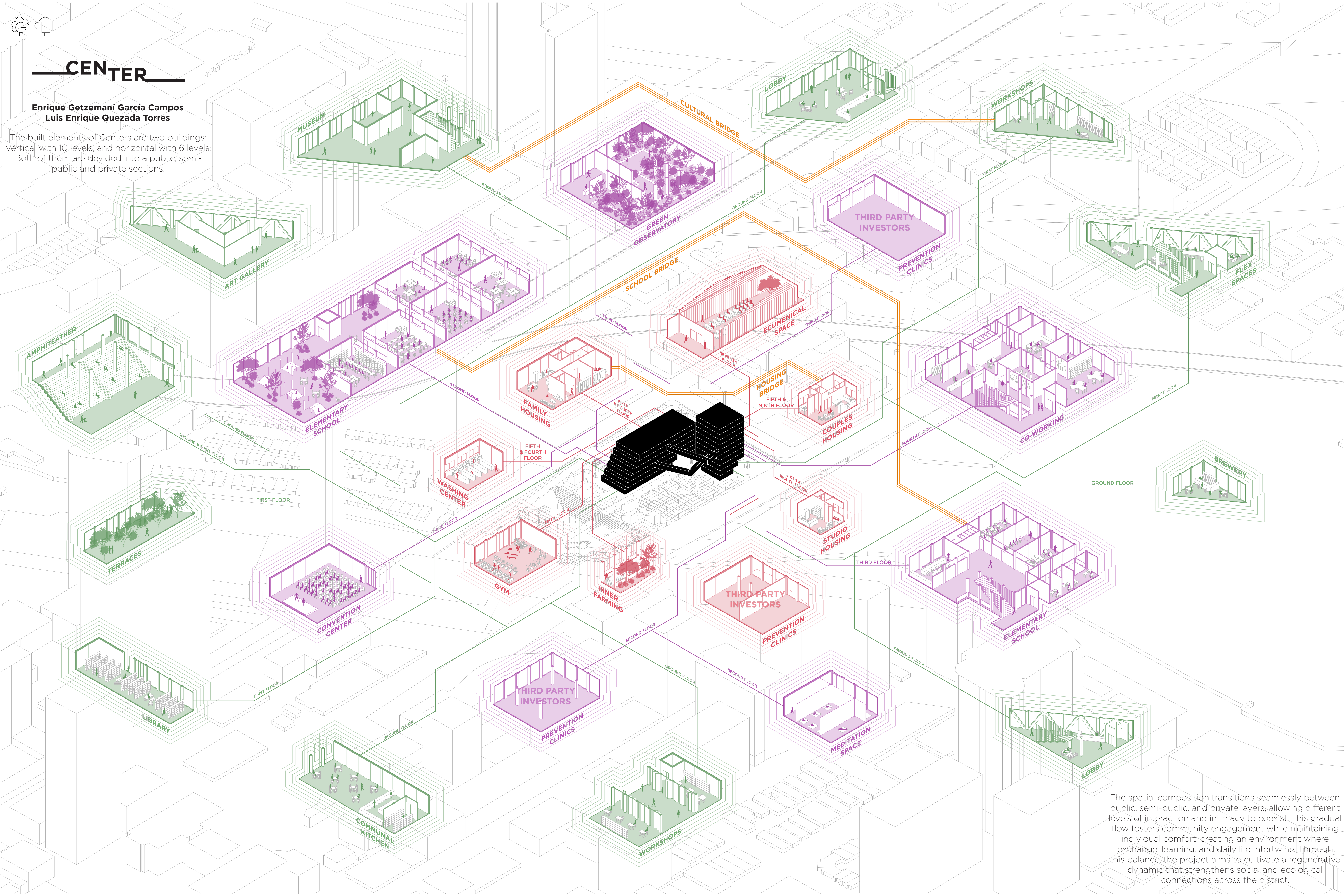

The spatial composition transitions seamlessly between public, semi-public, and private layers, allowing different levels of interaction and intimacy to coexist. This gradual flow fosters community engagement while maintaining individual comfort, creating an environment where exchange, learning, and daily life intertwine. Through this balance, the project aims to cultivate a regenerative dynamic that strengthens social and ecological connections across the district.