

SRAWUNG

/socialize /culture /empower
Reviving Local Spirit Through Inclusive Social Hubs



SITE PROBLEM ANALYSIS

lack of opportunities to develop local potential

Lack of interaction between local residents and tourists



The Decline of Local Cultural Values

Lack of multifunctional public open spaces

BACKGROUND

Prawirotaman Village is facing gentrification due to Yogyakarta's tourism boom. Indigenous residents are increasingly marginalized, social spaces are disappearing, and interactions with tourists often create tension.

The former Tilamas Hotel, a 1,075-square-meter abandoned plot of land, has great potential to become a catalyst for change. The Unfolding Petal design serves as an Adaptive Social Hub, bridging local residents and tourists, while simultaneously empowering the creative economy based on local culture.

SOLUTION

The proposed solution is to develop the Unfolding Petal concept as an Adaptive Social Hub based on the Transformative Collective Space approach. This design transforms the abandoned space of the Ex Tilamas Hotel into a sculptural building shaped like a blooming flower that functions as a medium for community empowerment, providing an inclusive interaction space, an MSME zone, a cultural amphitheater, and a local community space, thus responding to the issue of gentrification by balancing tourism and the sustainability of the lives of the Prawirotaman Village community.

SITE LOCATION



Ex Hotel Tilamas,
Jl. Prawirotaman
No.34B,
Brontokusuman,
Kec. Mergangsan,
Kota Yogyakarta,
Daerah Istimewa
Yogyakarta 55153
(-7.819601,
110.372122)

EKSISTING VIEW



WEST ROAD VIEW

EASTERN ROAD VIEW

CONCEPT

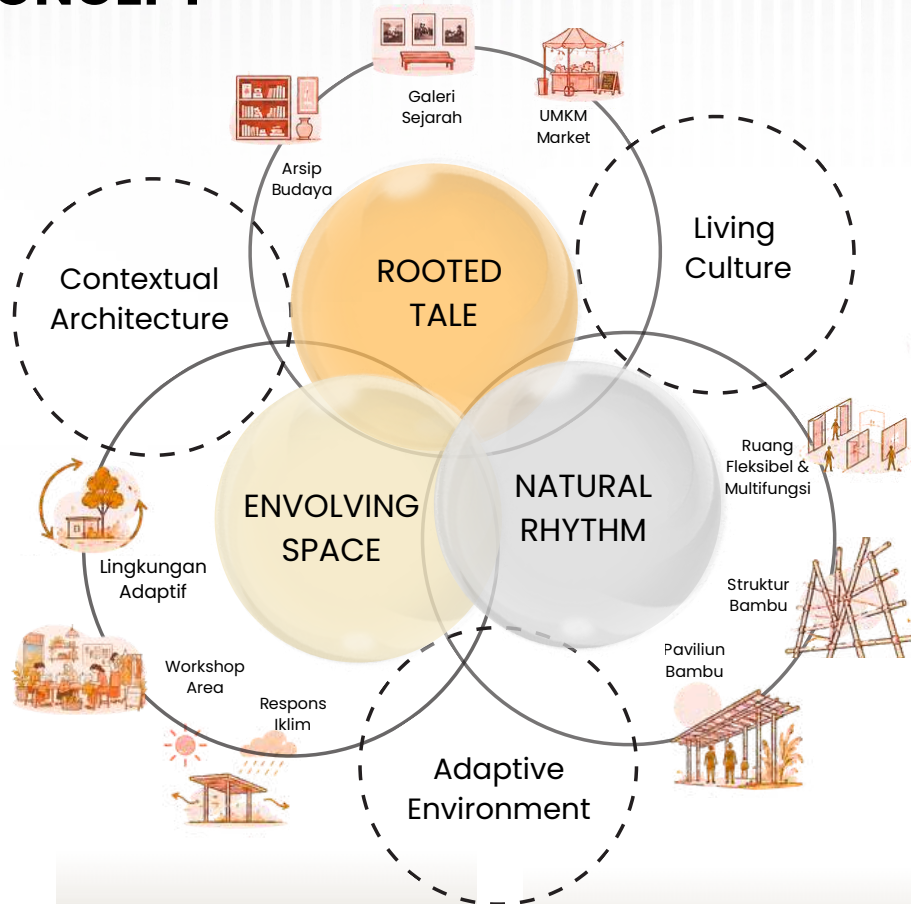

USER

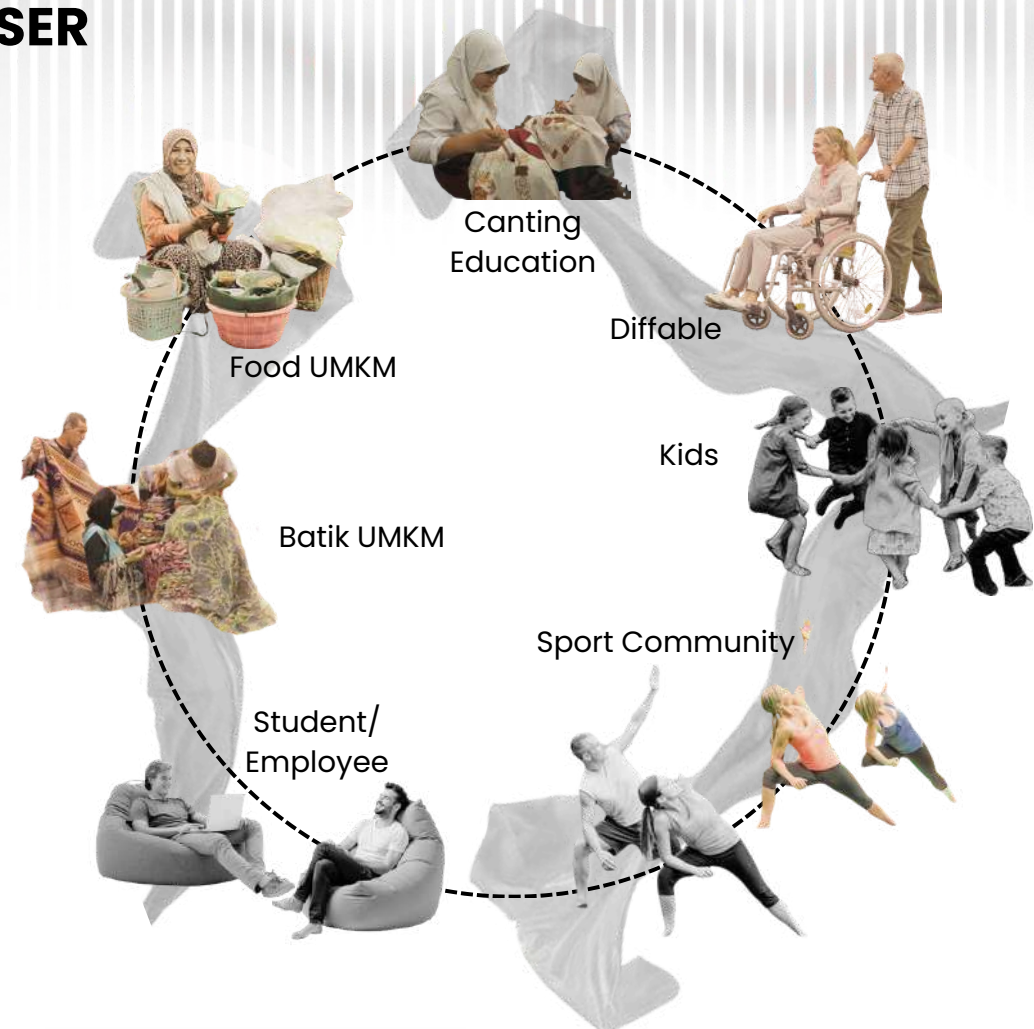

SITE ANALYSIS

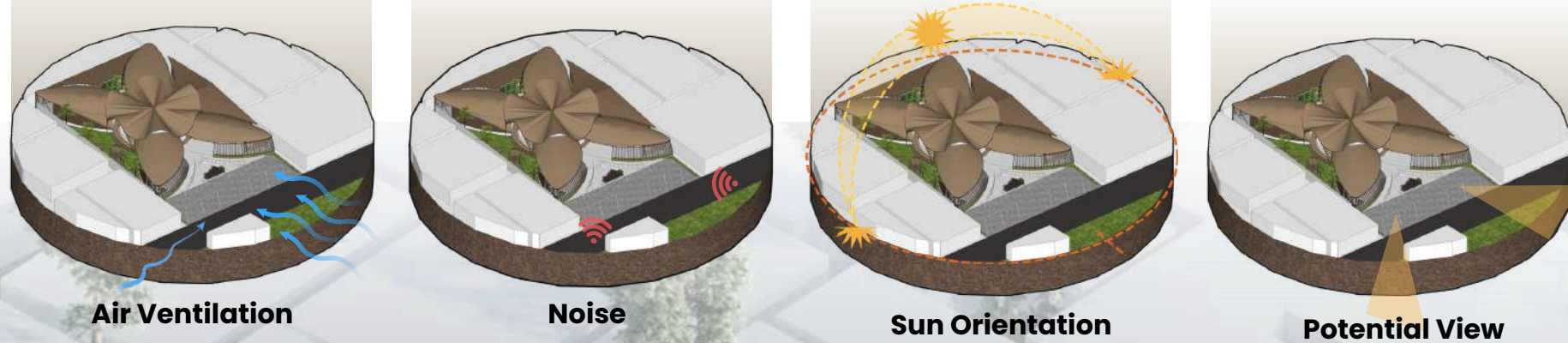

Air Ventilation

Noise

Sun Orientation

Potential View



BATIK PARANG

KERATON YOGYAKARTA

TRANSFORMASI DESAIN

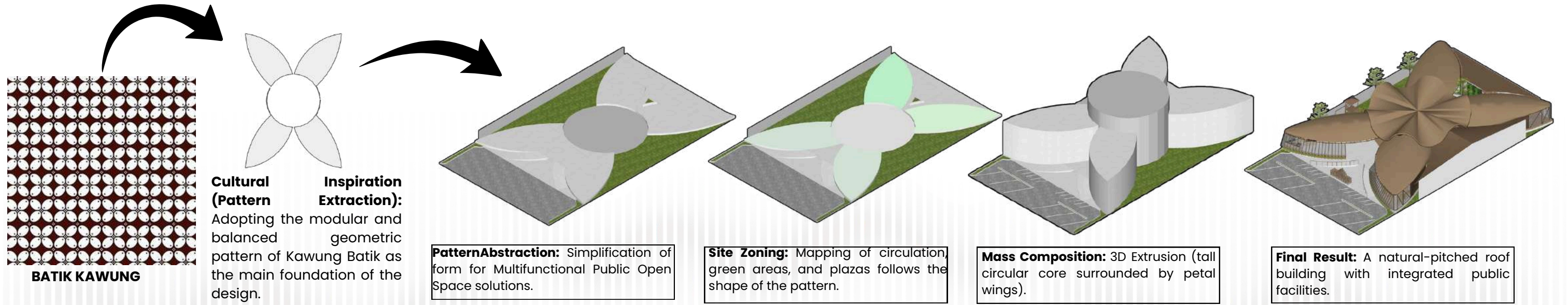

DENAH

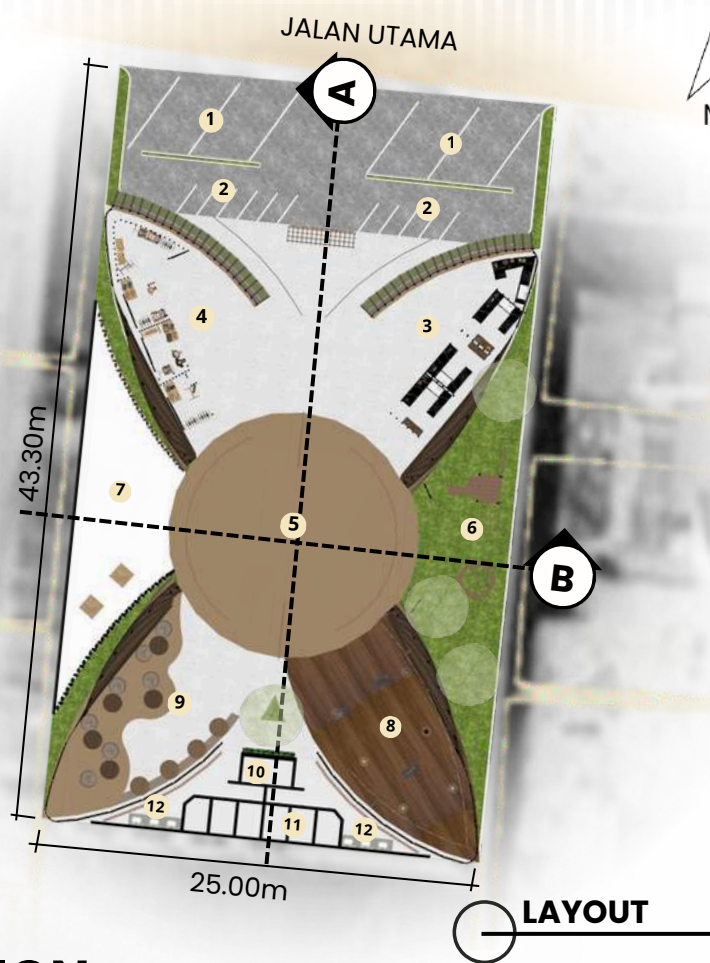

KETERANGAN :

1. Car Parking
2. Motorcycle Parking
3. Food UMKM
4. Fashion UMKM
5. Amphitheater
6. Playground
7. Multifunctional Space
8. Culture Gallery
9. Workspace
10. Janitor
11. Toilet
12. Sink

ISOMETRIC DESIGN

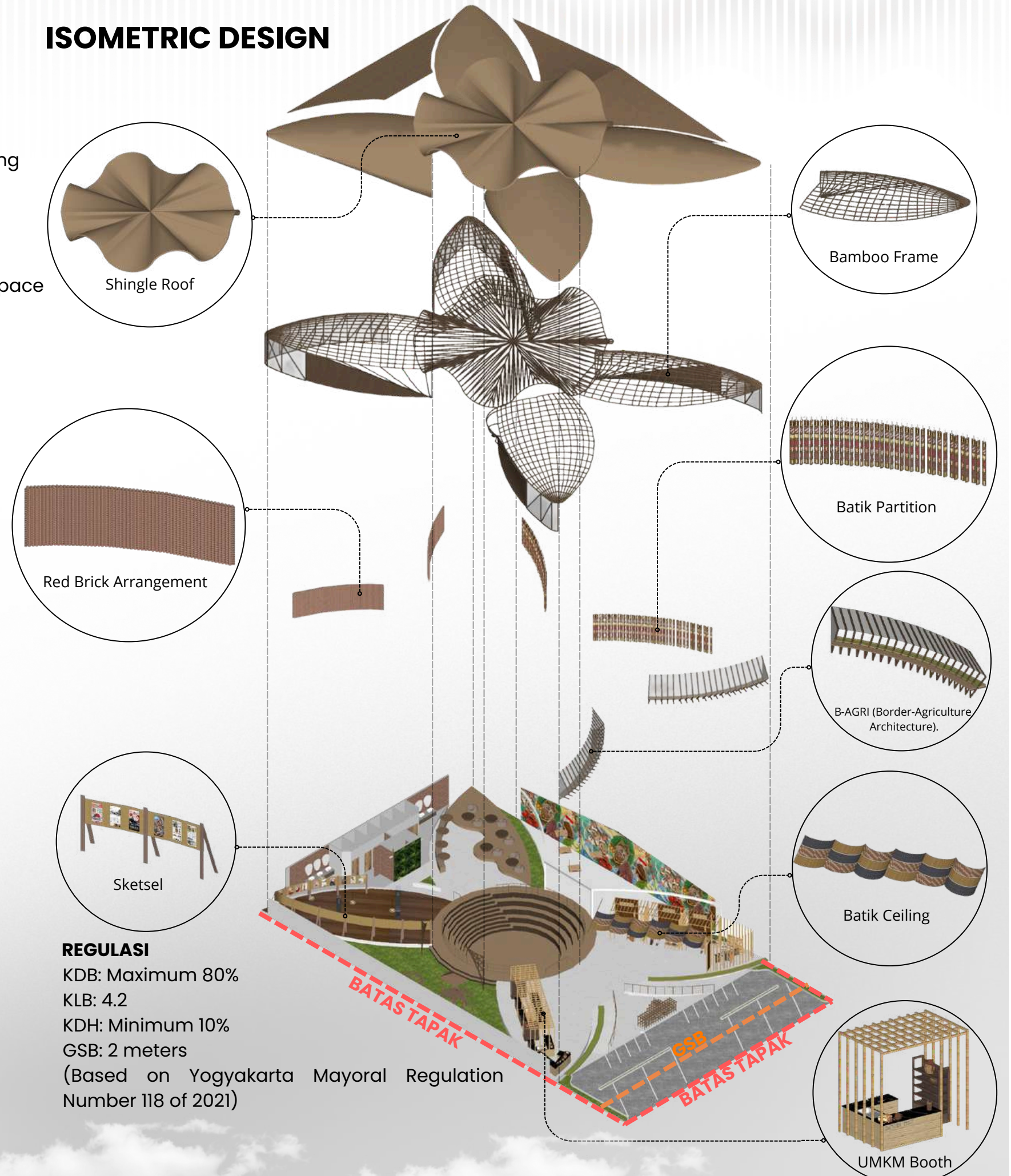

SECTION



TAMPAK



RENDER VIEW



FOOD UMKM

A traditional culinary space designed to accommodate local traders, serving as a support for the creative economy as well as an attraction for tourists.



EXHIBITION/GALLERY

An art and culture appreciation space as a forum for community work, historical documentation of Prowirotnaman Village that bridges local artists with the public.



MULTIFUNCTIONAL AREA FOR CANTING EDUCATION

An adaptive educational space designed for traditional batik-making activities. It serves as a hub for the transfer of cultural knowledge from generation to generation and from one tourist to the next.



MULTIFUNCTIONAL AREA FOR SPORTS COMMUNITY

A venue for physical activity and light exercise for the local community to strengthen togetherness. Featuring a multifunctional open space concept for health (exercise/yoga).



CLOTHING UMKM

A creative retail area dedicated to local fashion, textile crafts, and Yogyakarta's distinctive batik. It plays a direct role in improving the welfare of local artisans by providing representative commercial space.



WORKSPACE

A co-working space that facilitates creative industry players, students, pupils, and communities to collaborate, exchange ideas, and develop innovations based on local potential.



PLAYGROUND

A safe, educational, and family-friendly children's play area. Designed as an inclusive interaction space to support children's social development in an urban environment.



AMPITHEATER

A focal point zone that can be used as a platform for collaboration between local residents and tourists. It promotes the identity and culture of Yogyakarta, particularly the Prowirotnaman area.