

3 Interventions

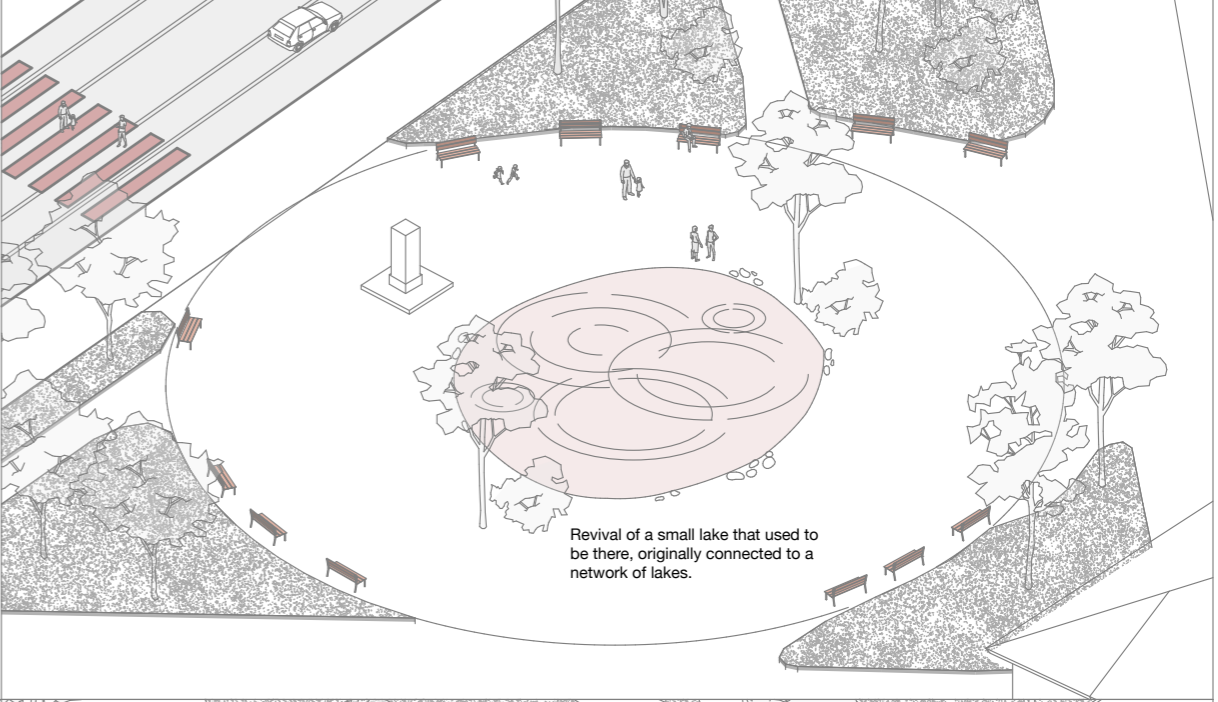

Revival of a small lake that used to be there, originally connected to a network of lakes.

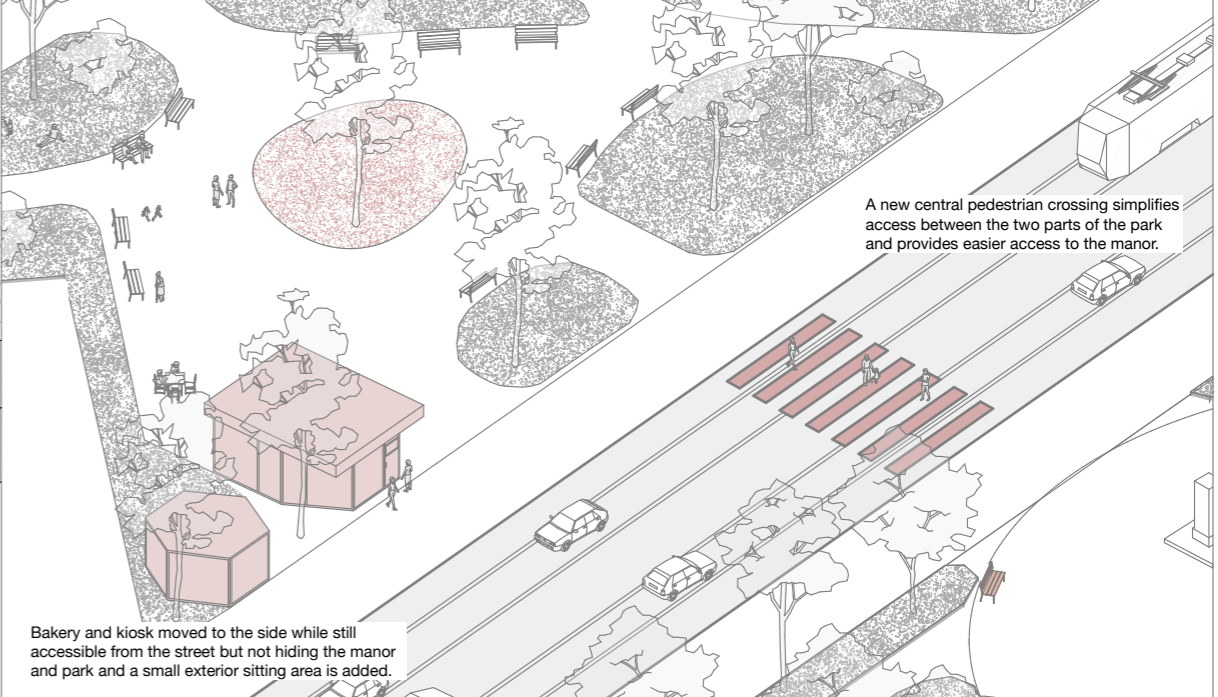

Bakery and kiosk moved to the side while still accessible from the street but not hiding the manor and park and a small exterior sitting area is added.

A new central pedestrian crossing simplifies access between the two parts of the park and provides easier access to the manor.

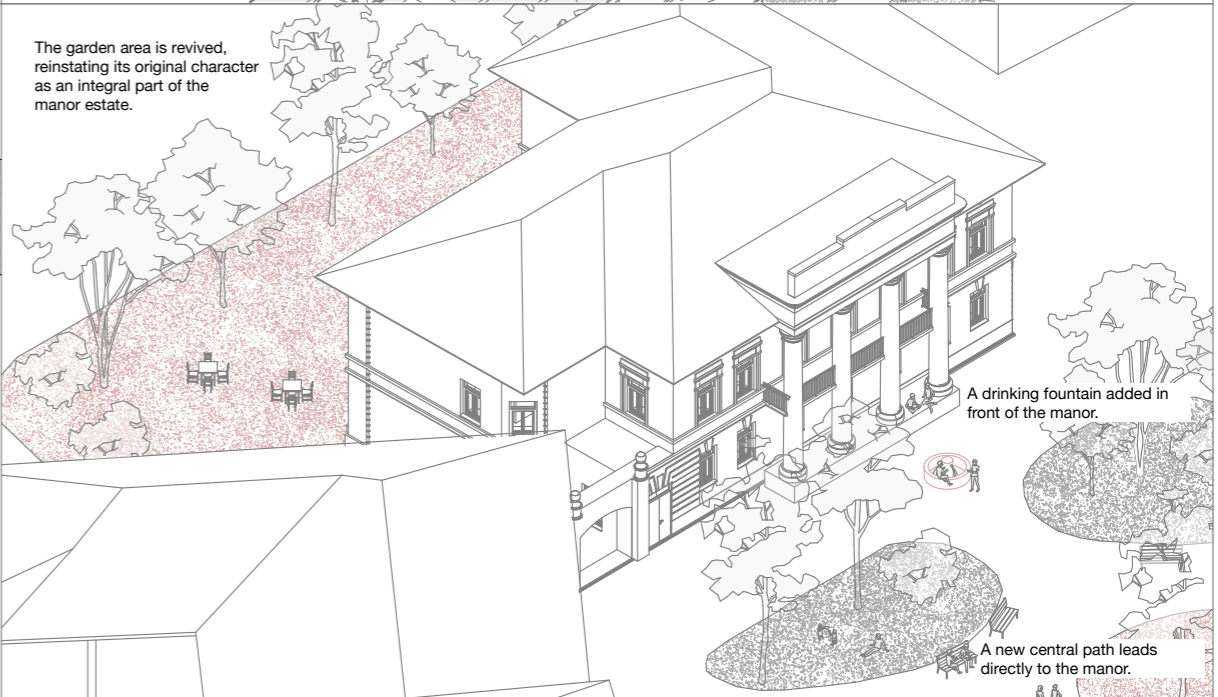

The garden area is revived, reinstating its original character as an integral part of the manor estate.

A drinking fountain added in front of the manor.

A new central path leads directly to the manor.