

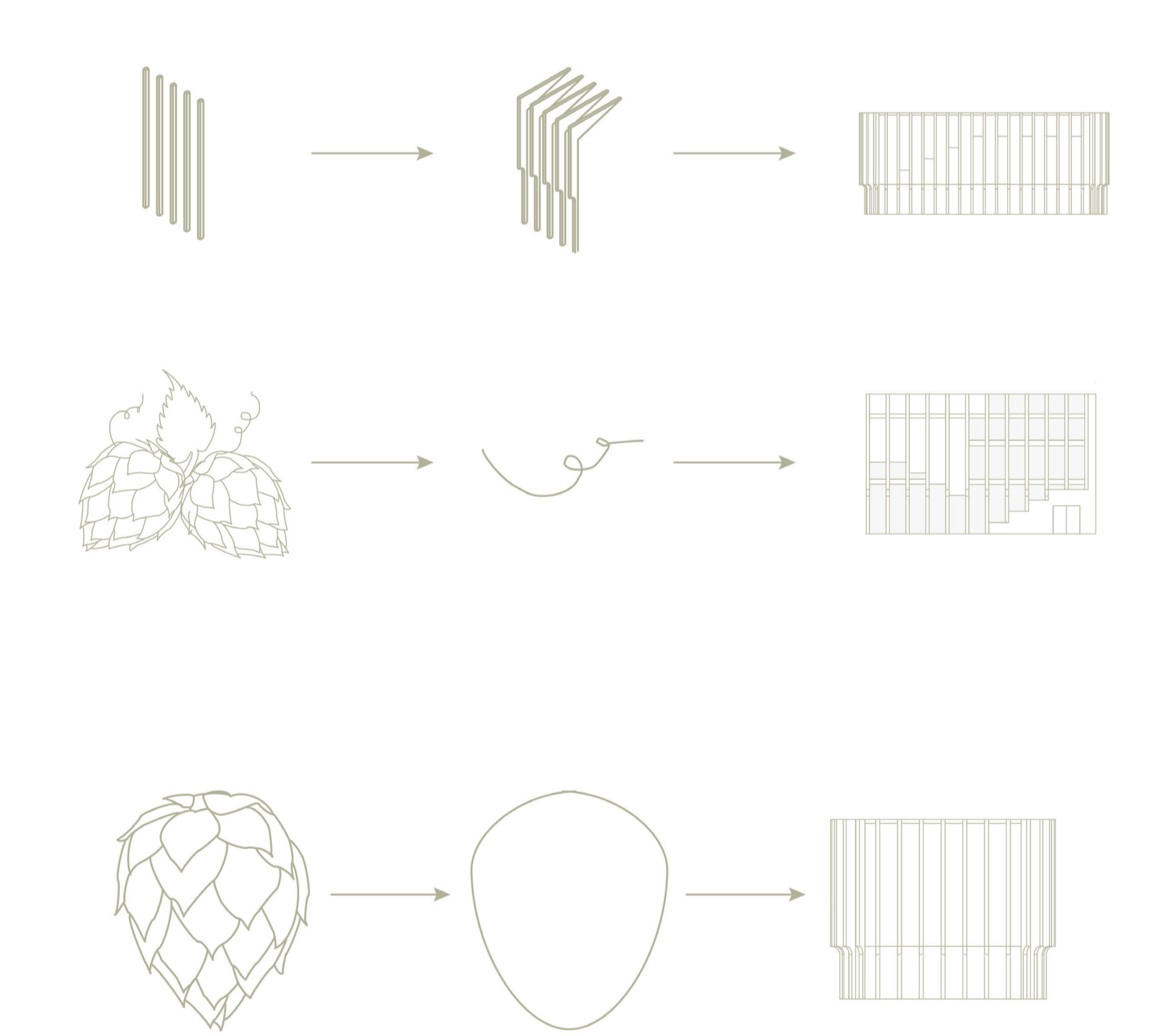

# MUSEUM BULOVNA

IAS3 | SS 2025/2026 | 3. gráde  
 programme A+S FSV CTU | k129  
 studio: Bořiková | Hlaváček

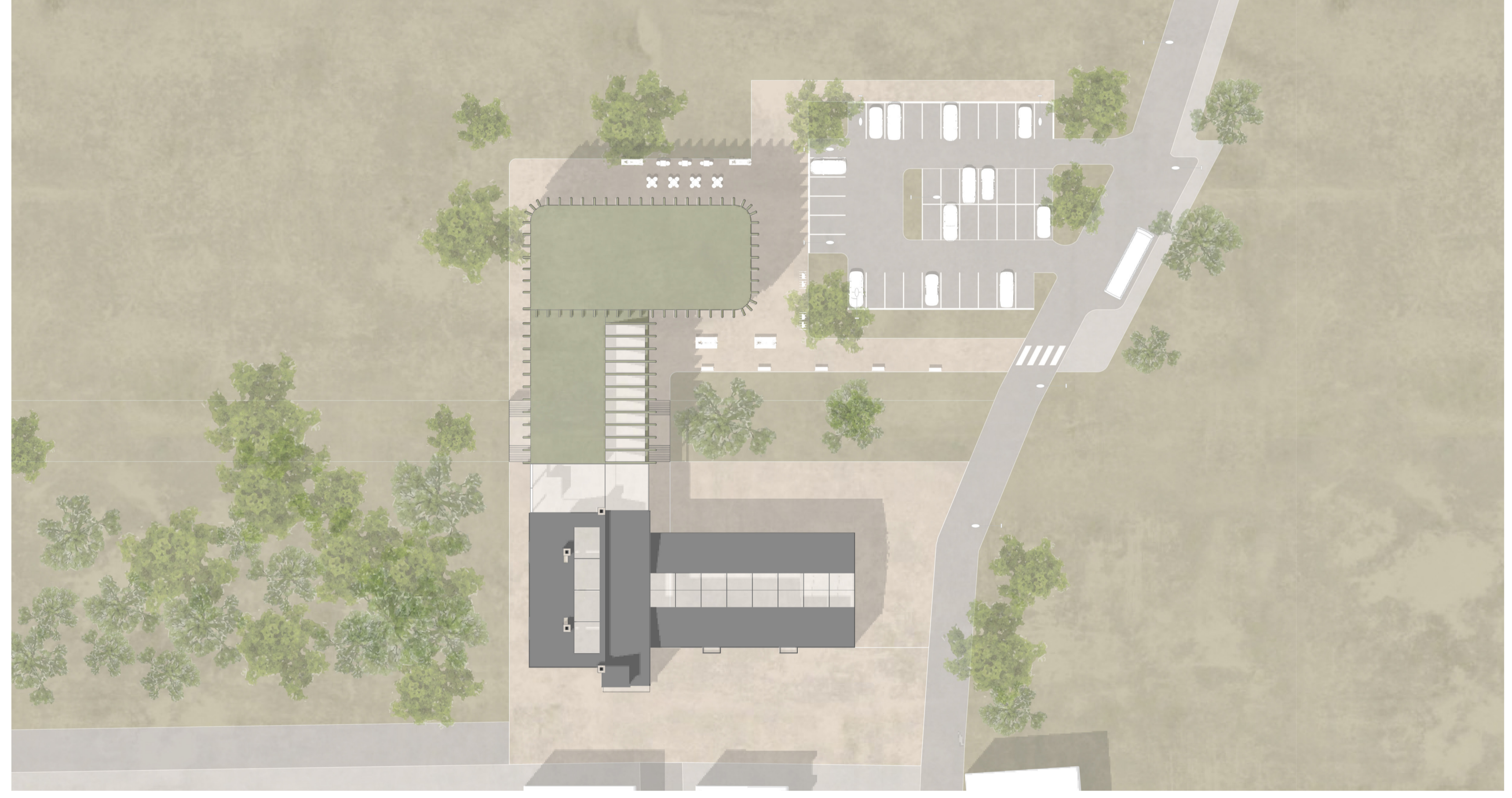

**THE CONCEPT**  
 The design concept for the Bulovna Beer Factory is inspired by the hop plant, drawing from its natural form, growth pattern, and structure. These characteristics informed the extension of the existing building, creating a contemporary addition that reflects the identity of beer production. The original exterior has been preserved to respect the site's industrial heritage, while the intervention focuses on transforming the interior experience through natural light. Roof skylights have been introduced, and central sections of the floor plates have been removed to create vertical light wells, allowing daylight to penetrate deep into the building and connect the different levels. This approach enhances spatial quality while celebrating the relationship between architecture, brewing, and nature.

