

Revamping Ibrahimia canal street

Prepared By:

- Knzey Mohamed
- Konoz Mohamed
- Shahd Khaled
- Omar Ashraf
- Mohamed Mohsen

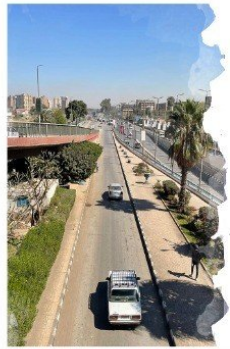

and to the residents in their basic essential services such as electricity, water supply, and sewage disposal. The main objective of this project is to revitalize the canal street and improve the quality of life for the residents. The project will include the following components:

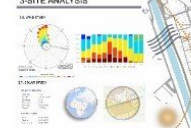
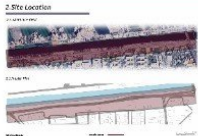

5. CONCEPT DEVELOPMENT



6. SCHEMATIC DESIGN



6. SCHEMATIC DESIGN

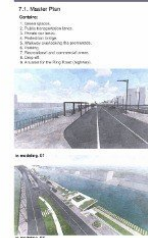

6. SCHEMATIC DESIGN

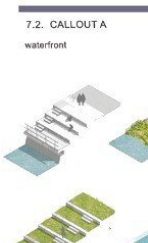

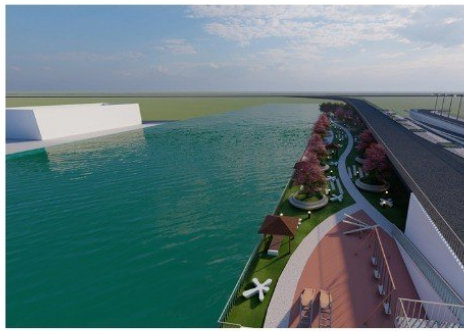

6. SCHEMATIC DESIGN

7.2. CALLOUT B

Parking

Garage Description (Structural and Functional Details)

- The total height of the garage is 12.15 meters.
- The structural system consists of beams and columns.
- The garage comprises four floors as follows:
 - Ground floor at an elevation of 15 meters
 - First floor at an elevation of 13 meters
 - Second floor at an elevation of 11 meters
 - Roof level at an elevation of 9 meters
- The rooftop is utilized by establishing a cafeteria overlooking the river.
- Stairs and elevators are provided to accommodate people with special needs.

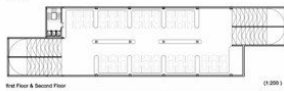

6. SCHEMATIC DESIGN

7.4. CALLOUT C

Sky walkways

Pedestrian Bridge Description:

- The height of the bridge is 5.30 meters.
- The pedestrian bridge is designed to facilitate movement between the gallery site and the adjacent site.



16 - RAMPING 10



6. SCHEMATIC DESIGN

7.5. CALLOUT D

Sky walkways

Road Design Elements:

- Trees are placed on both sides of the road as well as in the median.
- Drop-off areas are carefully coordinated.
- The road width is consistent.

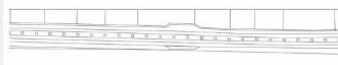

7.6. CALLOUT E

Traffic and Landscape Design:

- Drop-off areas are designated.
- Traffic signals are installed to regulate movement and prevent congestion.
- The roundabout is meticulously designed, with greenery distributed along the road.

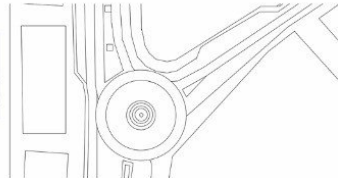

7. MASTER PLAN ANALYSIS

7.1. VEHICULAR MOVEMENT



7. MASTER PLAN ANALYSIS

7.4. Green Area



7.5. Active Space

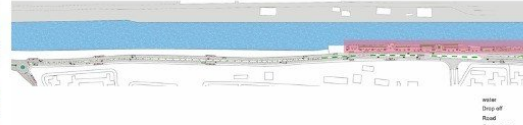

7. MASTER PLAN ANALYSIS

7.2. Bus Path

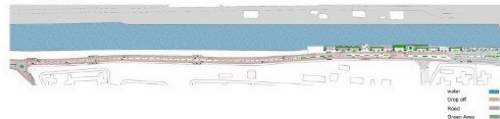

7.3. Drop Off

