

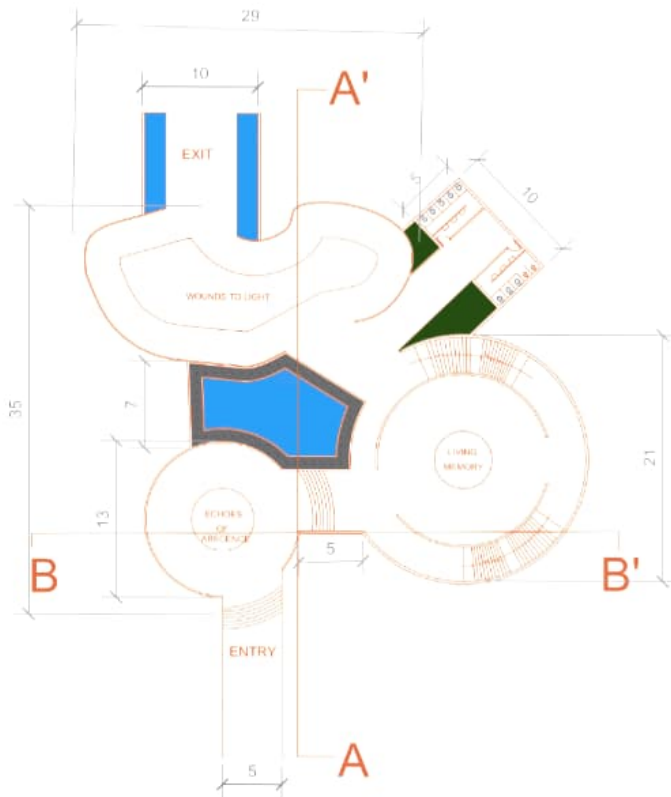

## FLOOR PLAN

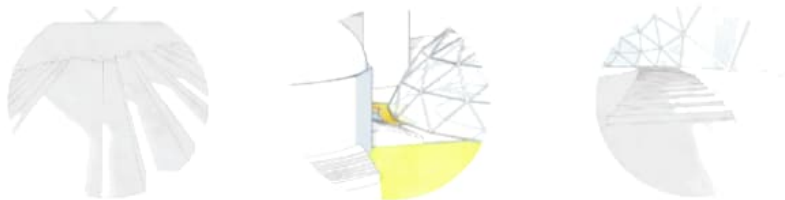

## SECTIONS

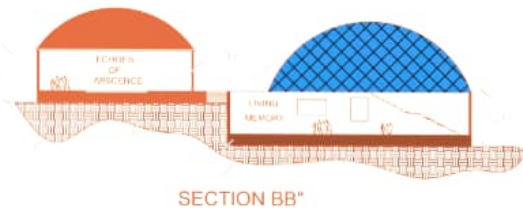
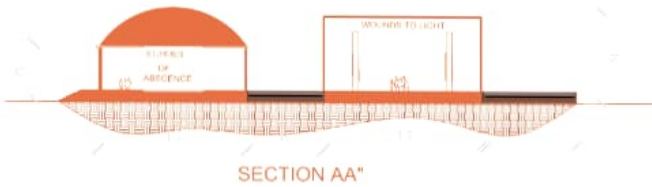

The underground gallery is designed as a Living Memory, where memory is experienced through movement, light, and space rather than static display.

Visitors descend and emerge through circular staircases, symbolizing a journey between past and present

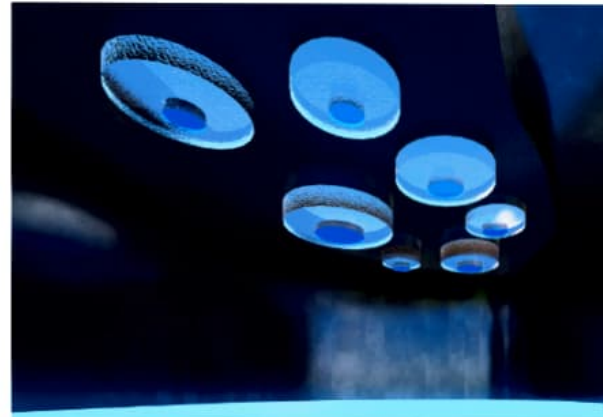

Wound to Light is the final chamber in the gallery sequence – a space of emotional release and healing.

Here, light becomes the primary artifact, replacing static objects with projections, reflections, and temporary immersive installations.

Suspended luminous forms emerge from darkness like openings within a wound, symbolizing recovery after trauma and remembrance.

The gallery acts as a transitional threshold between the enclosed emotional journey and the reflective outdoor retention pond beyond, allowing visitors to leave the space with a sense of calm, release, and renewal.



This entrance chamber serves as a space of remembrance and reflection

Inspired by cave-like formations, the compressed stone walls and warm lighting create an intimate emotional atmosphere.

A beam of light from the ceiling falls into the central void, symbolizing presence within absence.

The inscribed walls preserve memories and traces of the past, transforming the space into a living memorial where history is left in the present.

