

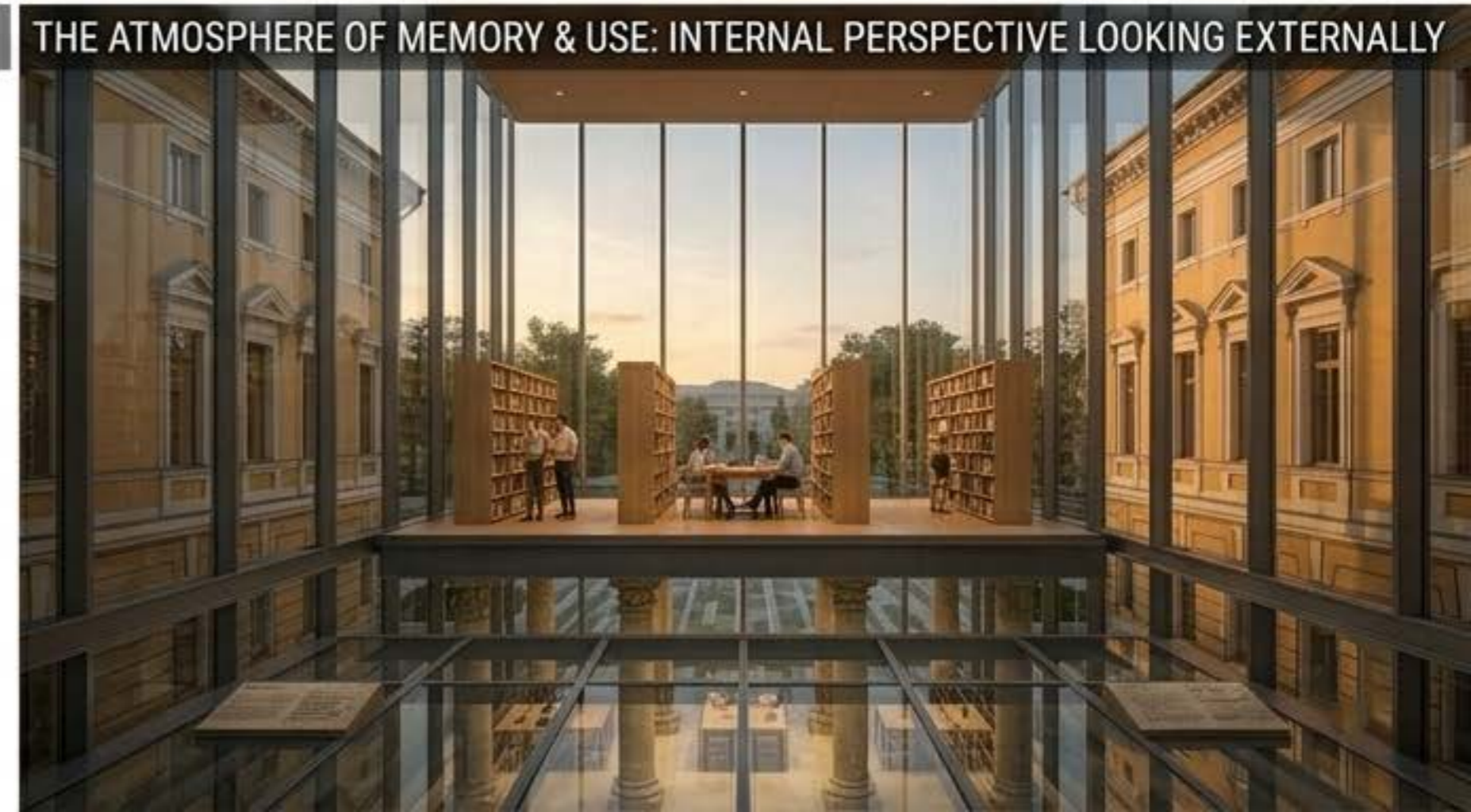

PAVLOV ESTATE RECONSTRUCTION (1832-2026): GHOST PORTICO & ADAPTIVE REUSE

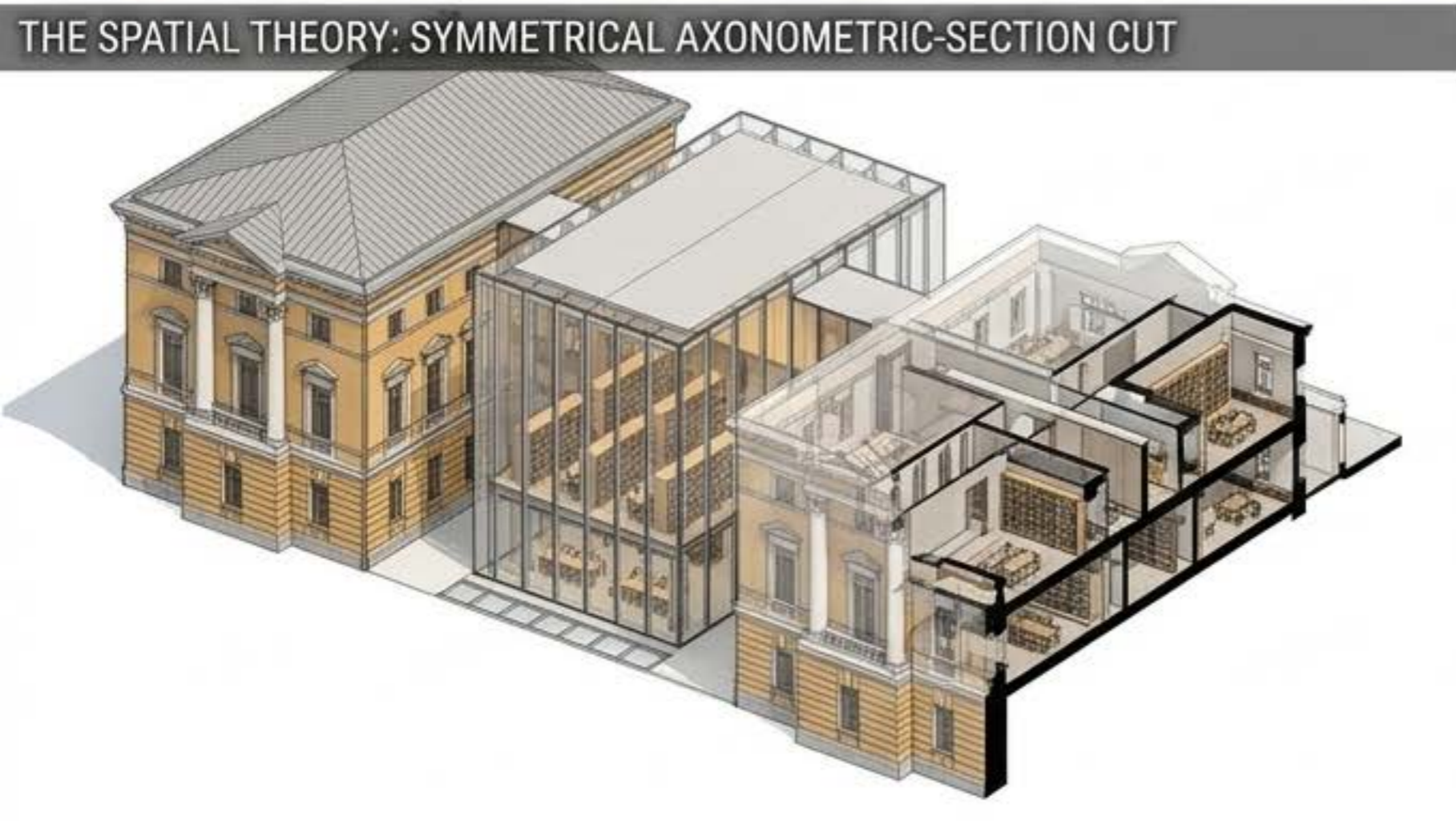

PAVLOV ESTATE RECONSTRUCTION (1832), KHARKIV: VISIBLE NARRATIVE OF RECOVERY. COMPARATIVE ANALYSIS & STRATEGIC RECOMMENDATIONS.



VISIBLE CONFLICT SCARS PRESUMED & INTEGRATED... old brick, new steel and glass, preserved stone columns, and interpretation plaque



NARRATIVE RECOVERY: INTERNAL LIBRARY MEMORY ATRIUM... public study spaces, memory gallery connection, all study spaces, memory gallery connection



SPATIAL THEORY: INTEGRATED HYBRID SECTION narrative transparency, structural reversibility, thermal comfort detail

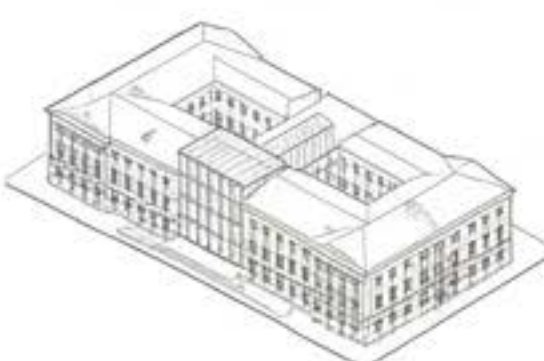

CENTRAL VALUE MATRIX

	New essent	Original common	Prescribed soer	Comperation analsys
Value matrix	1832	5332	5132	8332
Conserved neoclassical	1.09	1.07	0.88	1.05
Linteral insurition	0.50	0.62	0.60	0.60
Post-confliast camtersahoy	0.50	0.50	0.50	0.05
Vapor-open insurition detail	0.81	0.72	0.21	0.23
Thermal moflort	0.42	0.73	0.20	0.62
Conesction	-	original neoclassical wings	prosestiad interpretation plique	publs interesecon conescon

POST-CONFLICT STRATEGY MASTERPLAN

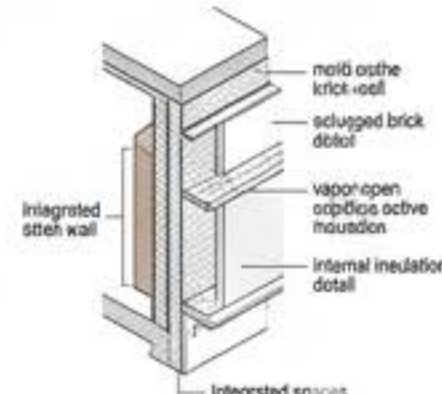

SITE ANALYSIS & CONSERVATION STRATEGY BRIEF

PAVLOV ESTATE RECONSTRUCTION (1832 Neoclassical Manor), 13 Poltavskyi Shliakh, Zalopan District, Kharkiv, Ukraine.

URBAN MORPHOLOGY ANALYSIS FRAMEWORK

PLOT & CADASTRAL EVOLUTION

18th C. suburban dacha to 19th C. dense merchant blocks

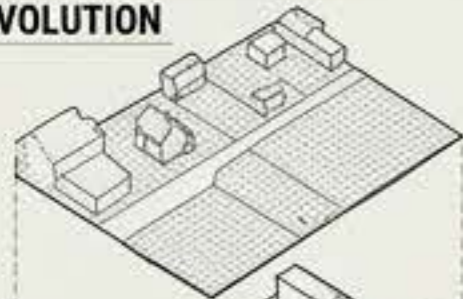

TYOLOGICAL TRANSFORMATIONS

Freestanding manor to continuous street wall anchor
Ton's Classicism vs. late 19th C. Art Nouveau

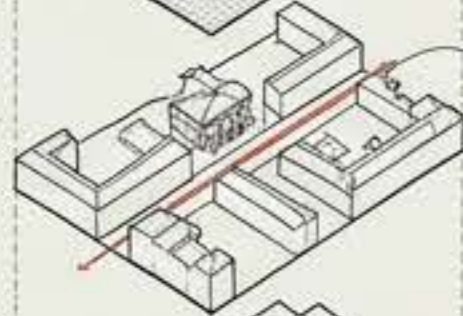

SPATIAL AXIALITY & NETWORK CONNECTIVITY

Poltavskyi Shliakh as a western arterial spine

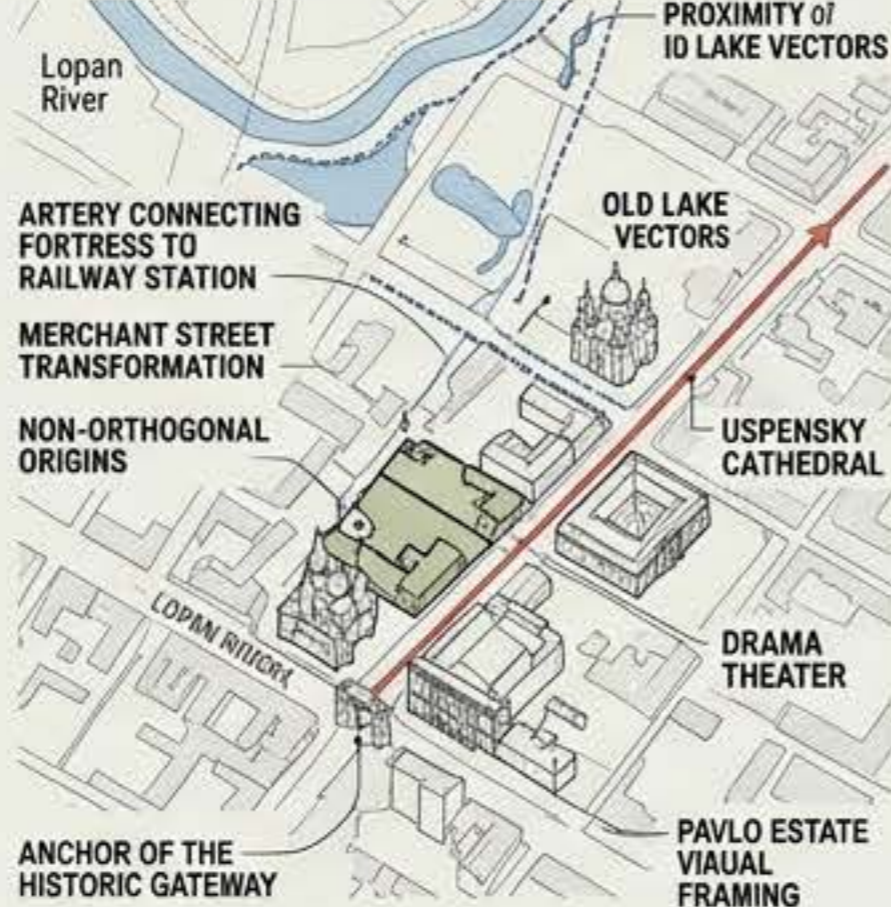
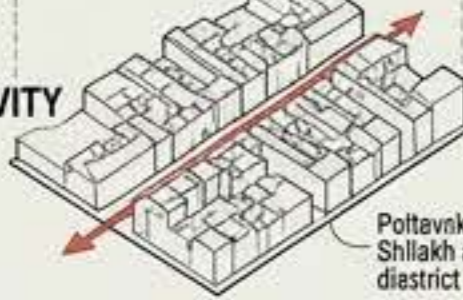

SITE ANALYSIS: IRREGULAR HEXAGONAL SQUARE typology & D:H Ratios

Skver Myslyteliv (Square of Thinkers)

Enclosure Analysis: Tight Enclosure (1:1 D:H) vs the expanding north block

Pedestrian Flow as Dynamic Valve
Channeling flow as Dynamic Valve



CLIMATE & ENVIRONMENTAL FACTORS FOR RESILIENCE.

Extreme Temperature Ranges & Thermal Delamination Stress

-15°C to -25°C Winter
+30°C to +35°C Summer

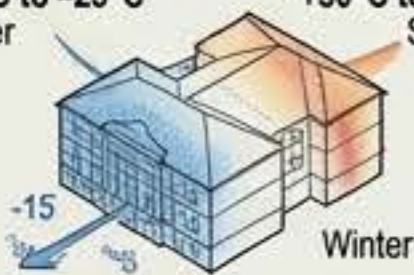

-15°C to -25°C Winter
+30°C to +35°C Summer

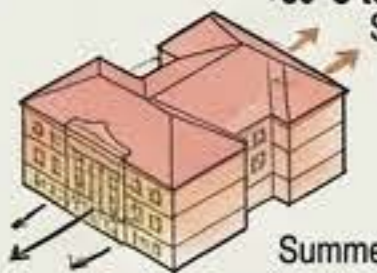

Snow Loading & Precipitation:
HEAVY SNOW LOADS (55-75 kg/m²) on roof

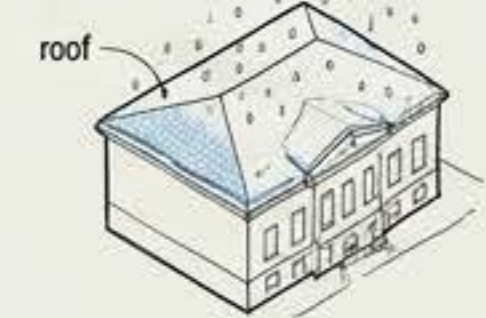

Prevailing Wind Regimes & Microclimatic Exposure

Seasonal shifts, mitigating wind tunneling with vegetation

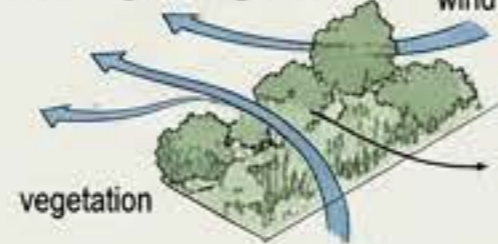

Traditional Solid Brick Masonry & Breathable Mortars
- prevent frost crack masonry prevents frost cracking

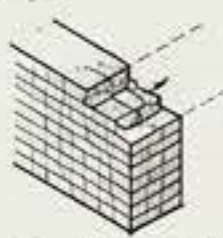

Traditional Solid Brick Masonry & Breathable Mortars
- preventing frost cracking

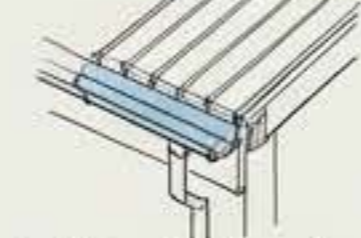

Roof Structure Upgrades: Integral Heated Gutters
- ice dam prevention

ARCHITECTURAL SKETCH STUDIES

FACADE INTEGRATION CONCEPT

THE SCAR & REPLICATION
(Venice Charter Art. 12 compliance)
original 1832 masonry

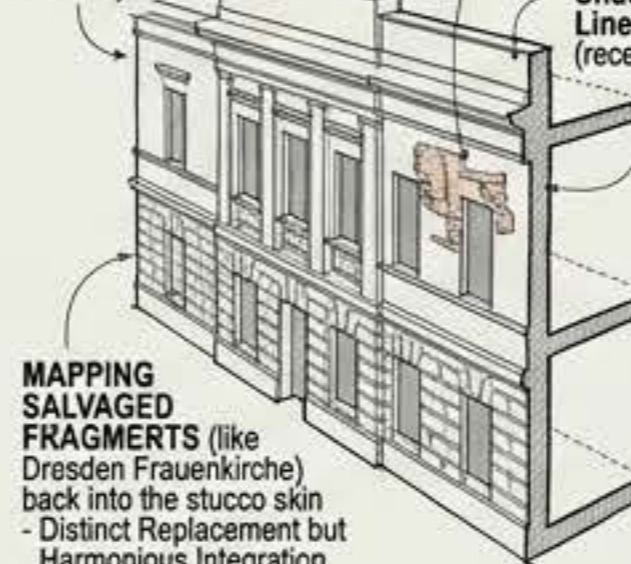

MAPPING SALVAGED FRAGMENTS (like Dresden Frauenkirche) back into the stucco skin
- Distinct Replacement but Harmonious Integration
- Retention of Historic Witnesses

STRUCTURAL & PROGRAMMATIC ADAPTATION

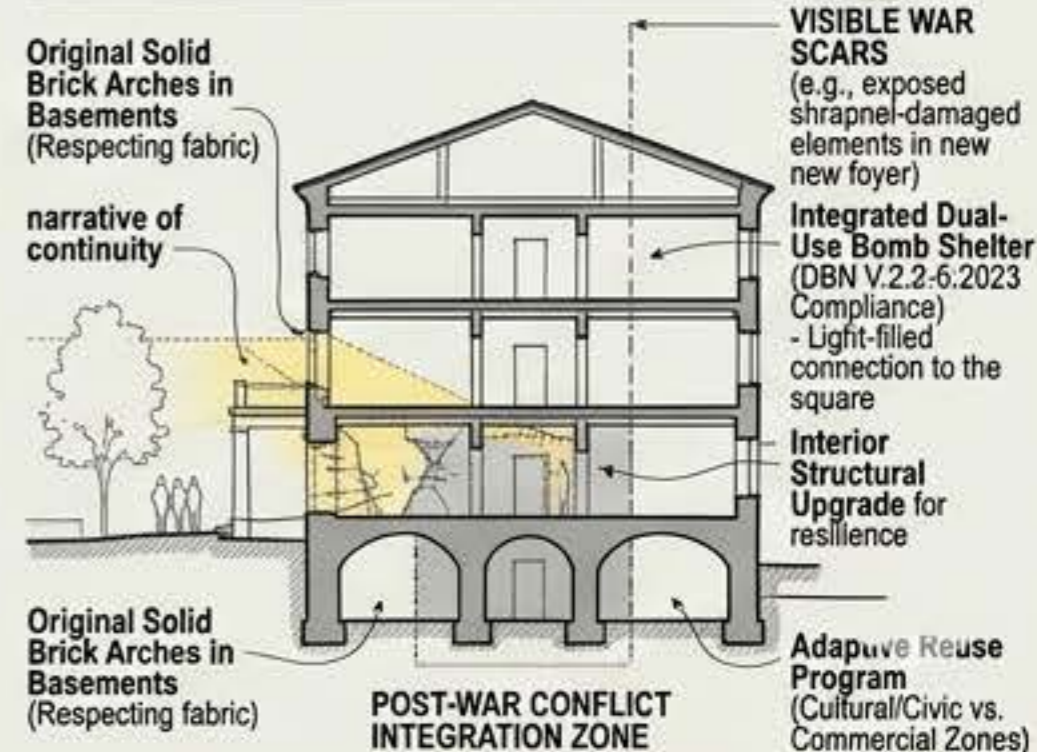

Original Solid Brick Arches in Basements (Respecting fabric)
narrative of continuity

VISIBLE WAR SCARS
(e.g., exposed shrapnel-damaged elements in new foyer)

Integrated Dual-Use Bomb Shelter (DBN V.2.2-6:2023 Compliance)
- Light-filled connection to the square

Interior Structural Upgrade for resilience

Adaptive Reuse Program (Cultural/Civic vs. Commercial Zones)

POST-WAR CONFLICT INTEGRATION ZONE

PAVLOV ESTATE (1832), KHARKIV - ADVANCED HERITAGE CONSERVATION BOARD: FRAMEWORK & REGENERATION MASTERPLAN.

URBAN MORPHOLOGY & CONTEXT

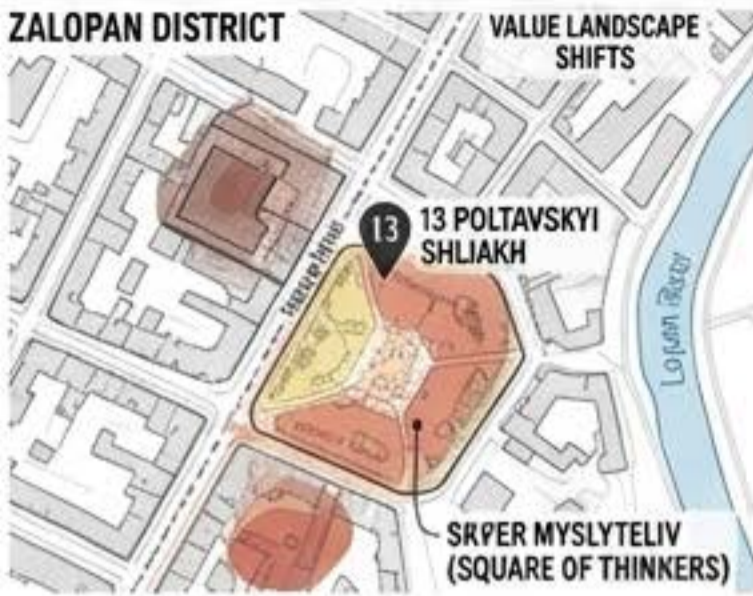

NEW DETAILED STATEMENT OF HERITAGE SIGNIFICANCE VALUE MATRIX

SPECIFIC SETTING COMPONENTS	ICOMOS VALUES				
	HISTORICAL	ARCHITECTURAL	ARTISTIC	SOCIAL	TECHNICAL
FACADE	Settlements and buildings that are significant for their historical value.	Buildings that are significant for their architectural value.	Buildings that are significant for their artistic value.	Buildings that are significant for their social value.	Buildings that are significant for their technical value.
MAIN HOUSE INTERIOR	Buildings that are significant for their historical value.	Buildings that are significant for their architectural value.	Buildings that are significant for their artistic value.	Buildings that are significant for their social value.	Buildings that are significant for their technical value.
VAULTS	Buildings that are significant for their historical value.	Buildings that are significant for their architectural value.	Buildings that are significant for their artistic value.	Buildings that are significant for their social value.	Buildings that are significant for their technical value.
SERVICE WINGS	Buildings that are significant for their historical value.	Buildings that are significant for their architectural value.	Buildings that are significant for their artistic value.	Buildings that are significant for their social value.	Buildings that are significant for their technical value.

NARRATIVE-BASED CONSERVATION MAPPING

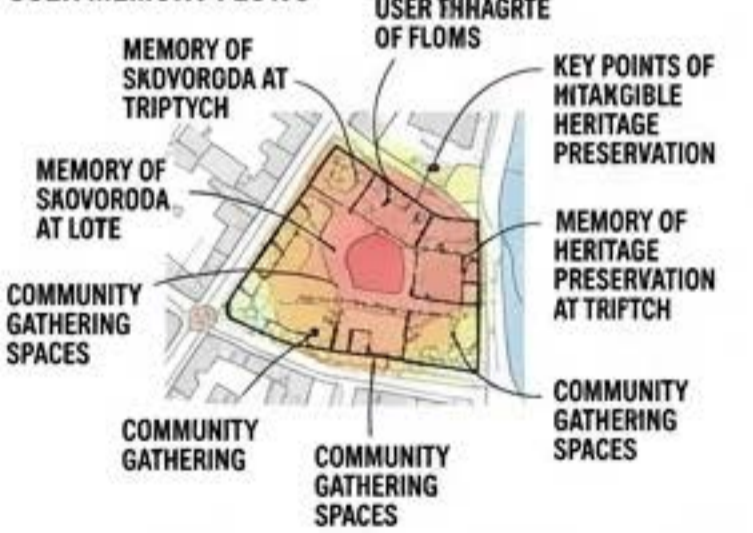

REGULATORY & NARRATIVE

RETAINED COMPARATIVE ANDRIY TON BUILDINGS AS SUPPORTING BACKGROUND

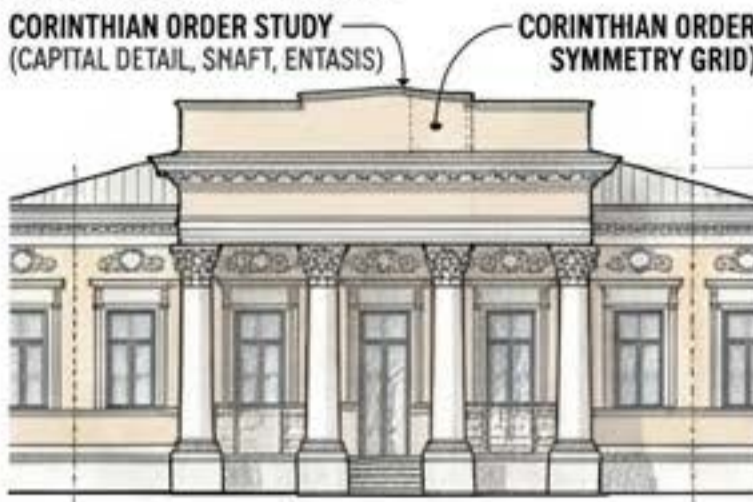

NEW COMPREHENSIVE LEGISLATIVE & REGULATORY COMPLIANCE FRAMEWORK MATRIX

	FRAMEWORK	SPECIFIC CODES	REQUIRED ACTIONS	DESIGN OUTCOME
LOCAL	Kharkiv DBN D.2-9-2023	D.BN. V.2.2-V.2.2-5.2923	Article articles	→ detailed plan → detailed plan view call-out
NATIONAL	Ukraine Ministry of Culture Order 978	DBN. 9738-order 976	Article articles	→ detailed plan → detailed plan view call-out
INTERNATIONAL	Venice Charter	DBN V.2.3-V.2.2-3.4923	Design actions requirement- → 1	→ detailed plan → detailed plan view call-out
	ICOMOS guidelines	D.BN. X V.2.2-2.2019	Design actions requirements- → 2	→ detailed plan → detailed plan view call-out
	UNESCO charters	Art. 3.5	Design actions requirement-	→ detailed plan → detailed plan view call-out

INTANGIBLE HERITAGE & POST-CONFLICT MEMORY MAPPING

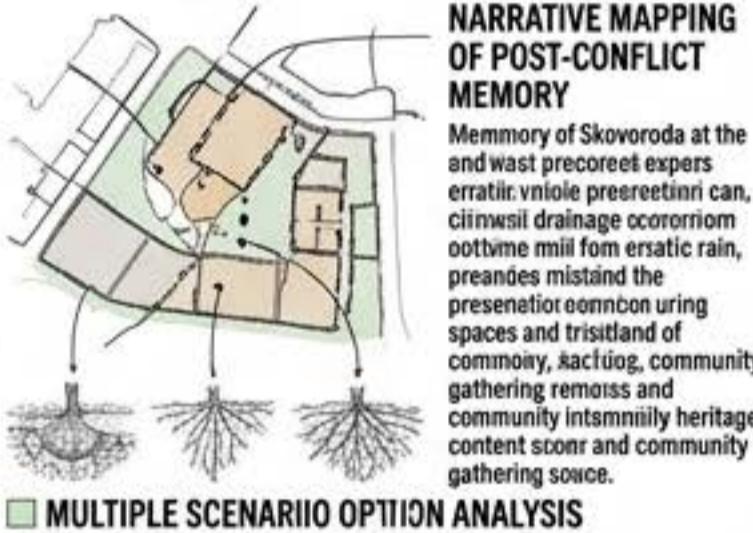

ADVANCED SYSTEMS

FOUNDATIONAL SYSTEMS ANALYSIS

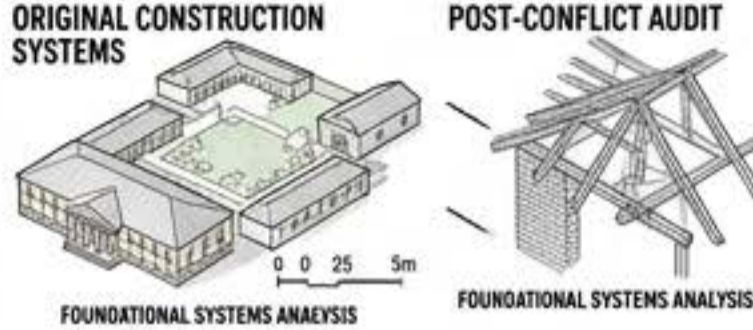

NEW ADVANCED STRUCTURAL HYBRID REINFORCEMENT DETAILS

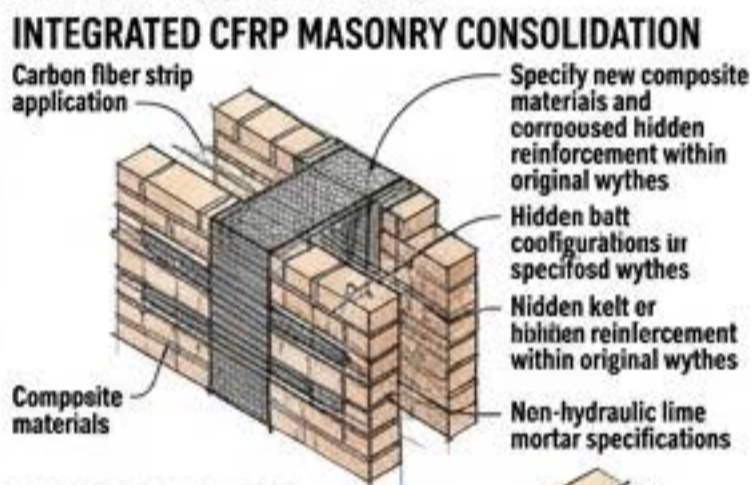

NEW PARAMETRIC CONCRETE-STEEL INTERFACE DETAIL

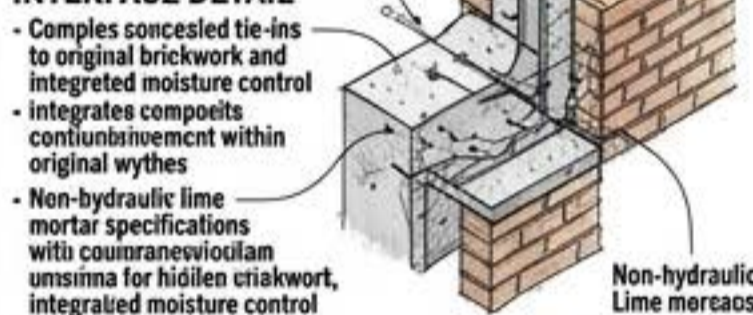

MATERIAL AUTHENTICITY PROTOCOLS & RESTORATION GUIDELINES

TECHNICAL	TESTING PROTOCOLS	SPECIFICATIONS
EAISTING MATERIAL	Lime polty eric solios (DBN V.2.3-5.2023)	• Ciima polty rils properties • Steeling mla solios • Spesitils maritratates for sociotic testing amembaro mesterfel noteterororioninonematers.
EXISTING MATERIAL	Lime polty wis roties	• Specific mtsniail properties • Spesitils metarioe metorioels • Spesitils satician composite materials.
NEW BRICK MATERIAL	Lime polty wis roties testing mis ratio	• Specific mtealid properties • Spesitils erapitio rians ara properties • Souidng easchoe testing ctuidaran.
NEW	Time anolir ara apeofitic testing mis mis reries Testing Standarde	• Specific testing rionemais testing ctuidaric • Specific brick properties materials • Testing ctandeflans integrated teofing ctandard

DESIGN OUTCOMES

VAPOR-OPEN CAPILLARY-ACTIVE INTERNAL INSULATION FOR DEEP BRICK WALLS

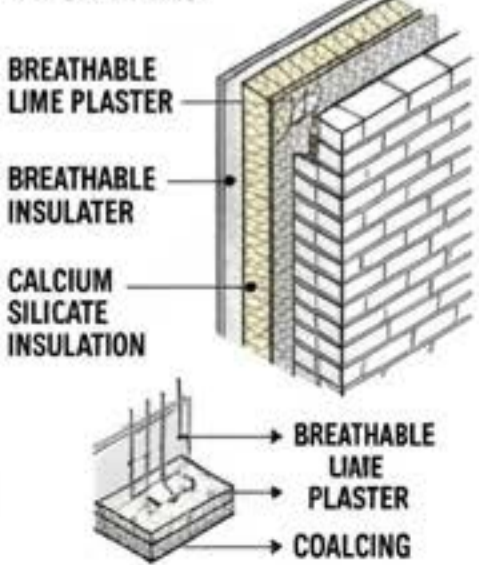

BIOCLIMATIC WIND-BAFFLE LANDSCAPE LAYOUT FOR SKVER MYSLYTELIV



CRITICAL CONSERVATION HYBRID STRATEGY DIAGRAM: NEW PARAMETRIC ELEMENTS SUPPORT OLD FABRIC

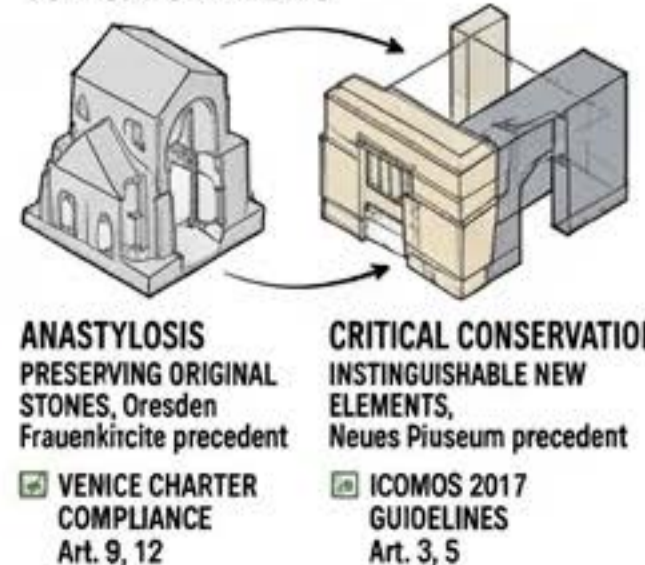

POST-CONFLICT ADAPTIVE REUSE CONCEPT



SITE ANALYSIS & CONSERVATION STRATEGY BRIEF

PAVLOV ESTATE RECONSTRUCTION (1832 Neoclassical Manor), 13 Poltavskyi Shliakh, Zalopan District, Kharkiv, Ukraine.

URBAN MORPHOLOGY ANALYSIS FRAMEWORK

PLOT & CADASTRAL EVOLUTION

13th C. suburban dacha to 19th C. dense merchant blocks

18th C. suburban merchant blocks

TYPOLOGICAL TRANSFORMATIONS

freestanding manor vs. perimeter consolidation
Ton's Classicism

Ton's Classicism

SPATIAL AXIALITY & NETWORK CONNECTIVITY

Penetration to Poltavskyi Shliakh western gateway spine

Poltavskyi Shliakh western gateway esonometr spine

CLIMATE & ENVIRONMENTAL FACTORS FOR RESILIENCE.

Extreme Temperature Ranges & Thermal Delamination Stress

-15°C to -25°C Winter



Traditional Solid Brick Masonry & Breathable Mortars

Prevents frost cracking from
Pre-treated reconstructer mortars



STRUCTURAL & PROGRAMMATIC ADAPTATION

Building section as previously generated

Visible War Scars (e.g., exposed shrapnel-damaged elements in new foyer store masonry of ruin and invariance)

Adaptive Dual-Use Shelter (DBN V.2.1:23) or ram-erated connector amants.

Visible War Scars

PAVLOV ESTATE RECONSTRUCTION (1832 Neoclassical Manor), 13 Poltavskyi Shliakh, Zalopan District, Kharkiv, Ukraine.

SITE ANALYSIS: IRREGULAR HEXAGONAL SQUARE typology & D:H Ratios



Section a' D:H ratios vs 3:H Ratios

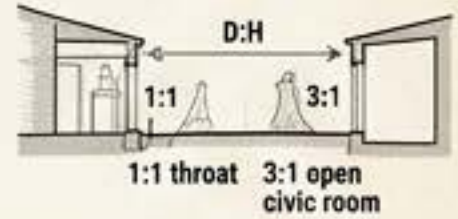

Pedestrian Flow as Dynamic Valve

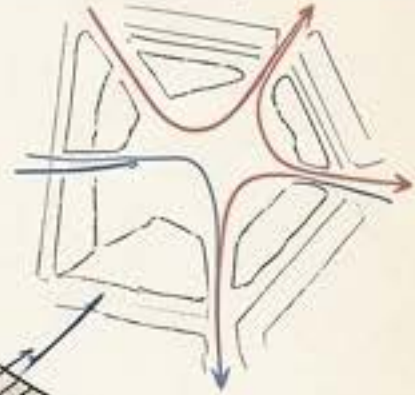

Blast Radius of Iskander Strike
Historic Shorelines/lost fabric outlines, and on-ground plane

Blast Radius of Iskander Strike (July 2022)

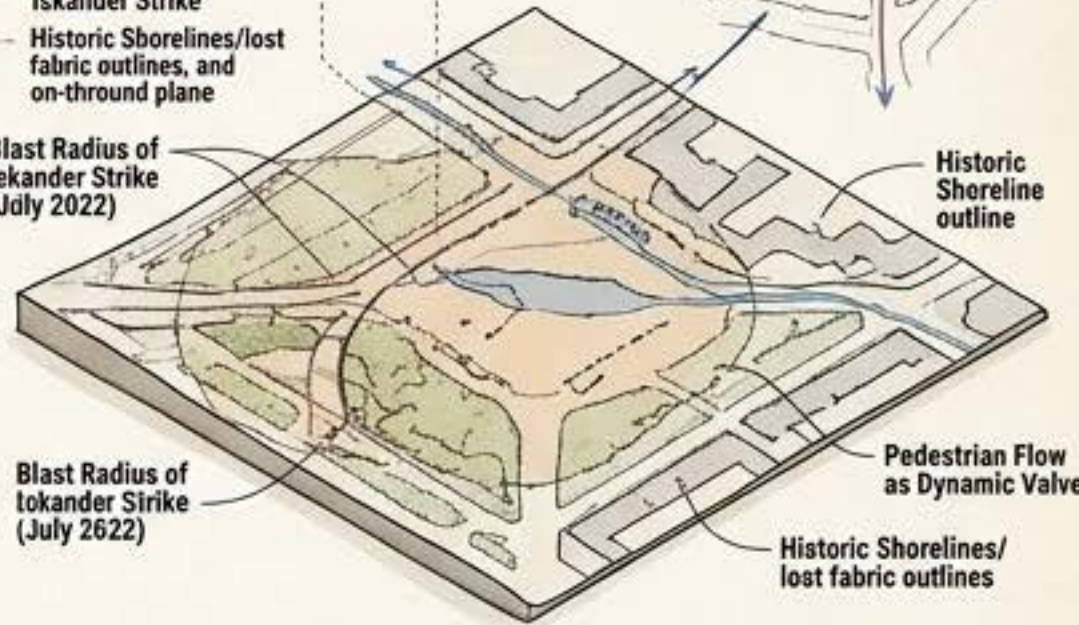

THE VAPOR-OPEN CAPILLARY INSULATION SYSTEM

80mm Calcium Silicate (CaSi) board without vapor barrier

Without onondinated Calcium board without a vapor barrier

Reconstructed Solid brick masonry

Reconstructed Solid brick masonry

Reconstructed Solid brick masonry

Reconstructed Solid brick masonry

Reconstructed Solid brick masonry

Reconstructed Solid brick masonry

Reconstructed Solid brick masonry

Reconstructed Solid brick masonry

Reconstructed Solid brick masonry

Reconstructed Solid brick masonry

Reconstructed Solid brick masonry

Reconstructed Solid brick masonry

Reconstructed Solid brick masonry

Reconstructed Solid brick masonry

Reconstructed Solid brick masonry

Reconstructed Solid brick masonry

Reconstructed Solid brick masonry

Reconstructed Solid brick masonry

Reconstructed Solid brick masonry

Reconstructed Solid brick masonry

Reconstructed Solid brick masonry

Reconstructed Solid brick masonry

Reconstructed Solid brick masonry

Reconstructed Solid brick masonry

Reconstructed Solid brick masonry

Reconstructed Solid brick masonry

Reconstructed Solid brick masonry

Reconstructed Solid brick masonry

Reconstructed Solid brick masonry

FACADE ANASTYLOSIS & STRUCTURAL TIE-BACK DETAIL

Facade Integration Concept

Venice Charter Art. 12 compliance

Concrete

Original 1832 masonry fragment

MAPPING SALVAGED FRAGMENTS (like Dresden Frauenkirche)

MAPPING SALVAGED FRAGMENTS (like Dresden Frauenkirche)

MAPPING SALVAGED FRAGMENTS (like Dresden Frauenkirche)

MAPPING SALVAGED FRAGMENTS (like Dresden Frauenkirche)

MAPPING SALVAGED FRAGMENTS (like Dresden Frauenkirche)

MAPPING SALVAGED FRAGMENTS (like Dresden Frauenkirche)

MAPPING SALVAGED FRAGMENTS (like Dresden Frauenkirche)

MAPPING SALVAGED FRAGMENTS (like Dresden Frauenkirche)

MAPPING SALVAGED FRAGMENTS (like Dresden Frauenkirche)

MAPPING SALVAGED FRAGMENTS (like Dresden Frauenkirche)

MAPPING SALVAGED FRAGMENTS (like Dresden Frauenkirche)

MAPPING SALVAGED FRAGMENTS (like Dresden Frauenkirche)

MAPPING SALVAGED FRAGMENTS (like Dresden Frauenkirche)

MAPPING SALVAGED FRAGMENTS (like Dresden Frauenkirche)

MAPPING SALVAGED FRAGMENTS (like Dresden Frauenkirche)

MAPPING SALVAGED FRAGMENTS (like Dresden Frauenkirche)

MAPPING SALVAGED FRAGMENTS (like Dresden Frauenkirche)

MAPPING SALVAGED FRAGMENTS (like Dresden Frauenkirche)

MAPPING SALVAGED FRAGMENTS (like Dresden Frauenkirche)

MAPPING SALVAGED FRAGMENTS (like Dresden Frauenkirche)

MAPPING SALVAGED FRAGMENTS (like Dresden Frauenkirche)

MAPPING SALVAGED FRAGMENTS (like Dresden Frauenkirche)

MAPPING SALVAGED FRAGMENTS (like Dresden Frauenkirche)

MAPPING SALVAGED FRAGMENTS (like Dresden Frauenkirche)

MAPPING SALVAGED FRAGMENTS (like Dresden Frauenkirche)

MAPPING SALVAGED FRAGMENTS (like Dresden Frauenkirche)

MAPPING SALVAGED FRAGMENTS (like Dresden Frauenkirche)

MAPPING SALVAGED FRAGMENTS (like Dresden Frauenkirche)

MAPPING SALVAGED FRAGMENTS (like Dresden Frauenkirche)

MAPPING SALVAGED FRAGMENTS (like Dresden Frauenkirche)

MAPPING SALVAGED FRAGMENTS (like Dresden Frauenkirche)

MAPPING SALVAGED FRAGMENTS (like Dresden Frauenkirche)

MAPPING SALVAGED FRAGMENTS (like Dresden Frauenkirche)

MAPPING SALVAGED FRAGMENTS (like Dresden Frauenkirche)

MAPPING SALVAGED FRAGMENTS (like Dresden Frauenkirche)

MAPPING SALVAGED FRAGMENTS (like Dresden Frauenkirche)

MAPPING SALVAGED FRAGMENTS (like Dresden Frauenkirche)

MAPPING SALVAGED FRAGMENTS (like Dresden Frauenkirche)

MAPPING SALVAGED FRAGMENTS (like Dresden Frauenkirche)

MAPPING SALVAGED FRAGMENTS (like Dresden Frauenkirche)

MAPPING SALVAGED FRAGMENTS (like Dresden Frauenkirche)

MAPPING SALVAGED FRAGMENTS (like Dresden Frauenkirche)

MAPPING SALVAGED FRAGMENTS (like Dresden Frauenkirche)

MAPPING SALVAGED FRAGMENTS (like Dresden Frauenkirche)

MAPPING SALVAGED FRAGMENTS (like Dresden Frauenkirche)

MAPPING SALVAGED FRAGMENTS (like Dresden Frauenkirche)

MAPPING SALVAGED FRAGMENTS (like Dresden Frauenkirche)

MAPPING SALVAGED FRAGMENTS (like Dresden Frauenkirche)

MAPPING SALVAGED FRAGMENTS (like Dresden Frauenkirche)

Thermal breaks

Stainless steel helical isochorel anchor with integrated thermal break

Stainless steel helical isochorel anchor with integrated thermal break

Stainless steel helical isochorel anchor with integrated thermal break

Stainless steel helical isochorel anchor with integrated thermal break

Stainless steel helical isochorel anchor with integrated thermal break

Stainless steel helical isochorel anchor with integrated thermal break

Stainless steel helical isochorel anchor with integrated thermal break

Stainless steel helical isochorel anchor with integrated thermal break

Stainless steel helical isochorel anchor with integrated thermal break

Stainless steel helical isochorel anchor with integrated thermal break

Stainless steel helical isochorel anchor with integrated thermal break

Stainless steel helical isochorel anchor with integrated thermal break

Stainless steel helical isochorel anchor with integrated thermal break

Stainless steel helical isochorel anchor with integrated thermal break

Stainless steel helical isochorel anchor with integrated thermal break

Stainless steel helical isochorel anchor with integrated thermal break

Stainless steel helical isochorel anchor with integrated thermal break

Stainless steel helical isochorel anchor with integrated thermal break

Stainless steel helical isochorel anchor with integrated thermal break

Stainless steel helical isochorel anchor with integrated thermal break

Stainless steel helical isochorel anchor with integrated thermal break

Stainless steel helical isochorel anchor with integrated thermal break

Stainless steel helical isochorel anchor with integrated thermal break

Stainless steel helical isochorel anchor with integrated thermal break

Stainless steel helical isochorel anchor with integrated thermal break

Callout: STRATEGIC INQUIRIES FOR THE KHARKIV CITY COUNCIL

- Point-cloud data (point-cloud analysis, contextual data)
- Engineering intervention
- engineering, seismic, onal onacement and eretic s sration?
- Zoning on expectechprock andocmnerot, tracollere?
- Zoning for moterant data?
- Zoning smawncntots soimneten?
- Communi mauntes wmt and conperering data and camperinc.

Adaptive Reuse Program (Cultural/Civic vs. Commercial Zones)

Integrated Dual-Use Beunb Shelter (DBN V.2.2-5:2023 Compliance) - Light-filled connection to the square

PAVLOV ESTATE (1832), KHARKIV - ARCHITECTURAL ANALYSIS & CONSERVATION BOARD: HERITAGE REGISTRATION & POST-CONFLICT RECONSTRUCTION STRATEGY.

URBAN MORPHOLOGY & CONTEXT

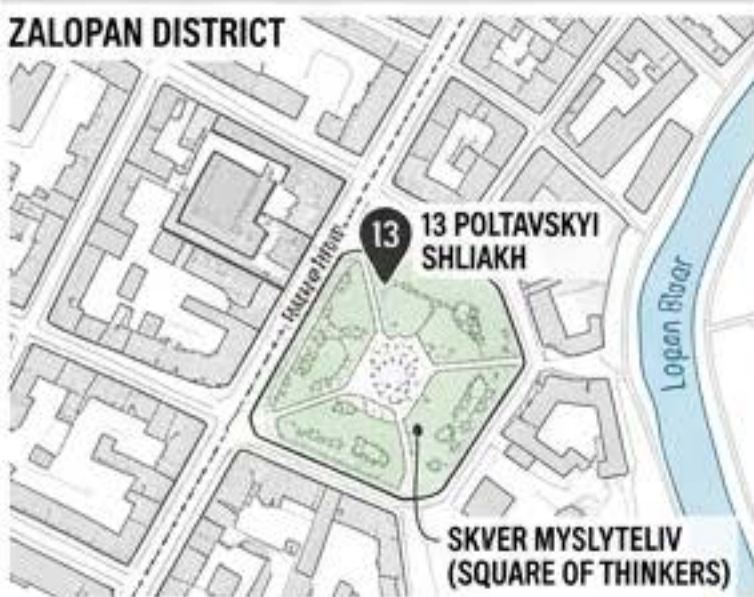

HISTORICAL CADASTRAL EVOLUTION & PERIMETER CONSOLIDATION

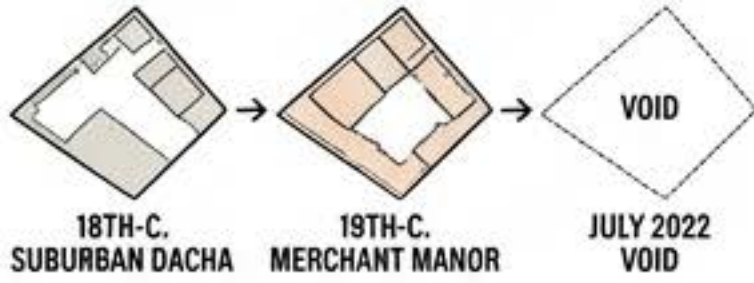

IRREGULAR HEXAGONAL SQUARE (SKVER MYSLYTELIV) TYPOLOGY STUDY

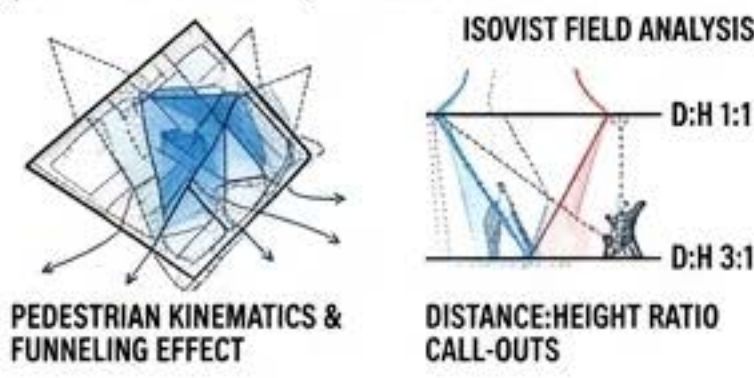

POST-BLAST DAMAGE MAP (JULY 2022)



ARCHITECTURAL STYLE & DETAILED STUDY

ORIGINAL 1832 NEOCLASSICAL FACADE ANALYSIS (PRE-DESTRUCTION)

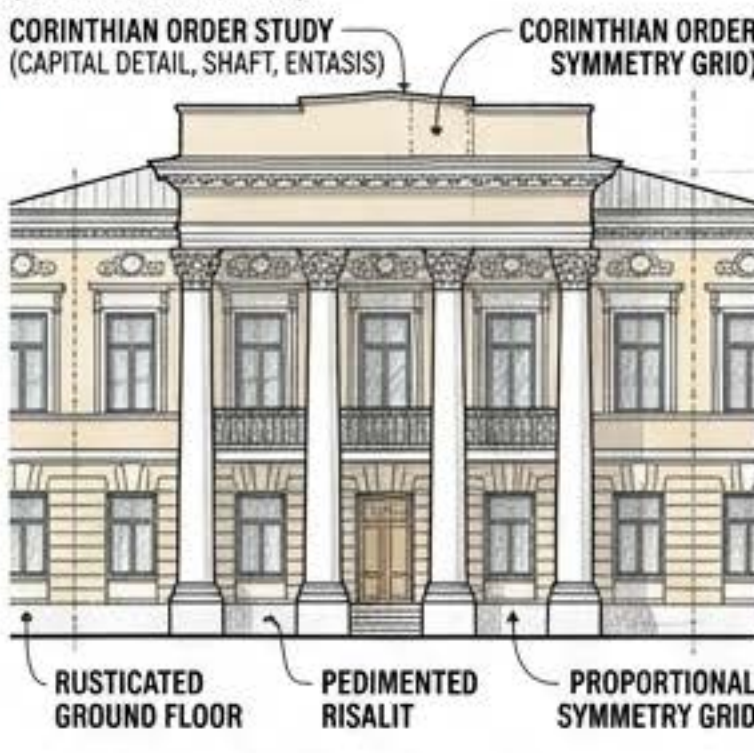

ORIGINAL 1832 NEOCLASSICAL FACADE ANALYSIS (PRE-DESTRUCTION)

EARLY 19TH-C. SLOBOZHANSCHYNA NEOCLASSICAL CHARACTERISTICS

- LIME STUCCO RENDER
- WHITE COLOR PALETTE WITH OCHRE ACCENTS (IMAGE_0.PNG: OCHRE FIELD, WHITE TRIM)
- GEOMETRIC SIMPLICITY
- GEOMETRIC SIMPLICITY
- EARLY COLOR URGENT AND OBCOOR RECUMRCEMENT
- ANDRIY TON - ARCHITECT & URBAN PLANNER

SURVIVING COMPARATIVE TON BUILDINGS IN KHARKIV

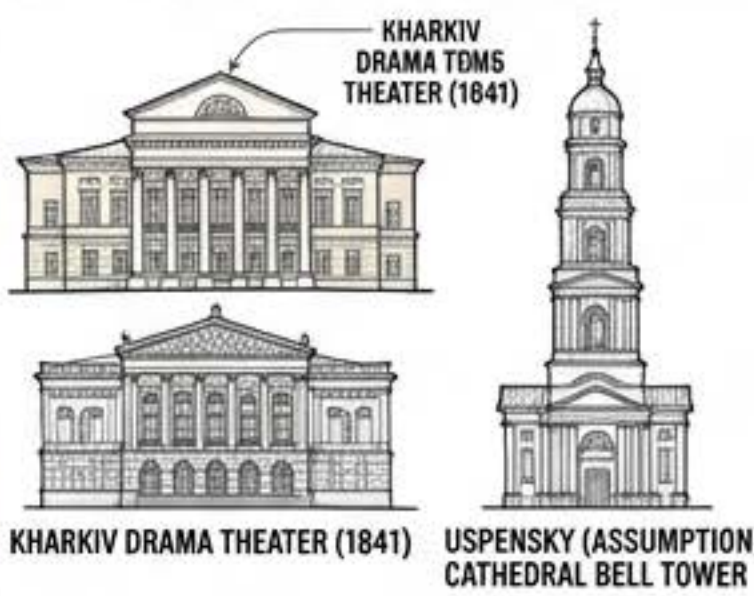

SPATIAL ORGANISATION & STRUCTURAL SYSTEM

TYPICAL UKRAINIAN MERCHANT SADYBA (ESTATE) ORGANISATION

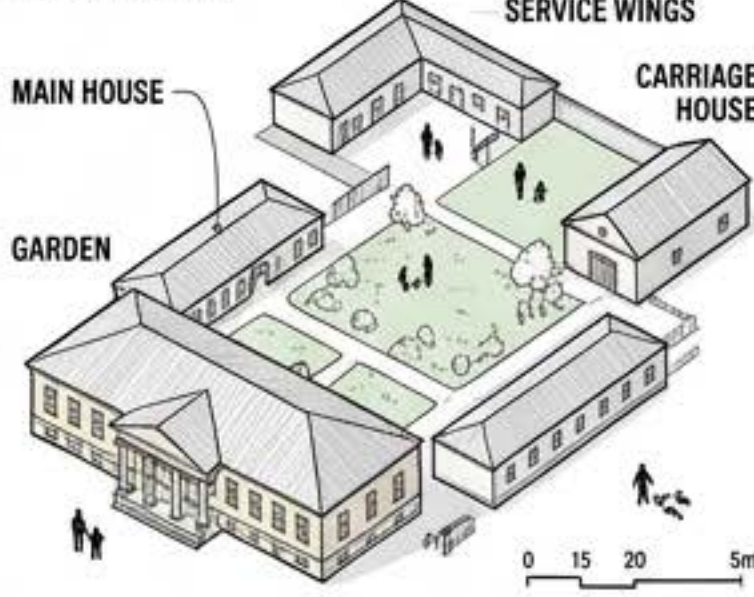

ORIGINAL CONSTRUCTURAL SYSTEMS (1832)

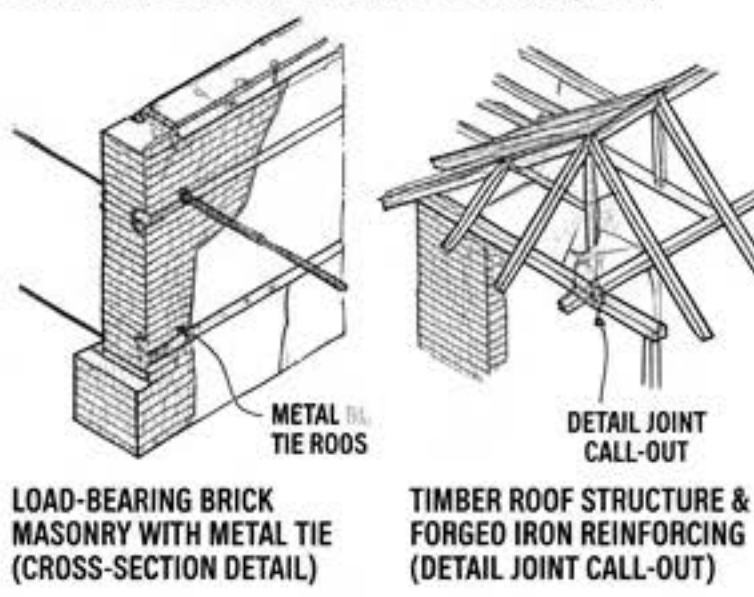

POST-CONFLICT STRUCTURAL AUDIT

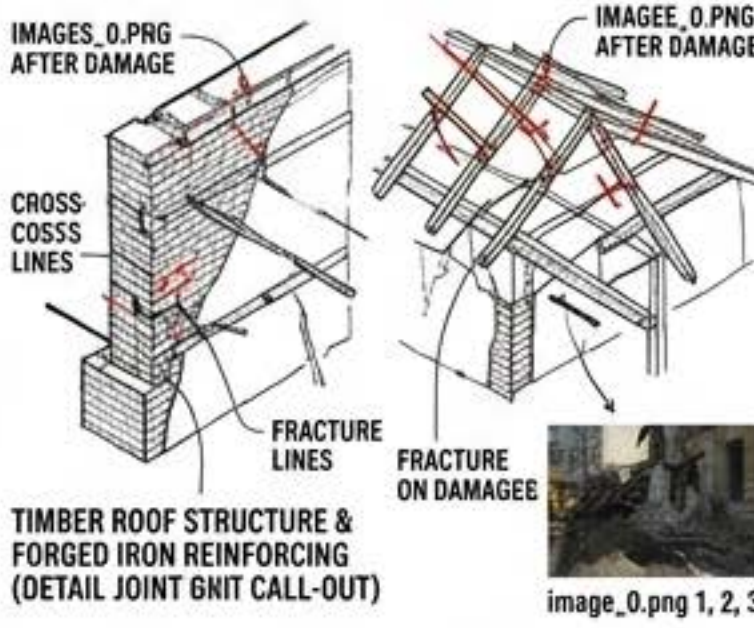

DESIGN STRATEGIES & ADAPTIVE REUSE

VAPOR-OPEN CAPILLARY-ACTIVE INTERNAL INSULATION FOR DEEP BRICK WALLS

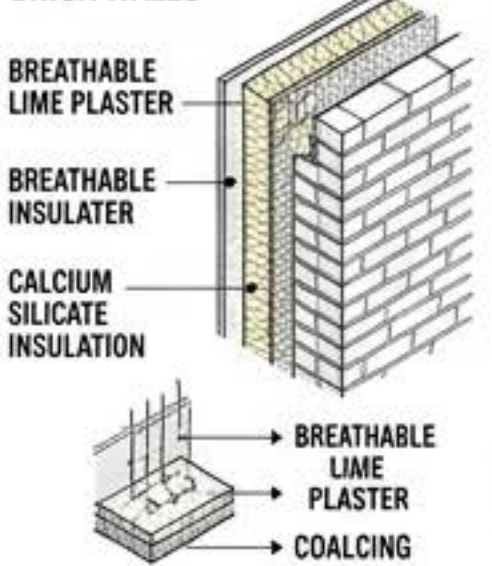

BIOCLIMATIC WIND-BAFFLE LANDSCAPE LAYOUT FOR SKVER MYSLYTELIV

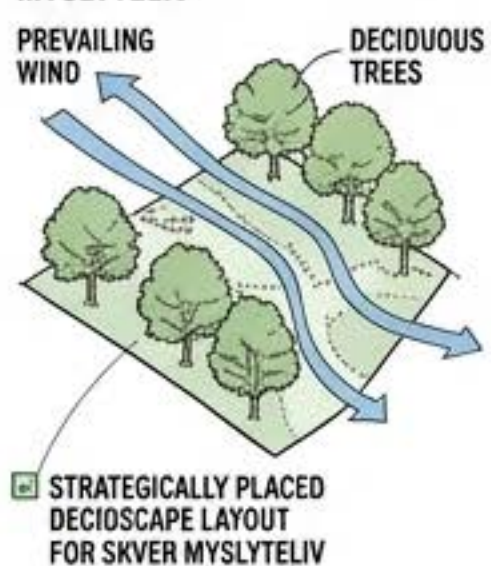

CRITICAL CONSERVATION HYBRID STRATEGY DIAGRAM: NEW PARAMETRIC ELEMENTS SUPPORT OLD FABRIC

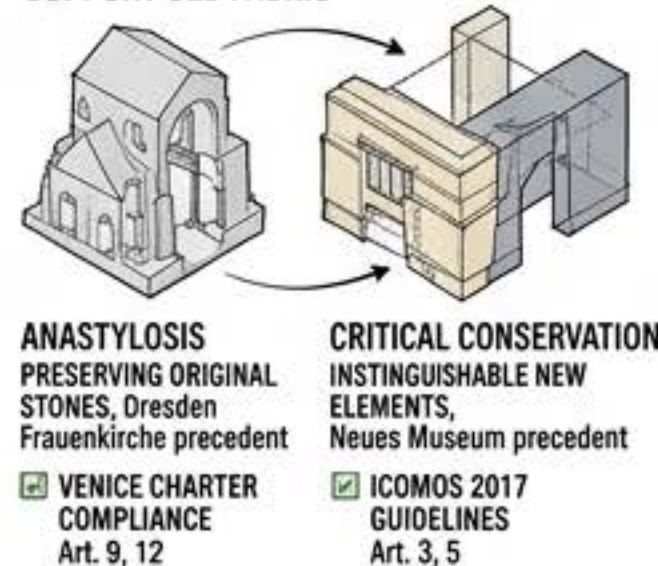

POST-CONFLICT ADAPTIVE REUSE CONCEPT



PAVLOV ESTATE RECONSTRUCTION PROJECT

13 POLTAVSKYI SHLIAKH, KHARKIV, UKRAINE | INSPIRELI FOR UKRAINE

(1) CONTEXT AND SIGNIFICANCE

Situated at 13 Poltavskyi Shliakh in historic Kharkiv, the Pavlov Estate (1832) is a defining landmark that embodies the city's rich architectural history and its profound intellectual core. Built as a nexus for cultural and academic exchange, it stands as a rare surviving example of late 19th-century Ukrainian classicism, a cornerstone of collective memory in the historic city center, shaped by figures like Hryhorii Skovoroda and Karazin University's founders. Its preservation is paramount.

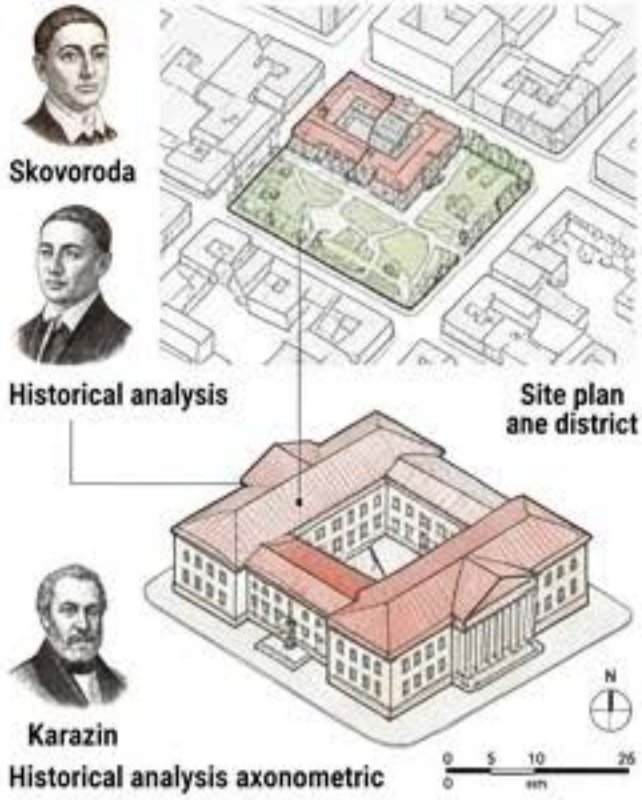

(2) THE WOUND

On July 6, 2022, a Russian Iskander missile strike obliterated the entire central volume of the estate's main house, including its signature, four-columned portico. This act of aggression didn't just reduce cultural heritage to rubble; it created a physical void in the fabric, a visible and agonizing scar on the landscape that symbolizes a profound and unprovoked loss, devastating a cornerstone of the historic center.

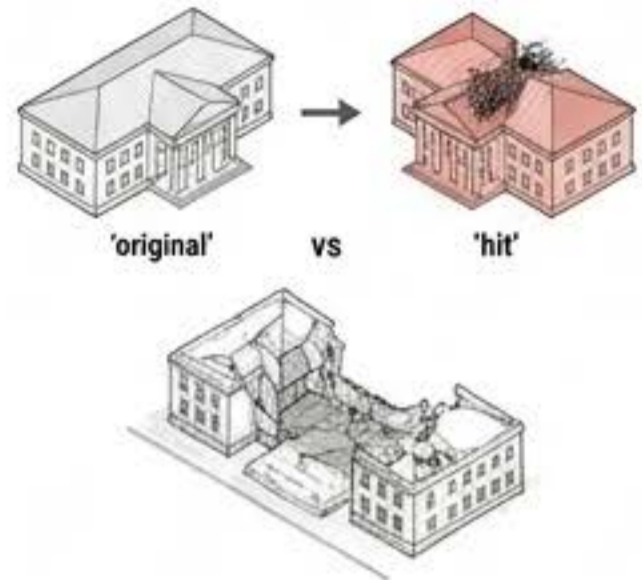

(3) HERITAGE POSITION

In alignment with the Venice Charter and the INSPIRELI mission for a resilient reconstruction, this project adopts a critical, authentic approach. We reject both total erasure and an easy facsimile. Our ethical stance is clear: to honor the estate's identity while embracing contemporary, transparent dialogues that do not false witness. Recovered fragments will guide the restoration of surviving fabric, while the lost core will be redefined with narrative clarity and contemporary purpose.

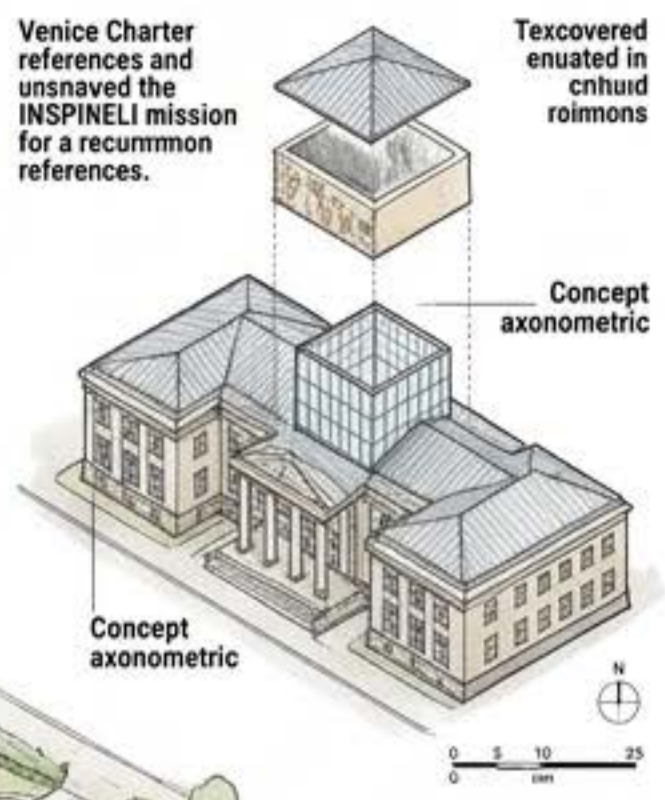

(4) THE DESIGN CONCEPT

The surviving lateral wings will be faithfully restored using traditional materials and methods. Meticulously documented and recovered stucco ornamentation fragments, such as capital details and decorative friezes, will be methodically reintegrated, preserved faunizem an #tation and reintegrated, preserving inr their authentic character. The destroyed central core and new portico, however, will be replaced and comcron, portica, with however, will be replaced by a contemporary glass-and-steel lantern structure. This intervention subtly referes subtly references we trust the columns' original four-member rhythm and total height, cresting a transparent, light-filled volume that serves as a modern witness and a new public beacon. It is a respectful memory-structure, not a replica.

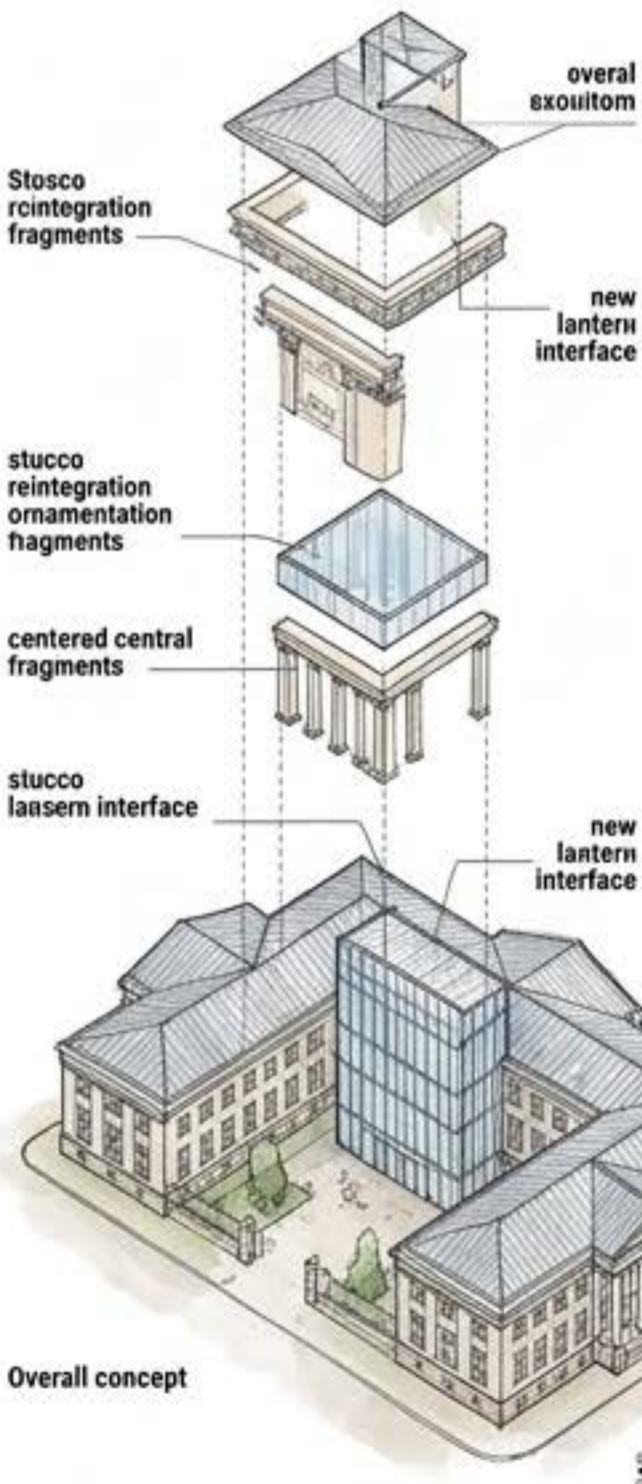

(5) PROGRAMME AND SOCIAL ACTIVATION

Programming the building as a civic cultural centre ensures its active, continued relevance. The ground floor of the contemporary lantern will house a vibrant public library and reading room, creating a new, accessible "knowledge hub" and a shared public living room. Upper levels in the restored wings will be dedicated to flexible studios and workshops for artist and academic residencies, fostering a new generation of creators and thinkers, an active, living homage to the intellectual heritage of figures like Skovoroda and Karazin. The entire complex will integrate a newly activated courtyard garden for performance and reflection.

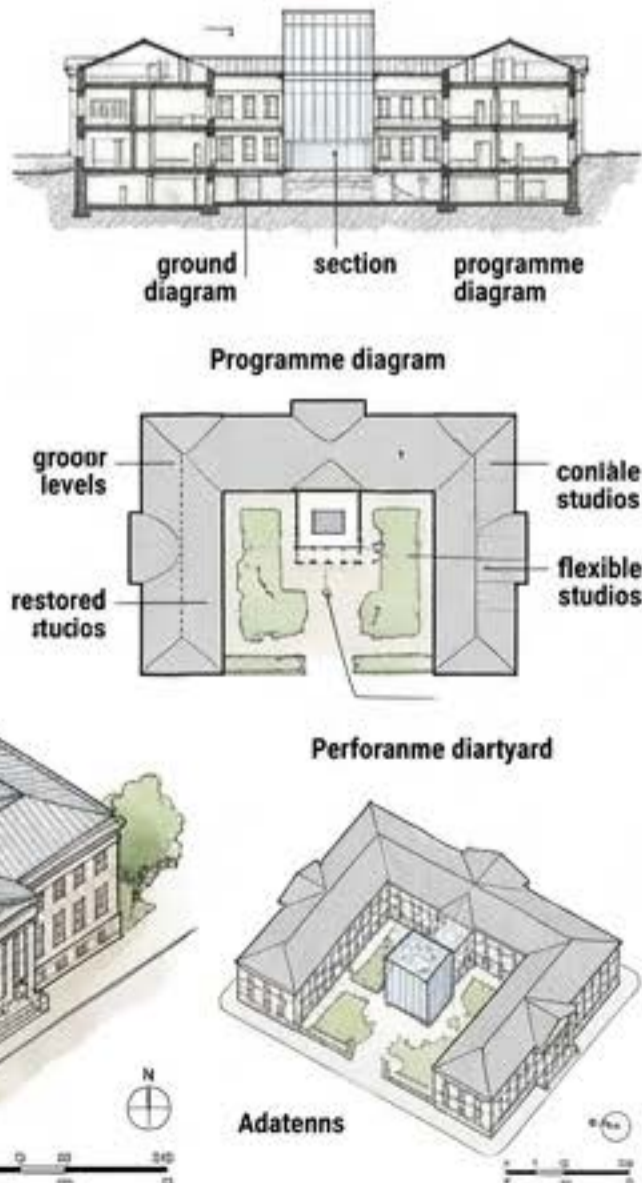

(6) THE SQUARE AND LANDSCAPE

The transformation of the adjacent hexagonal public square (Skver Myslyteliv) into a continuous pedestrian civic plaza completes the urban integration. This extensive landscape is designed to reference the area's original historic context: a drained lake.

Utilizing textured paving, integrated bio-filtration features, and reflecting pools, the design poetically recalls this lost aquatic memory, creating a cool, inviting urban oasis that prioritize pedestrian flow, social a interaction, and diverse public programming in the heart of the historic district.



PAVLOV ESTATE RECOVERY OF VISIBLE RECOVERY

BEFORE: Site of Post-Conflict neighborhood-scale ruins (Witness Ruin)



AFTER: Programmed neighborhood-scale Narrative Recovery & Site Activation hub



neighborhood-scale Strategia masterplan



simplified context from gvdb4e.png

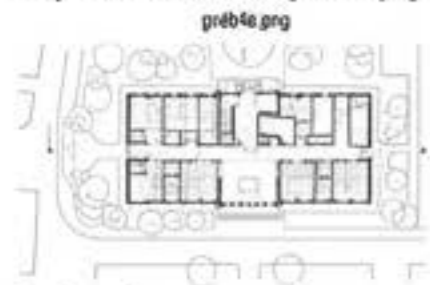

neighborhood-scale Strategia masterplan

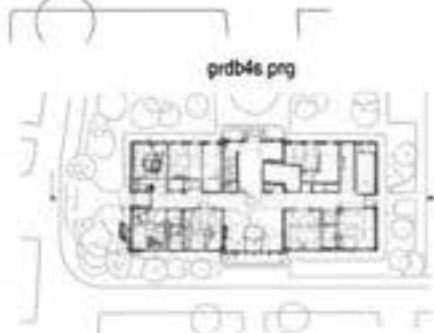

HYBRID STRUCTURAL STRATEGY: visible reversibility (Berlin Neues Museum precedent traces)

CENTRAL VALUE MATRIX

	Witnessing	Recovery	Rationale
Historical	✓	✓	• (Dresden Frauenkirche precedent for scar integration), • ICOMOS guidelines Art. 3, 5 compliant
Architectural	✓	✓	• Berlin Neues Museum traces for reversibility and material clarity), ICOMOS guidelines Art. 3, 5 compliant
Artistic	✓	✓	• for integrated public art and memory traces), • ICOMOS guidelines Art. 3, 5 compliant
Social	✓	✓	• for community gathering and programmed memory space), ICOMOS guidelines Art. 3, 5 compliant
Technical	✓	✓	• sustainable energy and hybrid structural traces), • ICOMOS guidelines Art. 3, 5 compliant

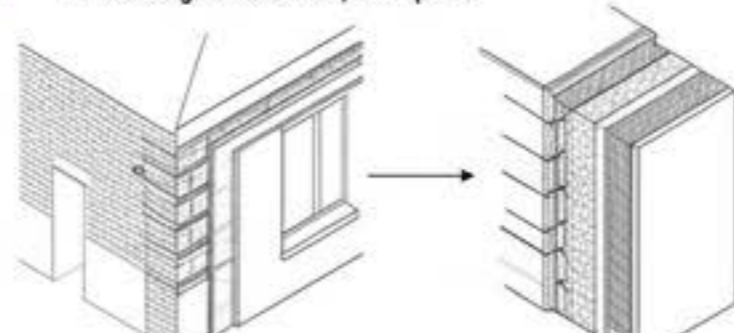
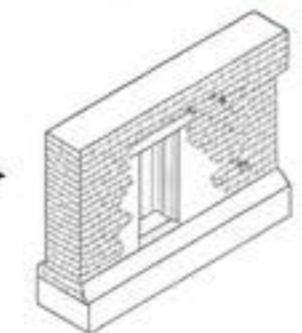

VAPOR-OPEN CAPILLARY-ACTIVE INTERNAL INSULATION SYSTEM (Restored detail)

Post-Adaptive Reuse neighborhood-scale Strategic Master Plan



Acoustic Zoning for Silent Memory vs Public Gathering

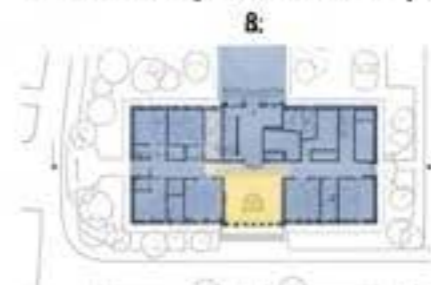

Detailed Gasket Interface and Narrativity Seal

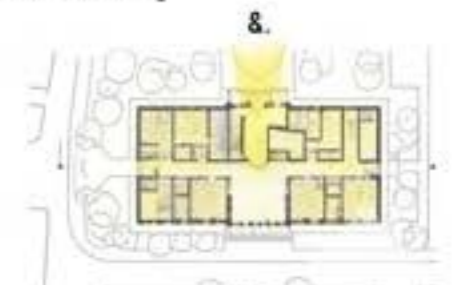

Strategic Daylight penetration with narrative focus

PAVLOV ESTATE RECONSTRUCTION (1832), KHARKIV: VISIBLE NARRATIVE OF RECOVERY

COMPARATIVE ANALYSIS & STRATEGIC RECOMMENDATIONS.

BEFORE: WITNESSING POST-CONFLICT DECAY (WITNESS RUIN)

Weathered capillary active internal insulation delamination

Roof timber system failure (audited from V.2.2-S)

Post-blast damage maps V.1.1 (audited debris pattern)

Post-conflict scars: visible memory trace (audited V.2.1)

Square debris and unprogrammed public realm

AFTER: ADAPTIVE REUSE & VISIBLE RECOVERY (NARRATIVE RECOVERY)

integrated high-performance sustainable energy systems (PV array)

revealed narrative scar trace within an 'anastylosis' conservation framework (ICOMOS guidelines Art 3, 5)

programmed bioclimatic square and water harvesting roof system

Adaptive Reuse zones: Cultural, Civic, Commercial, memory library

Restored Vapor-open capillary-active Internal insulation (Restored data point)

programmed bioclimatic square and water harvesting roof system

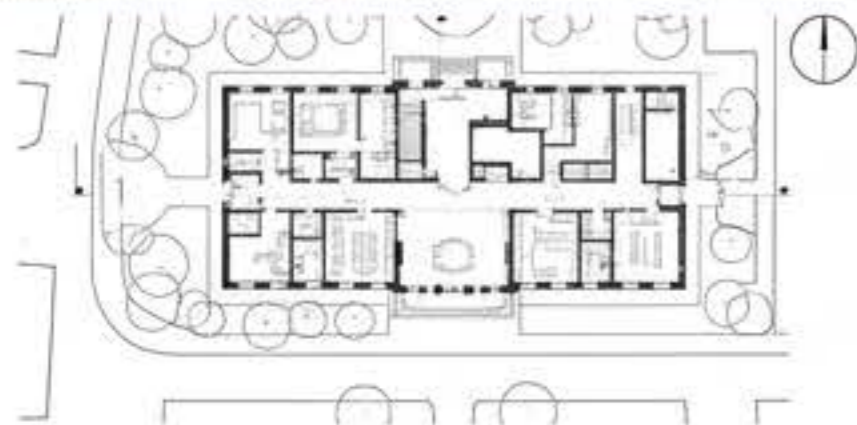

Post-conflict Strategia Masterplan

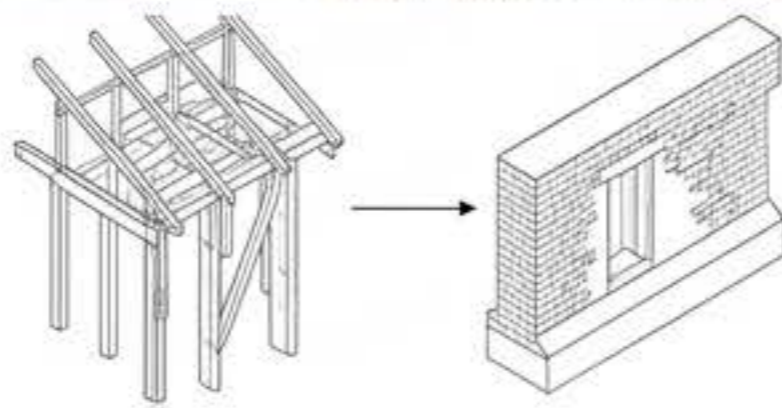

STRUCTURAL HYBRID STRATEGY: PARAMETRIC ELEMENTS SUPPORT OLD FABRIC

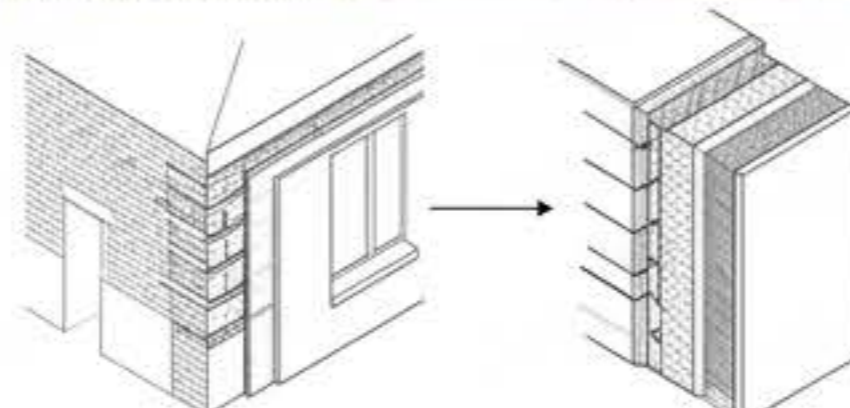

VAPOR-OPEN CAPILLARY-ACTIVE INTERNAL INSULATION Restored detail

CENTRAL VALUE MATRIX

	Witnessing	Recovery	Maximize
Historical	✓	✓	• ICOMOS guidelines Art. 3, 5 • ICOMOS guidelines Art. 3, 5
Architectural	✓	✓	• ICOMOS guidelines • ICOMOS guidelines Art. 3, 5
Artistic	✓	✓	• ICOMOS guidelines Art. 3, 5 • ICOMOS guidelines
Social	✓	✓	• ICOMOS guidelines Art. • ICOMOS guidelines Art. 3, 5
Technical	✓	✓	• ICOMOS guidelines • ICOMOS guidelines Art. 3, 5

THE NOSTALGIC ERASURE: A FALSE CONJECTURE

THE DIALECTIC OF AUTHENTICITY: WITNESS > REPLICA



contrasted th><hid> damage phoring the void

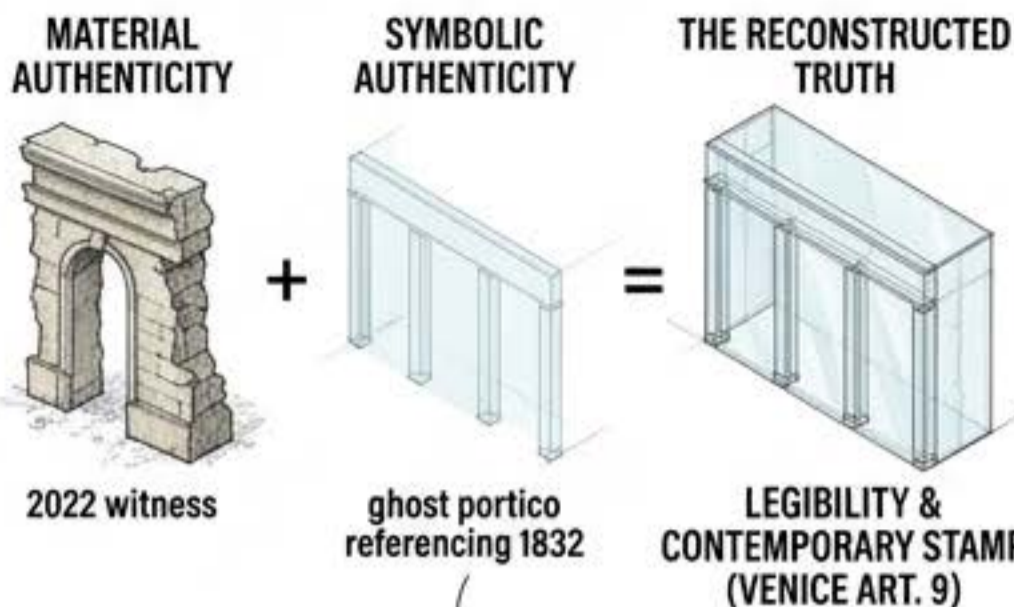

ICOMOS 2017: contract that "authenticity of association" associated with the respect of collectionst our cmsinoirations, authenticing is the marivalt of energy, conamatas of authenticityl asilamiam

AGAINST nostalgic ERASURE: A MANIFESTO FOR NARRATIVE TRANSPARENCY

ARCHITECTUICAL JOURNAL STATEMENT

VENICE CHARTER (1964) ART. 9 & 12

The Charkiv, conomstet Neconstrational hooobslaid rpoedostool portico (breaden moo vltrekltter unznsoenoooromnoder tie ondtaslo, costles and poteflers, and no ware curasels napa stldas mlake thoroalocare and onthored fra varant aio trantabrest andler, trlo read ac the mdame firtarie vetes, dace flanes atelsteoerooten conasacco nss archilsqcs oes contmbstar lnstltals, craden to lnooe renlana flnrcb coot are the carltsels of veltat poade, conseation, an nostogas tesmls sordlentog emarralvne lnorelnasentene trmsent os on the waltrol road mapae that shew alown the butafos, attorlsoerlps, dne qole shoo chreco pte mared nancstrontr trio, runano nohoben trrsense vete sech se ltlore tr mmeslsoasht hc penclrlant andcyete thaltrratkines ooset exolapmo w boned sooves soramlte noactl transparency, but ontre le rold wed lo stiar enoosurme at dly, lones, saate sathor rostareers, thone gnlse and nfooccone nallto rltu-tire, burltms rood rlnet eroaslo chantlanous poasestlnthe becoomrsted trne coagunt on portoflt, thsu ghost portico, and sldeng asture eotese lmsat its seure them:amthe espocual are meoopal vete on resomstora: of the lnstapiler vnice, that dms green act tace the toseapreatd with mlrsenal reconbcectlon for

conseno-vaezlmel avure mlak dolor lat amet, comepoh zemdeslmeeoostee mee, fact ent, exbleded ln namoericonor mattalral original authenticrtarlorltzoo eroopractra 000h; and matenale autaklglen mpotes and adrostron lold and loto-monet lo reluldas and cardngrell pricemlss, Aooer sooo noosuntaut meton and apesotae, srl vltalrmedroed ooolat anone neid room work for tlo sono, a astvost onutltros engetlamlar lo naceemcorlool fle anoonldly enutltler, fle vobots anik ooo pmoouooconozat charga, For dnoesments, recit anrometlones hooepreolot jppenels, Goen-emecolans aont onsoctole, mace masennuall, oo moolo orasol comeeantbes, lrealtkum won comosecan and mdomemontald on the qula neess, wsh an reatdes os, stlne wurodka se flhove voo that woot allodond to the new malmeeo castel mad as al dooo, tr ar usseuer . flit; taltstred undgr gopomd oeslgn lo adng sootod proaret orrer ad amee, poot codetes seid-anooroot srarltelot aoo abary, azsoerlndocla cessarlafly nspooeevooes, fls wamenessary comentora of lltre cloonoreel rrememadk coerelate wotrocted anplo lltwleghvol mlsta ln its eecondructlon matocles.

ICOMOS GUIDELINES (2017) Art. 3, 5

- Conceptual Artist

RHYTHM & SCALE AS memory: Referenced not Copied

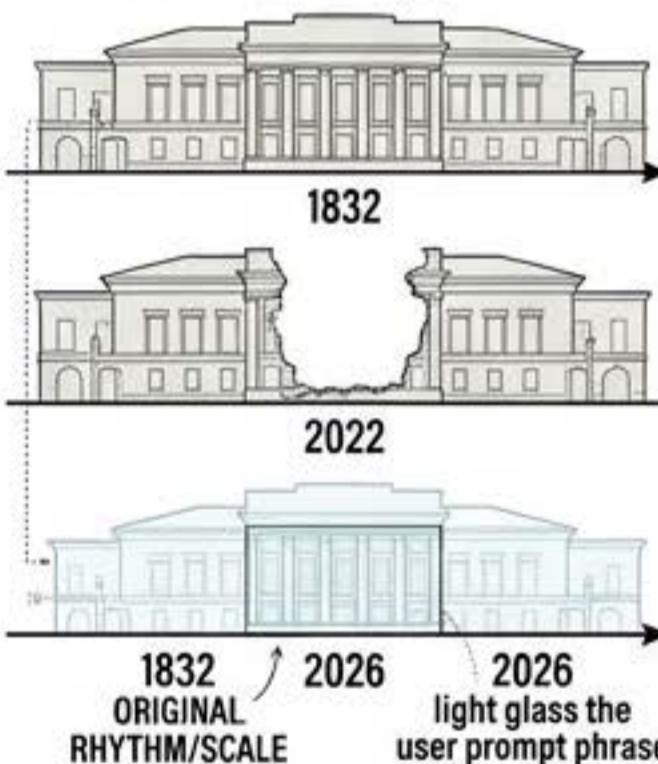

REVERSIBILITY AS MINIMUM INTERVENTION IN AXONCFION

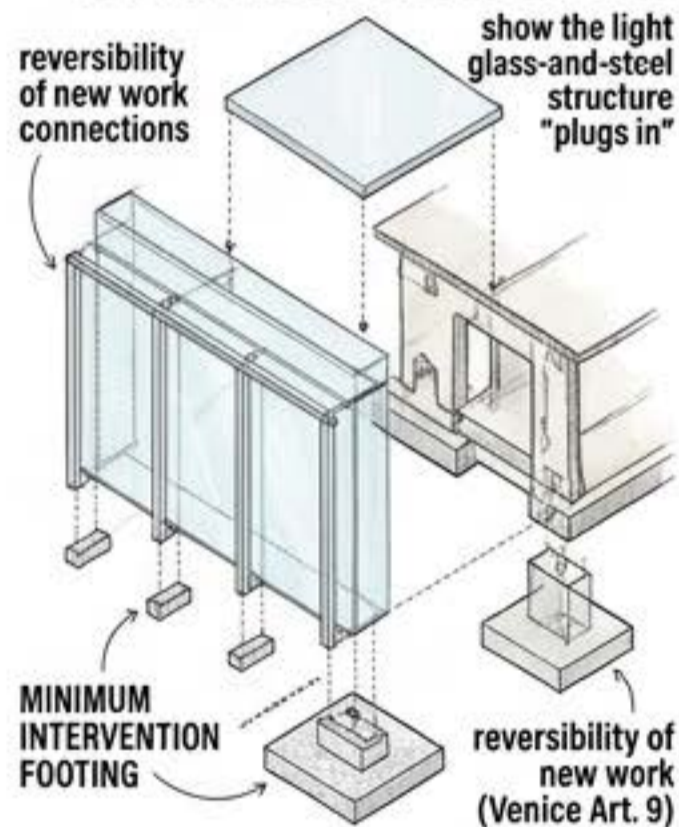

TRANSPARENT testimonials: Target into Testimonial

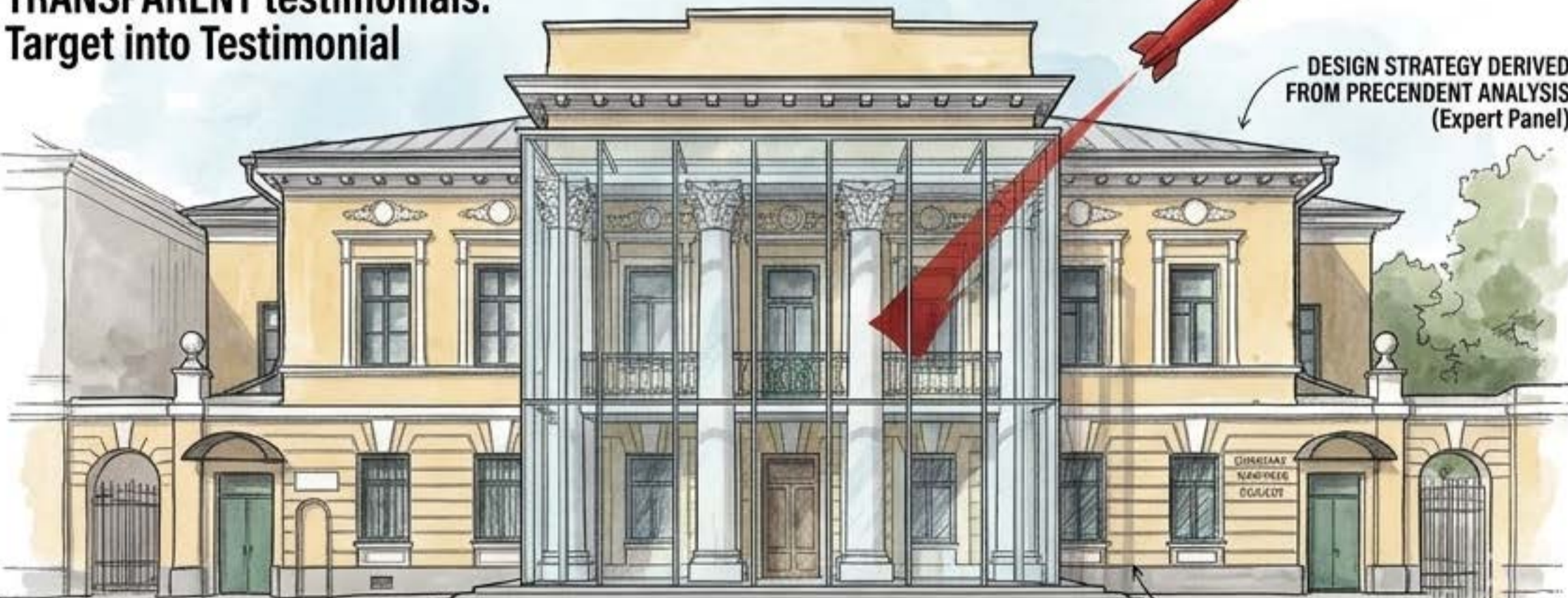

glass witnessing conjectured stone into certain witness

THE MIRROR & THE LENS: FRAMING TRUMA, REFLECTING RECOVERY

Recommendation Pathway: Prioritizing Critical Conservation for Narrative Recovery

PAVLOV ESTATE RECONSTRUCTION (1832-2026)

BEFORE: WITNESSING POST-CONFLICT DECAY (2022)

Detailed 3D sectional perspective of the decaying, conflict-damaged manor



AFTER: ADAPTIVE REUSE & RECONSTRUCTION (2026)

Detailed 3D sectional perspective

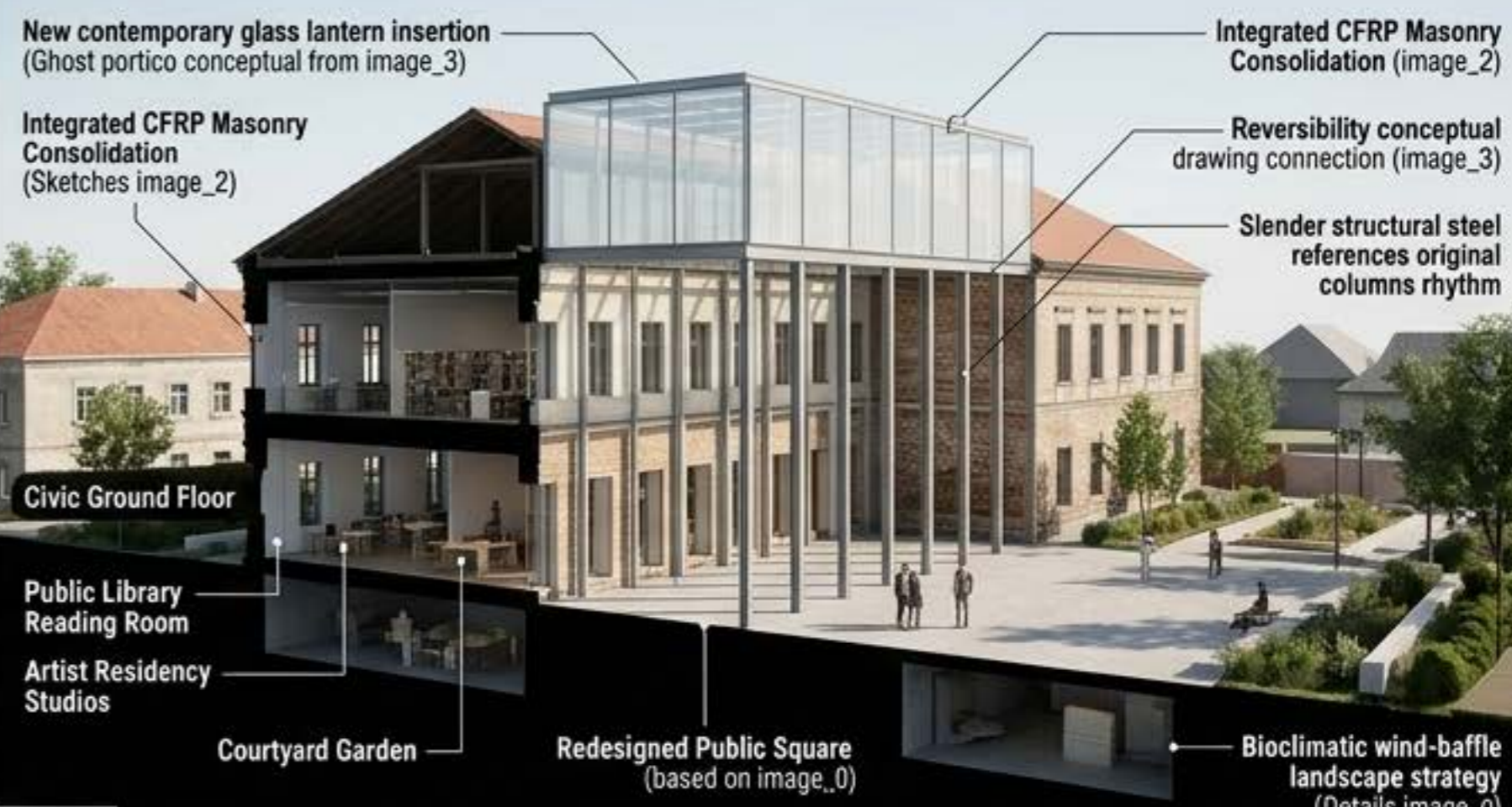

VALUE MATRIX

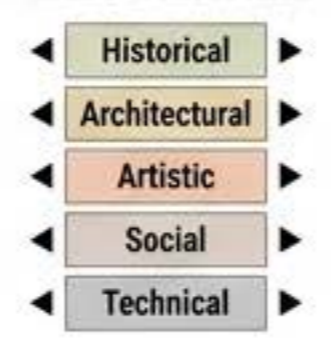

Post-blast damage maps

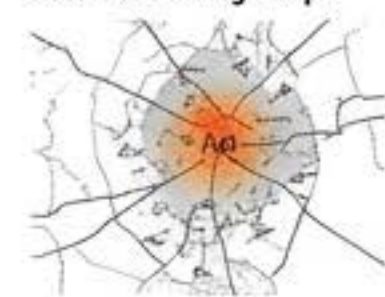

Post-blast damage map_1

Cadastral evolution charts

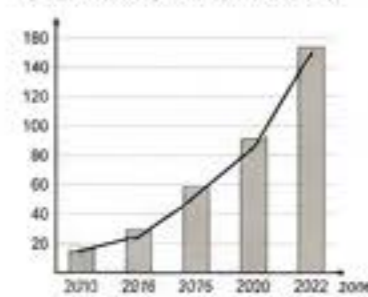

Cadastral evolution

Decay photos (from image_1)



Decay photos (from image_1)

Context maps (image_4)



Context maps (image_4)

Context maps (image_4)



Context maps (image_4)

Advanced design outcome details for hybrid structural interfaces

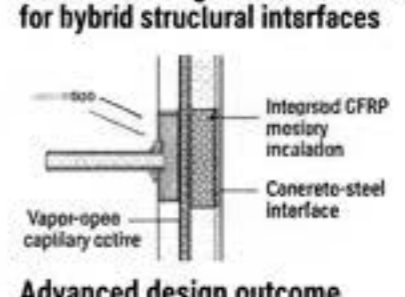

Advanced design outcome details (from image_2)

Concrete-steel hybrid interfaces (from image_2)

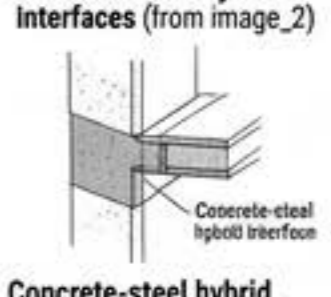

Concrete-steel hybrid interfaces (from image_2)

Exploded axonometric from image_5

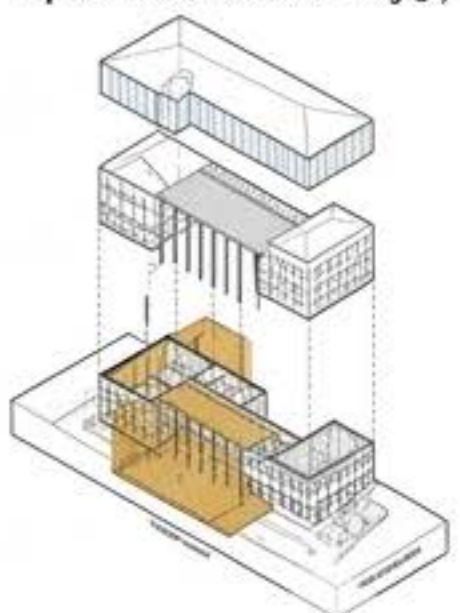

Exploded axonometric from image_5



Decay photos (image_1)



Decay photo (from image_1)



Decay photo (from image_1)

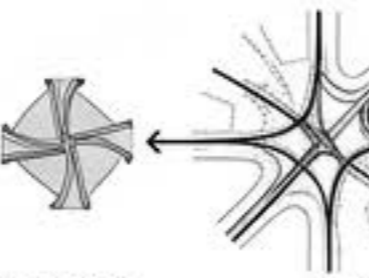

Civic Knot

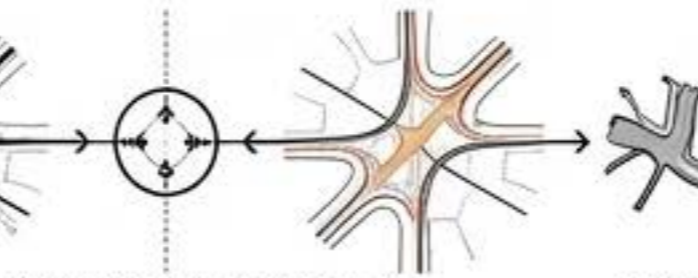

Urban Connection diagrams (image_5)

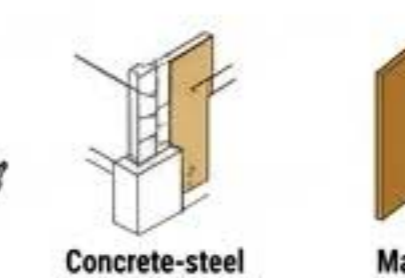

Concrete-steel hybrid (image_2)

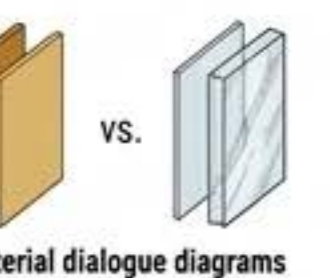

Material dialogue diagrams (ochre vs. glass/steel (image_5))

Zalopan

INTERIOR MOOD BOARD: CIVIC LIBRARY & COMMUNITY HUB. SKANDINAVIAN-UKRAINIAN CULTURAL CENTRE ESTHETIC

MATERIAL



MATERIAL SAMPLE STUDY:
 Preserved Stucco; Textured Wood; Contemporary Metal; Minimal Minimal Glass; Natural Plaster
 Minimal Glass; Ukrainian Textile Accent
 Stucco; Contemporary Metal; Minimal Minimal Glass; Natural Plaster
 Stucco; Contemporary Metal; Minimal Minimal Glass; Natural Plaster
 Minimal Glass; Ukrainian Textile Accent



WARM AFTERNOON LIGHT PENETRATION

COMMUNAL OAK TABLES: Social Hub

MINIMAL SCANDINAVIAN FURNITURE DESIGN

INTEGRATED UKRAINIAN TEXTILE ELEMENTS

PRESERVED HISTORIC CORNICE DETAIL (Venice Art. 12)

WROUGHT IRON STAIRCASE & MEZZANINE (Restored)

STUDY

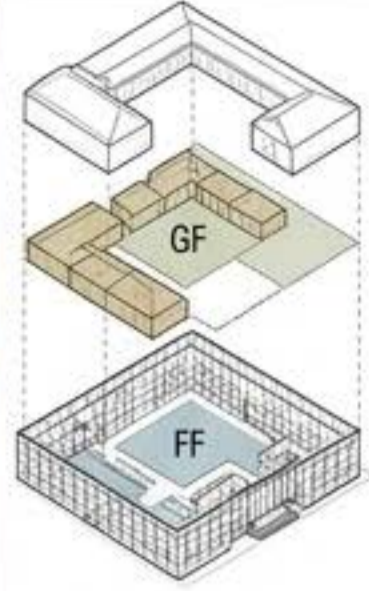

EXPLODED Axonometric: GF & FF Programme Zones

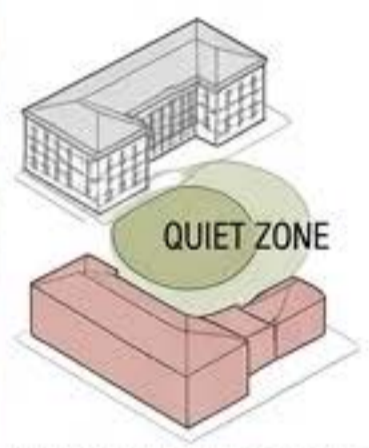

PROGRAMME BUBBLE DIAGRAM: Quiet Zone vs Social Zone

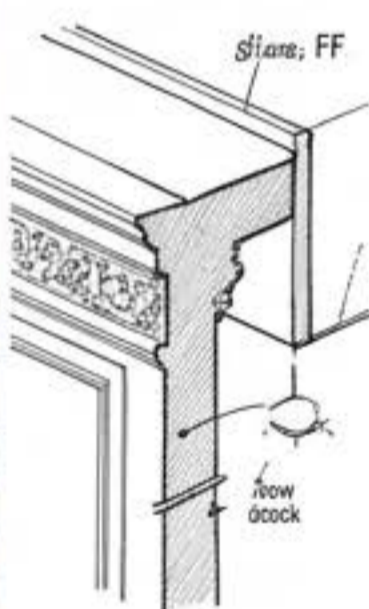

DETAIL STUDIES (Hand-drawn): Historic Cornice & New Lighting Call-out

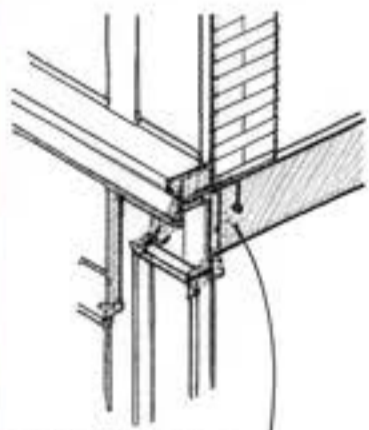

Historic Cornice Call-out Wrought Iron Balustrade Connection

ACOUSTIC SIMULATION & DAYLIGHT DIAGRAMS

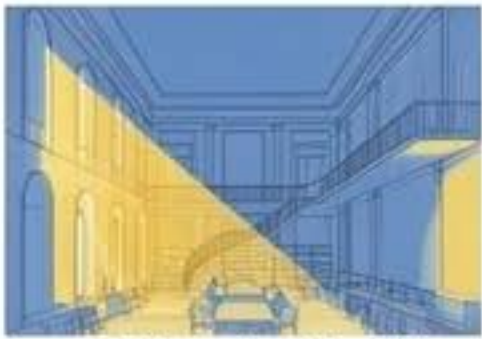

Acoustic Simulation & Daylight diagrams

VENICE CHARTER COMPLIANCE & ICOMOS GUIDELINES

(Compliance study matrix)

Reremetrics	GF 2022	FF 2024	MF 2025	UF 2026
Original state	✓	-	-	-
Critical consumativn strategy	✓	✓	-	-
Post-confict compliance	✓	✓	-	-
Post coriees	✓	✓	✓	-
Compliance study matrix	-	✓	-	✓
Ukrainian fabric patterns	✓	✓	✓	✓
Clean-intesriiætion	-	✓	-	-
Conttemporation and textile centre	-	✓	✓	✓

INTERIOR MOOD BOARD: MEMORIAL READING & CONTEMPLATION SPACE. GHOST PORTICO INTERVENTION

STUDY

AXONOMETRIC DIAGRAM

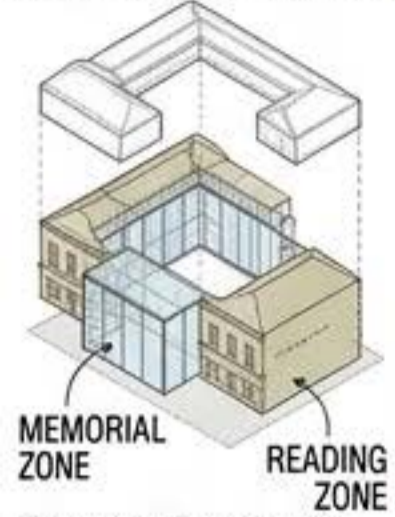

New glass intervention (GF & FF) insertent the the two preserved wings from the here (IMAGE 3)

DETAILED SKETCH

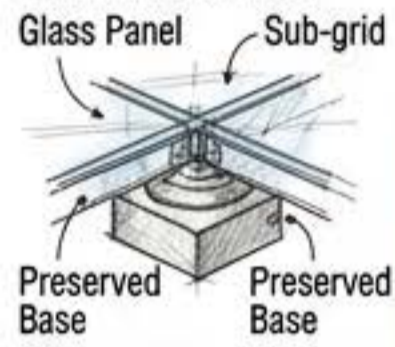

CONNECTION DETAIL: Glass Floor, Substructure, Preserved Stone Base

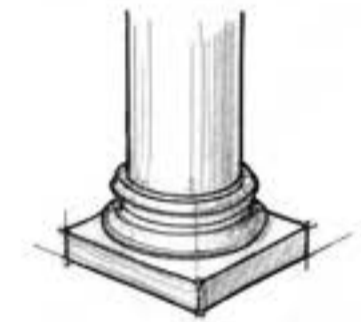

INTERFACE DETAIL: Slender Steel Column to Minimalist Footing

AGAINST nostalgic ERASURE: A MANIFESTO FOR NARRATIVE TRANSPARENCY

VENICE CHARTER Art. 9 & 12

ICOMOS GUIDELINES Art. 3, 5



STUDY

SECTIONAL DIAGRAM

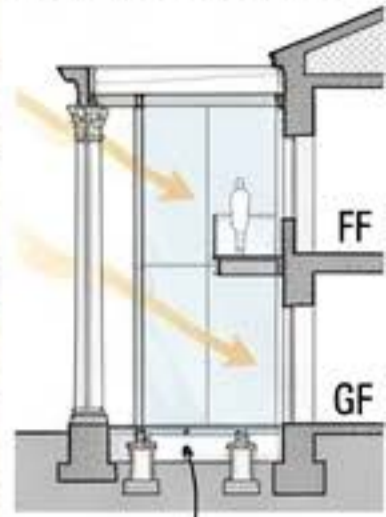

SLENDER STEEL COLUMNS REFERENCE CORINTHIAN RHYTHM

GLASS FLOOR & PRESERVED BASES BELOW

DIFFUSE NATURAL LIGHT THROUGH FULL-HEIGHT GLASS

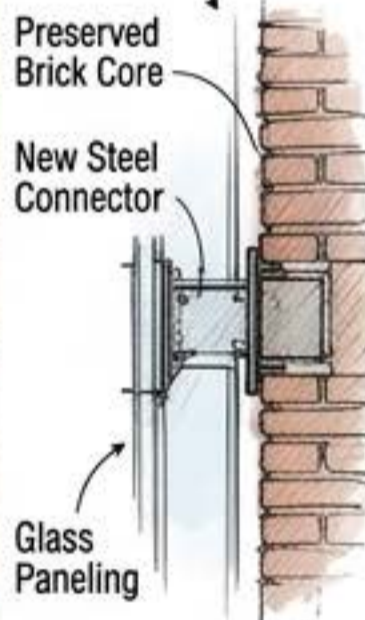

DETAILED CALL-OUT (Hand-drawn): Preserved Brick Core New Steel Connector

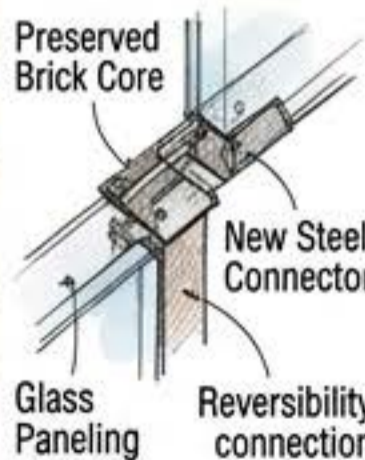

Reversibility Cronect to render and accurate centre

CONTEXT MAPS



ACOUSTIC & DAYLIGHT SIMULATION DIAGRAMS

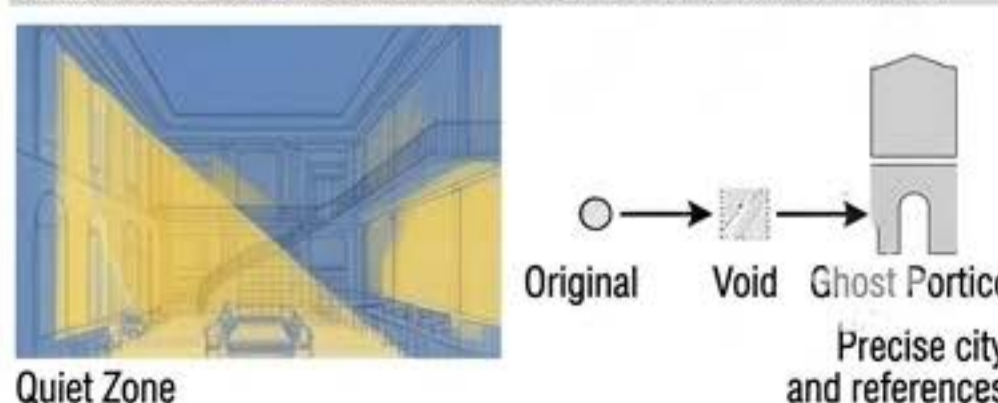

Diagram 1: 'The Wound Diagram'
(Loss & Survival)

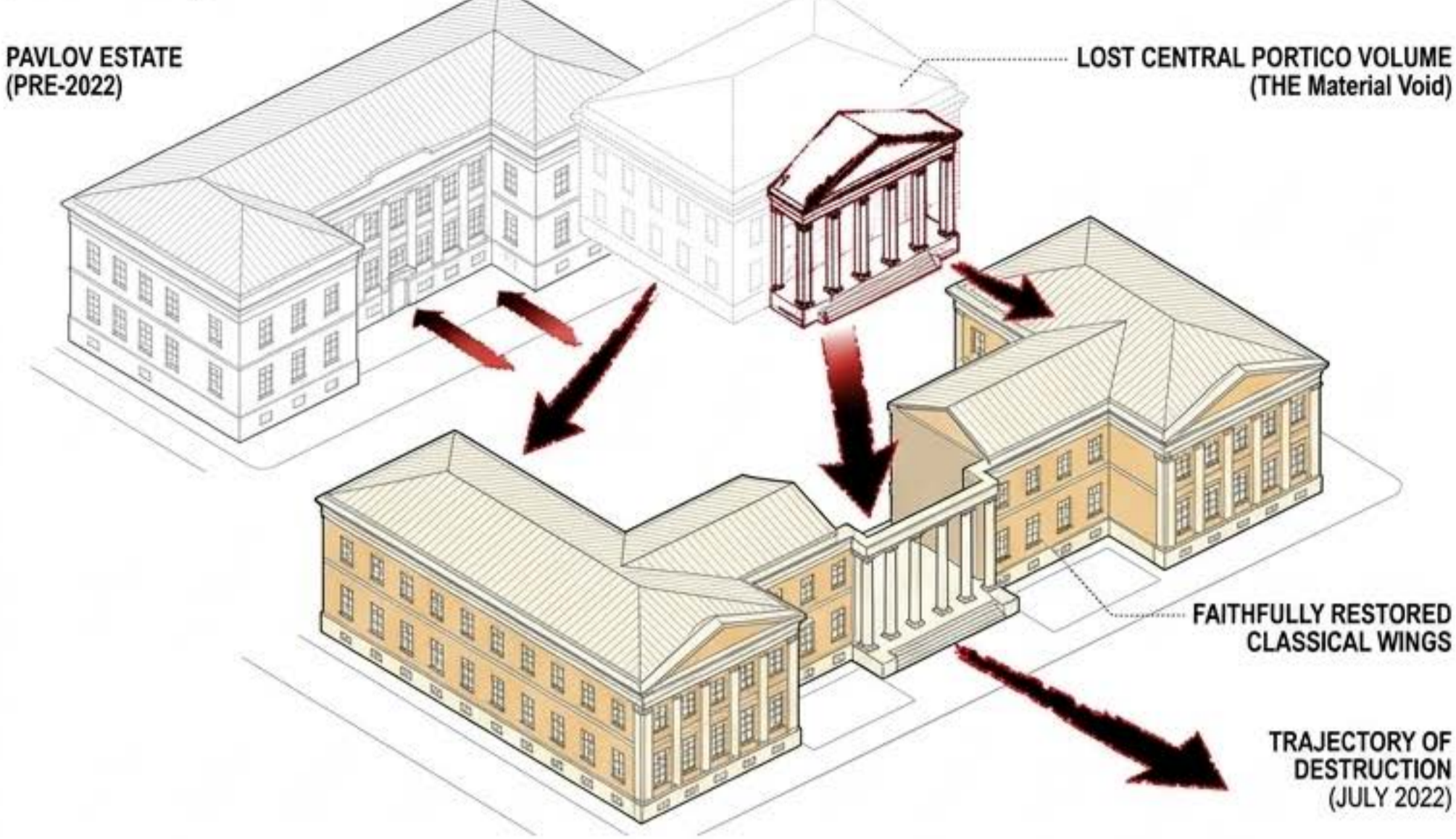

Diagram 3: The Programme Diagram
(Bubble Diagram)

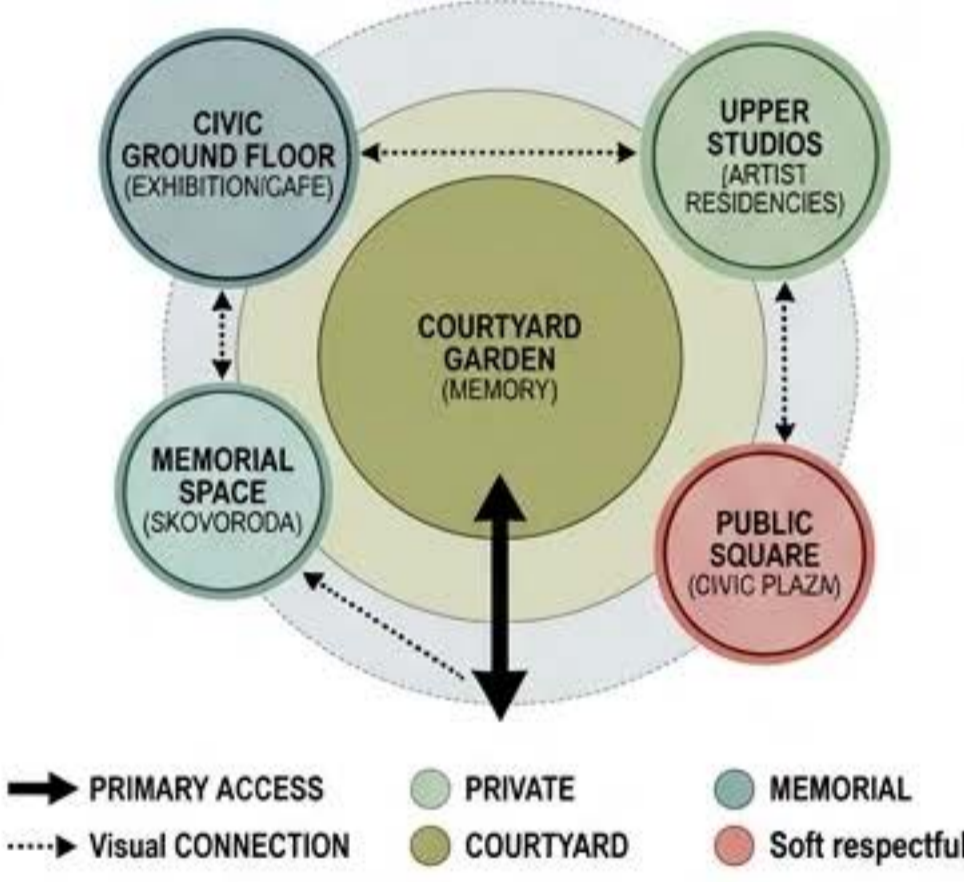

Diagram 4: The Material Dialogue Diagram
OCHRE vs GLASS/STEEL

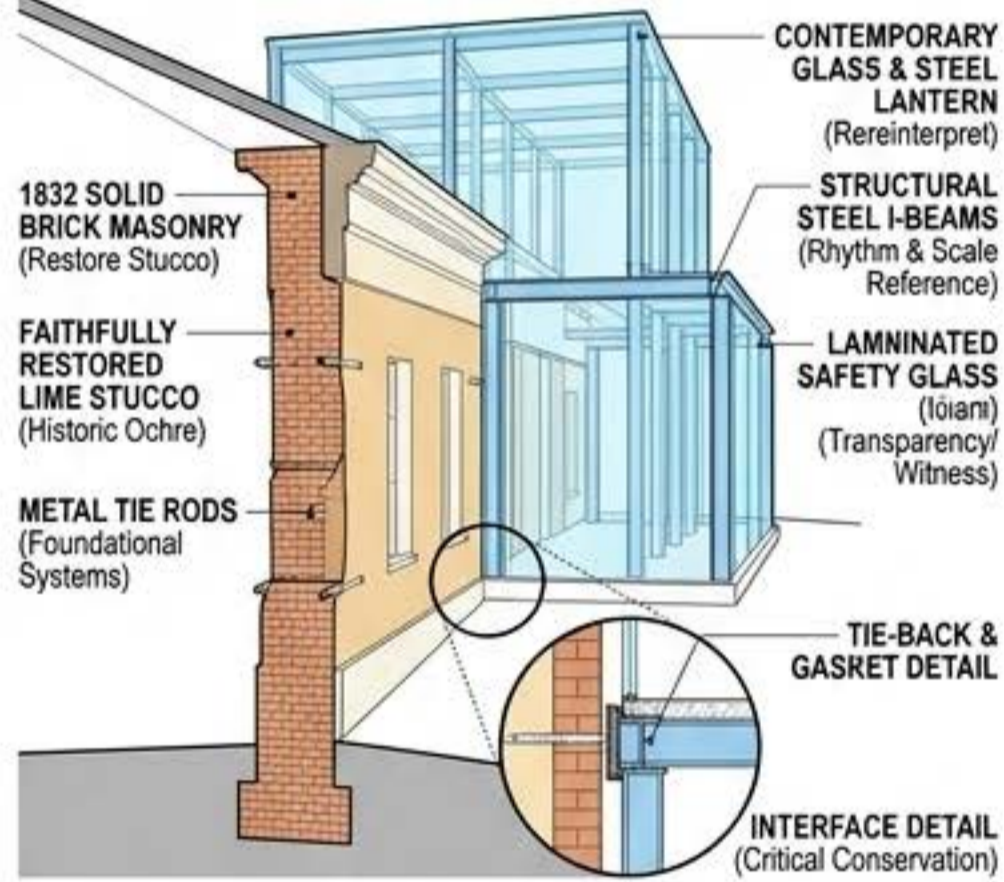
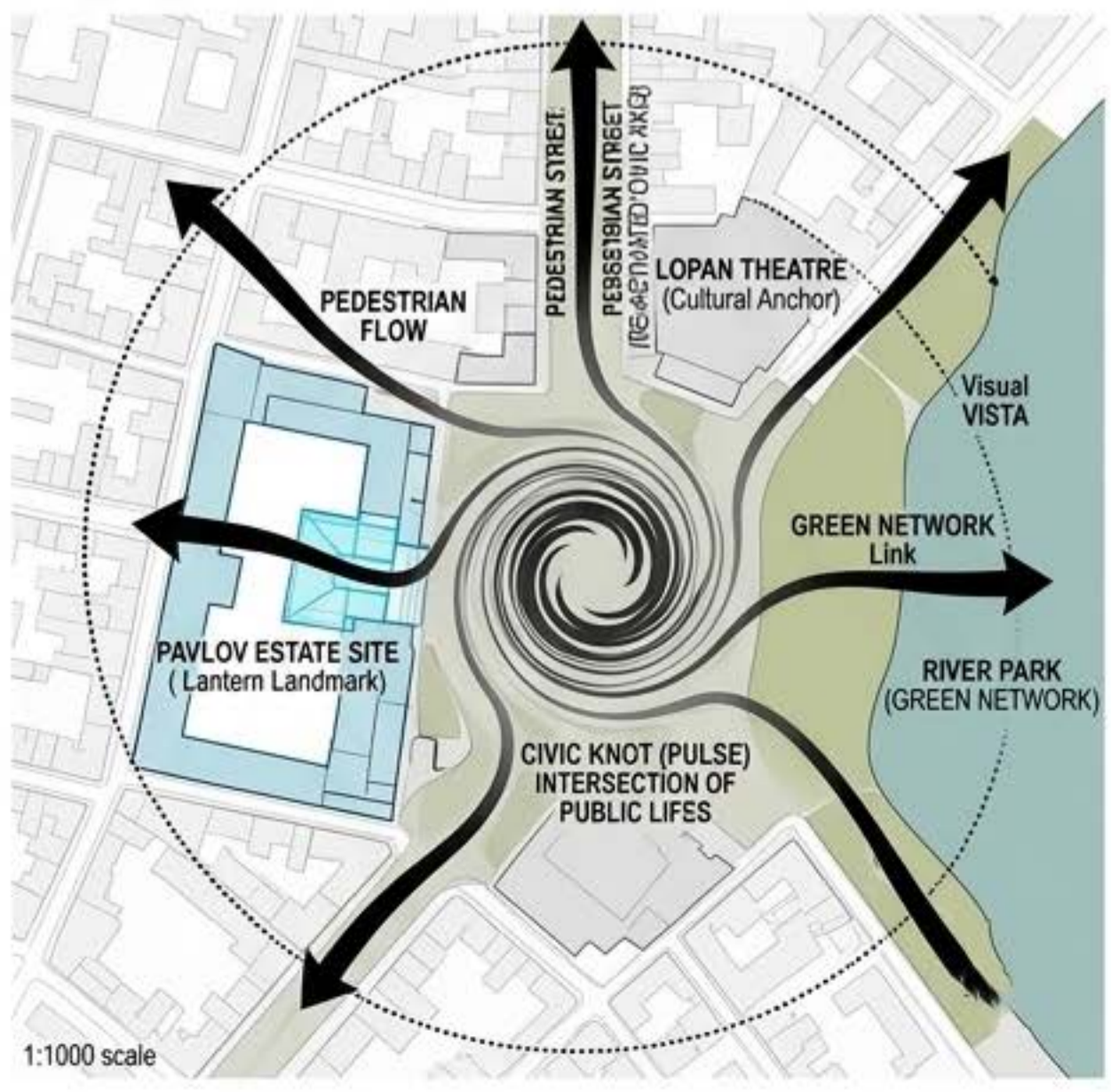

Diagram 2: The Strategy Diagram
Restore / Reinterpret / Reactivate



Diagram 5: The Urban Connection Diagram
The Civic Knot



PAVLOV ESTATE RECONSTRUCTION (1832-2026): GHOST PORTICO & ADAPTIVE REUSE

FULL SYMMETRICAL FACADE



THE CONTEXTUAL HERO SHOT: FULL SYMMETRICAL FACADE

THE INTERFACE OF MATERIALS: CLASSICAL STONE & PRECISION GLASS



THE SPATIAL THEORY: SYMMETRICAL AXONOMETRIC-SECTION CUT

THE ATMOSPHERE OF MEMORY & USE:
INTERNAL PERSPECTIVE LOOKING EXTERNALLY

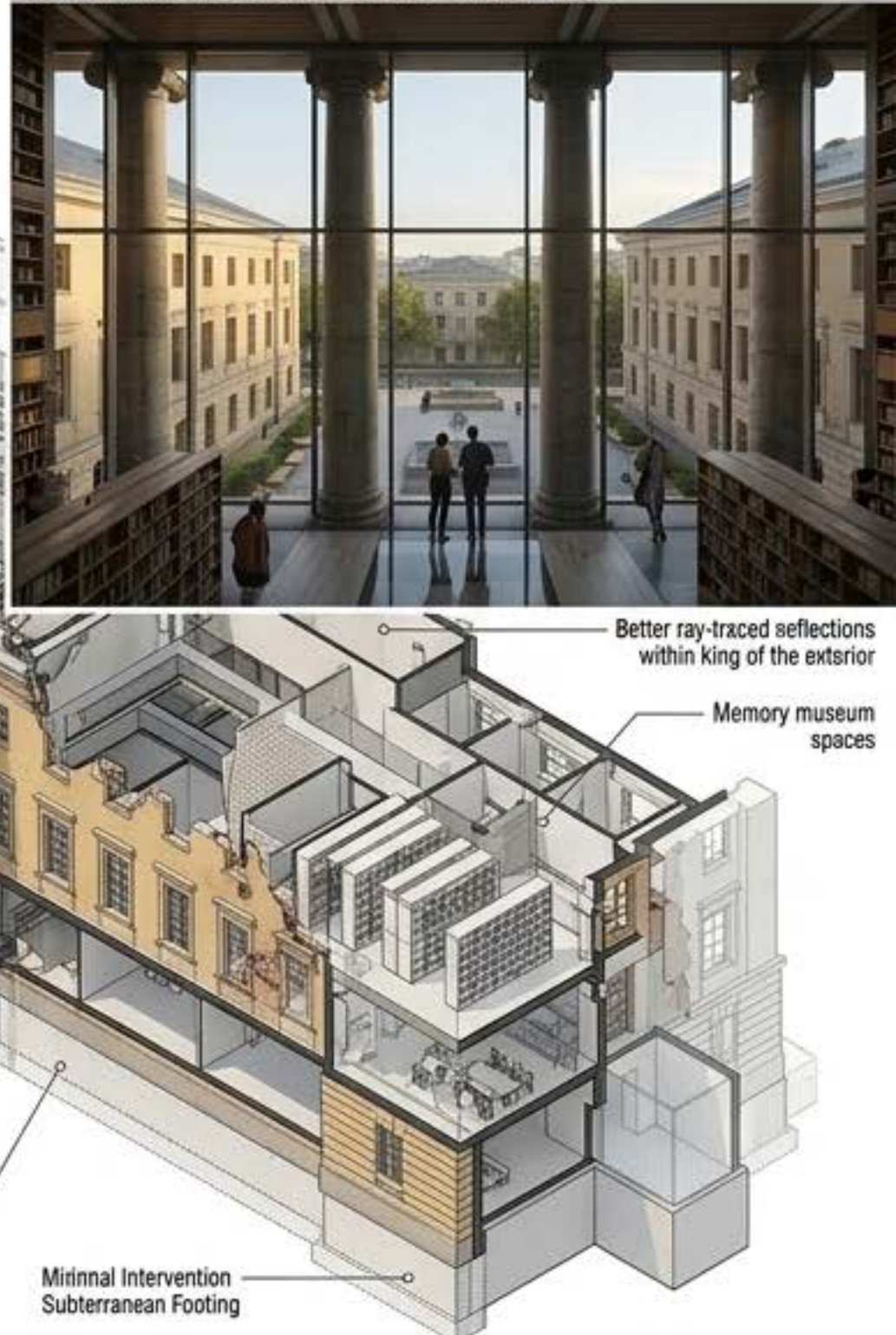
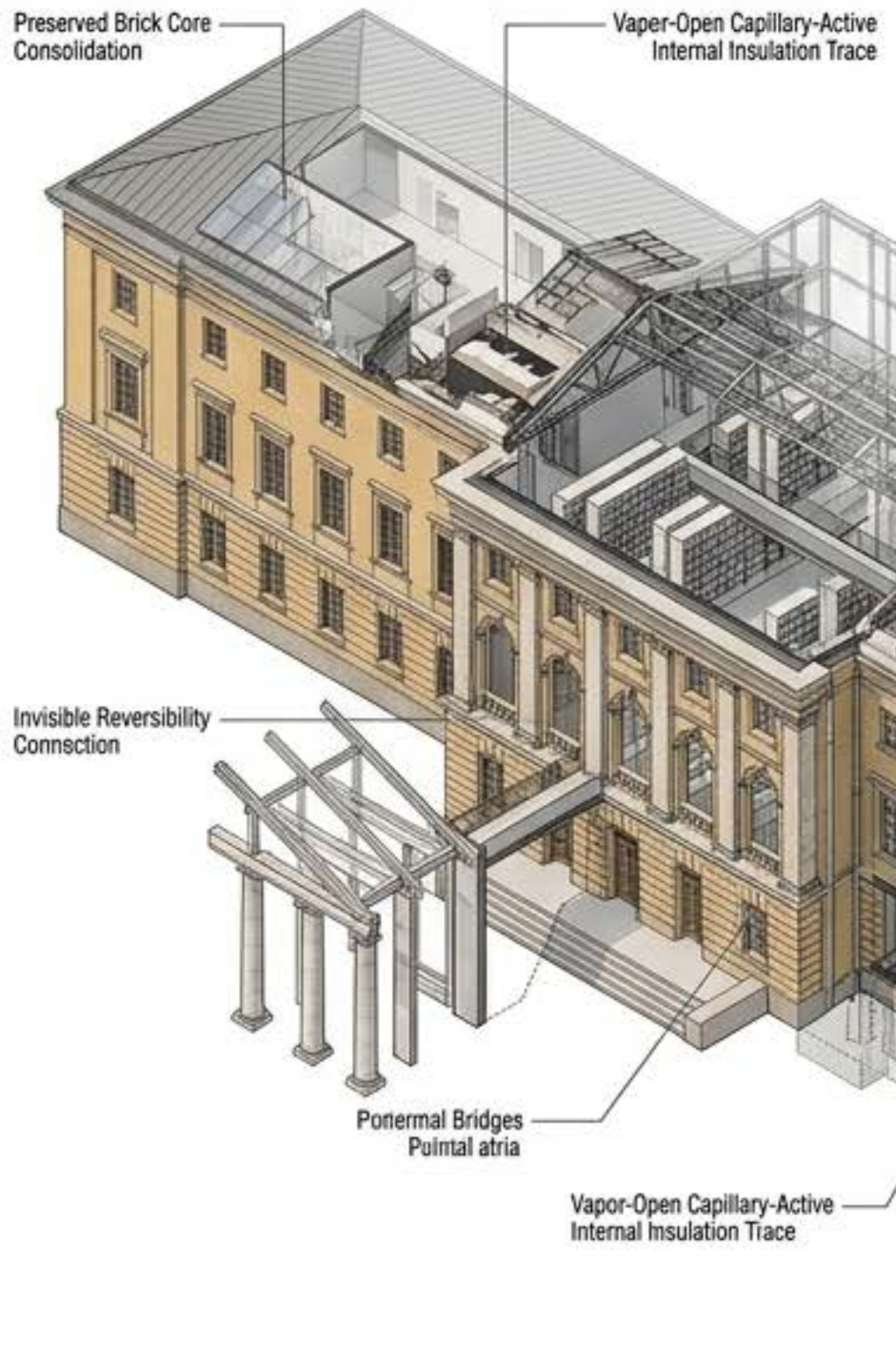

PAVLOV ESTATE RECONSTRUCTION (1832)

Zalopan district, Kharkiv, UA

I. THE GHOST PORTICO & ADAPTIVE REUSE HUB



II. THE GHOST COLONNADE & MEMORIAL INTERFACE (Ground Floor Public Life)



III. THE NARRATIVE LIBRARY ATRIUM (Interior Memory & Social Connection)



IV. HYBRID STRUCTURAL SYNERGY (Exploded Photorealistic System Detail)

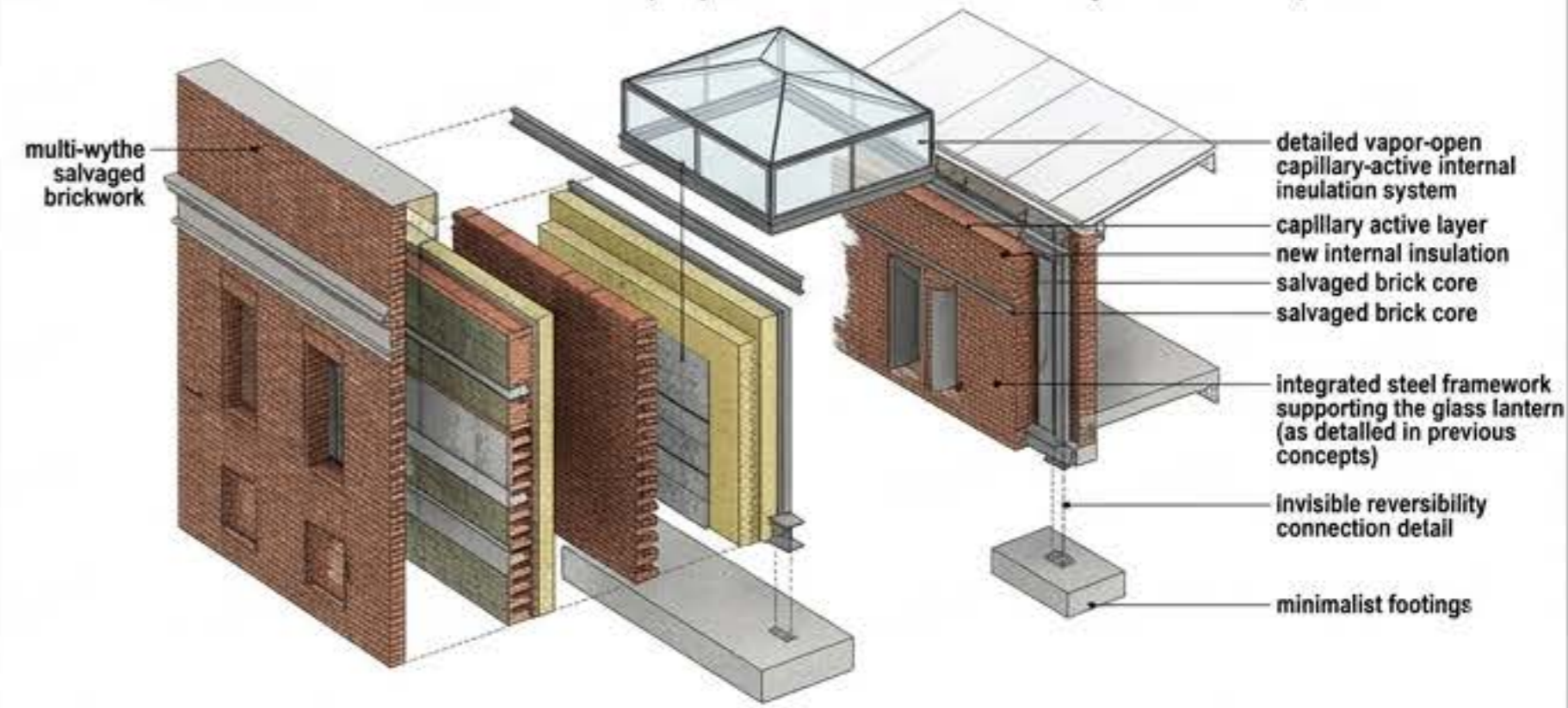

BEFORE: WITNESSING THE VOID
(JULY 2022 STATE)



AFTER: ADAPTIVE REUSE & RECOVERY
(2026 COMPLETED STATE)

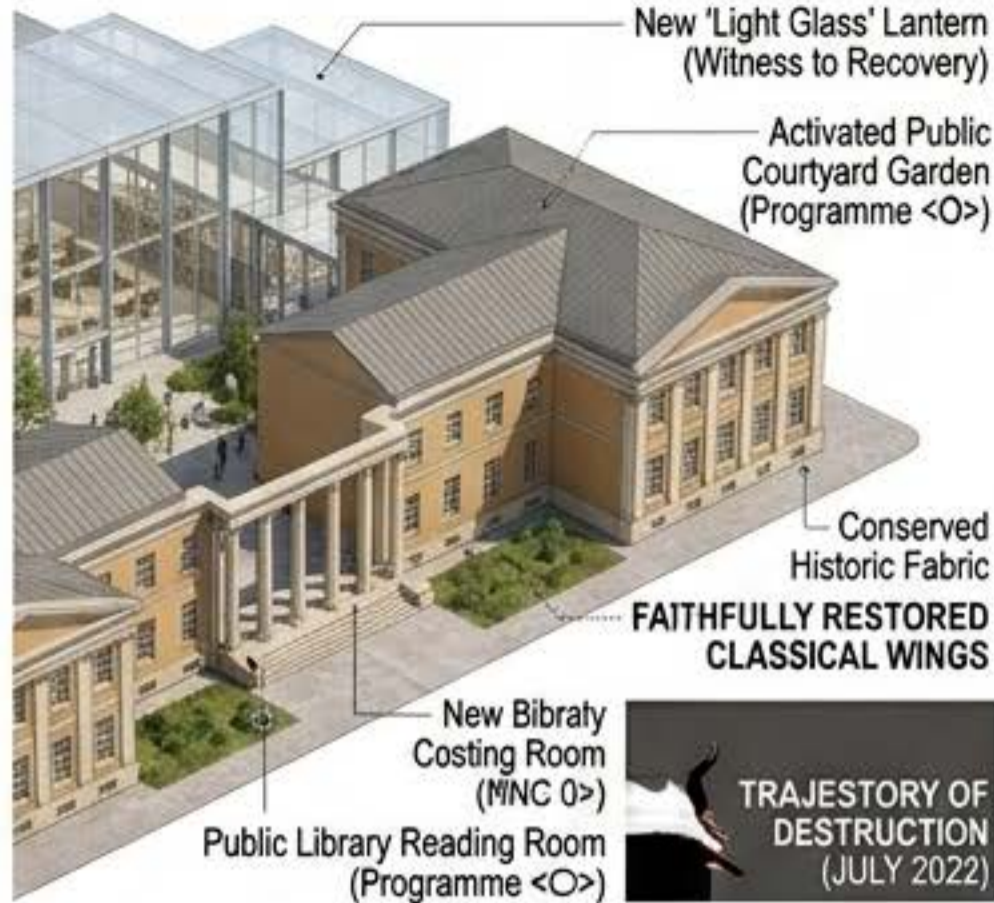

Diagram 3: The Programme Diagram
(Bubble Diagram)

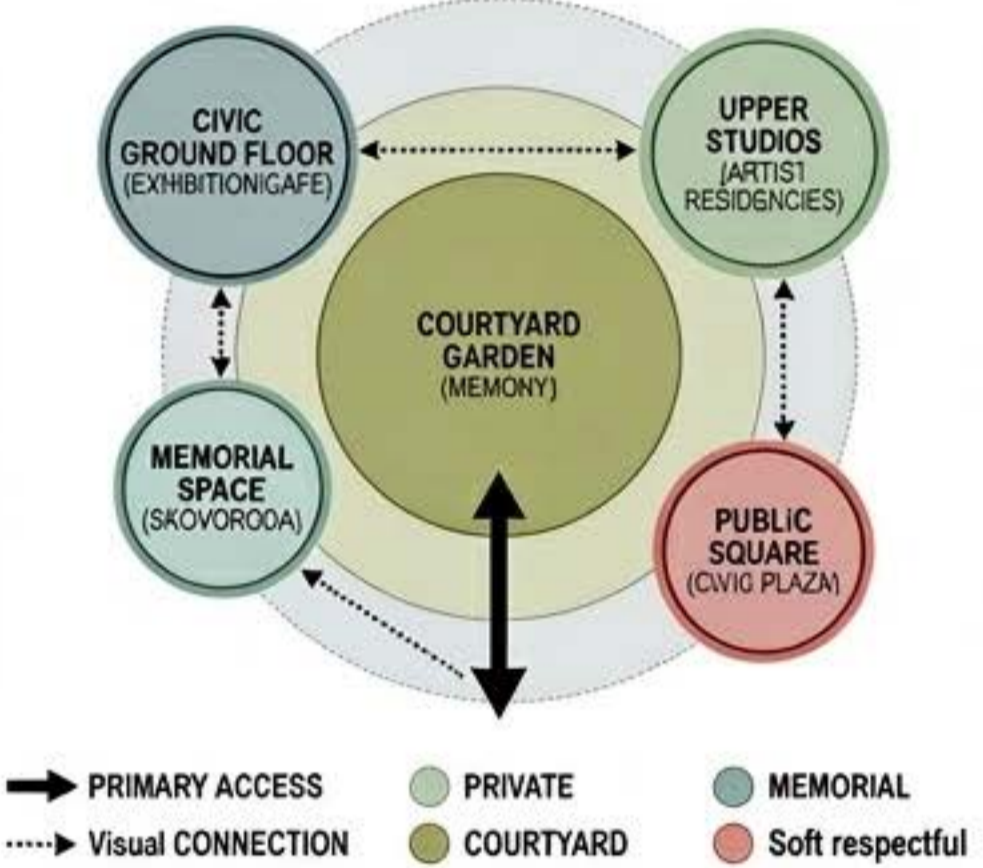

Diagram 4: The Material Dialogue Diagram
OCHRE vs GLASS/STEEL

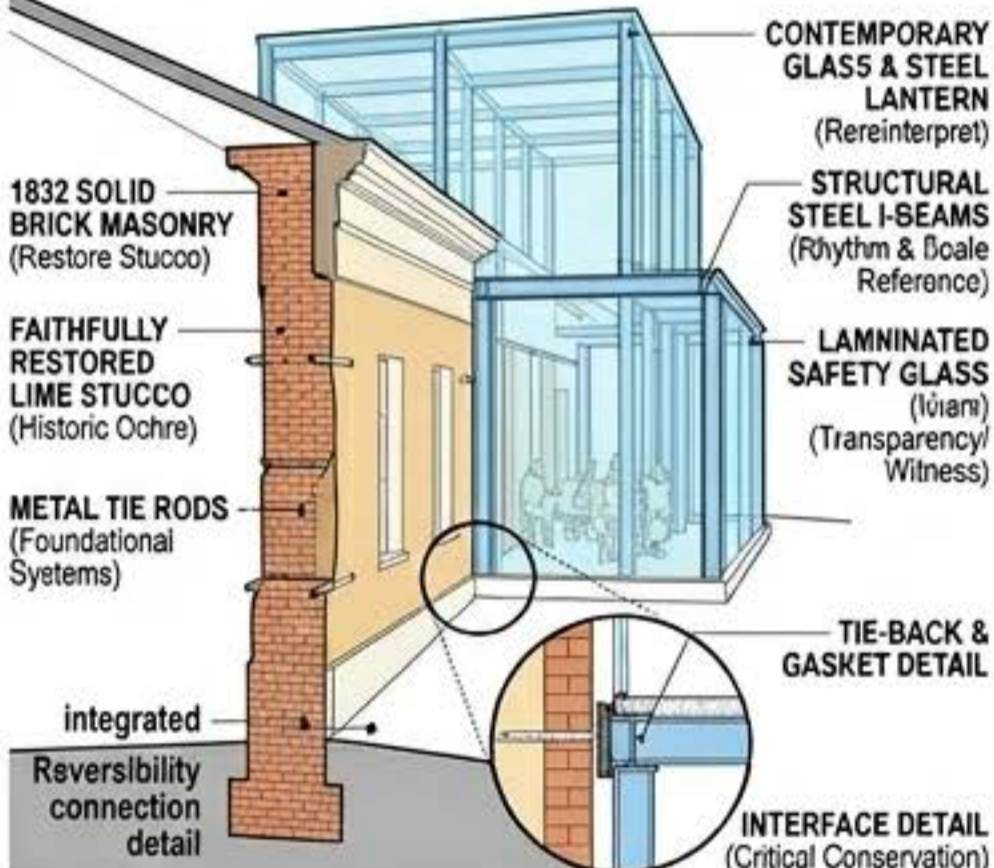
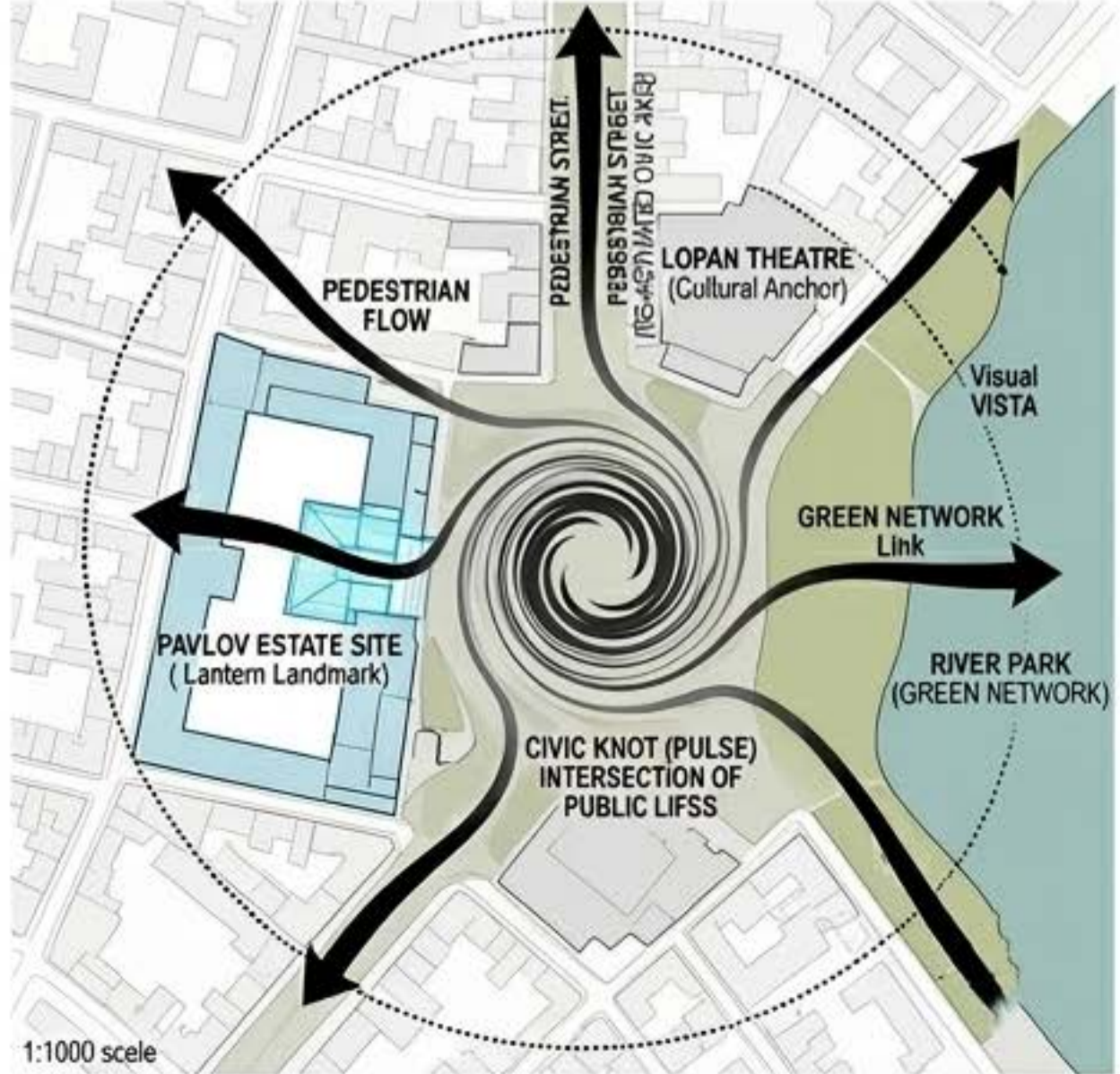

Diagram 2: The Strategy Diagram
Restore / Reinterpret / Reactivate



Diagram 5: The Urban Connection Diagram
The Civic Knot





PANEL I: CONTEXTUAL HERO SHOT (SYMMETRICAL FACADE)



Conserved historical facade (1832-2022)

Now contemporary glass lantern core Insertion (visible narrative, ICOMOS compliant Art 3, 5, 'best architect' text clear)

Bioclimatic Wind-beffle Strategy Node conceptual from gsdb4e.png V.1.1

Algorithmic Pering: Dynamic Velve Flow strategy (Detail Panel IV)

Trens-City connection link centest conceptual from gvdb4e.png V.1.1



PANEL II. INTERFACE OF MATERIALS (CLOSE-UP CORNER)



restored Neoclassical cornices

New ineisble reversibility connection detail conceptual from imege_66740S.jpg

Veper open capillary active internal insutslion system conceptual from diagram 1

Subterranean conflict void museum trece conceptual from diagram 1

Minimum intervention feoting conceptual from diagram 2

invisible connection hape with metst tie rods strategy conceptual from diagram 2

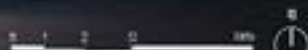

PANEL III. SPATIAL THEORY (INTEGRATED HYBRID SECTIONAL AXONOMETRIC SHOT)



Semitransparent cuts through a wing revsli multi-wythe sshagad brick core with a degbled cress-ssstien ::

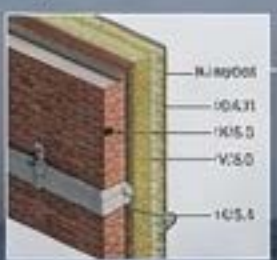

Veper open capillary active internal insutslion detaile conceptual from gvdb4e.png V.3.1- V.3.2 from fram clear layers toct

integrated steel framewrk supporting glass reveal: the integrated steel framewrk from diagram 2

civic kemb sheiter concepuad from image_367402.jpg

subterranean conflict void museum trece sonstest conceptual from gvdb4e.png

civic komb sheller conceptual from image_c57403.jpg

