

# CONCEPT

**1** Shape that's open for the community



**2** The shape was extruded



**3** The shape was raised at the highway to create a focal point and was lowered at the community section to create an inviting shape



**4** the final form was split in half due to the function needs

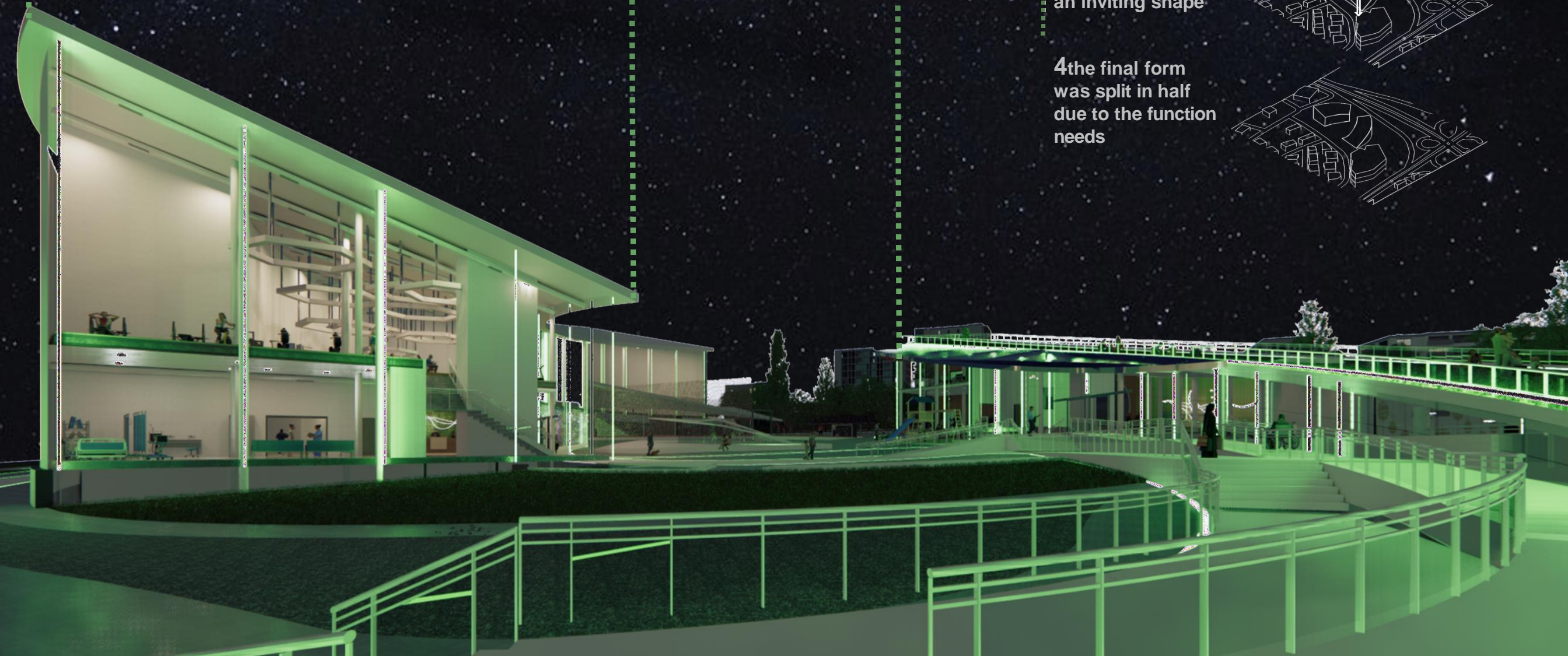
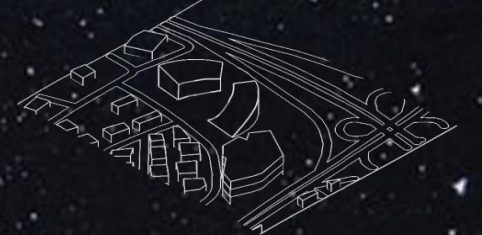
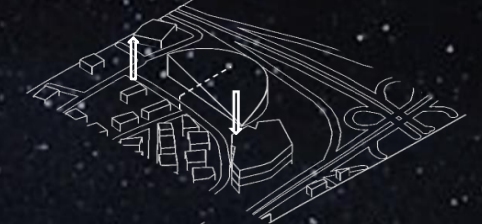

# GROUND FLOOR PLAN

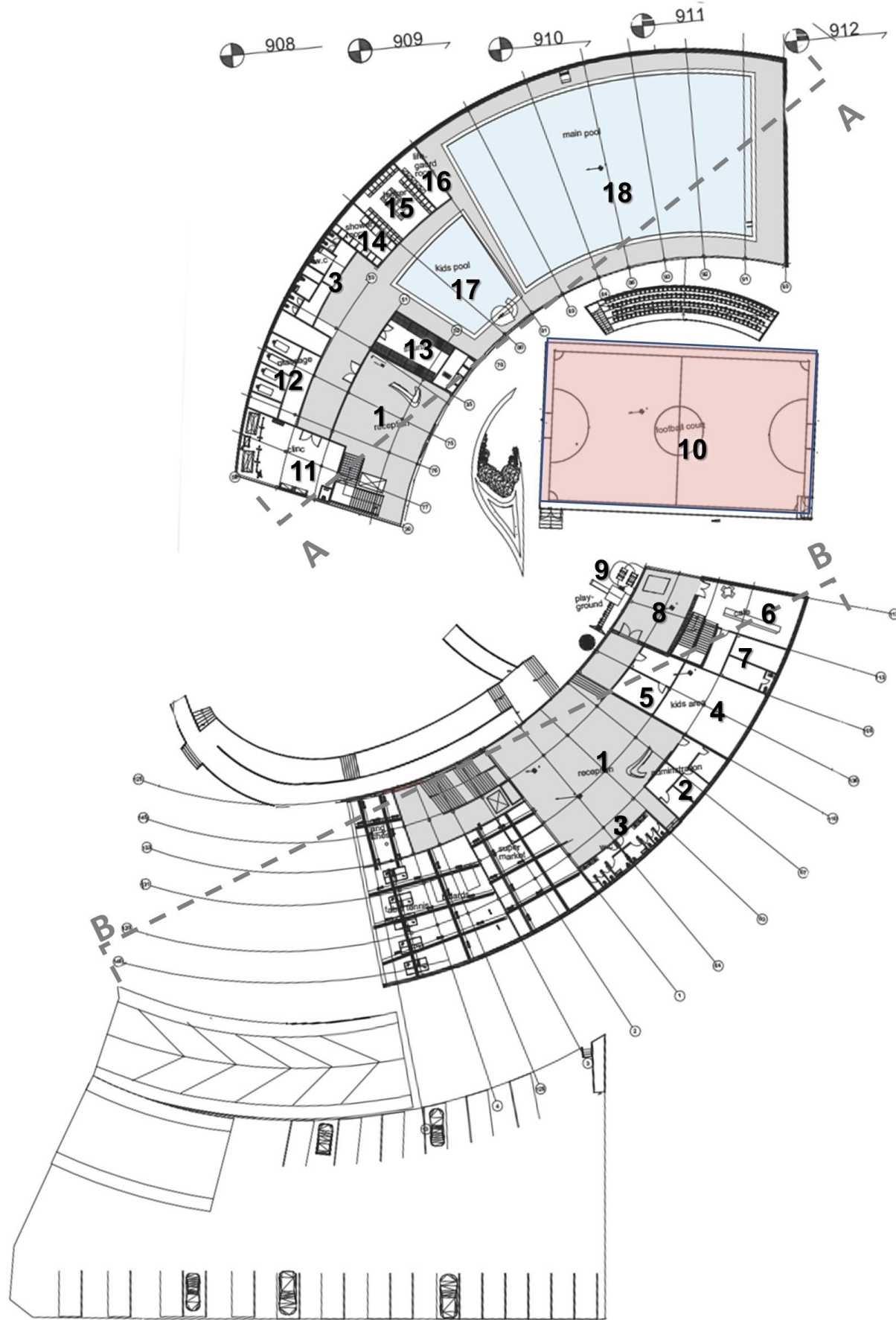

# 1ST FLOOR PLAN

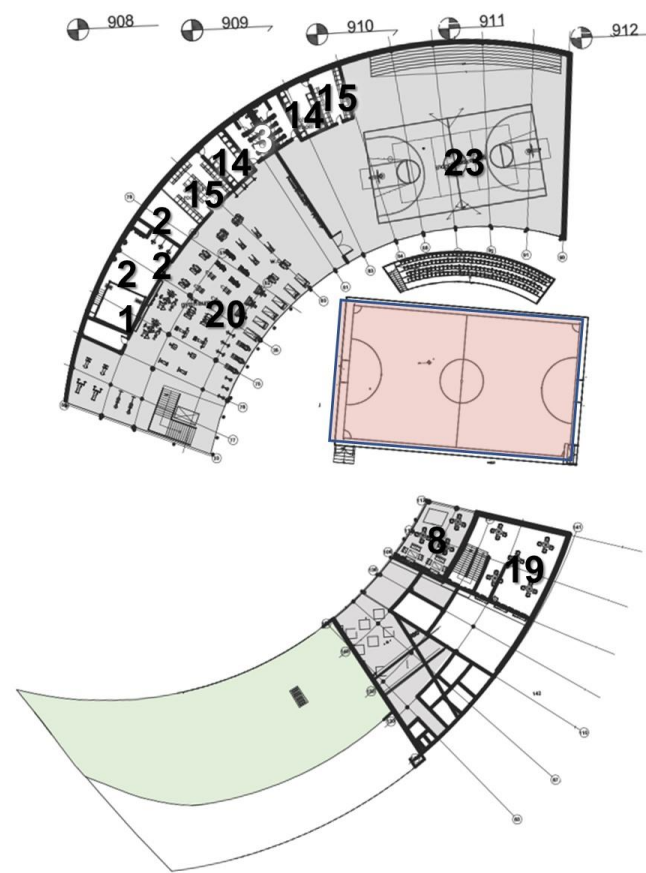

# SUB-BASEMENT PLAN

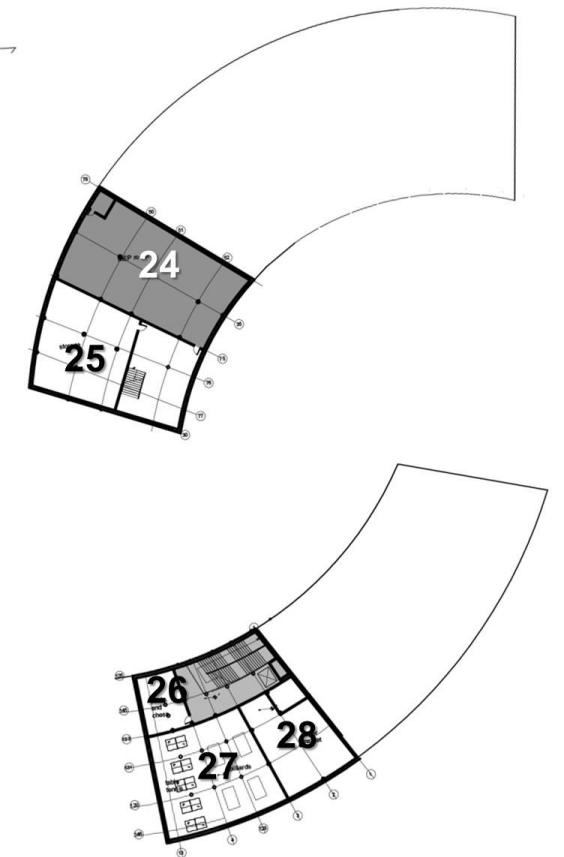

# BASEMENT PLAN

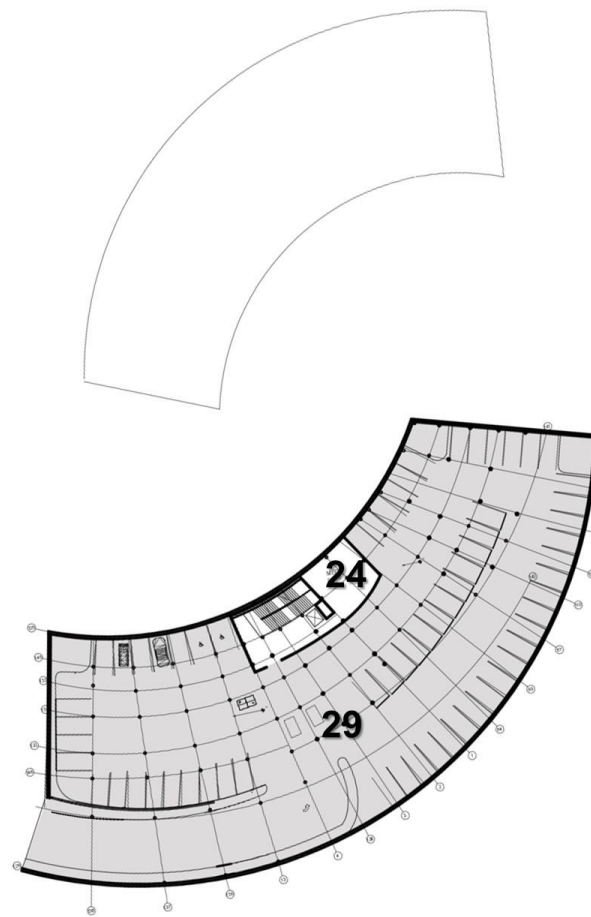

# LEGEND

- |                            |                          |
|----------------------------|--------------------------|
| 1. reception               | 21. boxing room          |
| 2. administration          | 22. yoga room            |
| 3. bathroom                | 23. basketball room      |
| 4. kids' area              | 24. MEP-room             |
| 5. multipurpose kids' area | 25. Storage              |
| 6. café                    | 26. Chess and cards room |
| 7. café kitchenette        | 27. Youth room           |
| 8. outdoor sitting area    | 28. Supermarket          |
| 9. playground              | 29. Parking              |
| 10. Outdoor Football court |                          |
| 11. clinic                 |                          |
| 12. massage room           |                          |
| 13. sauna                  |                          |
| 14. shower room            |                          |
| 15. locker room            |                          |
| 16. lifeguard room         |                          |
| 17. kids pool              |                          |
| 18. main pool              |                          |
| 19. indoor seating area    |                          |
| 20. gym                    |                          |

# ELEVATIONS & SECTIONS



East elevation



B-B section

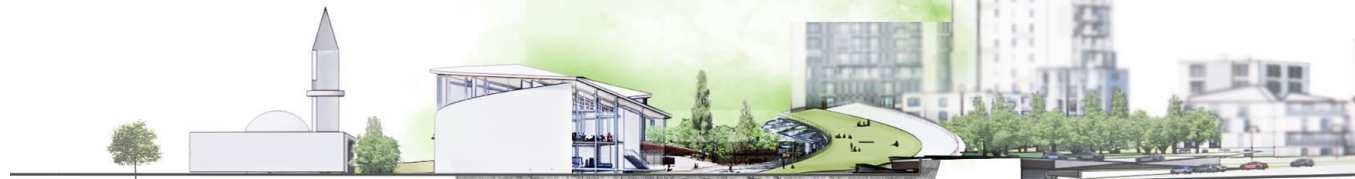

West elevation



A-A section

# EXPLODED DIAGRAM



# SUSTAINABLE ASPECT

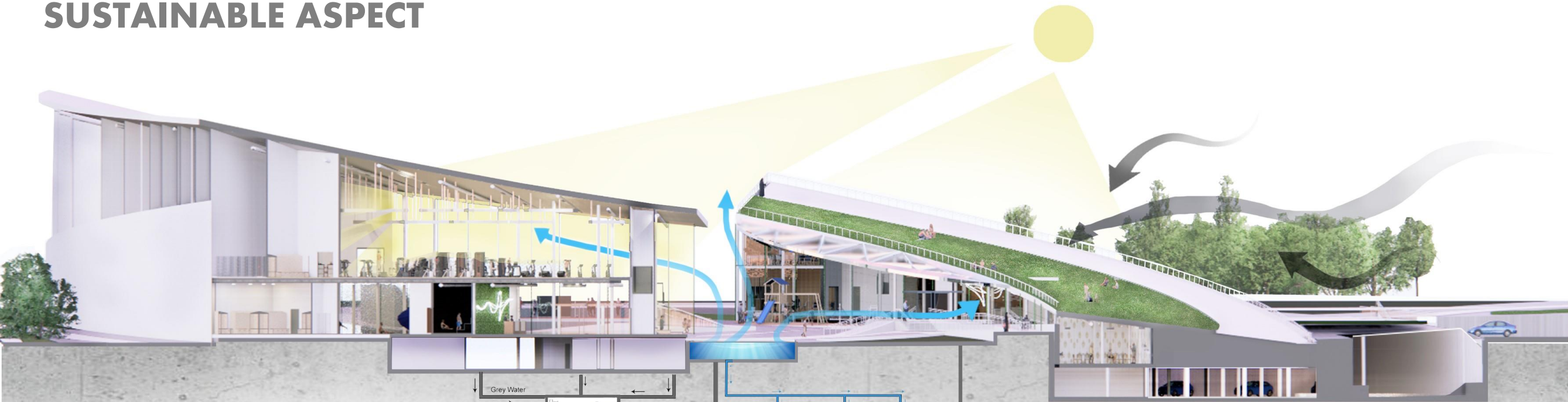

## materiality

The glass used reduces the noise coming from the highway

## form

The sloped form helps to bounce off the pollution coming from the freeway with addition to the green buffer

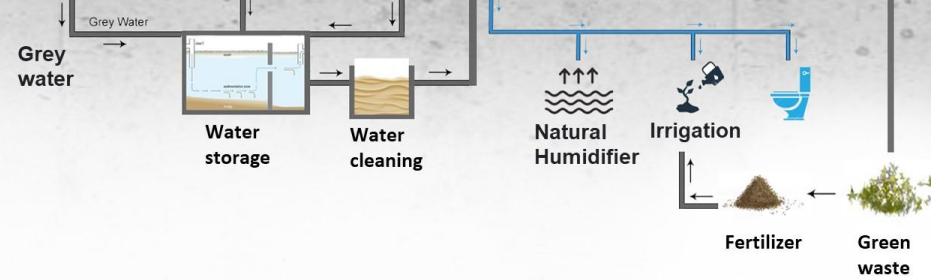

## U-vale

thermal transmittance which represents how quickly heat will pass through the glass has been taking into consideration and tried to be as lower as possible

## U-VALUE

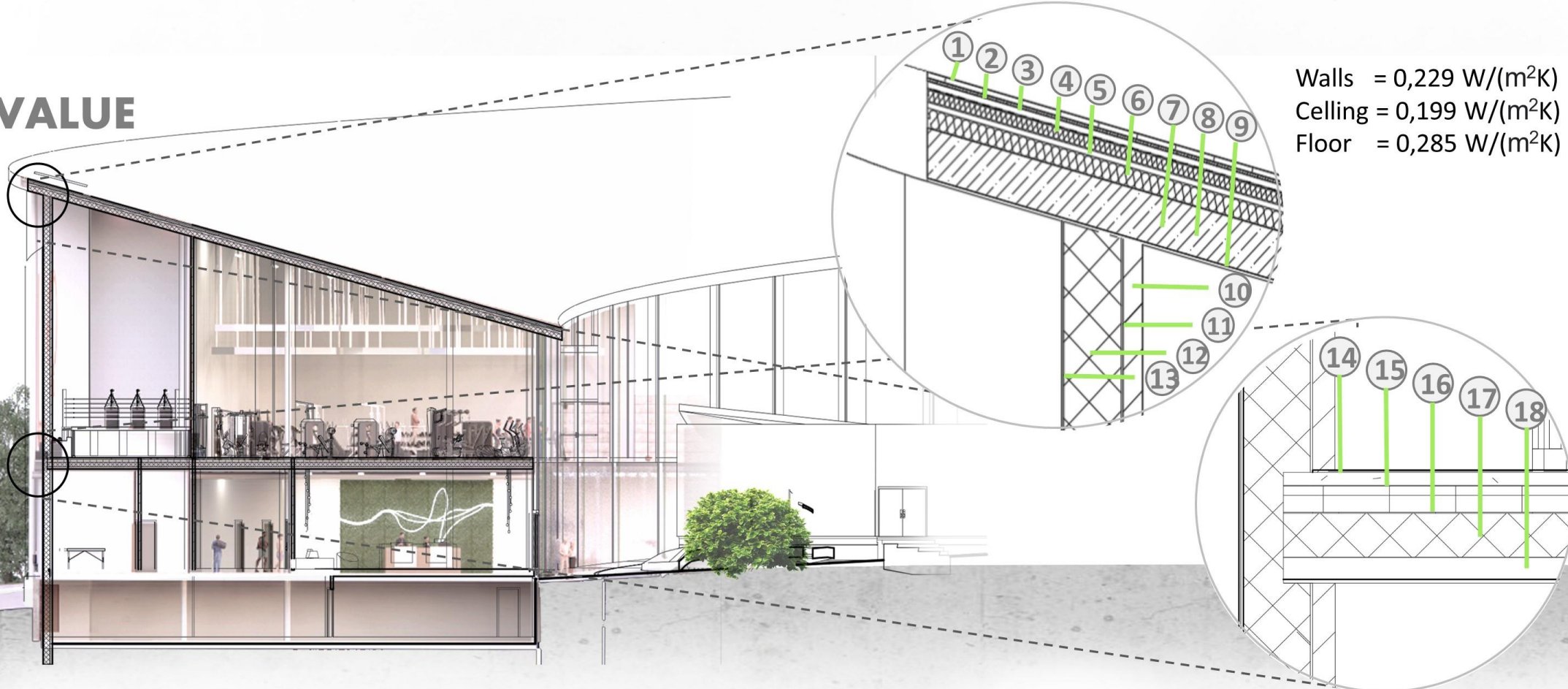

Walls = 0,229 W/(m<sup>2</sup>K)  
 Ceiling = 0,199 W/(m<sup>2</sup>K)  
 Floor = 0,285 W/(m<sup>2</sup>K)

1. Tiles
2. Cement screed
3. Dry sand
4. Bitumen
5. Wood fibers
6. Cement screed
7. Polystyrene insulation
8. Reinforced concrete
9. Clay plaster
10. Gypsum plaster
11. Concrete
12. Lime cement plaster
13. Wood fiber insulation
14. Tiles
15. Dry sand
16. Foil
17. Rigid panels
18. Bitumen pvc

# SHOTS



# NIGHT RENDER

