



RE-DESIGN BEIRUT PORT PROJECT



Beirut Port is among the top 10 ports in the Mediterranean and is considered a gateway to the Middle East. The port has been transformed through self-financing from a local port to a regional port and transshipment center in the region. The port of Beirut is located at the intersection of longitude 35 degrees 57 minutes east and latitude 35 degrees 15 minutes north and it constitutes a meeting point for the three continents: Europe, Asia, and Africa. During the seventies of the twentieth century, the port of Beirut was the most important station for international trade with the surrounding Arab countries, and it still retains this commercial advantage to this day.

Free zone in the port of Beirut
In the mid-seventies and at the beginning of the civil war, all operations were halted in the port of Beirut and the free zone, which was considered to be the strongest and most important commercial area in the Middle East to date. By the end of the nineties and with the end of the war, the Beirut port administration set in mind a new strategy that revolved around rebuilding what had been destroyed and restoring the vital role of Beirut Port and its free zone. Today, the free zone constitutes an essential part of the city of Beirut and its port, whose distinctive nature and important geographical location at the meeting point of several civilizations cannot be ignored. Free zone buildings and equipment

The free zone consists of four modern build
Three industrial buildings Buildings No. 5 and 6, each of them covers an area of 4000 m² and includes 52 warehouses with an area of approximately 200 m² for each warehouse, including 16 warehouses on the ground floor, with a height of 6.5 m, and the rest is distributed between the first and second floors, at a height of 4.5 m, in addition to 5 warehouses with an area of 70 millimeter
Building No. 2 covers an area of 4000 m² and includes 38 warehouses with an area of approximately 200 m² for each warehouse, 12 of which are on the ground floor, with a height of 6.5 m, and the rest is distributed between the first and second floors, at a height of 4.5 m.

Main Layout

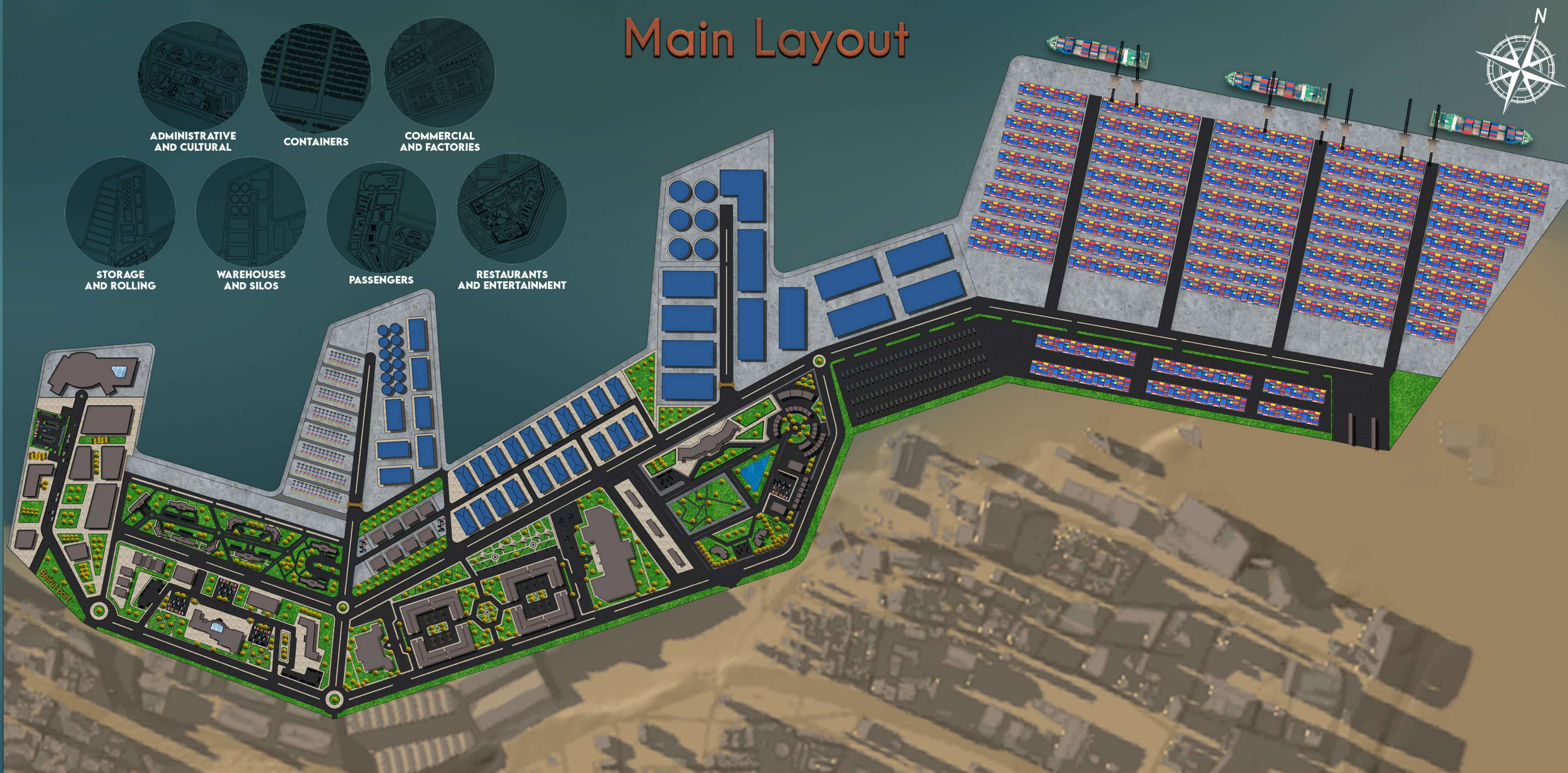

Main Shoot



Important Plans



Plans

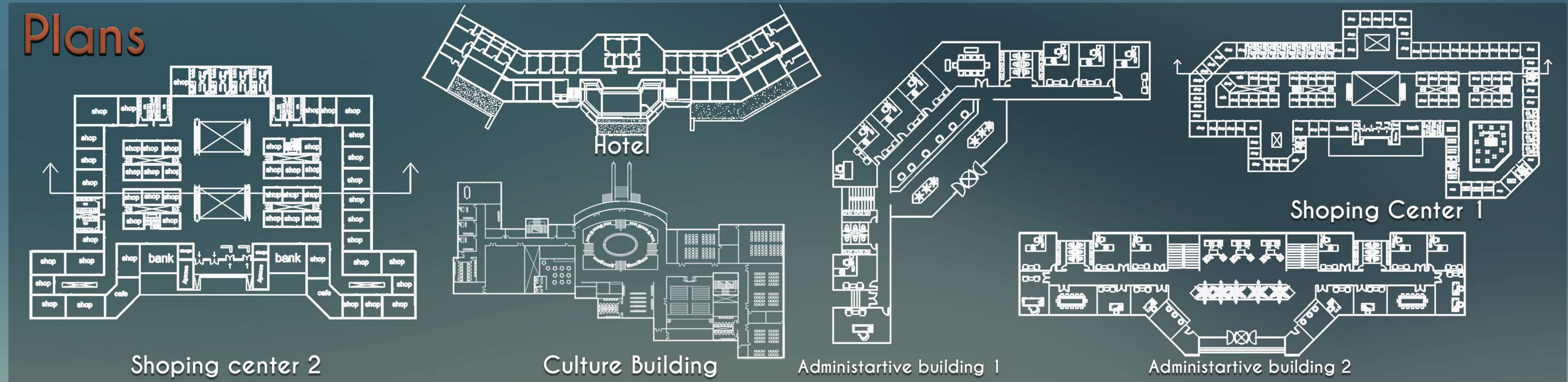

Sections



Elevation

