

SUSTAINABILITY DEVELOPMENT AND STRATEGY

A performing stage on the water, reactivating the Docks and the community

CREATING A PLACE WHERE EVERYONE CAN MEET

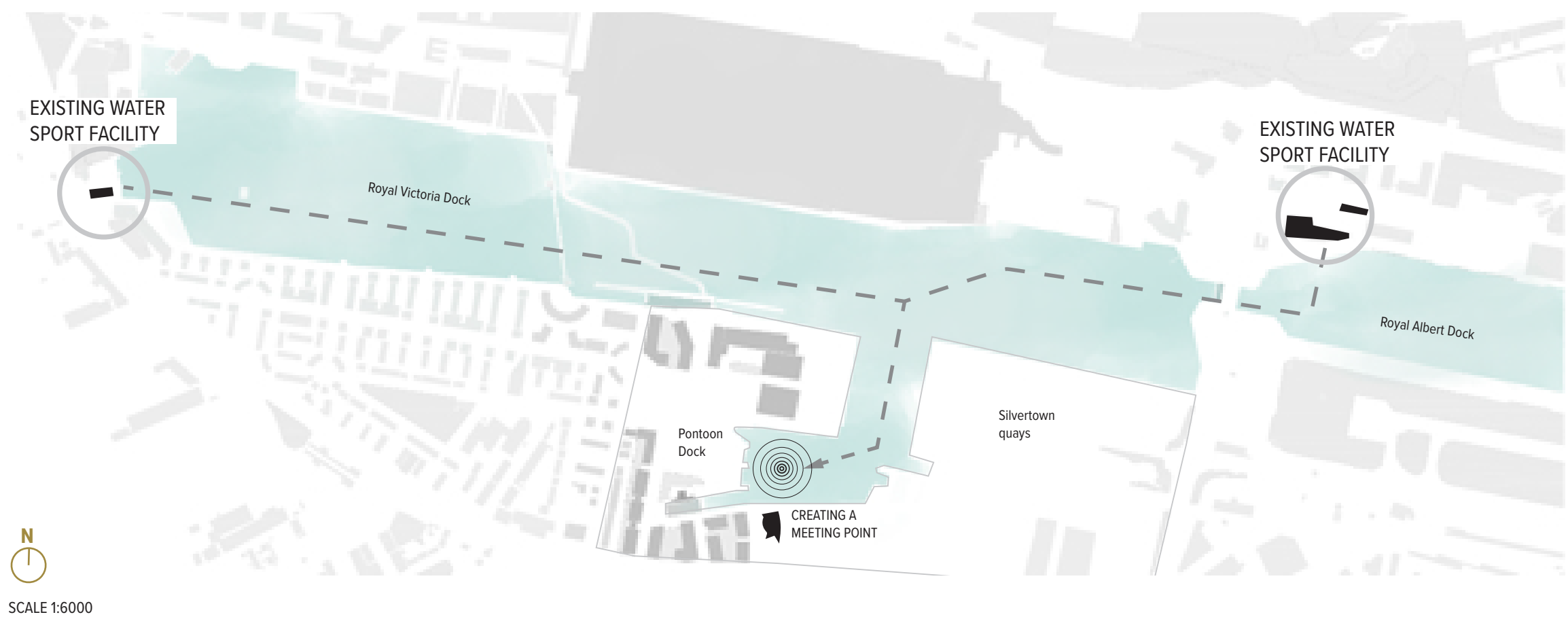

Pontoon Dock and its water will be reactivated by creating a place that allows the existing water activities in Royal Victoria Dock to interact one with the other. The more people become aware of what is happening on the docks, the more they should be encouraged to try new activities as well and experience the docks in multiple ways.

STRETCHING THE AXIS

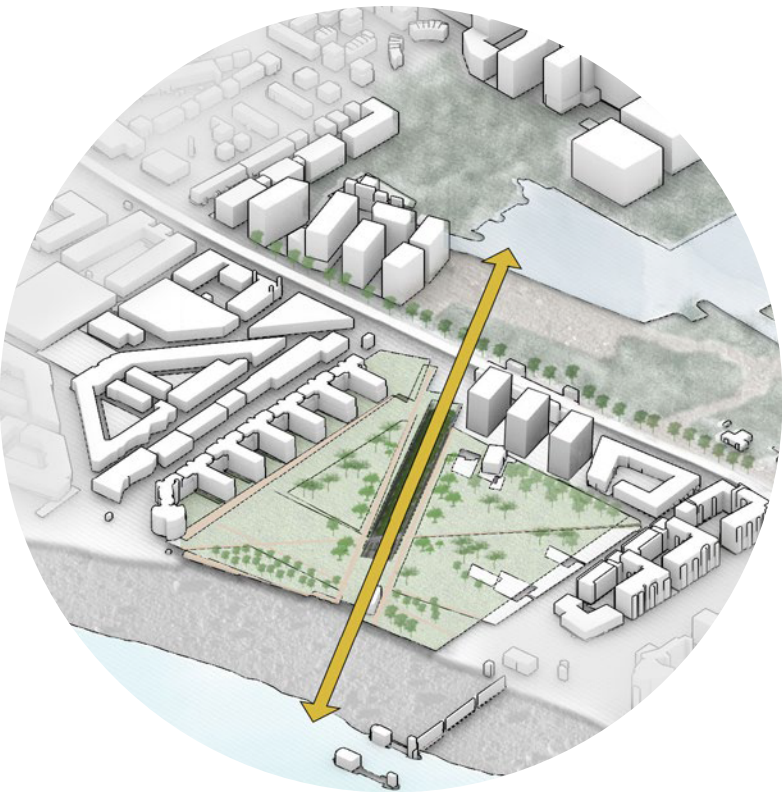

Linking the Docks with the River Thames offers the view of a body of water as a final destination when following the axis found in Thames Barrier Park.

ADMIRING THE DOCKS LIKE IN A THEATRE

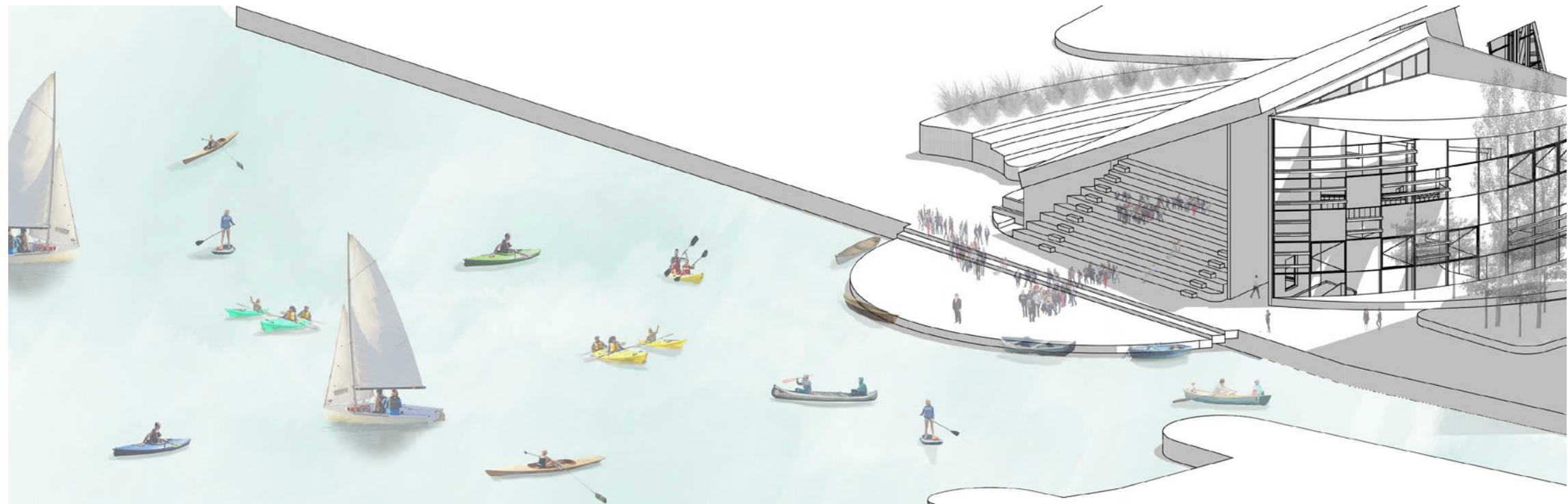

Sport activities present in the Royal Docks include:

- Canoeing
- Paddling
- Open water swimming
- Rowing
- Sailing

Because of the new activities happening in Pontoon Dock, people should be able to gather interact with the Docks. The proposal offers an open-air amphitheatre that can become a shelter to admire the performance of the sports activities. People usually gather around bodies of water.

RECONNECTING

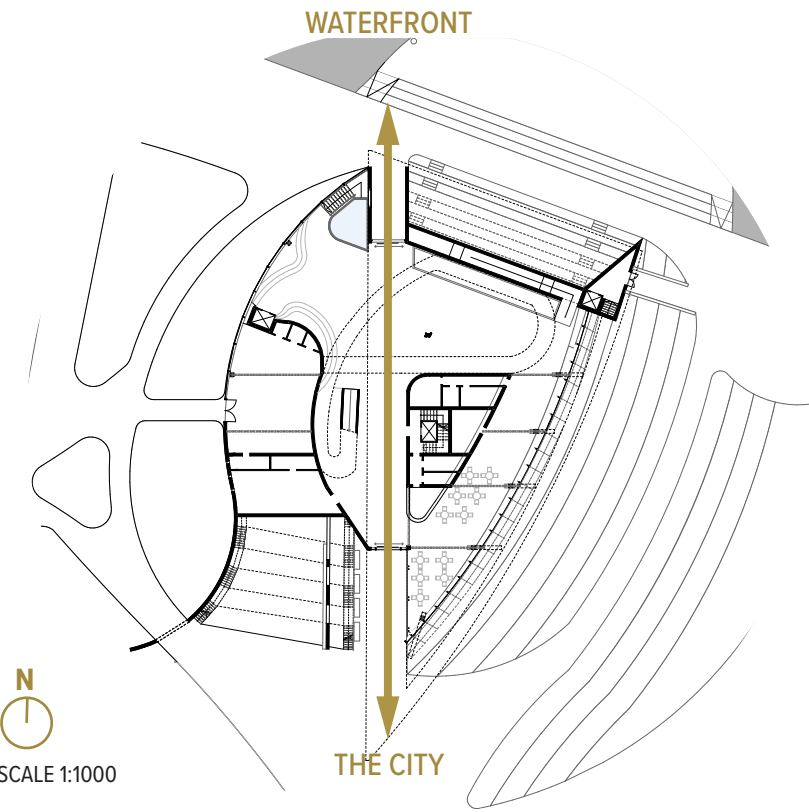

Connecting the waterfront to the city through the axis already established by the sunken garden in Thames Barrier park. Moving from place to the other will be perceived as a single experience.