



Exterior view of the mosque, being part of the urban fabric of the Nugegoda city by performing a unique identity to itself and to the city

PLURALISM | A MOSQUE TO NUGEGODA A TEMPLE TO HAPUTALE

At the beginning of religions there were no followers. So, every religion is not originally made for its followers, but for human beings. It originally comes in an acceptable and welcoming manner. But, with the evolution and rise of a religion, it is built in to a closed group and always tries to stand out from the others, as a result of identity politics. Religious architecture also has been projecting this phenomenon.

Hence, this is an attempt to drive religious architecture to harmonize with its original roots. The project suggests a typology for a mosque and a temple, which is an architectural expression of the holistic philosophy of both religions.

The whole project is woven with the concept "pluralism" in order to create an acceptable religious space and a dialogue with the community.

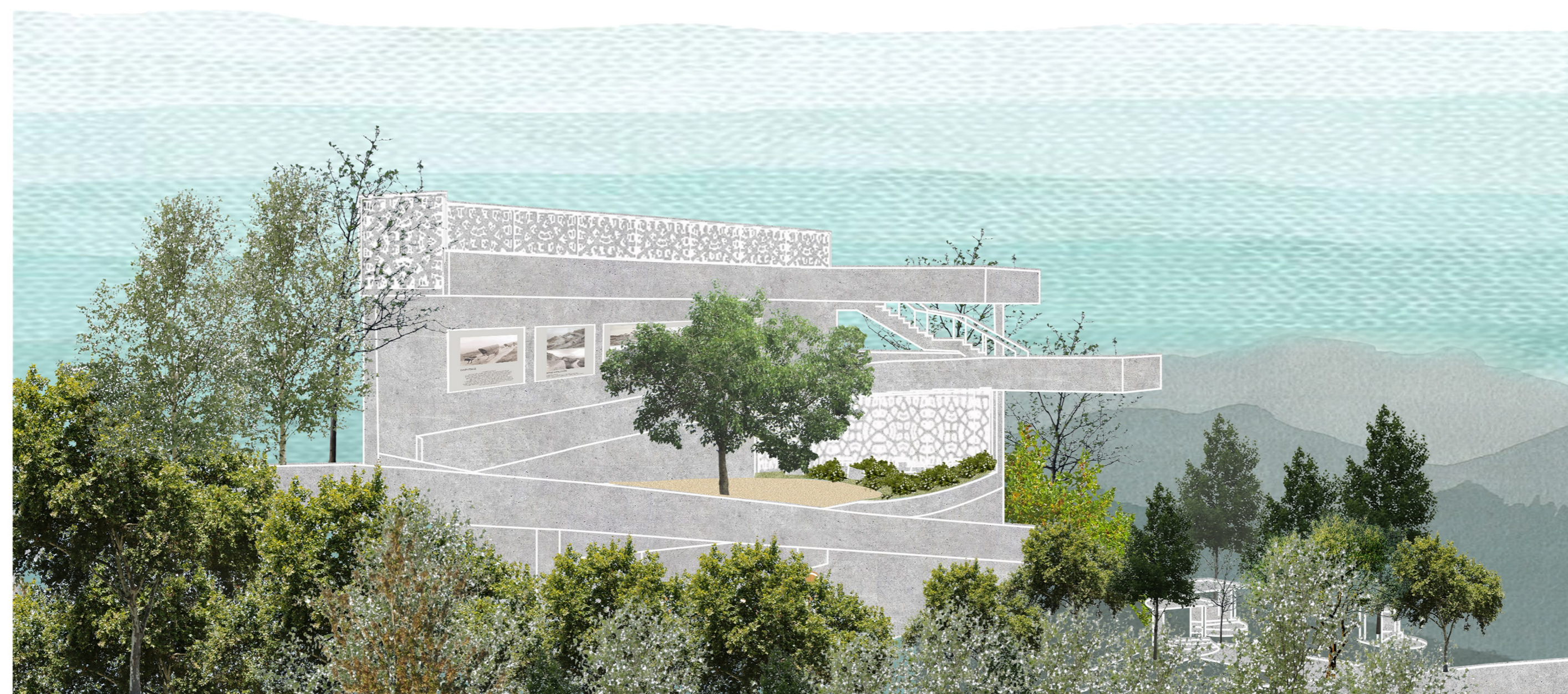

Exterior view of the temple, making a unique entrance to the Haputale city by enhancing its character and giving an opportunity to be a part of it for its users