

# ECOLOGICAL RESOURCE CENTRE AT JANAKPUR

CONTEXT + INTRODUCTION

## ECOLOGICAL RESTORATION

Ecosystems are dynamic communities of plants, animals, and microorganisms interacting with their physical environment as a functional unit. Urbanization results in a series of both local and far-reaching effects.

## ECOLOGICAL RESOURCE CENTRE

- An ecological resource centre is a centre specially dedicated for knowledge of ecology, its resources and research.
- Will provide a wide range of learning activities by making information available regarding the ecological aspects and factors affecting the ecological development of Janakpur.
- Along with local skill and knowledge development through workshops and trainings.

## SPACES INCLUDING:

- EDUCATIONAL RESOURCE SPACES
- RESEARCH LABS
- QUARTERS/DORMITORY
- OFFICES
- TRAINING ROOMS
- PRESS/PUBLICATION
- GALLERY SPACES - ECOLOGICAL GALLERY
- CULTURAL GALLERY

## SITE ANALYSIS

Janakpur is well known for its religious aspect. Not just religiously the city is also rich ecologically. Renowned as an ancient town of ponds. The city owns more than 200 sacred ponds. One of 52 ponds used to be a source of potable water.

The main reason behind the degrading situation are:

- the improper management of waste
- lack of awareness
- encroachment of pond land.

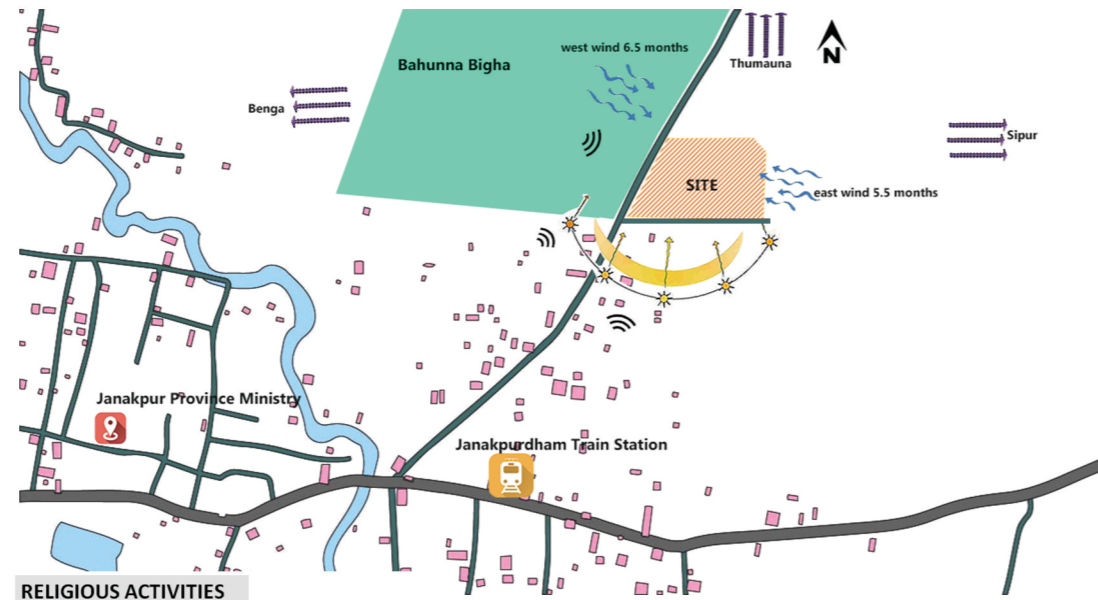

### RELIGIOUS ACTIVITIES

- Janaki temple area.
- Ganga Sagar and Dhanuschatra pond.
- Barha Bigha and Bahunna Bigha.

### GOVERNMENTAL ACTIVITIES

- Province Ministry Office
- Janakpurdham Train Station.

### EDUCATIONAL ACTIVITIES

- Janakpur Women Development Centre.
- Ganga Sagar Public Library.
- Ramswaroop Ramsagar Multiple Campus.

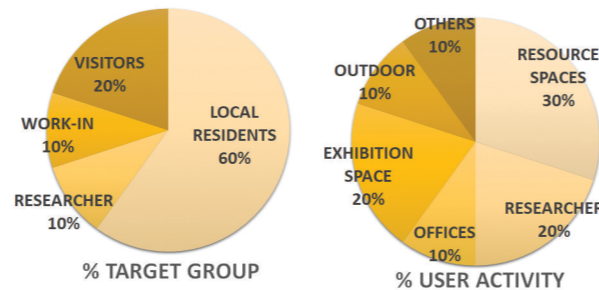

## STUDY & INSPIRATION

### JANAKPUR WOMEN DEVELOPMENT CENTRE(JWDC)

Location: Kuwa, Janakpur

Objective: Study about training programs and vernacular architecture

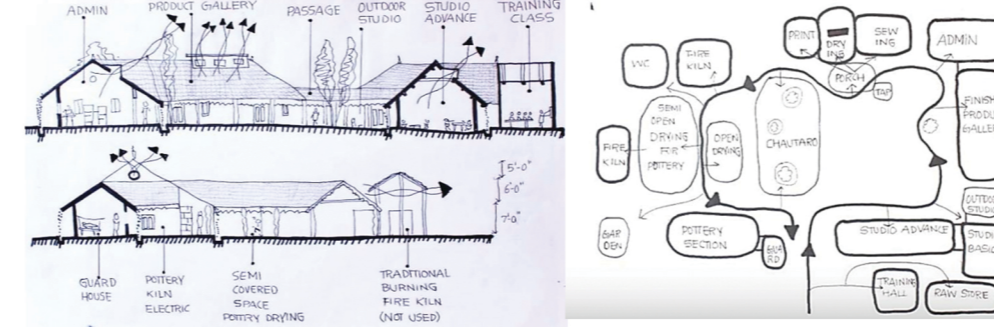

### EL HUMEDAL ENVIRONMENT RESEARCH FACILITY

Location: Valle de Bravo, Mexico

Objective: Study about the overall features of the research facility.



### AUROVILLE VISITOR'S CENTRE

Location: Tamil Nadu, India

Objective: Study of spaces, use of materials and climate responsive green design



## MATERIAL & CONTEXT

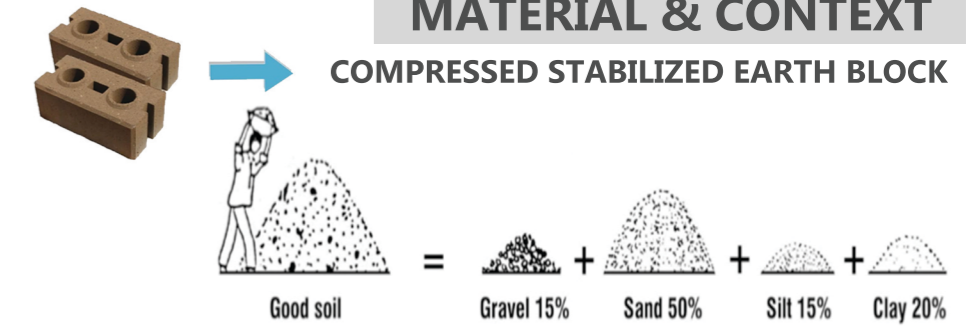

### PROS

- Natural resource management.
- Human resource management.
- Thermal comfort.
- Creative and aesthetic design.
- Energy efficient and environment friendly.
- Economic and efficient.

- Low emission for construction and use than conventional buildings and systems
- 4 times less initial embodied energy
- 3 times less operating energy

### CONS

- Not suitable for high-rise buildings and wide-spans.
- Proper soil identification required.
- Difficulties for experimentation on design.
- Water effects prominent.

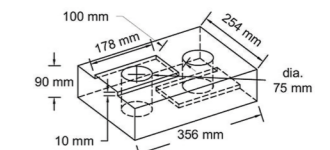

### FOR:

- Local Residents
- Researchers
- Tourists: Domestic & International
- Ecological Enthusiasts

### BY:

- NGOs, INGOs
- Government Offices
- Local Committees

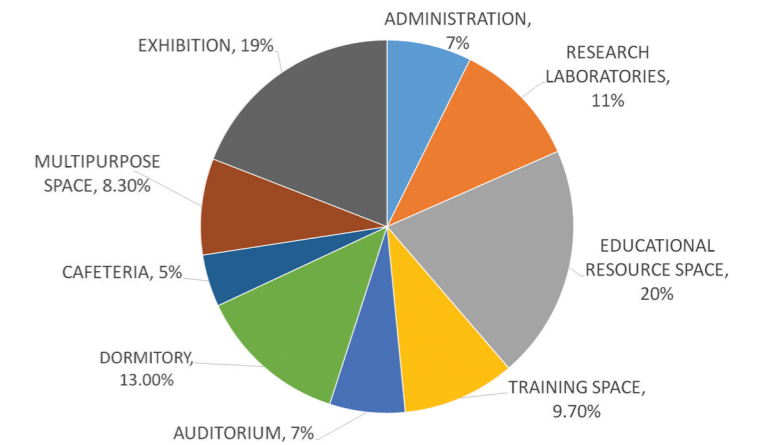

## AIM & PROPOSED PROGRAMME CHART