

USER GROUP

The number of higher education institutions in India has risen considerably over the past five years, to cater to the current and expected demand. However, while this may be the case, students still tend to cluster in certain regions. A similar cluster we found near our site, and from the land use map, we analyzed that our site is surrounded by various institutions. As found, there are 11 graduation colleges around the site and only 2 paying guest facilities are available. Colleges hostel services cater to some 15 percent of students. Showing cluster of unsatisfied students spread in that zone, looking for their accommodation in other areas.

Jaipur is an economic and learning hub of Rajasthan. Some 85% of students studying here are from outside of the state creating a significant demand for accommodation. "High-quality student accommodation is emerging as a differentiator, influencing the choice of an increasingly mobile student body on where to study." At present, private home-owners continue to dominate the student housing market. The majority of students either rent apartments or live in private hostels outside of the university campus. The quality of this accommodation is often way below what students want, or expect.

Today's best universities are built on the development of cross-border partnerships, the strength of academic networks, and the ability to attract students from around the world. Accommodation is playing a big role in supporting this, by helping in creating student communities. These institutions compensate the student's demand for academics but are unable to cater to such a large group for accommodation. "Students from around the world want to be in the right place, in terms of good quality accommodation with facilities and communities that add value to their experience." Thus, habitat built purposefully for students will meet their requirements with a different idea of space than apartment housing, enhancing their living, and fulfilling their requirements.

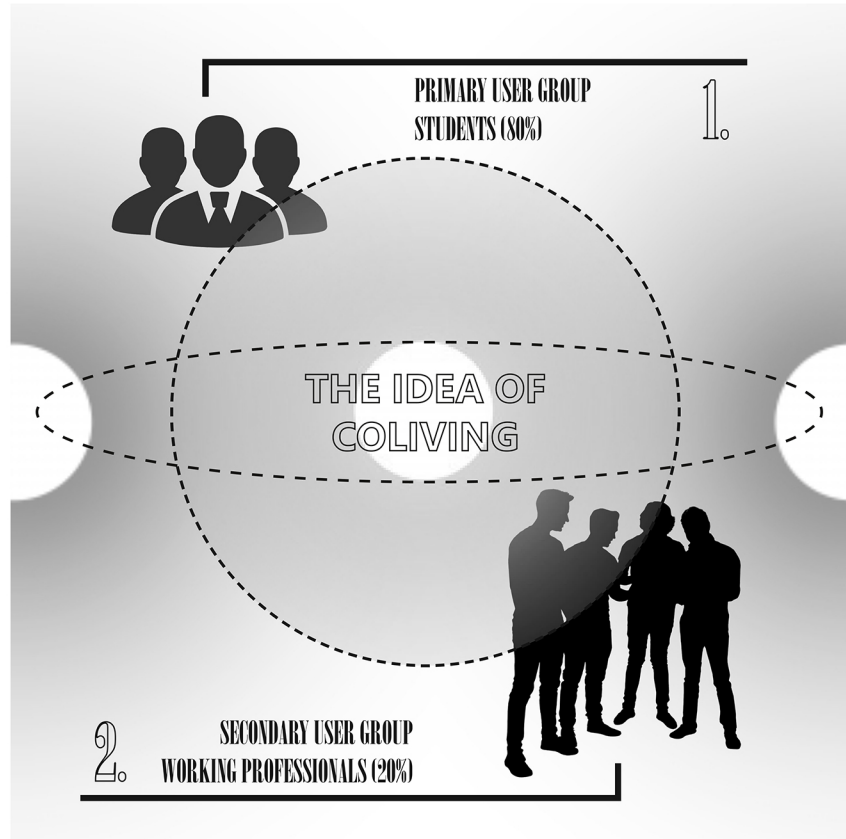

DIAGRAM SOURCE : AUTHOR

DEALING WITH THE USER GROUP- The idea of Co-Living

STUDENT LIFE- This period of life is the learning stage where students' steps towards a different mode of life and this is the transition phase between the two different modes, the phase between child and a Man. Thus, their habitation is critical and can have an impact on their lives based on the idea of living.

As this is the learning period for them, we analysed that there are four types of learners based on their learning style and these are-

1. Diverging (feeling and watching)

These people are able to look at things from different perspectives. They are sensitive. They prefer to watch rather than do, tending to gather information and use imagination to solve problems. People with a diverging learning style have broad cultural interests and like to gather information. They are interested in people, tend to be imaginative and emotional, and tend to be strong in the arts. People with the diverging style prefer to work in groups, to listen with an open mind and to receive personal feedback.

2. Assimilating (watching and thinking)

People with an assimilating learning style are less focused on people and more interested in ideas and abstract concepts. People with this style are more attracted to logically sound theories than approaches based on practical value. People with this style prefer readings, lectures, exploring analytical models, and having time to think things through.

3. Converging (doing and thinking)

People with a converging learning style are best at finding practical uses for ideas and theories. They can solve problems and make decisions by finding solutions to questions and problems. People with a converging learning style are more attracted to technical tasks and problems than social or interpersonal issues. A converging learning style enables specialist and technological abilities. People with a converging style like to experiment with new ideas, to simulate, and to work with practical applications.

4. Accommodating (doing and feeling)

The Accommodating learning style is 'hands-on,' and relies on intuition rather than logic. These people use other people's analysis, and prefer to take a practical, experiential approach. They are attracted to new challenges and experiences, and to carrying out plans.

They commonly act on 'gut' instinct rather than logical analysis. People with an accommodating learning style will tend to rely on others for information than carry out their own analysis. This learning style is prevalent within the general population.

These various learning styles tells us about individuals' habit and activities and this could be integrated with their living creating continuum of learning by integrating learning and living. Where students are already learning living in home far from their home, this could be done by socialising individuals and creating highly experiential living and learning with sharing thoughts, spaces and ideas. Thus with inhabiting, framing the lives too.

In this fast-paced world, being part of a community is an important element to foster the individual mental health, happiness. Which is huge step towards this idea of integrated learning and living. Living in a single studio, for example, can be extremely convenient, but at the same time it can lead to loneliness and affect the overall personal wellbeing. Avoiding alienation and this sense of loneliness becomes a key step to consider while developing habitat for integrated living.

New generations want to be able to focus on work, but also enjoy a rich social life and connect with other peers. They want intimacy when needed and at the same time the possibility to engage with a more globalised personal network and build meaningful and fruitful connections, especially when living away from home and framing their lives.

Socialising individuals tends to the idea of co-living as the concept behind co-living relies on the fact that sharing facilities and experiences improves interpersonal interactions, while efficiently using the available space. As variable users from different places creating diverse community. But the idea of integrated co-living tends form a single community of habitation from variable communities.

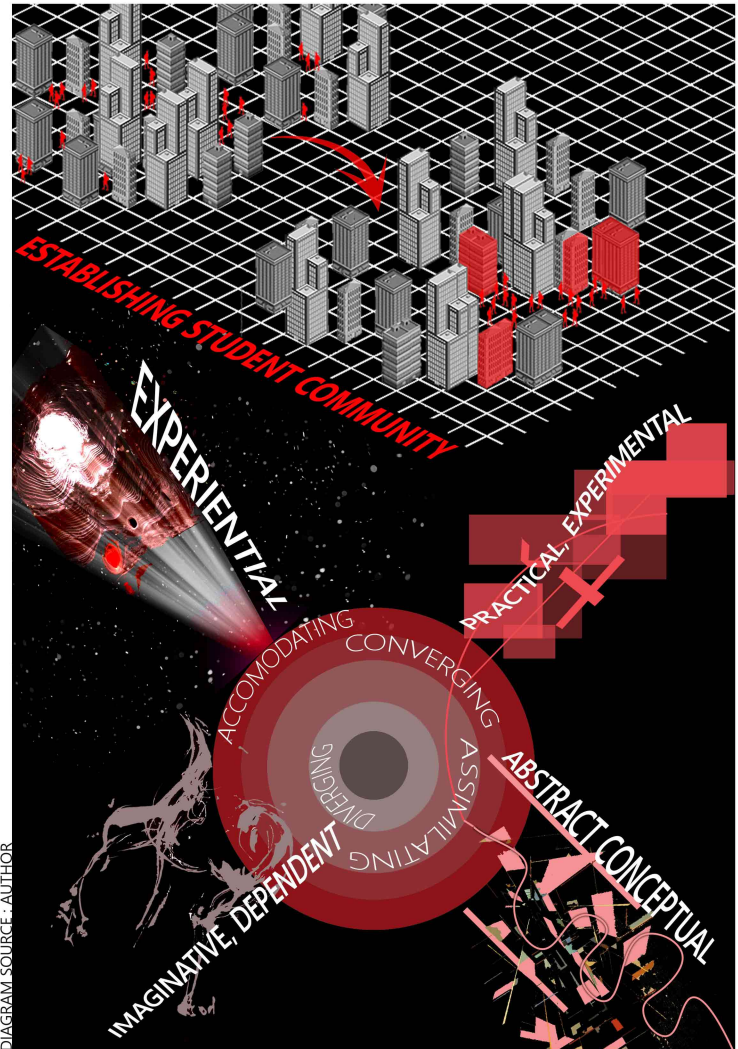
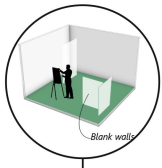
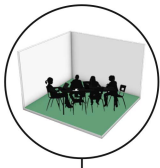

DIAGRAM SOURCE - AUTHOR



Blank walls

1. Open Art Space



2. Group Working Area

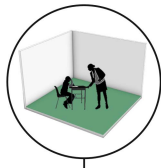

3. Mentor-Mentee

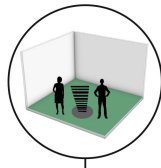

4. Innovative Zone

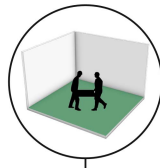

5. Temporary Workshop

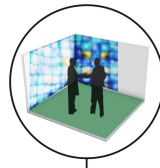

6. Digital Zone

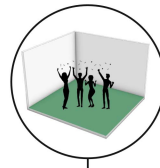

7. Celebrate

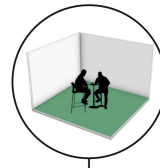

8. Open Cafe

LEARNING . CORRIDOR

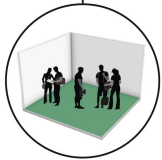

9. Discussion Zone

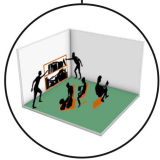

10. Mini Open Library

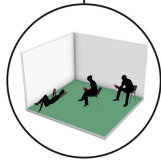

11. Self Study

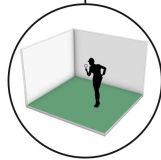

12. Observe

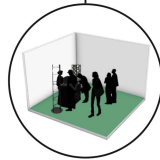

13. Display Area

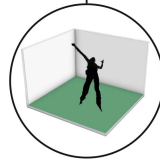

14. Viewing Terraces

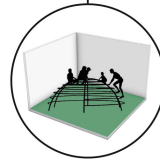

15. Play Area

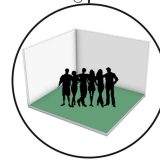

16. Collaborative Incubator

a. Diverging (Feeling & Watching)

- Art & Craft space with blank walls
- Group working area
- Discussion area
- Mini library
- Mentor mentee
- Celebration area
- Collaborative incubator
- Open cafeteria

b. Assimilating (Watching & Thinking)

- Self-study area
- Mini library
- Innovative/creative zone
- Observing space
- Workspace
- Digital zone

c. Converging (Doing & Thinking)

- Workshops
- Display area
- Working area
- Digital zone
- Play area

d. Accomodating

- Viewing area
- Display area
- Self-study area
- Working area
- Gathering area
- Collaborative incubator

2020 HABITAT STUDIO : UNIT JAIPUR (SITE : MANSAROVAR)						
AREA PROGRAMMING & SERVICES CALCULATIONS						
(Units Used : sqm) unless mentioned						
	Sqm	Acre				
Site Area	27600	6.8				
FAR	1.33					
Built Up	36705	9.07				
Density	250/ACRE	1700 User				
A RETAIL [R] - 10% - 3670.5						
Unit Type	Area	No. of Units	Total Area			
Anchor Stores (ex- Crossword, V Mart, Om Book Shop, 1 Minisu etc)	300	4	1200			
2. Shops	25	16	400			
	50	12	600			
3 Food Court & Etries	200	2	400			
	75	4	300			
Supermarket						
4 (ex- Spencers, Easyday)	300	2	600			
5 Public Services (includes toilets)	40	4	160			
	TOTAL		3660			
B CIRCULATION [C] - 15% - 5505.75						
1 Total Building Circulation		15	5505.75			
	TOTAL		5505.75			
C HABITAT FACILITIES [O] - 3180						
Unit Type	Area	No. of Units	Total Area			
1 Habitat Office	20	2	40			
2 Reception + Waiting	50	1	50			
3 Gym	300	2	600			
Dining Commons						
4 (60% of users at a time)	540	1	540			
5 Dining Commons Kitchen	360	1	360			
6 Cloakroom	50	2	100			
7 Digital Zone	75	2	150			
8 Squash Tennis	65	2	130			
9 Laundry Facilities	200	1	200			
10 Club house	75	2	150			
11 Plugin + Green Voids	860		860			
	TOTAL		2320			
	[R] + [C] + [O]		17485.75			
	[RE]		23860			
D RESIDENTIAL [RE]						
Unit Type	Area	Percentage	Total Area	No. of Units	Final	People/Unit
Single	21	15	3579	170.428571	178	1
EWS	34.9	20	4772	136.733524	142	2
Triple	31.5	45	10737	340.857143	340	3
2 BHK	104.5	20	4772	45.6650718	48	4
					TOTAL	1674
D PARKING [P]						
ECS	1		CAR PARKING REQUIRED			
EQUIVALENT CAR SPACE Equivalent (Car Spaces (ECS) per 100 sq m. of floor area)	367.05					368
	Area per ECS	Percentage	No. of Units	Total Area		
Basement	28	80	294.4	8243.2		
Ground Floor	18	20	73.6	1324.8		
			TOTAL	9568		
Basement	8243.2					
	Percentage	Area	No. of Units	Whole No.		
1 Car Parking	75	6182.4	220.8	220		
2 2 Wheelers	25	2060.8	294.4	295		
Ground Floor	1324.8					
	Percentage	Area	No. of Units	Whole No.		
1 Car Parking	50	662.4	36.8	37		

2 2 Wheelers	25	331.2	73.6	74
3 Cycle	25	331.2	184	184
3 Cycle Vending Machines				(Included in ground floor parking calculations)
E FIRE TANK CALCULATIONS (as per NBC)				
CATEGORY - RESIDENTIAL BUILDING				
(c) Dormitories Apartment: For Above 60m in Height				
WATER SUPPLY (in ltr)	Capacity	Size (L*B*H)		
1 Underground Static Water Storage Tank	1,00,000	4.84*2.06*5*2		
2 Terrace Tank	25,000	9*2.5*2		
F WATER TABLE CHART (as per NBC)				
1 Domestic Use (D)				
Total Occupants	1674			
Water Consumption Per Head (in ltr)	135			
Total Water Consumption	225990			
2 Commercial Use (C)				
No of shops	34			
Average Water Consumption Per Day	25			
Total Water Consumption	850			
Market Visitors (M)				
3 (Drinking + Common Facilities)				
Average Footfall Estimated Per Day	500			
Per Visitor Water Requirements	15			
Total Water Consumption	7500			
TOTAL WATER CONSUMPTION (D) + (C) + (M)				
	234340			
Number of Tanks	2			
Tank Size (L*B*H)	(4.84 * 2.42 * 5)			
For 2 days - Number of tanks	4			
Tank Size-Professional Tower (L*B*H)	5.1*2.55*1			
Tank Size-Habitat Tower (L*B*H)	(3.55*7.07*2)			
G SEWAGE TREATMENT PLANT (*as per Akruthi Enviro Solutions)				
Estimated Sewage = 90% of Domestic Consumption			203391	
TOTAL (liters/per day approx)			205000	
Size of Sewage Treatment Plant				
Volume (L*B*H)	(7 * 8.5 * 3.5) mtrs			
H RAIN WATER HARVESTING CALCULATIONS				
As per Norms (8000 ltr/ acre)				
Total Number Of Percolation Pits				
1 (Storm Water Line)	7			
Pit Size (L*B*H)	(1.01 * 2.02 * 4)			
2 Rain Water Tank				
Building Roof Top Area (sqm)	2450			
Jaipur Annual Rainfall (mm)	601			
Runoff Coefficient	0.9			
Total Water Saved (ltrs)	110433.75			
Tank Size (L*B*H)	(4.84 * 4.55 * 5)			
I SOLAR ROOFTOP CALCULATIONS : LOCATED ON PROFESSIONAL TOWERS ONLY (Considering Life-Time 25Yrs)				
As per Ministry of New and Renewable Energy				
Average solar irradiation in RAJASTHAN state is 1266.52 W / sq.m				
1KWp solar rooftop plant will generate on an average over the year 5.0 kWh of electricity per day (considering 5.5 sunshine hours)				
Total Roof Top Area Available	448 Sqm			
State	Rajasthan			
Customer Category	Residential			
Size of Power Plant	44.8 KW			
Total Electricity Generation from Solar Plant :	67200kWh			
Carbon dioxide emissions mitigated is	1378 tonnes			

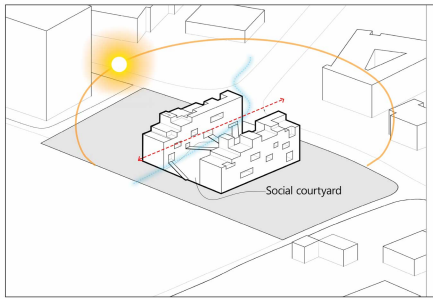

1. Form chosen for habitat design considering sun path for sufficient daylight and shaded courtyard, following natural ventilation and dividing built into two parts for creating social courtyard in between.

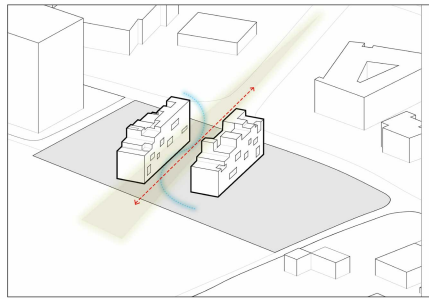

2. Tilt towards west to align the void with existing Mansarovar link road which frames the view towards upcoming largest park. And also this tilt provides with efficient wind flow and ventilation.

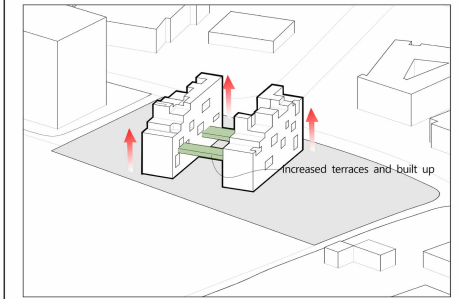

3. Connecting the two blocks to increase the terraces, interaction and built up providing more open spaces for students, also height is increased to accommodate more floors and required users.

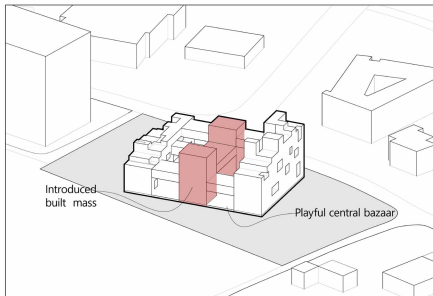

4. Introducing built mass between blocks increasing GFA and maintaining social courtyard by elevating central block and thus ending with playful bazaar as a central social space increasing interaction.

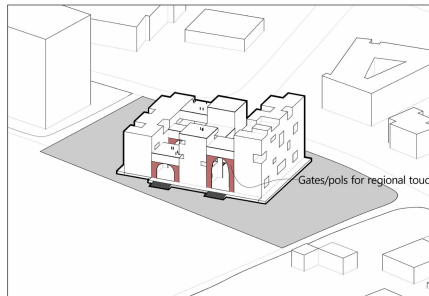

5. Adding regional touch to the final structure with reference to rich welcoming style of Jaipur. where gates/pol are used for landmarks in major market area of Jaipur walled city

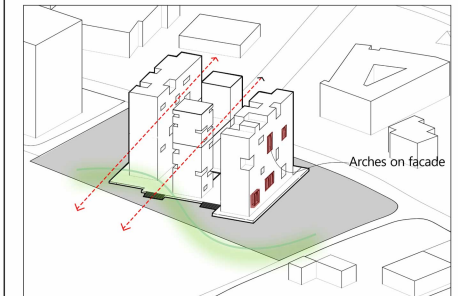

6. Arches are transferred on facade to break away the typical character of facade with opening the views through voids between the masses and considering setback ending up with Zig-zag form.

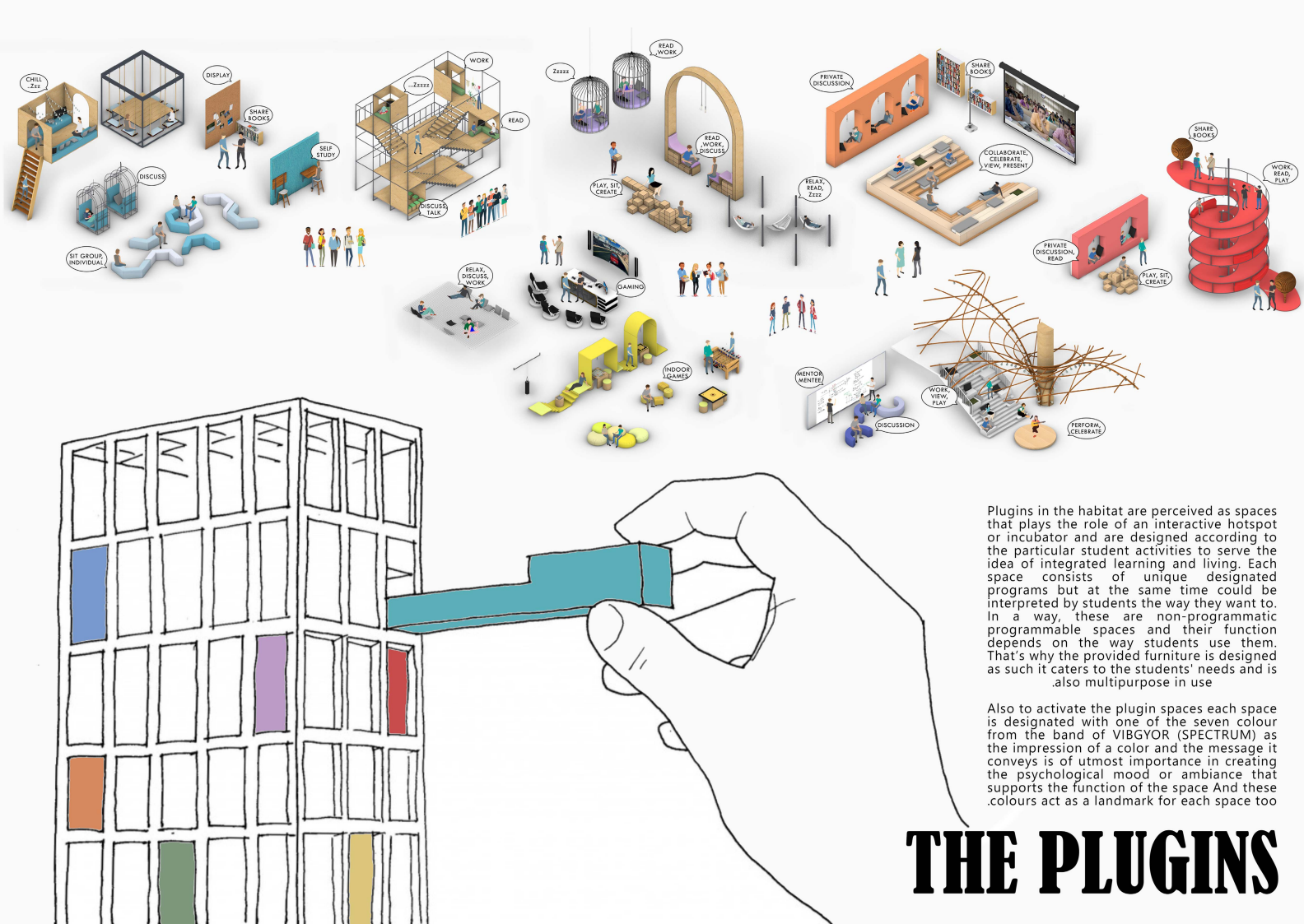

Plugins in the habitat are perceived as spaces that plays the role of an interactive hotspot or incubator and are designed according to the particular student activities to serve the idea of integrated learning and living. Each space consists of unique designated programs but at the same time could be interpreted by students the way they want to. In a way, these are non-programmatic programmable spaces and their function depends on the way students use them. That's why the provided furniture is designed as such it caters to the students' needs and is also multipurpose in use

Also to activate the plugin spaces each space is designated with one of the seven colour from the band of VIBGYOR (SPECTRUM) as the impression of a color and the message it conveys is of utmost importance in creating the psychological mood or ambience that supports the function of the space And these colours act as a landmark for each space too

THE PLUGINS

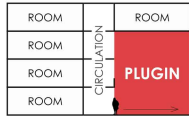

CASE 1 : Triple Ht. Plugin

In this case, the user is standing on the lowermost level of triple height plugin space, and can directly access it through circulation.

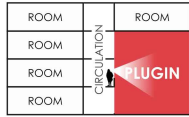

CASE 2 : Triple Ht. Plugin

In this case, the user is standing on the middle level of triple height plugin space, and can see what is happening in plugin space.

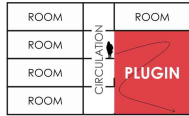

CASE 3 : Triple Ht. Plugin

In this case, the user is standing on the uppermost level of triple height plugin space, and can access it by the furniture provided in that space.

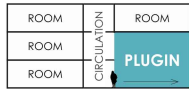

CASE 4 : Double Ht. Plugin

In this case, the user is standing on the lower level of double height plugin space, and can directly access it through circulation.

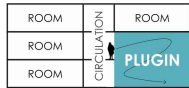

CASE 5 : Double Ht. Plugin

In this case, the user is standing on the upper level of double height plugin space, and can access it by the furniture provided in that space.

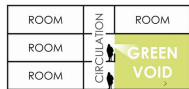

CASE 6 : Green Voids

In this case, the green voids (gardens) are added to add more breakout spaces in circulation.

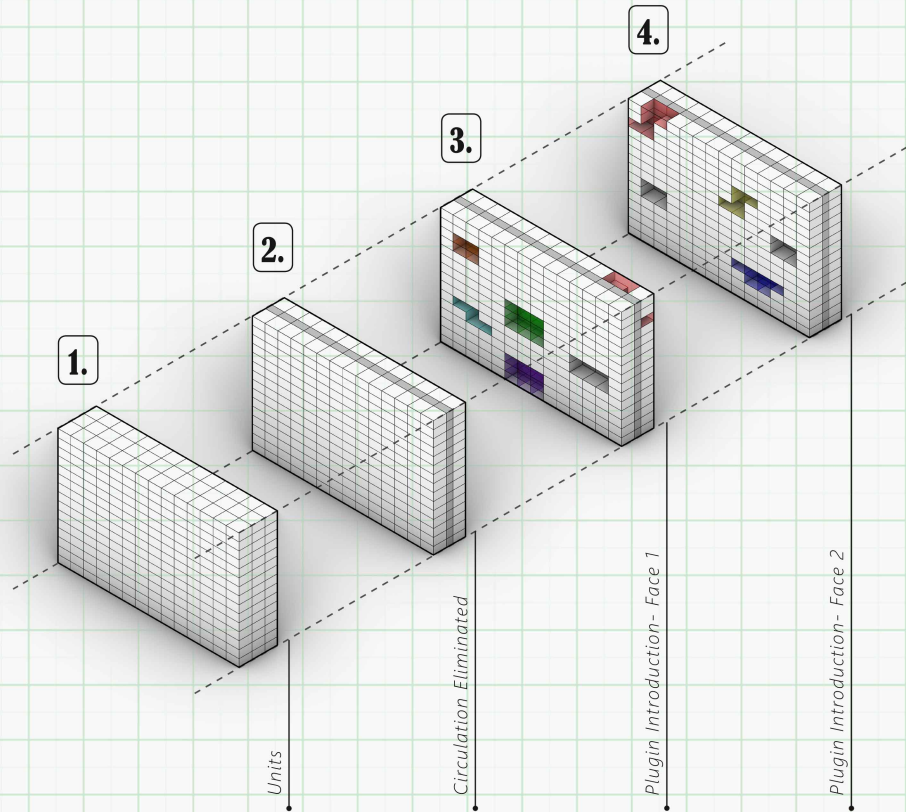

Elevation

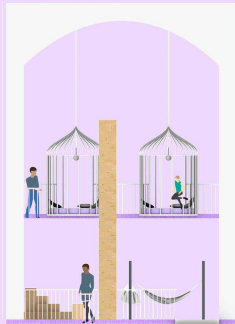

Plan

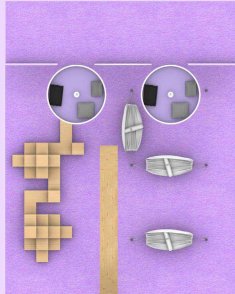

PLUGIN [V]

Violet appears as delicate, rich, or unsettling and degenerates with a feeling of dignified and exclusive.

Plugin [V] is designed with flexible block seating on one side and discussion seating embedded in the arch. Hammocks on the other side are provided for relaxing purposes and are interchangeable at their positions fixed at one end with the pole. At the upper level, the hanging cozy cages act as working and relaxing zones.

Elevation

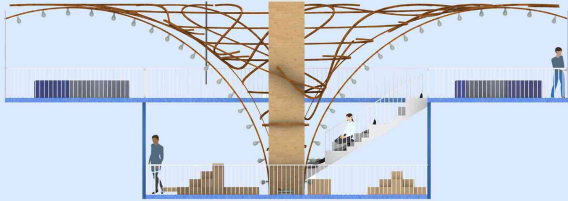

Plan

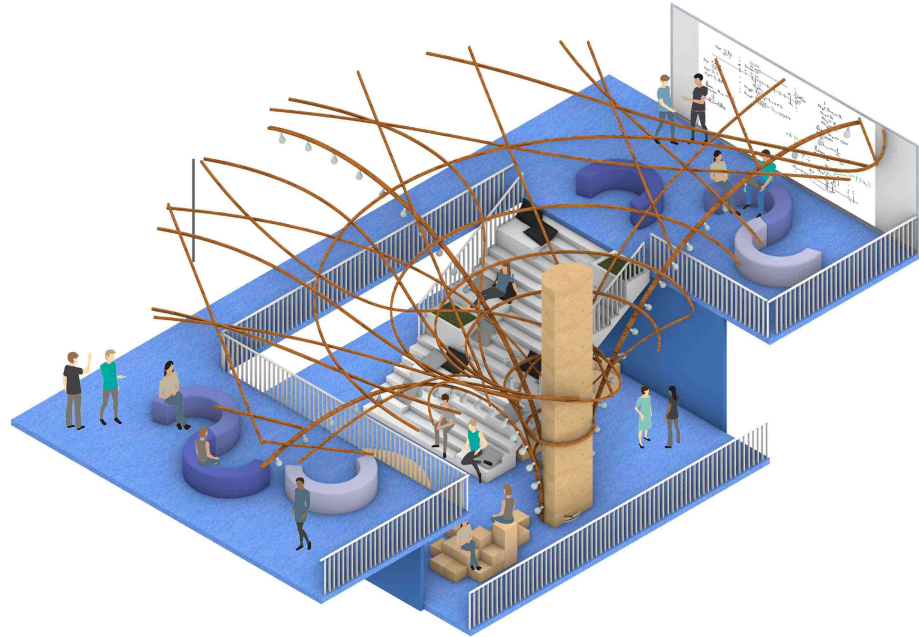
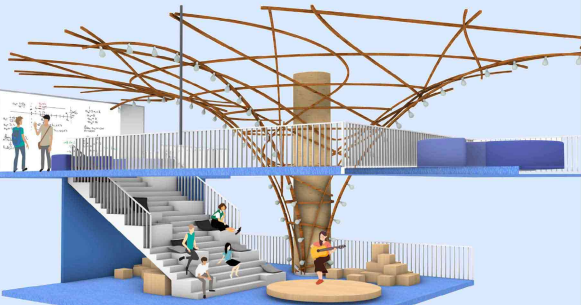
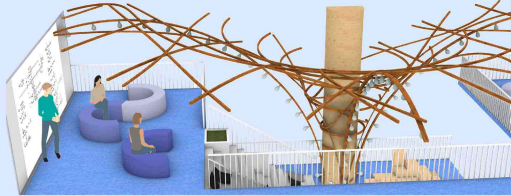
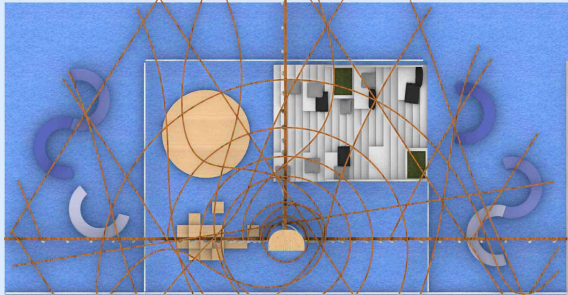

PLUGIN [I]

Indigo appears to be transparent, wet, cool, and relaxing with encouraging character.

Plugin [I] is designed as a celebration zone, performance, and gathering area with a seating stairway connecting to the other floor acting as a mini Amphi. The stairs beneath act as storage for flexible blocks to create the desired seating. On the upper floor, there are co-benches with white-boards for discussion that creates a working zone. The tree-like structure covers the space connecting two different activities and serves the lighting purpose too.

Elevation



Plan

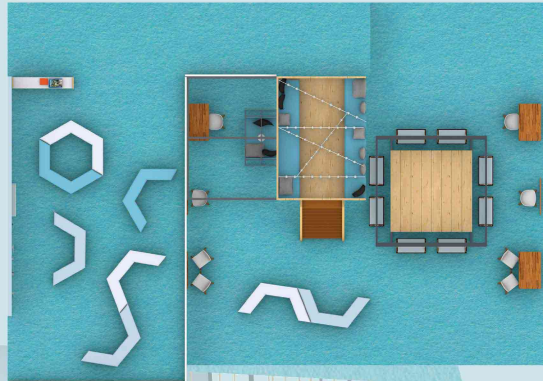

PLUGIN [B]

Blue colour is associated with words like retiring, relaxing, inspiring, calm, sober, secure, comfortable, noble and it appears to be transparent, wet, cool, and relaxing.

The Plugin [B] is designed as a relaxing and co-working space with various types of discussion spots. A foldable working table for personal work is provided which is attached to the wall when if not needed could be folded and increases the free space. A large table with swinging seating is provided for relaxed activities. Multi-purpose seating with two parts of hexagon that can have numerous arrangements. The plugin [B] is provided with two chilling spots one is used as a private, and the other space for group with comfortable seating creating a calm ambience.

Elevation



Plan



PLUGIN [G]

The green colour is associated with retiring, relaxing, refreshing, tranquil, and silence. Natural Greens is introduced to attract students and enhance their mood due to its capability. Plugin [G] is provided with a playful pavilion of miniature discussion and relaxing spots, which could be used as reading and working space too.

Large plant pot creates the identity of the space while providing a spot for seating too, the base has small bumps that could have an interpreted use according to students.

Elevation



Plan

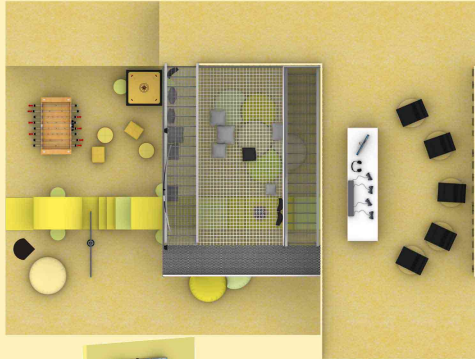

PLUGIN [Y]

The yellow colour is associated with words like cheerful, radiant, vital, glaring, and is happiest of all the colors and signifies enlightenment and communication.

Therefore the Plugin [Y] is programmed as full of cheering and interactive ambiance which consists of all the indoor brain games with digital gaming zone at an upper level, the intermediate level is provided with net for relaxing, reading, discussing, etc. and it's transparent nature creates an interactive system and helps in maintaining the void space.

Elevation



Plan

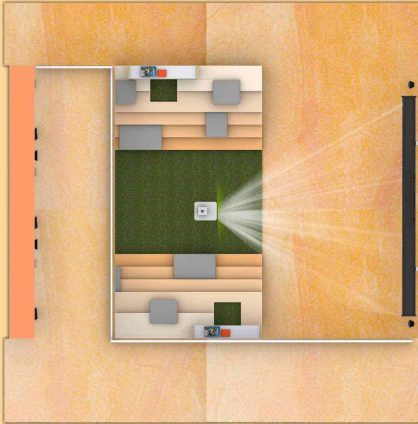

PLUGIN [O]

Common effects of orange are exciting, stimulating, cheering and words that describe it are jovial, lively, energetic, extroverted.

To enrich the vibrant colour plugin [O] is programmed as large collaborative seating with discussion pods behind. The Plugin [O] is a digital area with a presentation feature and acts as a theatre too. Bookshelves are provided where students can share their books.

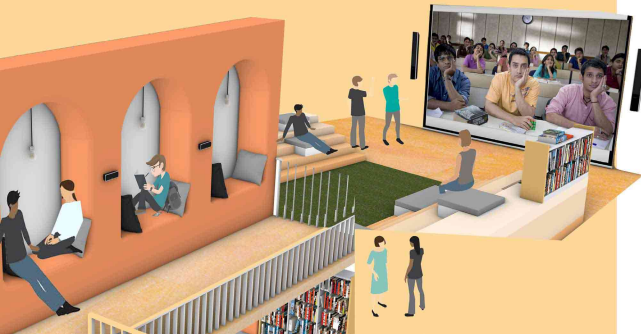

Elevation

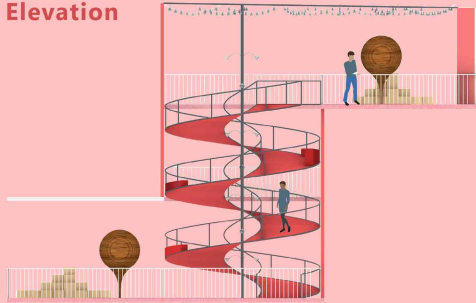

Plan

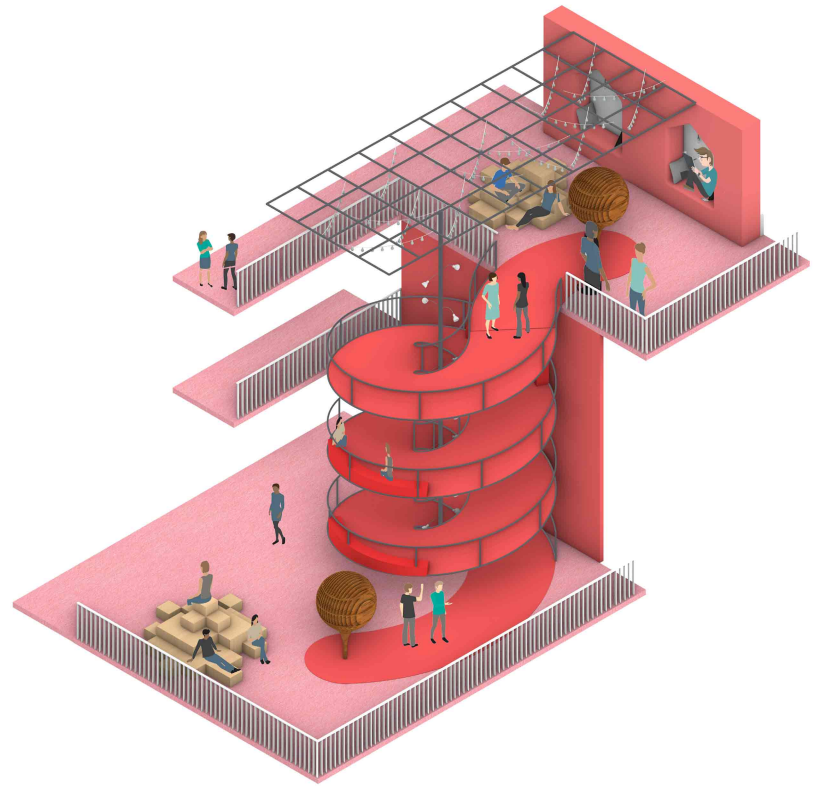
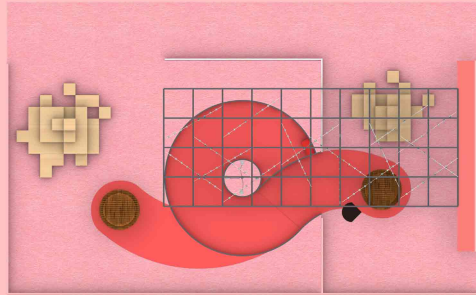

PLUGIN [R]

Red colour- Passionate, Fervid, Active, Strong, exciting, stimulating are common words associated with red.

Considering them Plugin [R] is programmed with a playful and creative approach consists of a triple-height circular ramp connecting two floors starting and ending of this ramp consist of a spherical book self with reading space provided at an intermediate level of the ramp. Discussion pods and flexible cube seatings is also provided, where a single cube/block is movable and can have numerous creative seating arrangements according to the user requirement.

iso view



■ **single occupancy**
unit layout

plan

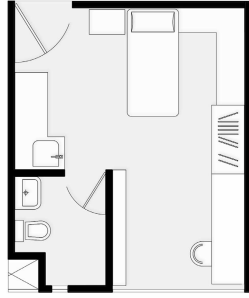

iso view



■ **ews**
unit layout

plan

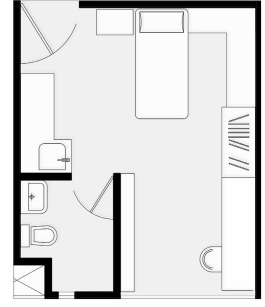

iso view



■ **triple occupancy**
unit layout

plan

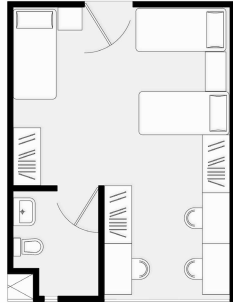

iso view

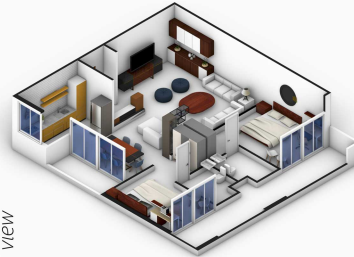

■ **2bhk**
unit layout

plan

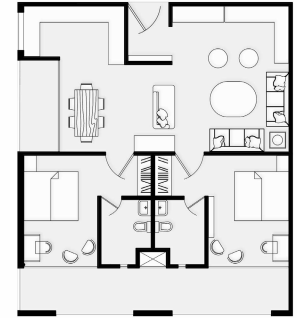

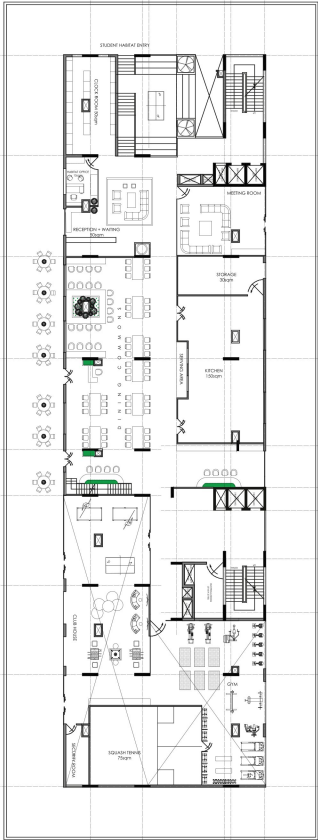

1st
floor plan

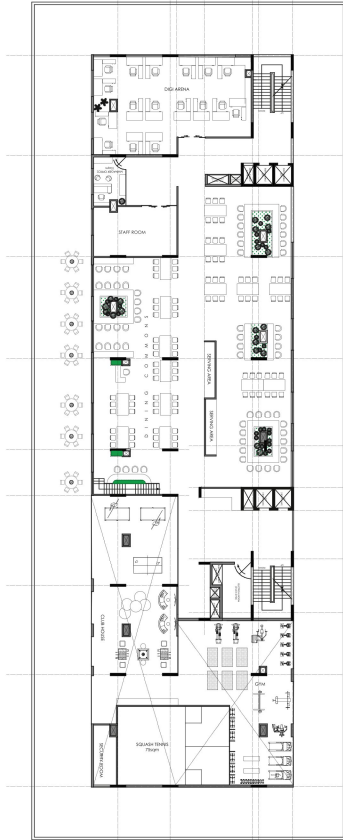

2nd
floor plan

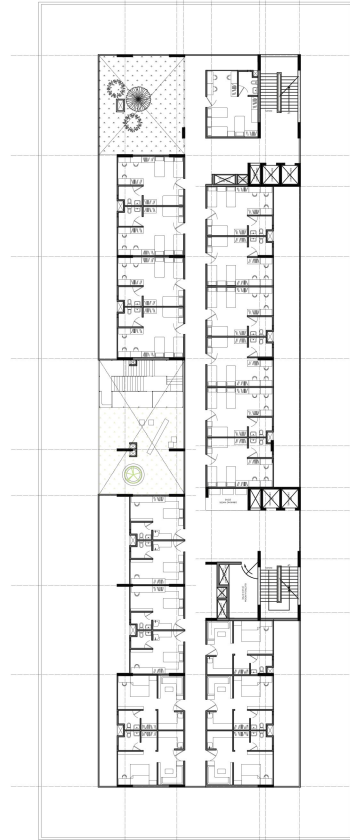

9th
floor plan

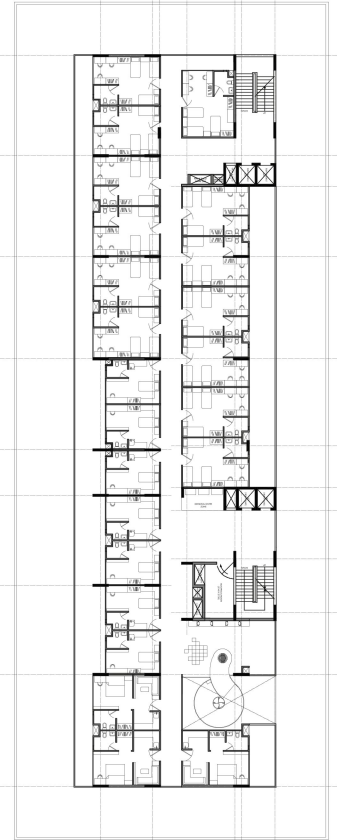

17th
floor plan

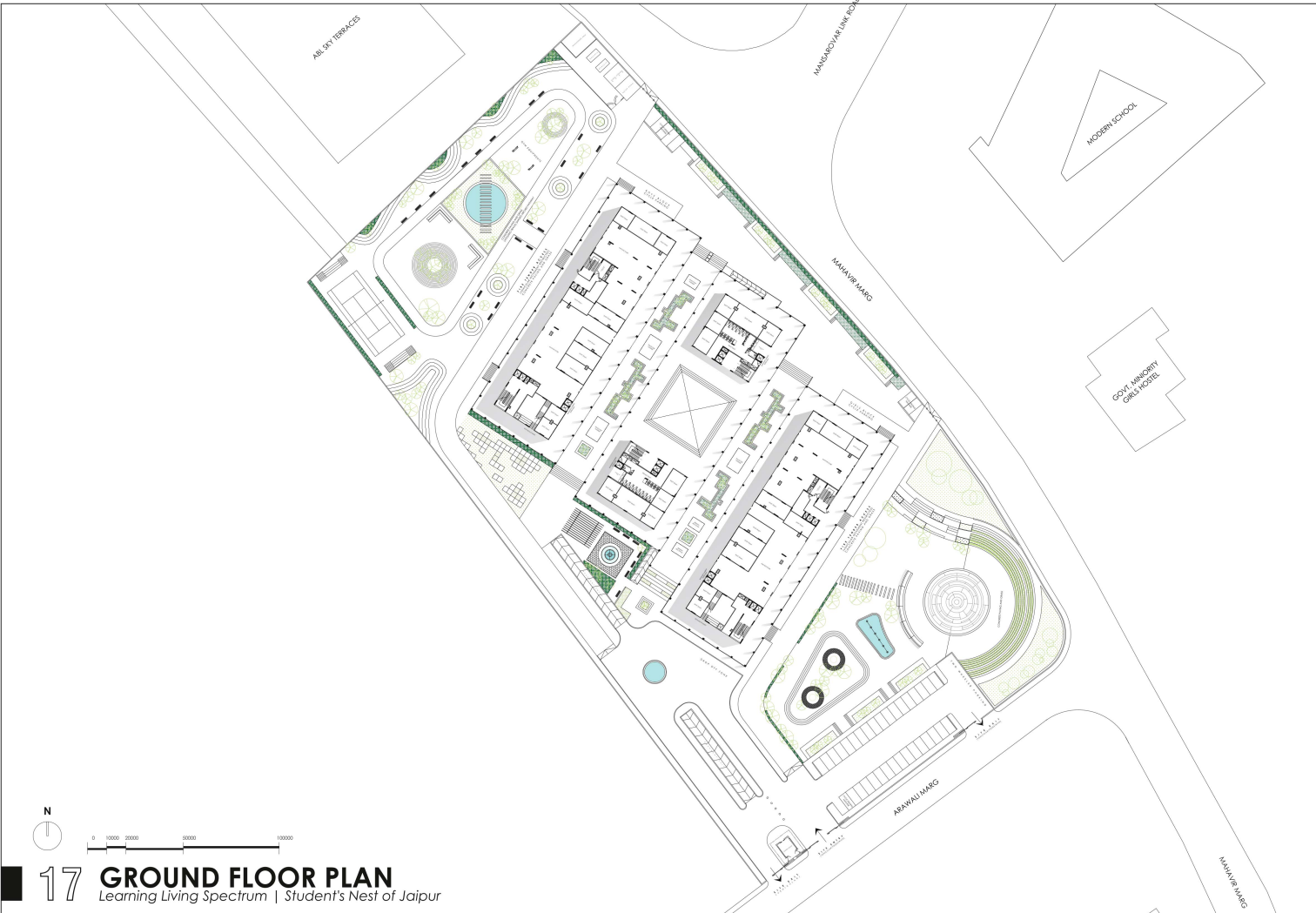

17 **GROUND FLOOR PLAN**
Learning Living Spectrum | Student's Nest of Jaipur

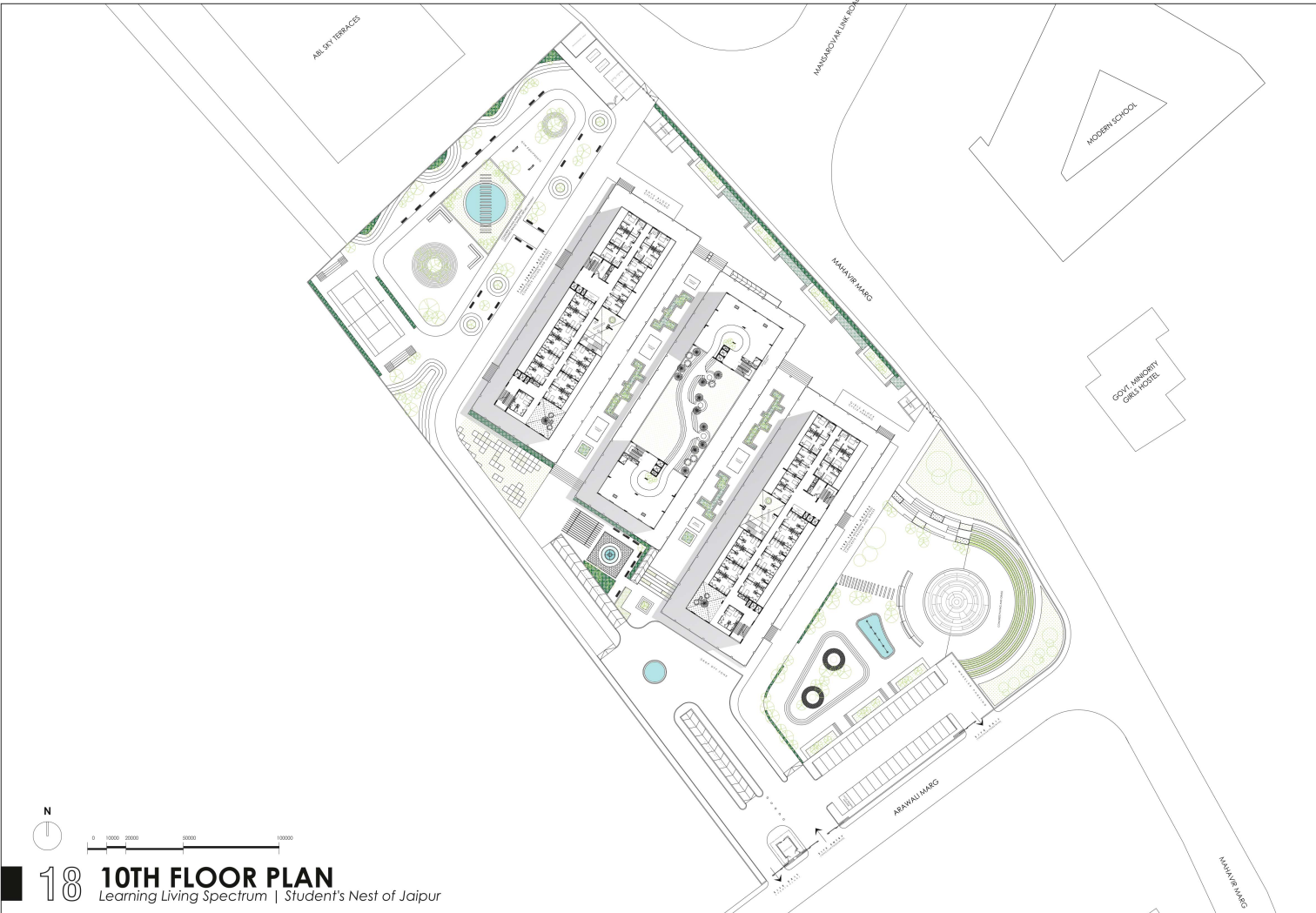

AB-GY TERRACES

MANMOHAN LAKH ROAD

MODERN SCHOOL

GOVT. MINORITY GIRLS HOSTEL

MANMOHAN MARG

ANAPALI MARG

MANMOHAN MARG



18 10TH FLOOR PLAN

Learning Living Spectrum | Student's Nest of Jaipur

DRAVAYAWATI RIVER PROJECT

HCG HOSPITAL

R.A.G. HOSPITAL

IIS SCHOOL

ABL SKY TERRACES

RHB PROPOSED AREA FOR HABITAT DEVELOPMENT

MODERN SCHOOL

GOVT. MINORITY HOSTEL

PEC JAIPUR PROJECT

ROSARY PUBLIC SCHOOL

RHB Proposed Area For Habitat Development

Upcoming 52 Acre Park

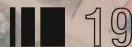

SITE PLAN WITH CONTEXT

Learning Living Spectrum | Student's Nest of Jaipur



Learning Living Spectrum
Student's Nest of Jaipur

SITE COORDINATES

26°51'54.3"N 75°46'19.7"E

Mansarovar, Jaipur (Rajasthan)

www.llsjaipur.com

SOURCE: <https://www.panitla.com/apollo-realestate/mansarovar-of-road-city-jp-1016-gold-give-panitla-0211688/>

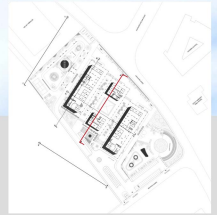
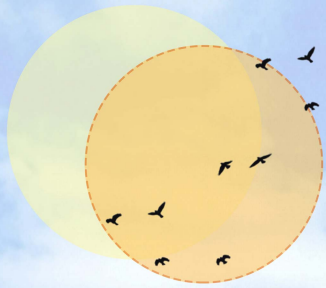

20

SECTION AA'

Learning Living Spectrum | Student's Nest of Jaipur

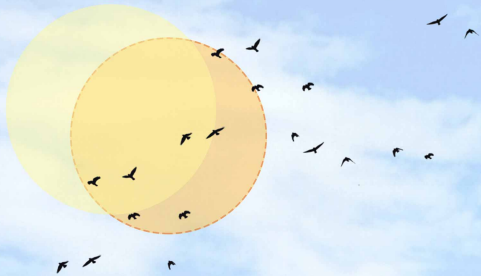

21

SECTION CC'

Learning Living Spectrum | Student's Nest of Jaipur

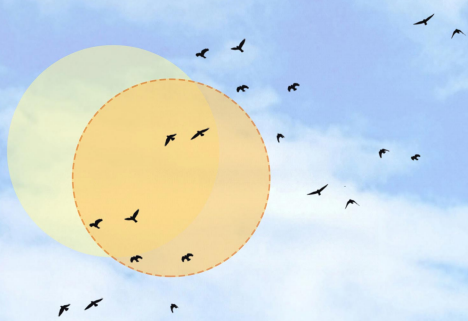

22

SECTION 11'

Learning Living Spectrum | Student's Nest of Jaipur



BOY'S BLOCK

WORKING PROFESSIONALS BLOCK 1

GIRLS' BLOCK

ARAWALI MARG

CELEBRATION ARENA

MAHAVIR MARG

MANSAROVAR LINK ROAD

WORKING PROFESSIONALS BLOCK 2

SOCIAL COURTYARD

BAZAAR

(Girls & Boys Block - Ground Floor
Working Prof. Block- Ground + First Floor)

24

BIRDS EYE VIEW

Learning Living Spectrum | Student's Nest of Jaipur



25

RENDERS

Learning Living Spectrum | Student's Nest of Jaipur





27

RENDERS

Learning Living Spectrum | Student's Nest of Jaipur



Learning Living Spectrum (Students Nest of Jaipur) - Designed by Adit Gupta & Prakhhar Rastogi
96 Views • Nov 23, 2020

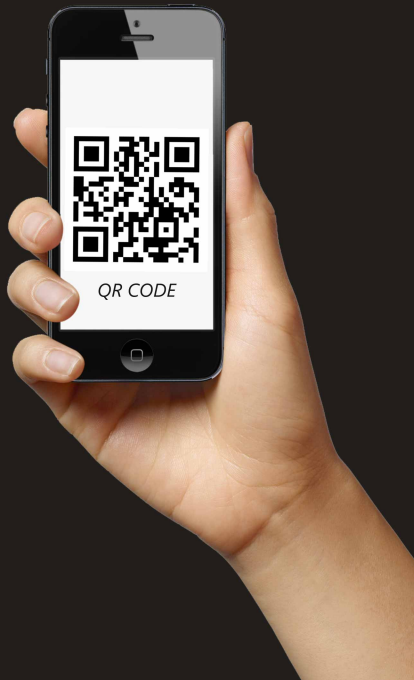

DIRECT LINK

https://youtu.be/eR4PhDAok_8

WEBSITE

<https://www.llsjaipur.com/>

