

THEATRE POPULAIRE

BURKINA FASO, OUAGADOUGOU

STUDENT: AMIRAN REKHVIASHVILI

SITE PLAN



PROJECT IDEA

THE MAIN IDEA OF THE THEATRE RECONSTRUCTION IS TO CREATE A NEW AND SUSTAINABLE ENVIRONMENT AROUND THE EXISTING THEATRE USING MODERN MATERIALS. THE MAIN BUILDING OF THE COMPLEX IS THE EXISTING AMPHITHEATRE, WHICH IS CREATED FROM AN ARTIFICIAL HILL, BECAUSE OUAGADOUGOU IS CHARACTERIZED BY FLAT RELIEF. IN THE CURRENT SITUATION, AS CAN BE SEEN FROM THE PHOTOS, THE MENTIONED HILL IS UNDOUBTEDLY THE MOST IMPRESSIVE PLACE OF THE COMPLEX, AS WELL AS QUITE A GREEN PLACE. AGAINST THE BACKGROUND OF FLAT TERRAIN IT REMINDS US OF A REAL MOUNTAIN, THIS IS WHERE THE INSPIRATION FOR MY IDEA COMES FROM.

PROJECT DESCRIPTION

THE MAIN IDEA OF THE RECONSTRUCTION IS TO CREATE SEVERAL ADDITIONAL ARTIFICIAL HILLS AROUND THE AMPHITHEATRE, WHILE BETWEEN THE EXISTING AND NEW HILLS, THE THEATRE COMPLEX WILL BE BUILT AND NEW BUILDINGS WILL BE BUILT USING LOCAL MATERIALS. THE EXISTING AMPHITHEATRE WILL VISUALLY BE THE MAIN, HIGHEST HILL, AND THE VISITOR WILL PASS BETWEEN RELATIVELY SMALL HILLS BEFORE ARRIVING AT THE MAIN HILL. ARTIFICIAL HILLS, WHICH MUST BE PLANTED. PLANTING GREENERY WILL CREATE A CERTAIN MICROCLIMATE IN THE AREA, WHICH IS VERY IMPORTANT IN THE LOCAL CLIMATE. AN ADDITIONAL PLUS IS THE SHAPE OF THE HILLS, THEY WILL BE DEVELOPED IN SUCH A WAY THAT IT WILL DIRECT THE WIND MASSSES AND FACILITATE THE NATURAL VENTILATION OF THE AREA AS WELL AS NEW BUILDINGS. VENTILATION.

TECHNICAL INFORMATION

MOST OF THE PROJECT IS MADE OF LOCAL MATERIALS, SUCH AS CLAY, SOIL, SLAB, BRICK, LOCAL WOOD. CONCRETE COLUMNS AND METAL CONSTRUCTION ARE ALSO USED FOR ROOFING.

THE FACADE OF THE WORK SPACE BUILDING IS MADE OF BRICKS, WHICH ARE INSPIRED BY LOCAL WALL PAINTINGS WITH ARROW-SHAPED OPENINGS. THEIR FUNCTION IS TO ILLUMINATE AND VENTILATE THE BUILDING. THE FLOOR IS MADE OF CONCRETE SLAB, WHICH IS ALSO PAVED WITH BRICKS. THE ROOF CONSTRUCTION IS MADE OF METAL, SUPPORTED BY CONCRETE COLUMNS. THE CONSTRUCTION IS COVERED WITH A LOCAL PATTERN ARRANGED BY A MODERN METHOD. THE SCENE FACADE CONSISTS OF A CLAY WALL IN WHICH LOCAL PIECES OF WOOD ARE ATTACHED. ROPES ARE STRETCHED OVER THE AUDIENCE SPACE, FASTENED ON ONE SIDE TO THE TOP OF THE STAGE AND ON THE OTHER SIDE TO A LIGHT METAL CONSTRUCTION. ON THE FACADE OF THE LABO SPACE BUILDING IS USED STRAW, AS WELL AS STRAW REVOLVING DOORS WITH WOODEN FRAMES. THIN VERTICAL ARROW-SHAPED LINES ARE CUT ON THE FACADE TO ILLUMINATE AND VENTILATE THE SPACE. THE CONSTRUCTION OF THE ROOF IS MADE OF LOCAL WOOD, SUPPORTED BY CONCRETE COLUMNS. THE CONSTRUCTION IS COVERED WITH A LOCAL PATTERN ARRANGED BY A MODERN METHOD.

- SHOW AREA - 900 M²
- WORK AREA - 1100 M²
- LABO AREA - 1200 M²
- PLACE FOR TEMPORARY STALLS - 250 M²
- POINTS OF SALE FOR TICKETS

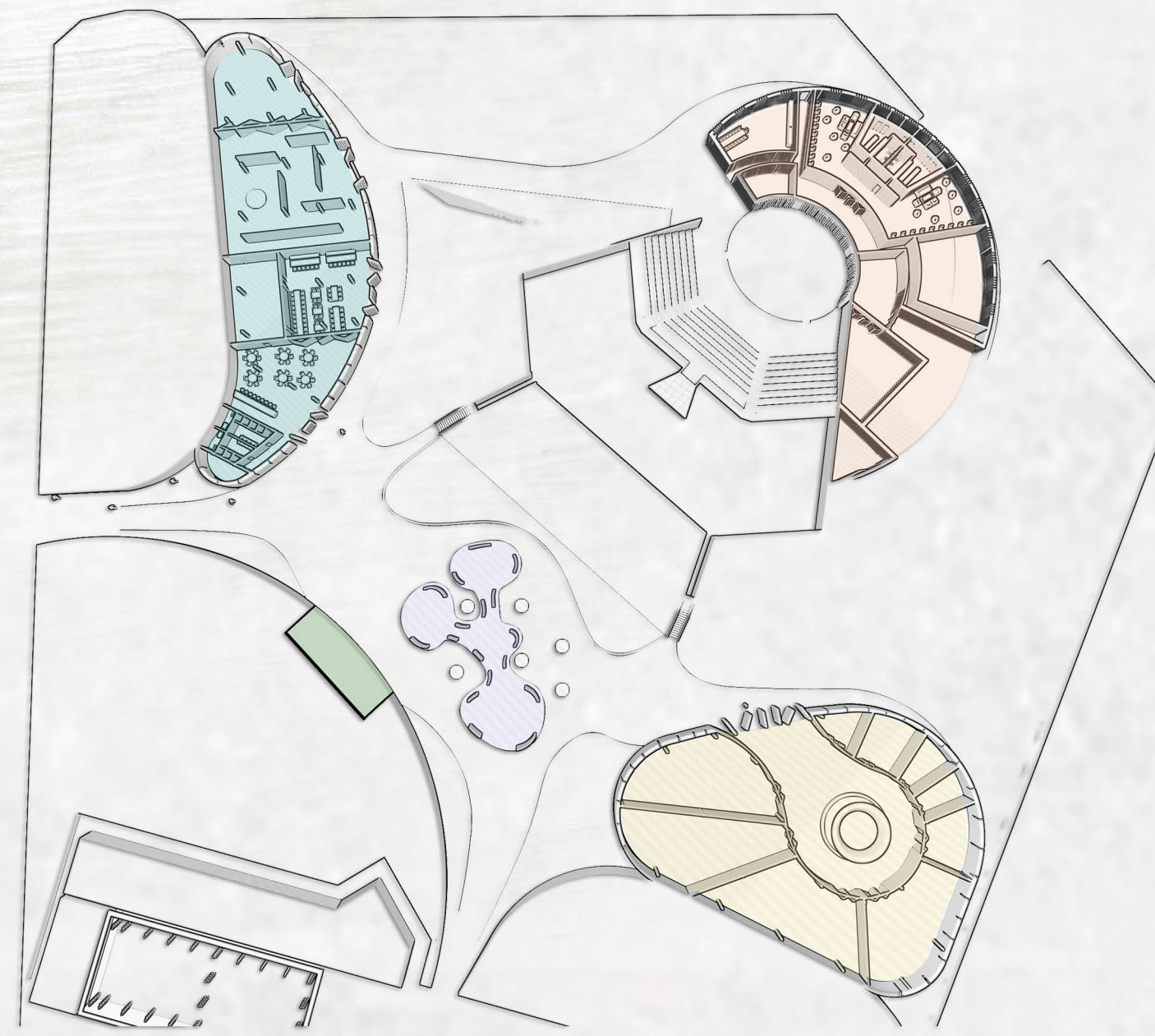

- WORKING AREA**
1. STAGE (15X18) - 220 M²
 2. BACKSTAGE - 70 M²
 3. MAKE-UP AREA - 70 M²
 4. DRESSING ROOMS, RESTROOMS, SHOWERS, MIRRORS - 200 M²
 5. MEETING ROOM WITH A KITCHENETTE - 75 M²
 6. ROOM FOR TECHNICIANS - 30 M²
 7. SEWING WORKSHOP - 115 M²
 8. ROOM FOR CONSTRUCTION AND STORAGE FOR STAGE SETS - 60 M²
 9. ROOM AND WORKSHOP FOR REPAIR AND STORAGE OF TECHNICAL EQUIPMENT - 90 M²
 10. TRUCK ACCESS - 60 M²
 11. GARAGE PARKING - 85 M²
 12. AREA FOR DISABLE PEOPLE

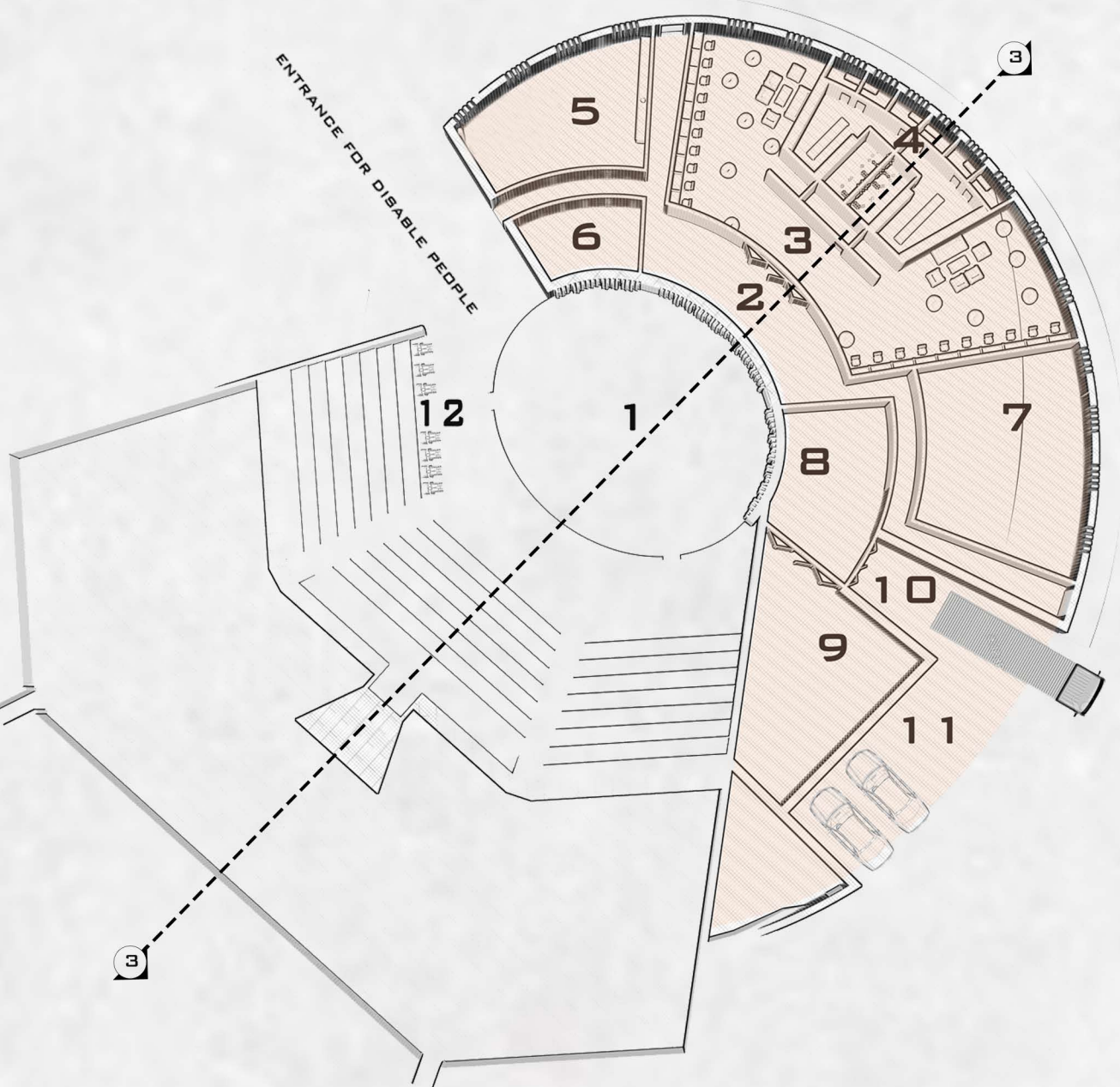

- LABO AREA**
1. DANCE AREA - 165 M²
 2. THEATRE AREA - 165 M²
 3. MUSIC - 170 M²
 4. CIRCUS AND PUPPETS AREA - 150 M²
 5. ARCHIVE ROOM - 60 M²
 6. MUSIC RECORDING STUDIO - 30 M²
 7. STUDIO PHOTO STUDIO - 30 M²
 8. MODULAR MEDIA ROOM - 50 M²
 9. VIDEO EDITING ROOM - 30 M²
 10. PUBLIC SPACE - 330 M²

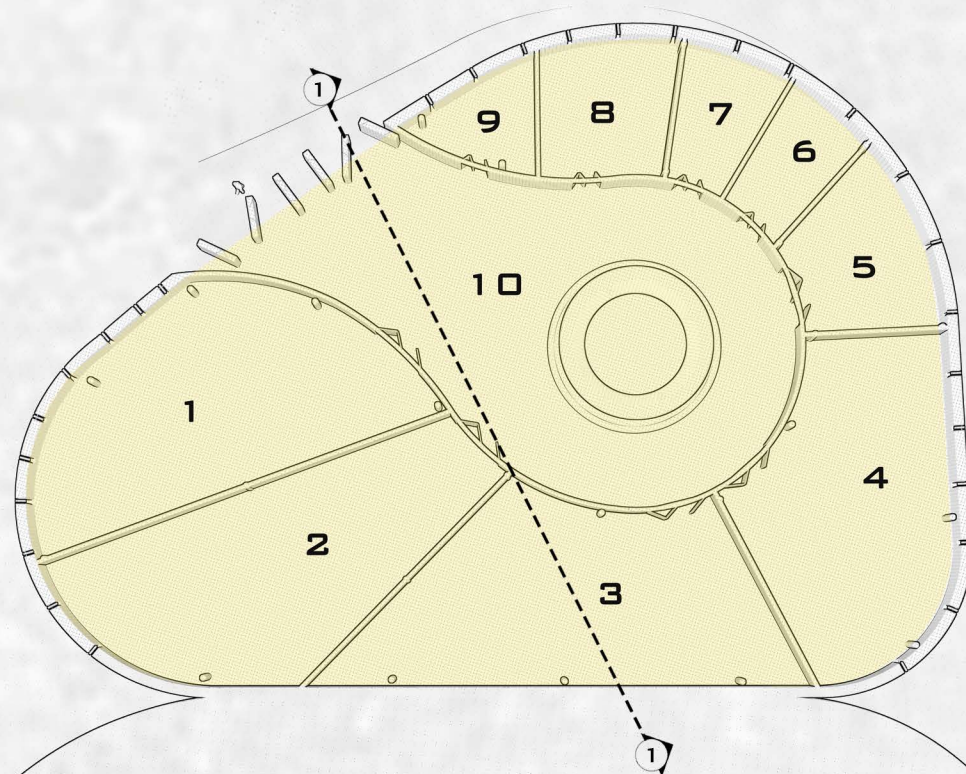

- SHOW AREA**
1. DANCE AREA - 165 M²
 2. THEATRE AREA - 165 M²
 3. MUSIC - 170 M²
 4. CIRCUS AND PUPPETS AREA - 150 M²
 5. ARCHIVE ROOM - 60 M²
 6. MUSIC RECORDING STUDIO - 30 M²
 7. STUDIO PHOTO STUDIO - 30 M²
 8. MODULAR MEDIA ROOM - 50 M²
 9. VIDEO EDITING ROOM - 30 M²
 10. PUBLIC SPACE - 330 M²

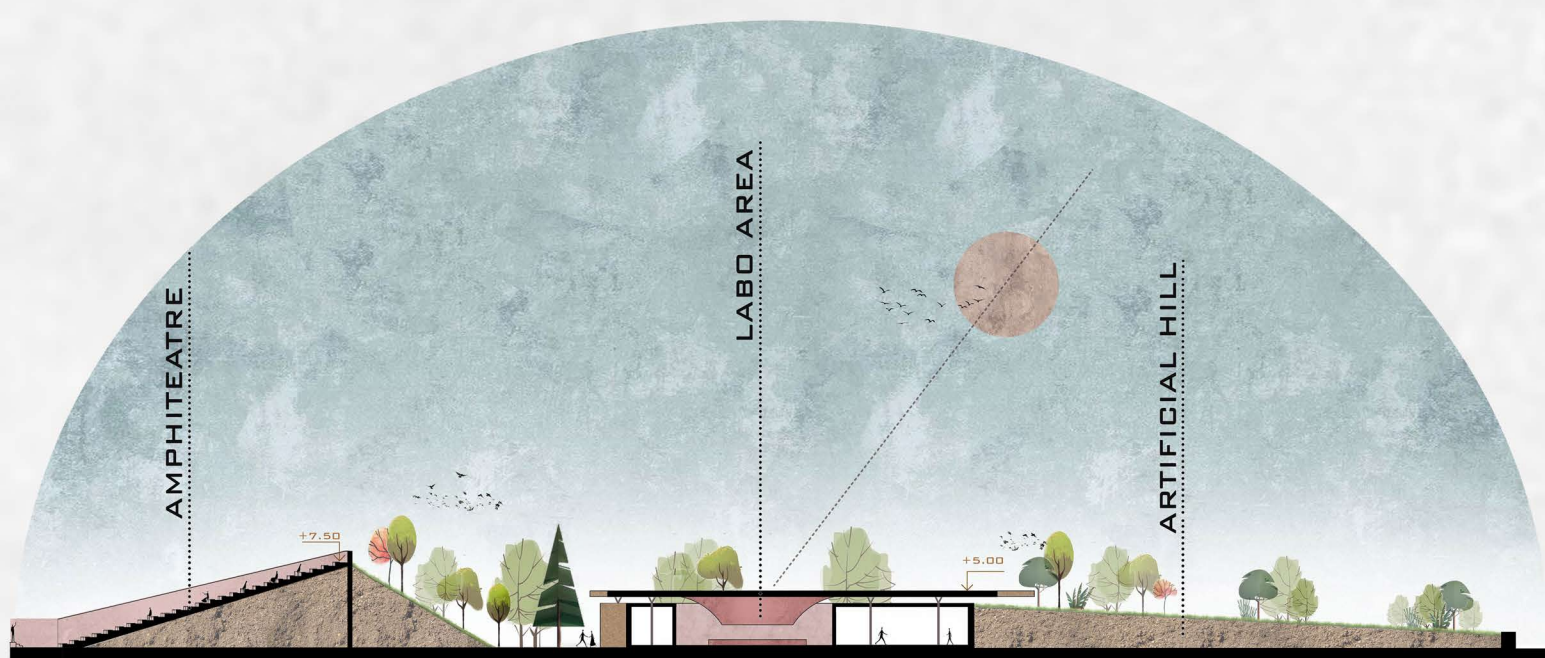
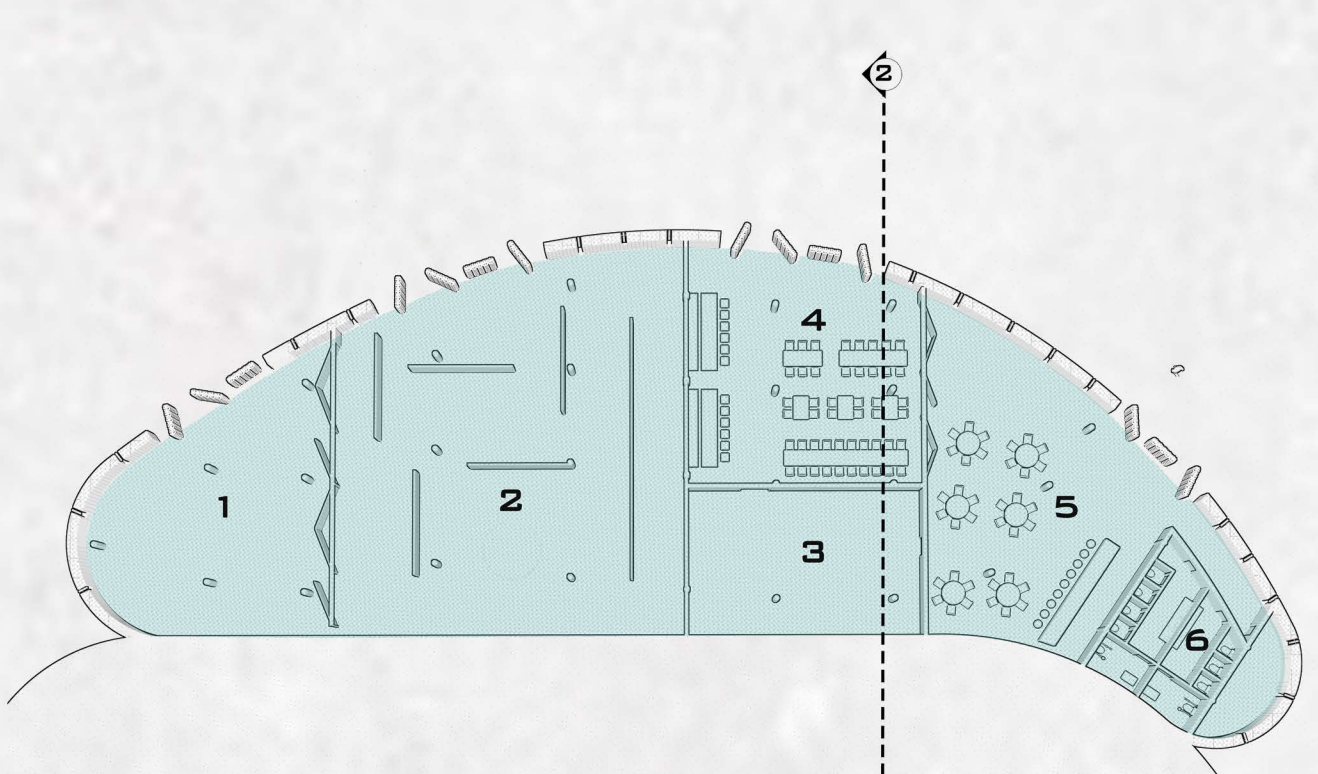

SECTION 1-1

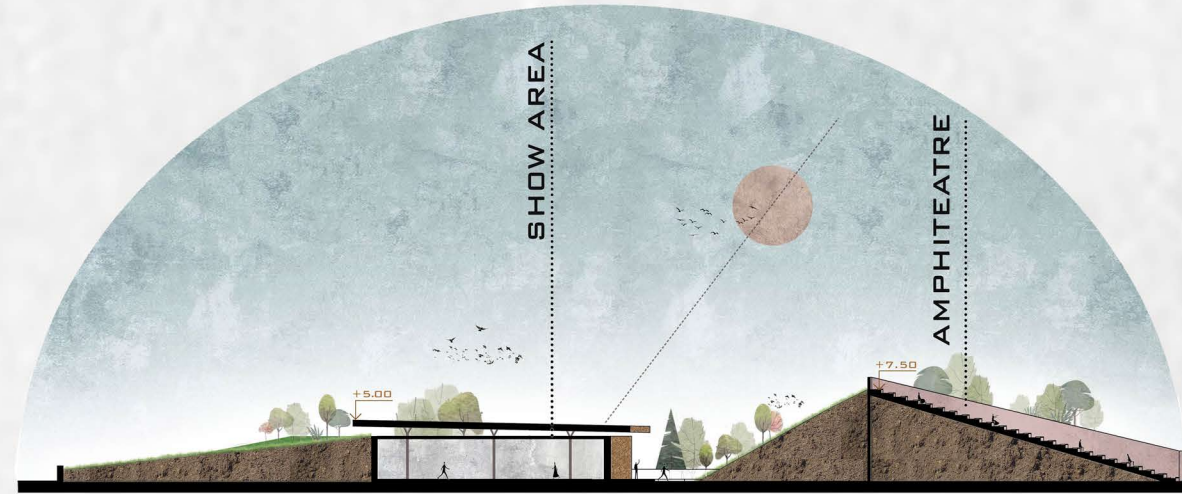

SECTION 2-2

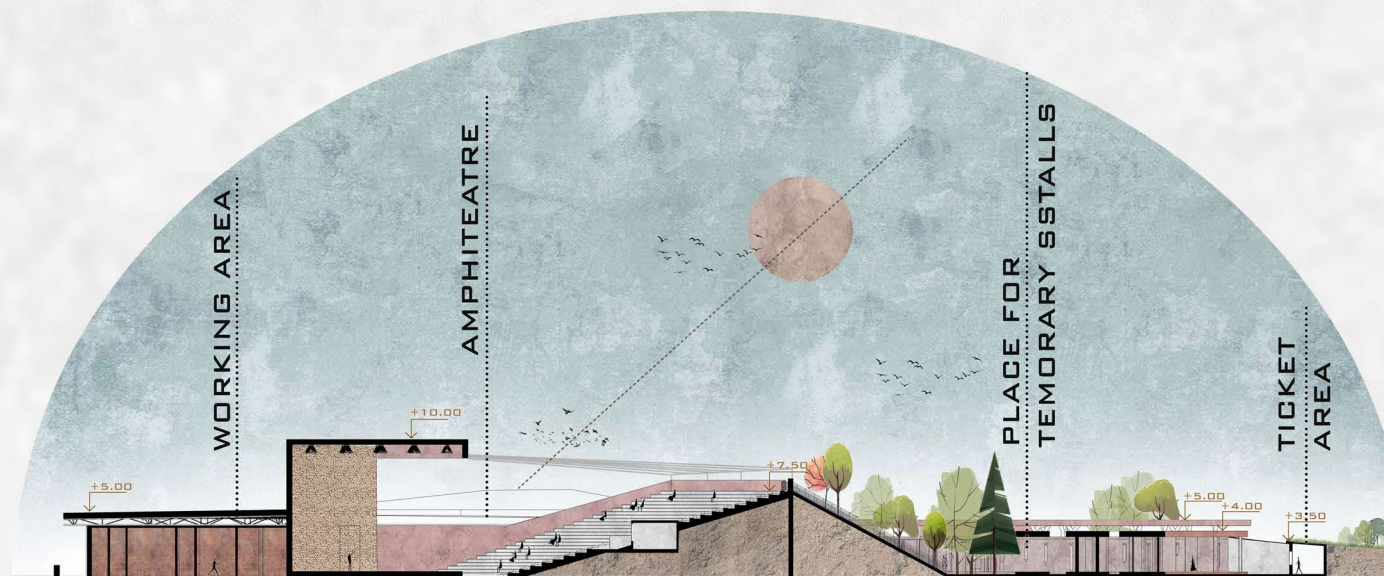

SECTION 3-3

WORKING AREA FACADE



LABO AREA FACADE



SHOW AREA FACADE



VENTILATION SYSTEM

