

THEATRE POPULAIRE IDEA(L)

RÉHABILITATION OF THE THÉÂTRE POPULAIRE DÉSIRÉ BONOGO

Theatre Populaire Desiré Bonogo should be a place, where everybody is warmly welcomed, and every citizen of the city could benefit of the renewed area of the amphitheatre. The main goal of the restoration project is to present a clear and sustainable idea of a people's centre of culture and art, respect to the local realities.

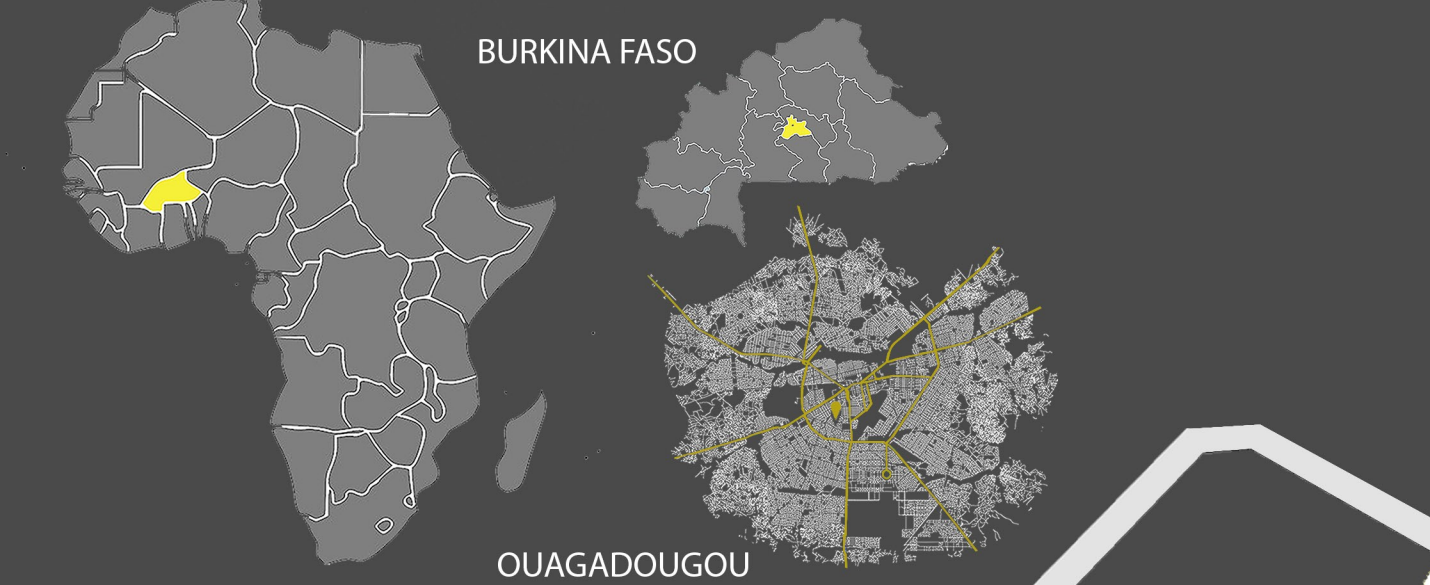

Burkina Faso is characterized by tropical summer-humid climate under the influences of a trade wind driven dry season from October to April and an Intertropical Convergence Zone driven rainy season from May to September. Whereas green vegetation largely disappears in the dry season, phenological peaks occur during the rainy season. The wind directions are mainly North - North-Eastern and South - South-Western.

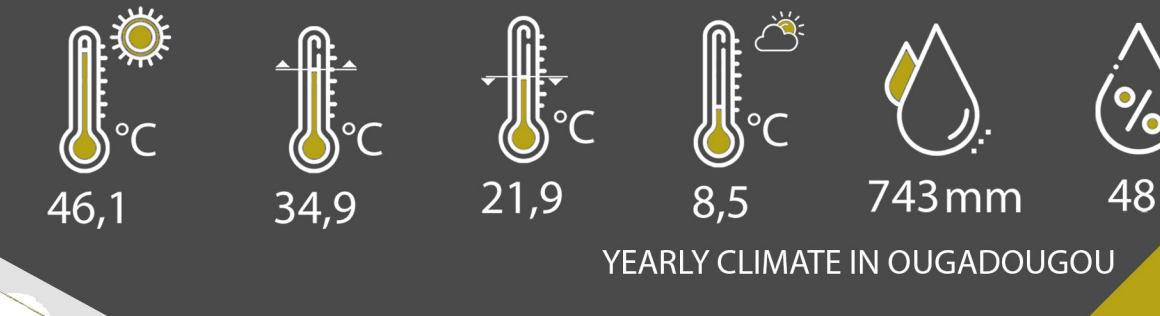

PREVAILING WINDS IN OUGAGA
PREVAILING WIND DIRECTION THROUGH THE SITE

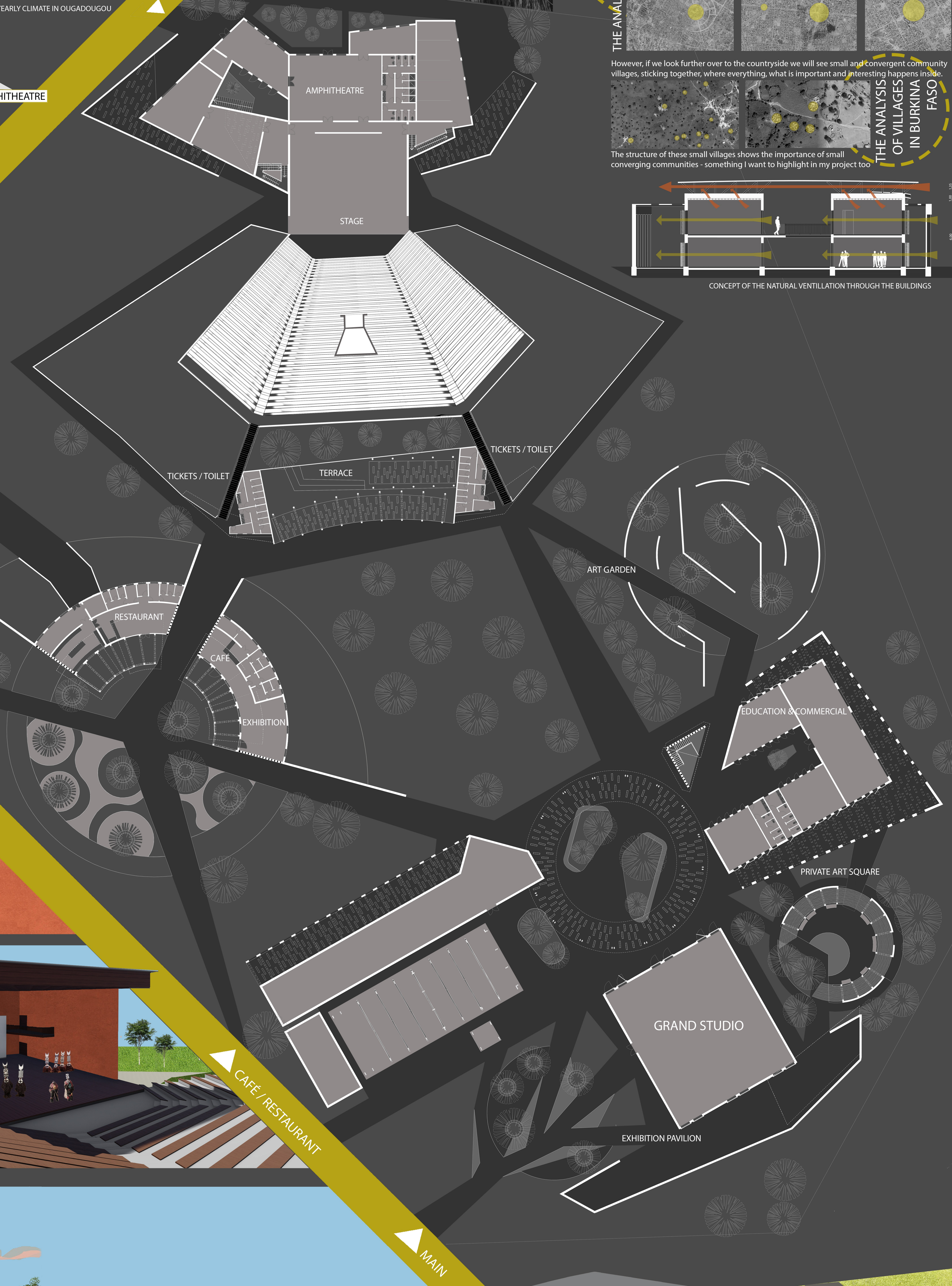
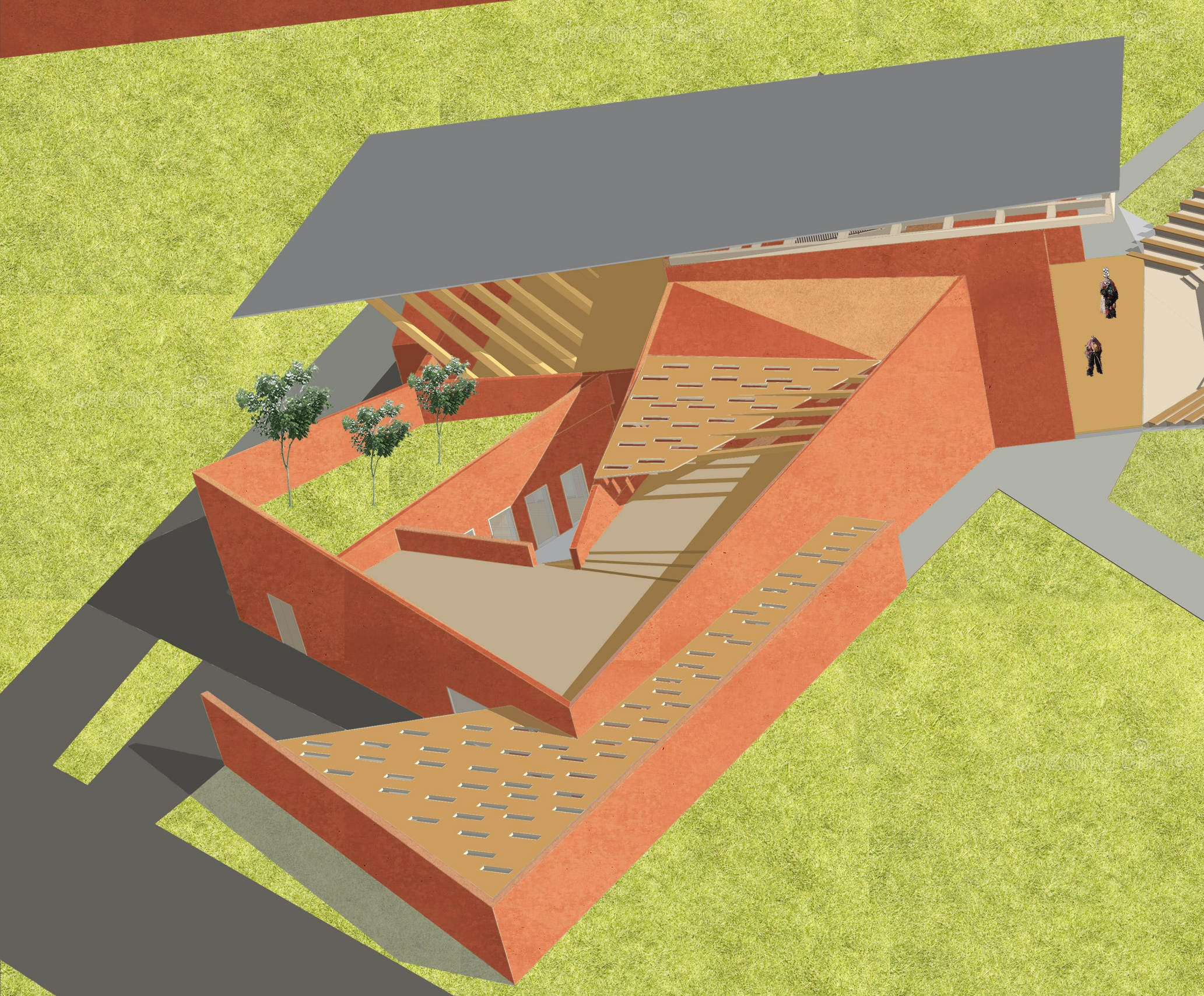
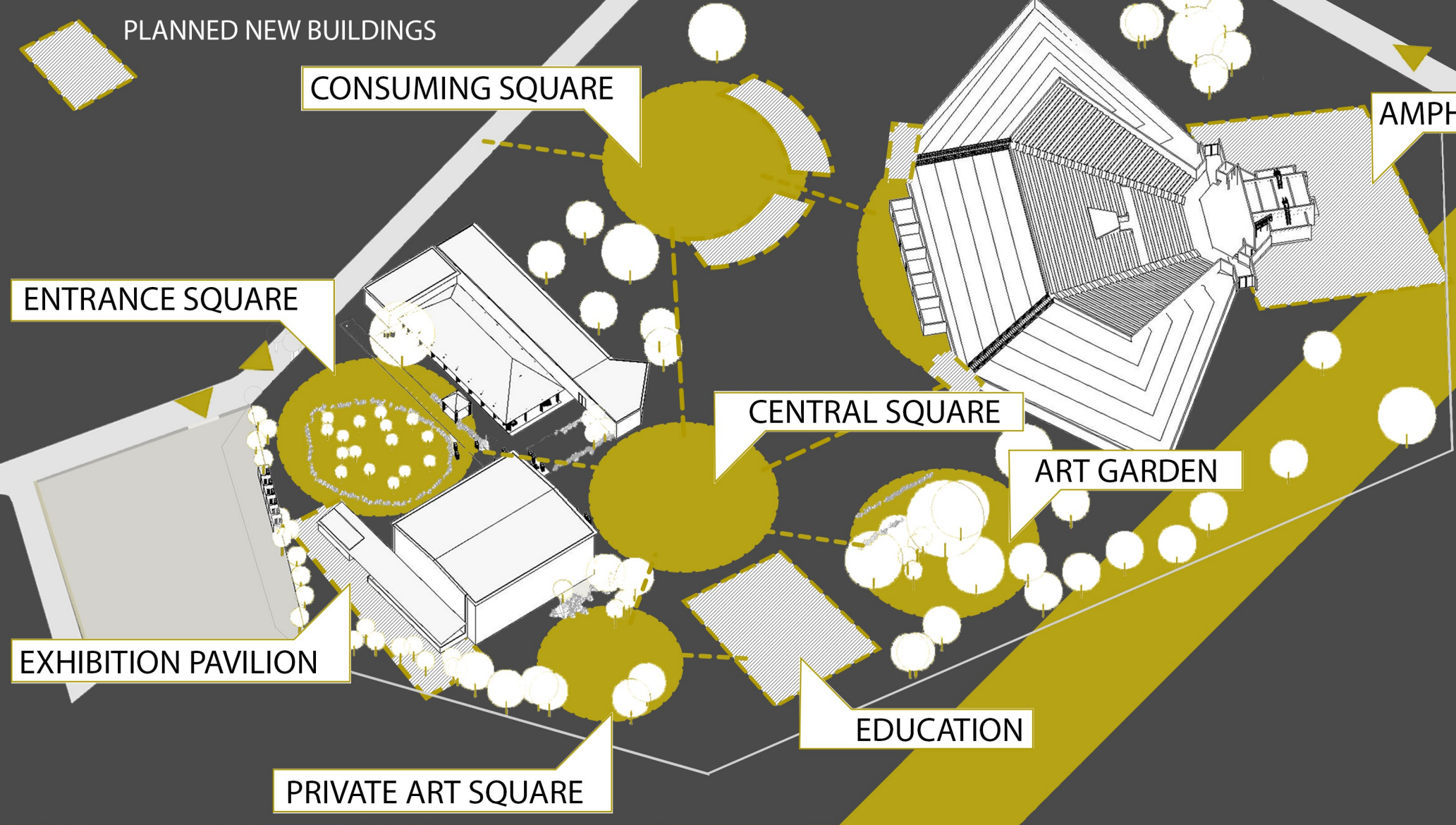

ANALYSIS

The capital, Ouagadougou is a wide spreaded city with a huge population density, very low average building height and with very rare green areas sparsely around water surfaces. Analysing the streets of Ouaga I recognised some of the most interesting places on the map are around the great roundabouts, but inside them nothing ever happens!

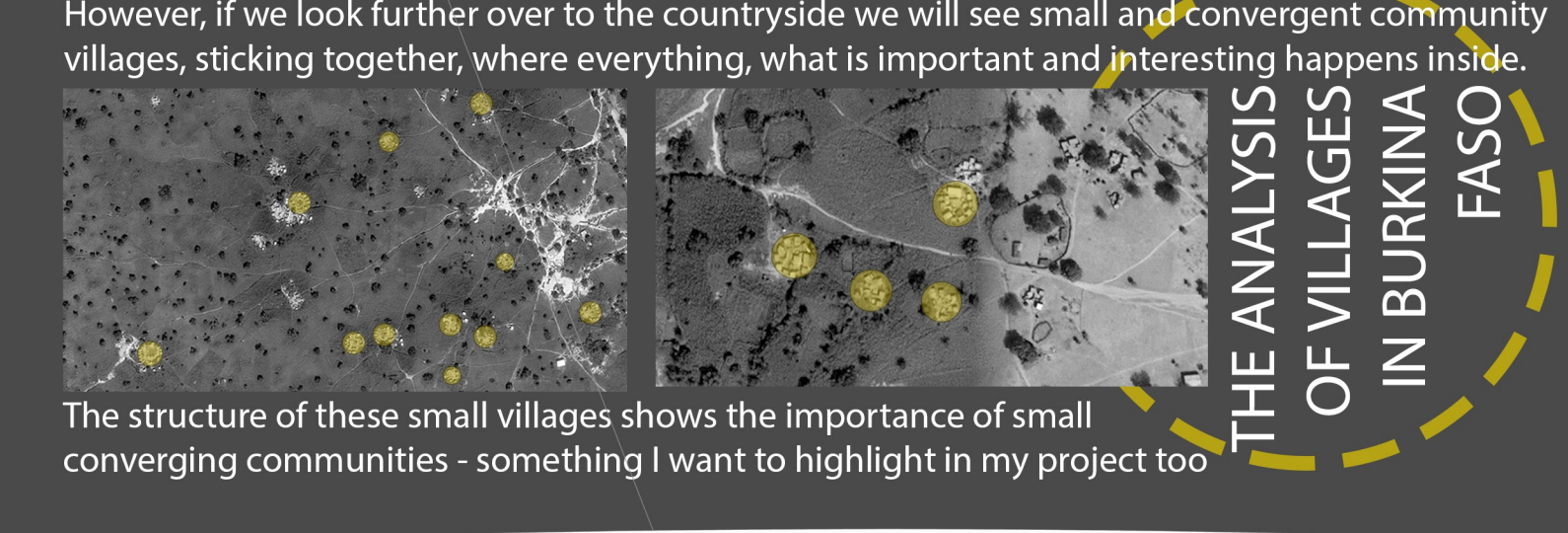

However, if we look further over to the countryside we will see small and convergent community villages, sticking together, where everything, what is important and interesting happens inside.

The structure of these small villages shows the importance of small converging communities - something I want to highlight in my project too



THE ANALYSIS OF VILLAGES IN BURKINA FASO