

PROJECT IDEA

OBSERVING BURKINA FASO'S CAPITAL OUAGADOUGOU, THE FIRST THING THAT CATCHES YOUR EYE IS THE GRID OF RECTANGULAR, SIMPLE GEOMETRIC SHAPES. WHEN YOU LOOK DIRECTLY AT THE ARCHITECTURAL FORMS, YOU WILL SEE THAT THE BUILDINGS ARE ALSO SIMPLE, POOR, MONOTONOUS, IN SHADES OF SAND AND DESERT. THIS IS AN ENVIRONMENT WHERE YOUR THEATER COMPLEX IS LOCATED, WHICH SEEMS TO BE OUT OF CONTEXT AND DOESN'T HAS CONTACT WITH THE URBAN ENVIRONMENT.

AFTER ANALYZING THE CURRENT SITUATION, I DECIDED THAT THE RENOVATED THEATER SHOULD HAVE NEW CONNECTIONS WITH THE EXISTING AREA. IT WILL HELP TO MAKE THEATER EASY TO ACCESS. IT IS ALSO IMPORTANT THAT THE THEATER AND THE CDC APPROACH TO EACH OTHER, BECAUSE THESE TWO COMPLEXES HAVE ALMOST THE SAME FUNCTIONS, THIS IS WHY NEW SPACES ARE INTEGRATED WITH BOTH.

AFTER CONSIDERING THE TYPICAL CLIMATIC CONDITIONS AND THE EXISTING ENVIRONMENT, I DECIDE TO MAKE THE ARCHITECTURE SIMPLE, WITH MINIMALISTIC SHAPES, SMALL OPENINGS, SUN SHADES, GREEN ROOF AND LOCAL MATERIALS. WHICH WILL FIT NEW BUILDINGS INTO THE CONTEXT HARMONIOUSLY AND MAINTAIN A DIFFERENT LOOK.

PROJECT DESCRIPTION

THE THEATER INCLUDES SEVERAL SPACES THAT ARE LOCATED IN DIFFERENT PARTS AND PROVIDE FREE SPACES BETWEEN THEM, WHICH CAN BE USED FOR A VARIETY OF ACTIVITIES. THE THEATER HAS ADDED A NEW STAGE, WHICH IS MAINLY REPRESENTED BY SIMPLE, MASSIVE FORMS AND WOODEN DETAILS. BEHIND THE STAGE, THERE IS LOCATES WORK SPACE FOR ACTORS, STAGE DECORATIONS, MEETINGS, TECHNICIANS, WORKSHOP AN ETC. OUTSIDE THE THEATER THERE IS A SHOW SPACE THAT INCLUDES TICKET SALES OFFICE AND CAFETERIA WITH SUNSHADES. AND THE LABO AREA IS DIVIDED INTO TWO PARTS: 1. SPACES FOR ART DISCIPLINES 2. STUDIOS AND WORKSHOP INTEGRATED WITH THE CDC COMPLEX. IN THE CDC BUILDINGS, THERE HAS BEEN REPLACED ACCOMMODATION SPACE, IT HAS BEEN GROW AND ADDED SOME PARTS OF THE LABO SPACE. AND THE OTHER BUILDINGS ARE UNTOUCHABLE. THERE IS PARKING ON THE TERRITORY OF THE COMPLEX AND IT IS POSSIBLE TO ACCESS THE TRUCK. THERE ARE NO WALKWAYS BETWEEN THE BUILDINGS, AS THE WHOLE AREA IS COVERED WITH SAND AND PEOPLE DECIDE FOR THEMSELVES WHICH DIRECTION TO GO. THERE IS VEGETATION AROUND THE BUILDINGS WHICH ALSO PROVIDES SHADES AND COOLNESS.

TECHNIQAL INFORMATION

MASSIVE SHAPES AND A GREEN ROOF PROTECT THE BUILDING FROM OVERHEATING. THERE ARE ALSO SHADES NEAR THE BUILDINGS AND BETWEEN THEM TO PROTECT FROM THE SUN RAYS. THE WALLS OF THE BUILDINGS ARE MADE OF LOCAL BRICKS AND COVERED WITH WHITE CONCRETE. THERE ARE SUN SHADES ON THE WINDOWS TOO, THAT PROTECT INTERIOR FROM HEATING.

LOCATION



SKETCHES

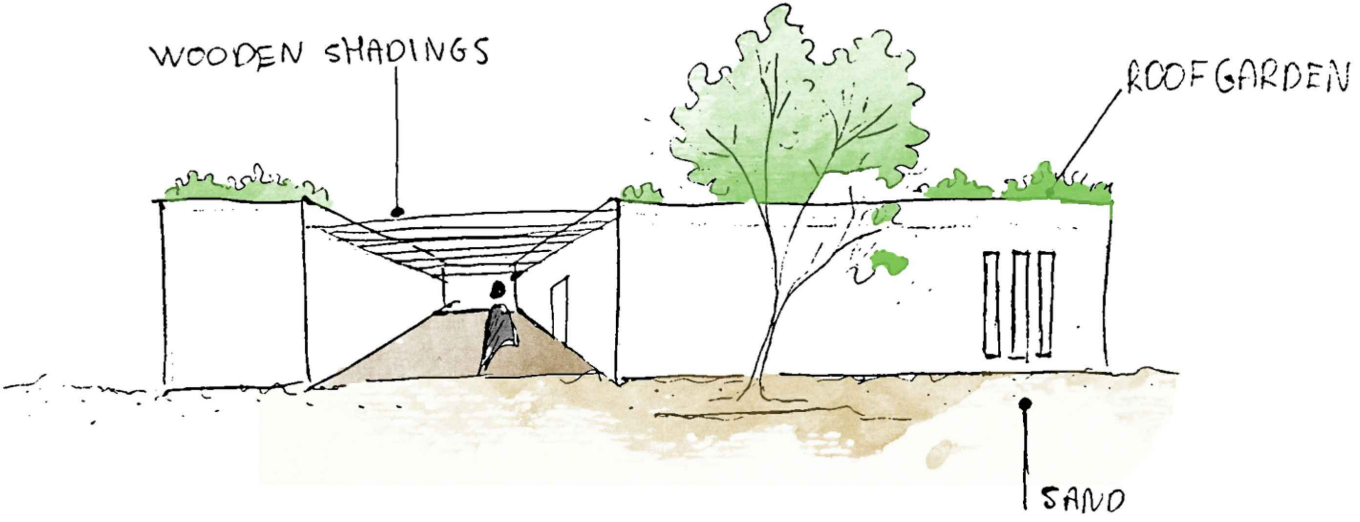

MATERIALS

