

THEATRE POPULAIRE BURKINA FASO

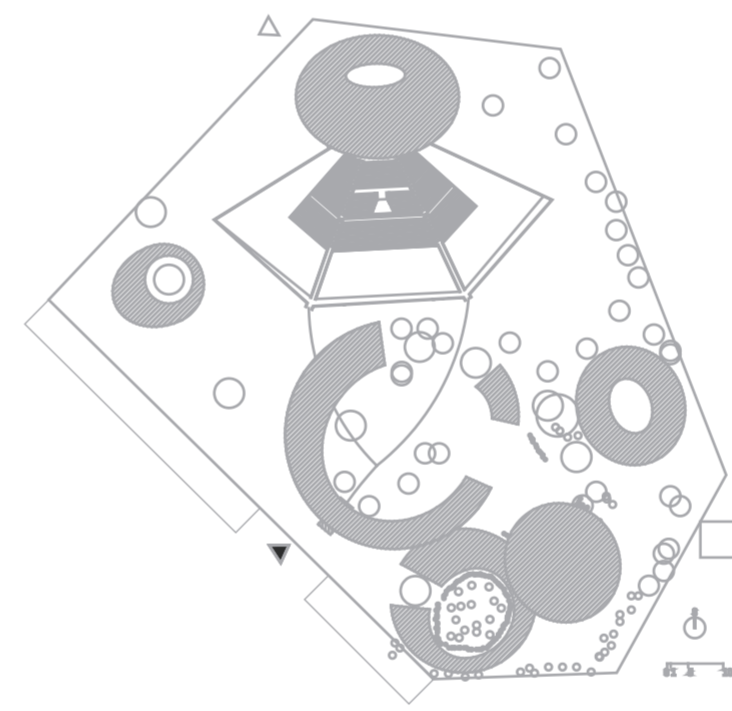

There are three main zones defined in the area and these include the Work, Show and Labo zones. These zones are designed in circular shapes, which are complemented or surrounded by existing trees in some parts. The circles are supposed to represent communities - the strength of Burkina Faso, one of the poorest countries in the world. Community is an integral part of life of the majority of the country's population (except for larger cities). Its functions cover sharing of space, needs, values, identity as well as a way of survival and a family. Circle is a symbol. It is open all visitors, performers, employees and students from all the directions to. The combination of circular roofs and existing trees, which are a natural meeting place in Africa due to its cold and shade, creates a space for gatherings. In total the zones consist of six circular roofs with square buildings located underneath. The principle of double roofing is used throughout the whole complex. It improves the conditions in the buildings as it allows air circulation and supplies coldness. The buildings of the individual zones are distributed in such a way that they are all accessible to each other and at the same time provide privacy, especially in the Work zone and in the accommodation area. The construction of the buildings will be carried out from the available natural materials located nearby. The aim of the overall solution is to create open, relaxed and safe atmosphere and affect the visitors in this way.

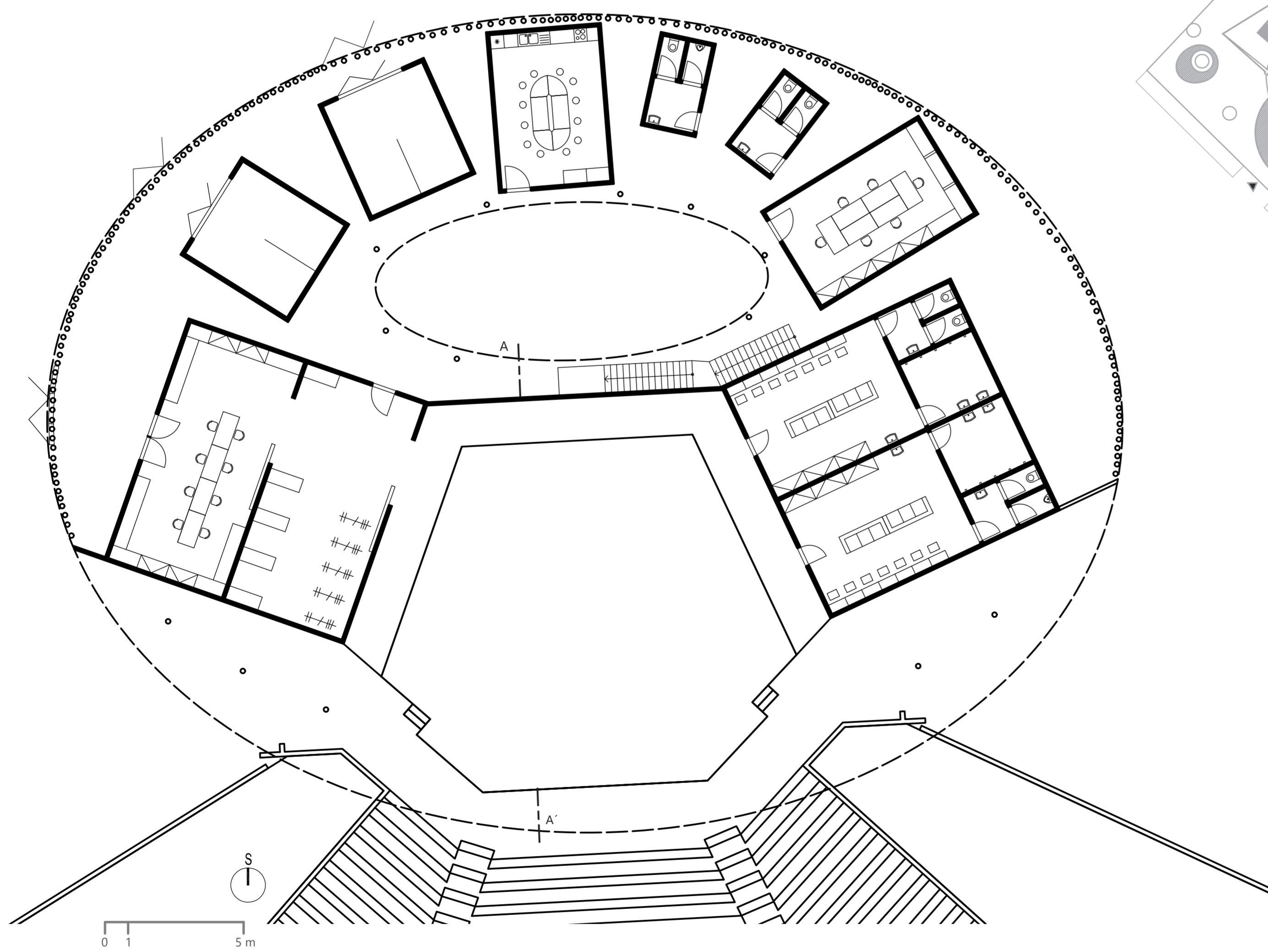