

CONSTRUCTION SYSTEM

ROOF +16.40

WOODEN TRUSS +16.20

STEEL TRUSS BEAM +11.50

COLUMNS +10.50

AUDITORIUM +8.60

GROUND ±0.00

AUDITORIUM
STRUCTURE

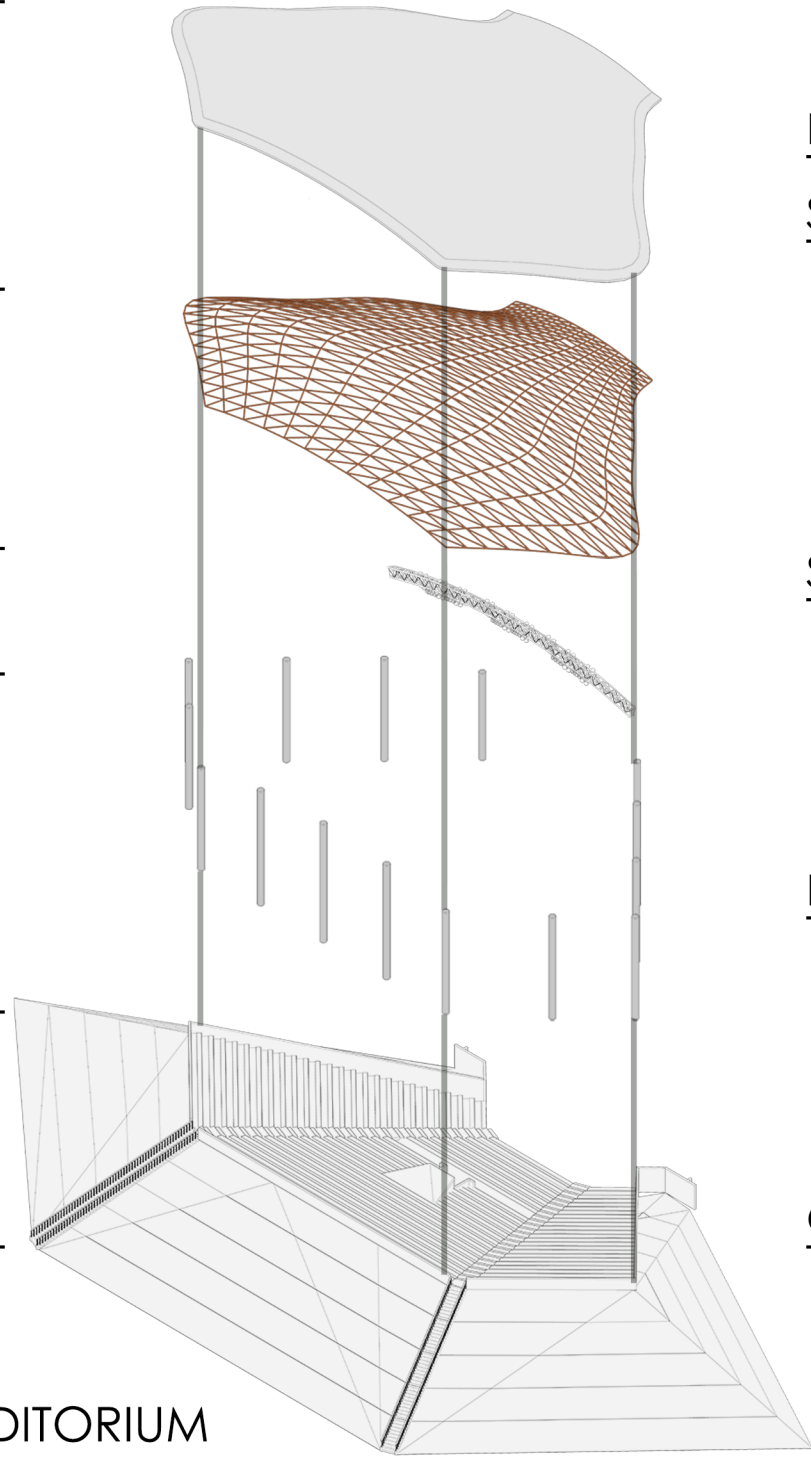

FLY TOWER ROOF +28.35

ROOF +14.40

STEEL TRUSS +12.60

SECOND FLOOR +8.80

FIRST FLOOR +5.00

GROUND FLOOR +1.20

BACKSTAGE
STRUCTURE

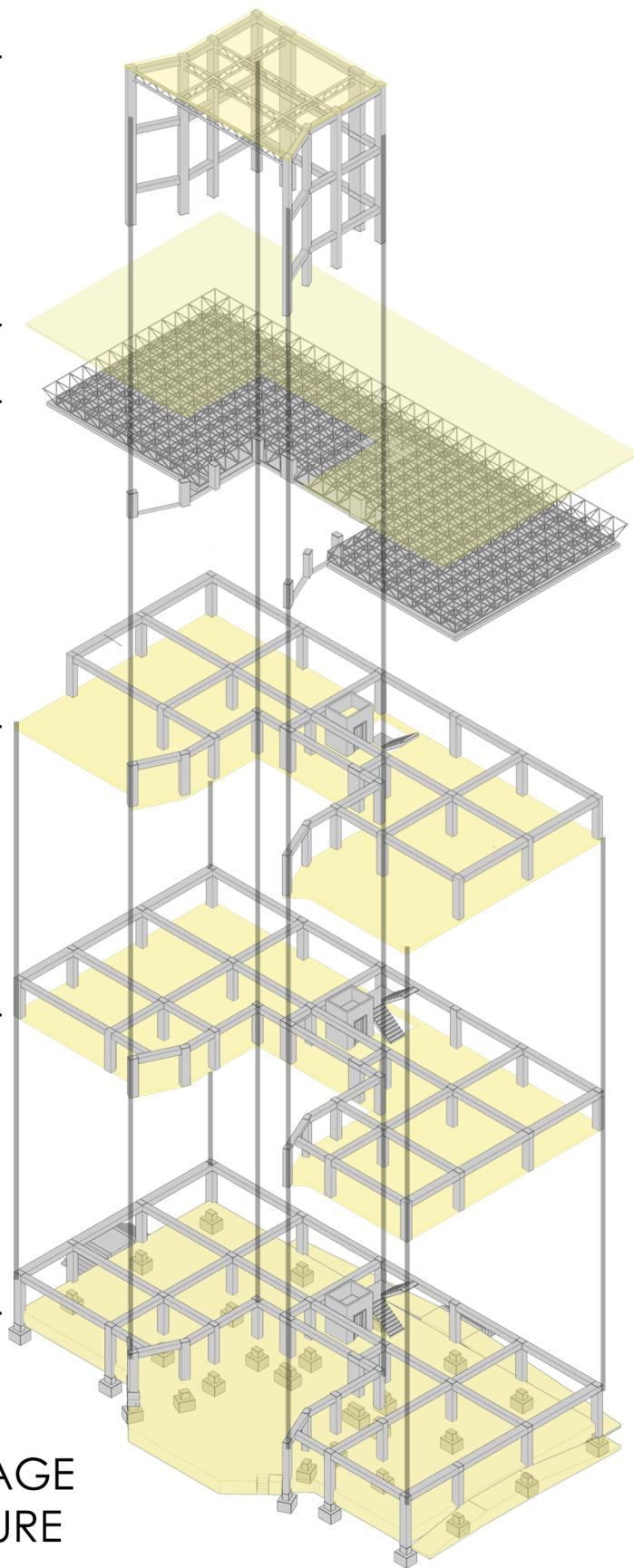

DESCRIPTION

Considering the socio-economic situation of Burkina Faso, the building elements were chosen as cheap, durable and functional.

Easy-to-apply reinforced concrete has been used for the backstage building. The steel truss structure in the backstage has been designed to protect the building from heat and rain.

Secondly, the auditorium also needed to be protected from heat and rain. Roofing system has been designed for this purpose.

Wooden truss structure is cheap and light and could be applied by using local material. Thus, the design will also achieve to vernacular architecture.